

# **Tender specification**

## **No: BHE/PW/PUR/WNT2-PEB BLD/1352**

### **Scope of work:-**

**A) Supply Job:** - Design, Supply of pre- fabricated office building using Plastocrete panels including & its supporting structure, internal & external plumbing & sewage connections all complete including supply of modular furnishing items, air conditioner etc. For 1 x 800 MW Wanakbori gujarat.

**B) E & C Job:-** Unloading, receipt & handling of all supplied material to complete Pre- Fabricated office Building; pre assembly, erection, alignment, bolting/ welding/ fastening, grouting, testing, final painting and handing over including Civil work, sewerage system, plumbing system of Pre- Fabricated office Building site of 1 X 800 MW WANAKBORI GUJARAT.

### **AT**

### **1X 800 MW WANAKBORI TPS**

### **GUJRAT**

### **Technical bid - volume- I**

#### **Consisting of:**

- **Notice Inviting Tender,**
- **Volume-IA : Technical Conditions of Contract-,**
- **Volume-IB : Special Conditions of Contract,**
- **Volume-IC : General Conditions of Contract**
- **Volume-ID : Forms & Procedures**
- **Volume II B: technical Specification**



# **Tender specification**

## **No: BHE/PW/PUR/WNT2-PEB BLD/1352**

### **Tender Specification Issue Details**

#### **Scope of work:-**

**A) Supply Job:** - Design, Supply of pre- fabricated office building using Plastocrete panels including & its supporting structure, internal & external plumbing & sewage connections all complete including supply of modular furnishing items, air conditioner etc. For 1 x 800 MW Wanakbori Gujarat.

**B) E & C Job:-** Unloading, receipt & handling of all supplied material to complete Pre- Fabricated office Building; pre assembly, erection, alignment, bolting/ welding/ fastening, grouting, testing, final painting and handing over including Civil work, sewerage system, plumbing system of Pre- Fabricated office Building site of 1 X 800 MW WANAKBORI GUJARAT.

### **AT**

## **1X 800 MW WANAKBORI TPS**

## **GUJRAT**

EARNEST MONEY DEPOSIT: Refer Notice Inviting Tender

LAST DATE FOR                      Refer Notice Inviting Tender  
TENDER SUBMISSION                      .

THESE TENDER SPECIFICATION DOCUMENTS CONTAINING VOLUME-I AND VOLUME- II ARE ISSUED TO:

M/s. ....

.....

PLEASE NOTE:  
THESE TENDER SPECS DOCUMENTS ARE NOT TRANSFERABLE.

For Bharat Heavy Electricals Limited

AGM (Purchase)  
Place: Nagpur  
Date :

Volume No	Description	Hosted in website bhel.com as files titled
NIL	Tender Specification Issue Details	(Part of <b><u>Vol-IA-1352</u></b> )
NIL	Notice Inviting Tender	(Part of <b><u>Vol-IA-1352</u></b> )
I-A	Technical Conditions of Contract	Vol-IA- <b><u>1352</u></b>
I-B	Special Conditions of Contract	Vol-IBCD- <b><u>1352</u></b>
I-C	General Conditions of Contract	(Part of Vol-IBCD- <b><u>1352</u></b> )
I-D	Forms & Procedures	(Part of Vol-IBCD- <b><u>1352</u></b> )
II	Price Bid Specification	Vol-II- <b><u>1352</u></b>

1352

# NOTICE INVITING TENDER

Bharat Heavy Electricals Limited

**BHEL PSWR**  
**Notice Inviting Tender**

Tender Specification No: BHE/PW/PUR/WNT2-PEB BLD/1352

Page 5 of 46

Ref: BHE/PW/PUR/WNT2-PEB BLD/1352

Dt: 07/11/2014

**NOTICE INVITING TENDER (NIT)**  
**NOTE: BIDDER MAY DOWNLOAD FROM WEB SITES**  
**OR**  
**PURCHASE TENDERS FROM THIS OFFICE ALSO**

=====

To

Dear Sir/Madam

Sub : **NOTICE INVITING TENDER**

Sealed offers in two part bid system are invited from reputed & experienced bidders (meeting [PRE QUALIFICATION CRITERIA](#) as mentioned in Annexure-I) for the subject job by the undersigned on the behalf of BHARAT HEAVY ELECTRICALS LIMITED as per the tender document. Following points relevant to the tender may please be noted and complied with.

**1.0 Salient Features of NIT**

SL NO	ISSUE	DESCRIPTION
i	TENDER NUMBER	BHE/PW/PUR/WNT2-PEB BLD/1352
ii	Broad Scope of job	<p><b>A) Supply Job:</b> - Design, Supply of pre- fabricated office building using Plastocrete panels including &amp; its supporting structure, internal &amp; external plumbing &amp; sewage connections all complete including supply of modular furnishing items, air conditioner etc. For 1 x 800 MW Wanakbori gujarat.</p> <p><b>B) E &amp; C Job:-</b> Unloading, receipt &amp; handling of all supplied material to complete Pre- Fabricated office Building; pre assembly, erection, alignment, bolting/ welding/ fastening, grouting, testing, final painting and handing over including Civil work, sewerage system, plumbing system of Pre-Fabricated office Building site of 1 X 800 MW WANAKBORI GUJARAT.</p>
iii	DETAILS OF TENDER DOCUMENT	
a	Volume-IA	<i>Technical Conditions of Contract (TCC) consisting of Scope of work, Technical Specification, Drawings, Procedures, Bill of Quantities, Terms of payment, etc</i> Applicable
b	Volume-IB	<i>Special Conditions of Contract (SCC)</i> Applicable

**BHEL PSWR**  
**Notice Inviting Tender**

**Tender Specification No: BHE/PW/PUR/WNT2-PEB BLD/1352**

**Page 6 of 46**

\*\*\*\*\*

c	Volume-IC	<i>General Conditions of Contract (GCC)</i>	<i>Applicable</i>
d	Volume-ID	<i>Forms and Procedures</i>	
e	Volume-II	<i>Price Schedule (Absolute value).</i>	<i>Applicable</i>
iv	Issue of Tender Documents	<p>1. <u>Sale from BHEL PS Regional office at :</u>  <b>Start : 02/12/2014 ,</b>  <b>Closes: 16/12/2014 , Time : 16.00 Hrs</b></p> <p>2. From BHEL website (<a href="http://www.bhel.com">www.bhel.com</a>)  Tender documents will be available for downloading from website till due date of submission</p>	<i>Applicable/</i> <i>Not applicable</i>
v	DUE DATE & TIME OF OFFER SUBMISSION	<p><b>Date : 17/12/2014, Time 15.00 Hrs</b>  <b>Place : <u>BHEL PS Regional office at :Nagpur</u></b></p> <p>Tenders being submitted through representative shall be submitted at dispatch section of of PSWR HQ Office after making entry/registration at the reception. For any assistance on the matter kindly contact following officials:  Pratish Gee Varghese/Sr Engineer(Purchase  Shivkesh Meena / Engineer (Purchase)</p>	<i>Applicable</i>
vi	OPENING OF TENDER	<p><b>1 hours after the latest due date and time of Offer submission</b></p> <p>Notes:  (1) In case the due date of opening of tender becomes a non-working day, then the due date &amp; time of offer submission and opening of tenders get extended to the next working day.  (2) Bidder may depute representative to witness the opening of tender</p>	<i>Applicable</i>
vii	EMD AMOUNT	<i>Rs 2,00,000/- (Rupees Two Lakhs Only)</i>	<i>Applicable</i>
viii	COST OF TENDER	<i>Rs 2000/- (Rupees Two thousand Only)</i>	<i>Applicable</i>
ix	LAST DATE FOR SEEKING CLARIFICATION	<p><i>Five days before the due date of offer submission.</i>  <i>Along with soft version also, addressing to undersigned &amp; to others as per contact address given below</i></p>	<i>Applicable</i>
x	SCHEDULE OF Pre Bid Discussion (PBD)	<i>Date :</i>	<i>Not applicable.</i>
xi	INTEGRITY PACT & DETAILS OF INDEPENDENT EXTERNAL MONITOR (IEM)		<i>Not Applicable</i>
xii	Latest updates	<p>Latest updates on the important dates, Amendments, Correspondences, Corrigenda, Clarifications, Changes, Errata, Modifications, Revisions, etc to Tender Specifications will be hosted in BHEL webpage (<a href="http://www.bhel.com">www.bhel.com</a> --&gt;Tender Notifications →View Corrigendums) <b>and not in the newspapers</b>. Bidders to keep themselves updated with all such information</p>	

**BHEL PSWR**  
**Notice Inviting Tender**

**Tender Specification No: BHE/PW/PUR/WNT2-PEB BLD/1352**

**Page 7 of 46**

\*\*\*\*\*

- 2.0 The offer shall be submitted as per the instructions of tender document and as detailed in this NIT. Bidders to note specifically that all pages of tender document, including these NIT pages of this particular tender together with subsequent correspondences shall be submitted by them, duly signed & stamped on each page, as part of offer. **Rates/Price including discounts/rebates, if any, mentioned anywhere/in any form in the techno-commercial offer other than the Price Bid, shall not be entertained.**
- 3.0 Unless specifically stated otherwise, bidder shall remit cost of tender and courier charges if applicable, in the form of Demand Draft drawn in favour of Bharat Heavy Electricals Ltd, payable at Power Sector Regional HQ at Nagpur issuing the Tender, along with techno-commercial offer. Bidder may also choose to deposit the Tender document cost by cash at the Cash Office as stated above against sl no iv of 1, on any working day; and in such case copy of Cash receipt is to be enclosed with the Techno Commercial offer. Sale of tender Documents shall not take place on National Holidays, holidays declared by Central or State Governments and BHEL PS HQ at Nagpur, Sundays and second/ last Saturdays
- 4.0 Unless specifically stated otherwise, bidder shall deposit EMD through Demand Draft/Pay Order in favour of Bharat Heavy Electricals Ltd, payable at Nagpur. For other details and for 'One Time EMD' please refer General Conditions of Contract.
- 5.0 **Procedure for Submission of Tenders:** The Tenderers must submit their Tenders to Officer inviting Tender, as detailed below:
- PART-I consisting of 'PART-I A (Techno Commercial Bid)' & 'PART-I B (EMD/COST of TENDER)' in two separate sealed and superscribed envelopes (ENVELOPE-I & ENVELOPE-II)
  - PART-II (Price Bid) – in sealed and superscribed envelope (ENVELOPE-III)
  - One set of tender documents shall be retained by the bidder for their reference
- 6.0 The contents for ENVELOPES and the superscription for each sealed cover/Envelope are as given below. **(All pages to be signed and stamped)**

Sl no	Description	Remarks
	<b>Part-I A</b>	
	<b>ENVELOPE – I superscribed as :</b> PART-I (TECHNO COMMERCIAL BID) TENDER NO : NAME OF WORK : PROJECT: DUE DATE OF SUBMISSION:  <b>CONTAINING THE FOLLOWING:-</b>	
i.	Covering letter/Offer forwarding letter of Tenderer.	
ii.	Duly filled-in 'No Deviation Certificate' as per prescribed format to be placed after document under sl no (i) above.  <b>Note:</b> <ol style="list-style-type: none"> <li>a. In case of any deviation, the same should be submitted separately for technical &amp; commercial parts, indicating respective clauses of tender against which deviation is taken by bidder. The list of such deviation shall be placed after document under sl no (i) above. It shall be specifically noted that deviation recorded elsewhere shall not be entertained.</li> <li>b. BHEL reserves the right to accept/reject the deviations without assigning any reasons, and BHEL decision is final and binding.               <ol style="list-style-type: none"> <li>i). In case of acceptance of the deviations, appropriate loading shall be done by BHEL</li> <li>ii). In case of unacceptable deviations, BHEL reserves the right to reject the tender</li> </ol> </li> </ol>	

**BHEL PSWR**  
**Notice Inviting Tender**

**Tender Specification No: BHE/PW/PUR/WNT2-PEB BLD/1352**

**Page 8 of 46**

\*\*\*\*\*

iii.	Supporting documents/ annexure/ schedules/ drawing etc as required in line with Pre-Qualification criteria.  It shall be specifically noted that all documents as per above shall be indexed properly and credential certificates issued by clients shall distinctly bear the name of organization, contact ph no, FAX no, etc.	
iv.	All Amendments/Correspondences/Corrigenda/Clarifications/Changes/ Errata etc pertinent to this NIT.	
v.	Integrity Pact Agreement (Duly signed by the authorized signatory)	If applicable
vi.	Duly filled-in annexures, formats etc as required under this Tender Specification/NIT	
vii.	Notice inviting Tender (NIT)	
viii.	Volume – I A : Technical Conditions of Contract (TCC) consisting of Scope of work, Technical Specification, Drawings, Procedures, Bill of Quantities, Terms of payment, etc	
ix.	Volume – I B : Special Conditions of Contract (SCC)	
x.	Volume – I C : General Conditions of Contract (GCC)	
xi.	Volume – I D : Forms & Procedures	
xii.	Volume – II (UNPRICED – without disclosing rates/price, but mentioning only 'QUOTED' or 'UNQUOTED' against each item	
xiii.	Any other details preferred by bidder with proper indexing.	

	<b>PART-I B</b>	
	<b><u>ENVELOPE – II superscribed as:</u></b> PART-I (EMD/COST of TENDER) TENDER NO : NAME OF WORK : PROJECT: DUE DATE OF SUBMISSION:  <b><u>CONTAINING THE FOLLOWING:-</u></b>	
i.	1. Earnest Money Deposit (EMD) in the form as indicated in this Tender <b>OR</b> Documentary evidence for 'One Time EMD' with the Power Sector Region of BHEL floating the Tender  2. Cost of Tender ( Demand Draft or copy of Cash Receipt as the case may be)	

	<b>PART-II</b>	
	<b>PRICE BID</b> consisting of the following shall be enclosed	
	<b><u>ENVELOPE-III</u></b> superscribed as: PART-II (PRICE BID) TENDER NO : NAME OF WORK : PROJECT: DUE DATE OF SUBMISSION:  <b><u>CONTAINING THE FOLLOWING</u></b>	
i	Covering letter/Offer forwarding letter of Tenderer enclosed in Part-I	
ii	Volume II – PRICE BID ( Duly Filled in Schedule of Rates – rate/price to be entered in words as well as figures)	



**BHEL PSWR  
Notice Inviting Tender**

**Tender Specification No: BHE/PW/PUR/WNT2-PEB BLD/1352**

**Page 9 of 46**

\*\*\*\*\*

	<b>OUTER COVER</b>	
	<b>ENVELOPE-IV (MAIN ENVELOPE / OUTER ENVELOPE)</b> superscribed as: TECHNO-COMMERCIAL BID, PRICE BID & EMD TENDER NO: NAME OF WORK: PROJECT: DUE DATE OF SUBMISSION:  <b>CONTAINING THE FOLLOWING:</b>	
i	<ul style="list-style-type: none"> <li>○ Envelopes I</li> <li>○ Envelopes II</li> <li>○ Envelopes III</li> </ul>	

**SPECIAL NOTE :** All documents/ annexures submitted with the offer shall be properly annexed and placed in respective places of the offer as per enclosure list mentioned in the covering letter. BHEL shall not be responsible for any missing documents.

- 7.0 Deviation with respect to tender clauses and additional clauses/suggestions in Techno-commercial bid / Price bid shall NOT be considered by BHEL. Bidders are requested to positively comply with the same.
- 8.0 BHEL reserves the right to accept or reject any or all Offers without assigning any reasons thereof. BHEL also reserves the right to cancel the Tender wholly or partly without assigning any reason thereof. Also BHEL shall not entertain any correspondence from bidders in this matter (except for the refund of EMD).
- 9.0 VOID:**
- 10.0 Since the job shall be executed at site, bidders must visit site/ work area and study the job content, facilities available, availability of materials, prevailing site conditions including law & order situation, applicable wage structure, wage rules, etc before quoting for this tender. They may also consult this office before submitting their offers, for any clarifications regarding scope of work, facilities available at sites or on terms and conditions.
- 11.0 For any clarification on the tender document, the bidder may seek the same in writing or through e-mail, as per specified format, within the scheduled date for seeking clarification, from the office of the undersigned. BHEL shall not be responsible for receipt of queries after due date of seeking clarification due to postal delay or any other delays. Any clarification / query received after last date for seeking clarification may not be normally entertained by BHEL and no time extension will be given.
- 12.0 BHEL may decide holding of pre-bid discussion [PBD] with all intending bidders as per date indicated in the NIT. The bidder shall ensure participation for the same at the appointed time, date and place as may be decided by BHEL. Bidders shall plan their visit accordingly. The outcome of pre-bid discussion (PBD) shall also form part of tender.
- 13.0 In the event of any conflict between requirement of any clause of this specification/ documents/drawings/data sheets etc or requirements of different codes/standards specified, the same to be brought to the knowledge of BHEL in writing for clarification before due date of seeking clarification (whichever is applicable), otherwise, interpretation by BHEL shall prevail. Any typing error/missing pages/ other clerical errors in the tender documents, noticed must be pointed out before pre-bid meeting/submission of offer, else BHEL's interpretation shall prevail.

**BHEL PSWR**  
**Notice Inviting Tender**

**Tender Specification No: BHE/PW/PUR/WNT2-PEB BLD/1352**

**Page 10 of 46**

\*\*\*\*\*

- 14.0 Unless specifically mentioned otherwise, bidder's quoted price shall be deemed to be in compliance with tender including PBD.
- 15.0 Bidders shall submit Integrity Pact Agreement (Duly signed by authorized signatory who signs in the offer), if applicable, along with techno-commercial bid. This pact shall be considered as a preliminary qualification for further participation. **The names and other details of Independent External Monitor (IEM) for the subject tender is as given at point (1) above.**
- 16.0 The Bidder has to satisfy the Pre Qualifying Requirements stipulated for this Tender in order to be qualified. The Price Bids of only those bidders will be opened who will be qualified for the subject job on the basis of satisfying the Pre Qualification Criteria specified in this NIT as per Annexure-I (as applicable), past performance etc. and date of opening of price bids shall be intimated to only such bidders. BHEL reserves the right not to consider offers of parties under HOLD.
- 17.0 In case BHEL decides on a 'Public Opening', the date & time of opening of the sealed PRICE BID shall be intimated to the qualified bidders and in such a case, bidder may depute one authorised representative to witness the price bid opening. BHEL reserves the right to open 'in-camera' the 'PRICE BID' of any or all Unsuccessful/Disqualified bidders under intimation to the respective bidders.
- 18.0 Validity of the offer shall be for **six months** from the latest due date of offer submission (including extension, if any) unless specified otherwise.
- 19.0 BHEL reserves the right to decide the successful bidder on the basis of Reverse Auction process. In such case all qualified bidders will be intimated regarding procedure/ modality for Reverse Auction process prior to Reverse Auction and price will be decided as per the rules for Reverse Auction. .
- However, if reverse auction process is unsuccessful as defined in the RA rules/procedures, or for whatsoever reason, then the sealed 'PRICE BIDS' will be opened for deciding the successful bidder. BHEL's decision in this regard will be final and binding on bidder.
- 20.0 On submission of offer, further consideration will be subject to compliance to tender & qualifying requirement and customer's acceptance, as applicable.
- 21.0 In case the bidder is an "Indian Agent of Foreign Principals", 'Agency agreement has to be submitted along with Bid, detailing the role of the agent along with the terms of payment for agency commission in INR, along with supporting documents.
- 22.0 The bidders shall not enter into any undisclosed M.O.U. or any understanding amongst themselves with respect to tender.
- 23.0 Consortium Bidding (or Technical Tie up) shall be allowed only if specified in Pre Qualifying Requirement (PQR) criteria, and in such a case the following shall be complied with:
- 23.1 Prime Bidder and Consortium Partner or partners are required to enter into a consortium agreement with a validity period of six months initially. In case the consortium is awarded the contract, then the Consortium Agreement between the Prime Bidder and Consortium Partner or partners shall be extended till contractual completion period including extension periods if any applicable.
- 23.2 'Stand alone' bidder cannot become a **'Prime Bidder' or a 'Consortium bidder' or 'Technical Tie up bidder' in a consortium (or Technical Tie up) bidding.** Prime bidder shall neither be a consortium partner to other prime bidder nor take any other consortium partners. However, consortium partner may enter into consortium agreement with other prime bidders. In case of non compliance, consortium bids of such Prime bidders will be rejected.

**BHEL PSWR**  
**Notice Inviting Tender**

**Tender Specification No: BHE/PW/PUR/WNT2-PEB BLD/1352**

**Page 11 of 46**

\*\*\*\*\*

- 23.3 Number of partners for a consortium Bidding (or Technical Tie up) shall be as specified in the PQR
- 23.4 Prime Bidder shall be as specified in the Pre Qualification Requirement, else the bidder who has the major share of work
- 23.5 In order to be qualified for the tender, Prime Bidder and Consortium partner or partners shall satisfy (i) the Technical 'Pre Qualifying Requirements' specified for the respective package, (ii) "Assessment of Capacity of Bidder" as specified in clause 9.0
- 23.6 Prime Bidder shall comply with additional 'Technical' criteria of PQR as defined in 'Explanatory Notes for the PQR'
- 23.7 Prime Bidder shall comply with all other Pre Qualifying criteria for the Tender unless otherwise specified
- 23.8 In case customer approval is required, then Prime Bidder and Consortium Partner or partners shall have to be individually approved by Customer for being considered for the tender.
- 23.9 Prime Bidder shall be responsible for the overall execution of the contract
- 23.10 In case of award of job, Performance shall be evaluated for Prime Bidder and Consortium Partner or partners for their respective scope of work(s) as per prescribed formats
- 23.11 In case the Consortium partner or partners back out, their SDs shall be encashed by BHEL. In such a case, other consortium partner or partners meeting the PQR have to be engaged by the Prime Bidder, and if not, the respective work will be withdrawn and executed on risk and cost basis of the Prime Bidder. The new consortium partner or partners shall submit fresh SDs as applicable.
- 23.12 In case the prime Bidder withdraws, the whole contract shall be considered cancelled and short closed.
- 23.13 After execution of work, the work experience shall be assigned to the Prime Bidder and the consortium partner or partners for their respective scope of work. After successful execution of two similar works with the same consortium partner or partners under direct orders of BHEL, the Prime Bidder shall be eligible for becoming a 'stand alone' bidder for similar works, subject to certification from BHEL about the active involvement of the Prime Bidder for satisfactory execution of the works.
- 23.14 The consortium partner shall submit SD equivalent to 2% of the total contract value in addition to the SD to be submitted by the prime Bidder for the total contract value. In case there are two consortium partners, then each partner shall submit SD equivalent to 1% of the total contract value in addition to the SD to be submitted by the prime Bidder for the total contract value.
- 23.15 In case of a Technical Tie up, all the clauses applicable for the Consortium partner shall be applicable for the Technical Tie up partner also
- 24.0 The bidder shall submit documents in support of possession of 'Qualifying Requirements' duly self certified and stamped by the authorized signatory, indexed and properly linked in the format for PQR. In case BHEL requires any other documents/proofs, these shall be submitted immediately.
- 25.0 The bidder may have to produce original document for verification if so decided by BHEL.
- 26.0 Order of Precedence  
In the event of any ambiguity or conflict between the Tender Documents, the order of precedence shall be in the order below:
- a. Amendments/Clarifications/Corrigenda/Errata etc issued in respect of the tender documents by BHEL

**BHEL PSWR  
Notice Inviting Tender**

**Tender Specification No: BHE/PW/PUR/WNT2-PEB BLD/1352**

**Page 12 of 46**

\*\*\*\*\*

- b. Notice Inviting Tender (NIT)
- c. Price Bid
- d. Technical Conditions of Contract (TCC)—Volume-1A
- e. Special Conditions of Contract (SCC) —Volume-1B
- f. General Conditions of Contract (GCC) —Volume-1C
- g. Forms and Procedures —Volume-1D

It may please be noted that guidelines/rules in respect of suspension of business dealings', 'Vendor evaluation format', 'Quality, Safety & HSE guidelines', etc may undergo change from time to time and the latest one shall be followed

for BHARAT HEAVY ELECTRICALS LTD

AGM Pur

**Enclosure**

1. Annexure-1: Pre Qualifying criteria.
2. Annexure-2: Check List .
3. Annexure-3: Important Information .
4. Other Tender documents as per this NIT.

**BHEL PSWR**  
**Notice Inviting Tender**

**Tender Specification No: BHE/PW/PUR/WNT2-PEB BLD/1352**

**Page 13 of 46**

\*\*\*\*\*

**ANNEXURE - 1**

**PRE QUALIFYING CRITERIA**

<b>JOB</b>	<p><b>A) Supply Job:-</b> Design, Supply of pre- fabricated office building using Plastocrete panels including &amp; its supporting structure, internal &amp; external plumbing &amp; sewage connections all complete including supply of modular furnishing items, air conditioner etc. For 1 x 800 MW Wanakbori gujarat.</p> <p><b>B) E &amp; C Job:-</b> Unloading, receipt &amp; handling of all supplied material to complete Pre- Fabricated office Building; pre assembly, erection, alignment, bolting/ welding/ fastening, grouting, testing, final painting and handing over including Civil work, sewerage system, plumbing system of Pre- Fabricated office Building site of 1 X 800 MW WANAKBORI GUJARAT.</p>
<b>TENDER NO</b>	<b>BHE/PW/PUR/WNT2-PEB BLD/1352</b>

<b>SL NO</b>	<b>PRE QUALIFICATION CRITERIA</b>	<b>Bidders claim in respect of fulfilling the PQR Criteria</b>	
		<b>Name and Description of qualifying criteria</b>	<b>Page no of supporting document. Bidder must fill up this column as per applicability</b>
<b>A</b>	<p>Submission of Integrity Pact duly signed (if applicable) (Note: To be submitted by Prime Bidder &amp; Consortium/Technical Tie up partner jointly in case Consortium bidding is permitted, otherwise by the sole bidder)</p>	<b>Not APPLICABLE</b>	
<b>B</b>	<p><b><u>Technical</u></b> Bidder should have Executed the following work in Power/Industrial/Infrastructure Projects in the last two (2) years as on latest date of offer submission:</p> <p><b><u>B.1:</u></b> Bidder should have executed (Supply and Construction) at least ONE Pre-engineered/ Pre-fabricated Shed of area 550 SQM or above against single work order.</p>	<b>APPLICABLE</b>	

**BHEL PSWR**  
**Notice Inviting Tender**

**Tender Specification No: BHE/PW/PUR/WNT2-PEB BLD/1352**

**Page 14 of 46**

\*\*\*\*\*

C-1	<b><u>Financial TURNOVER</u></b> Bidders must have achieved an average annual financial turnover (Audited) of <b>Rs 202.50 Lakhs or more</b> over last three Financial Years (FY) i.e. 2011-2012, 2012-2013, 2013-14.	APPLICABLE	
C-2	<b><u>NETWORTH</u></b> (only in case of Companies) Net worth of the Bidder based on the latest Audited Accounts as furnished for 'C-1' above should be positive	APPLICABLE	
C-3	<b><u>PROFIT</u></b> Bidder must have earned cash profit in any one of the three Financial Years as applicable in the last three Financial Years defined in 'C-1' above based on latest Audited Accounts.	APPLICABLE	
D	Assessment of Capacity of Bidder to execute the work as per sl no 9 of NIT (if applicable)	NOT APPLICABLE	By BHEL
E	Approval of Customer (if applicable)  <b>Note:</b> Names of bidders (including consortium/Technical Tie up partners in case consortium bidding is permitted) who stand qualified after compliance of criteria A to D shall be forwarded to customer for their approval.	NOT APPLICABLE	BY BHEL
F	Price Bid Opening <b>Note:</b> Price Bids of only those bidders shall be opened who stand qualified after compliance of criteria A to E	APPLICABLE	BY BHEL
F	Technical Tie up criteria (if applicable)	NOT APPLICABLE	
<p><b><u>Explanatory Notes for the PQR (unless otherwise specified in the PQR):</u></b></p> <ol style="list-style-type: none"> <li>1. Bidder to submit Audited Balance Sheet and Profit and Loss Account for the respective years as indicated against C-1 above along with all annexures</li> <li>2. In case audited Financial statements have not been submitted for all the three years as indicated against C-1 above, then the applicable audited statements submitted by the bidders against the requisite three years, will be averaged for three years i.e total divided by three.</li> <li>3. C-2:-NETWORTH : Shall be calculated based on the latest Audited Accounts as furnished for C-1 above. Net worth = Paid up share capital + Reserves. (Net worth is required to be evaluated in case of companies)</li> <li>4. C-3:- PROFIT : shall be NET profit (PAT + Non cash expenditure viz depreciation) earned during any one of the three financial years as in C-1 above</li> <li>5. <b>'EXECUTED'</b> means the Vendor should have achieved the criteria specified in the Technical criteria of PQR (as in 'B' above) even if the Contract has not been completed or closed</li> <li>6. The value of work (Experience submitted against PQR B) shall be updated as per the PVC indices</li> </ol>			

**BHEL PSWR**  
**Notice Inviting Tender**

**Tender Specification No: BHE/PW/PUR/WNT2-PEB BLD/1352**

**Page 15 of 46**

\*\*\*\*\*

	for “All India Avg. Consumer Price Index for Industrial Workers” with base month as date of execution (completion of contract/work) and indexed upto two months prior to bid opening month.
--	---

BIDDER SHALL SUBMIT ABOVE PRE-QUALIFICATION CRITERIA FORMAT, DULY FILLED-IN, SPECIFYING RESPECTIVE ANNEXURE NUMBER AGAINST EACH CRITERIA AND FURNISH RELEVANT DOCUMENT IN THE RESPECTIVE ANNEXURES IN THEIR OFFER.

**BHEL PSWR**  
**Notice Inviting Tender**  
**Tender Specification No: BHE/PW/PUR/WNT2-PEB BLD/1352**

Page 16 of 46

\*\*\*\*\*

**ANNEXURE - 2**

**CHECK LIST**

**NOTE:- Tenderers are required to fill in the following details and no column should be left blank**

1	Name and Address of the Tenderer		
2	Details about type of the Firm/Company		
3.a	Details of Contact person for this Tender	Name : Mr/Ms Designation: Telephone No: Mobile No: Email ID: Fax No:	
3.b	Details of alternate Contact person for this Tender	Name : Mr/Ms Designation: Telephone No: Mobile No: Email ID: Fax No:	
4	EMD DETAILS	DD No:                      Date : Bank :                      Amount: Please tick ( <input checked="" type="checkbox"/> ) whichever applicable:- ONE TIME EMD / ONLY FOR THIS TENDER	
5	Validity of Offer	TO BE VALID FOR SIX MONTHS FROM DUE DATE	
		APPLICABILITY( BY BHEL)	ENCLOSED BY BIDDER
6	Whether the format for compliance with <b>PRE QUALIFICATION CRITERIA</b> (ANNEXURE-I) is understood and filled with proper supporting documents referenced in the specified format	Applicable	YES / NO
7	Audited profit and Loss Account for the last three years	Applicable/ <del>Not Applicable</del>	YES/NO
8	Copy of PAN Card	Applicable/ <del>Not Applicable</del>	YES/NO
9	Whether all pages of the Tender documents including annexures, appendices etc are read understood and signed	Applicable/ <del>Not Applicable</del>	YES/NO
10	Integrity Pact	Not Applicable	YES/NO
11	Declaration by Authorised Signatory	Applicable/ <del>Not Applicable</del>	YES/NO
12	No Deviation Certificate	Applicable/ <del>Not Applicable</del>	YES/NO



**BHEL PSWR  
Notice Inviting Tender**

**Tender Specification No: BHE/PW/PUR/WNT2-PEB BLD/1352**

**Page 17 of 46**

\*\*\*\*\*

13	Declaration confirming knowledge about Site Conditions	Applicable/ <del>Not Applicable</del>	YES/NO
14	Declaration for relation in BHEL	Applicable/ <del>Not Applicable</del>	YES/NO
15	Non Disclosure Certificate	Applicable/ <del>Not Applicable</del>	YES/NO
16	Bank Account Details for E-Payment	Applicable/ <del>Not Applicable</del>	YES/NO
17	Capacity Evaluation of Bidder for current Tender	Applicable/ <del>Not Applicable</del>	YES/NO
18	Tie Ups/Consortium Agreement are submitted as per format	Applicable/ <del>Not Applicable</del>	YES/NO
19	Power of Attorney for Submission of Tender/Signing Contract Agreement	Applicable/ <del>Not Applicable</del>	YES/NO
20	Analysis of Unit rates	Applicable/ <del>Not Applicable</del>	YES/NO

NOTE : STRIKE OFF 'YES' OR 'NO', AS APPLICABLE. TENDER NOT ACCOMPANIED BY THE PRESCRIBED **ABOVE APPLICABLE DOCUMENTS** ARE LIABLE TO BE SUMMARILY REJECTED.

**DATE :  
SIGNATORY**

**AUTHORISED**  
**(With Name, Designation and Company seal)**

Annexure-3

## IMPORTANT INFORMATION

1. The offers of the bidders who are on the banned list as also the offer of the bidders, who engage the services of the banned firms, shall be rejected. The list of banned firms is available on BHEL web site ( [www.bhel.com](http://www.bhel.com) ---> Tender Notification -> List of Banned Firms )
2. All Statutory Requirements as applicable for this project shall be complied with.
3. Please take note of following Revised Tender Clauses:
  - i. Notice Inviting Tender: SI No 9
  - ii. General conditions of Contract: Clause No 1.15.13 (New), Clause No 2.8.3, 2.8.4 and 2.8.5
4. Following Notes are added to Form F- 15 of Volume I D 'Forms & procedures'
  - i. It is only indicative and shall be as per the online format issued by BHEL time to time.
  - ii. No request will be entertained after specified date of the current month w.r.t the changes requested in the scores of immediate previous month.
5. **General:**
  1. Prices for entire scope of work has been invited on lumpsum basis.
  2. Entire scope of work has been split in two parts viz. "Design and Supply portion" and "E&C Portion"
  3. As per Chapter-VII Terms of payments Vol-IA TCC 70% of total quoted price shall be considered for "Design and Supply portion" of work and 30% of total quoted price shall be considered for "E&C Portion".
6. **PRICE VARIATION CLAUSE**

Price Variation Compensation Clause no. 2.17 of Vol I C GCC shall not be Applicable:
7. **OVER RUN COMPENSATION**

Over Run Compensation Clause no. 2.12 of Vol I C GCC shall not be Applicable
8. **Broad Terms & Conditions of Reverse Auction**

**BHEL PSWR**  
**Notice Inviting Tender**

**Tender Specification No: BHE/PW/PUR/WNT2-PEB BLD/1352**

**Page 19 of 46**

\*\*\*\*\*

In continuation to Clause 19.0 of NIT (Notice Inviting Tender) following are the broad terms and conditions of Reverse Auction is given in Annexure V of NIT:

- 8.1. Against this enquiry for the subject item/ system with detailed scope of supply as per enquiry specifications, BHEL may resort to “REVERSE AUCTION PROCEDURE” i.e., ON LINE BIDDING (THROUGH A SERVICE PROVIDER). The philosophy followed for reverse auction shall be English Reverse (No ties).
- 8.2. BHEL reserves the right to go for Reverse Auction (RA) instead of opening the sealed envelope price bid, submitted by the bidder. This will be decided after techno-commercial evaluation. All bidders to give their acceptance for participation in RA. Non-acceptance to participate in RA may result in non-consideration of their bids. In case BHEL decides to go for Reverse Auction, only those bidders who have given their acceptance to participate in RA will be allowed to participate in the Reverse Auction. Those bidders who have given their acceptance to participate in Reverse Auction will have to necessarily submit „online sealed bid” in the Reverse Auction. Non-submission of „online sealed bid” by the bidder will be considered as tampering of the tender process and will invite action by BHEL as per extant guidelines in vogue.
- 8.3. For the proposed reverse auction, technically and commercially acceptable bidders only shall be eligible to participate.
- 8.4. Those bidders who have given their acceptance for Reverse Auction (quoted against this tender enquiry) will have to necessarily submit ‘online sealed bid’ in the Reverse Auction. Non-submission of ‘online sealed bid’ by the bidder for any of the eligible items for which techno-commercially qualified, will be considered as tampering of the tender process and will invite action by BHEL as per extant guidelines in vogue.
- 8.5. BHEL will engage the services of a service provider who will provide all necessary training and assistance before commencement of on line bidding on internet.
- 8.6. In case of reverse auction, BHEL will inform the bidders the details of Service Provider to enable them to contact & get trained.
- 8.7. Business rules like event date, time, bid decrement, extension etc. also will be communicated through service provider for compliance.
- 8.8. Bidders have to fax the Compliance form (annexure IV) before start of Reverse auction. Without this, the bidder will not be eligible to participate in the event.
- 8.9. In line with the NIT terms, BHEL will provide the calculation sheet (e.g., EXCEL sheet) which will help to arrive at “Total Cost to BHEL” like Packing & forwarding charges, Taxes and Duties, Freight charges, Insurance, Service Tax for Services and loading factors (for noncompliance to BHEL standard Commercial terms & conditions) for each of the bidder to enable them to fill-in the price and keep it ready for keying in during the Auction.
- 8.10. Reverse auction will be conducted on scheduled date & time.

**BHEL PSWR**  
**Notice Inviting Tender**

**Tender Specification No: BHE/PW/PUR/WNT2-PEB BLD/1352**

**Page 20 of 46**

\*\*\*\*\*

- 8.11. At the end of Reverse Auction event, the lowest bidder value will be known on auction portal.
- 8.12. The lowest bidder has to fax/e-mail the duly signed and filled-in prescribed format for price breakup including that of line items, if required, (Annexure VII) as provided on case-to-case basis to Service provider within two working days of Auction without fail.
- 8.13. In case BHEL decides not to go for Reverse Auction procedure for this tender enquiry, the Price bids and price impacts, if any, already submitted and available with BHEL shall be opened as per BHEL's standard practice.
- 8.14. Bidders shall be required to read the "Terms and Conditions" section of the auctions site of Service provider, using the Login IDs and passwords given to them by the service provider before reverse auction event. Bidders should acquaint themselves of the "Business Rules of Reverse Auction", which will be communicated before the Reverse Auction.
- 8.15. If the Bidder or any of his representatives are found to be involved in Price manipulation/ cartel formation of any kind, directly or indirectly by communicating with other bidders, action as per extant BHEL guidelines, shall be initiated by BHEL and the results of the RA scrapped/ aborted.
- 8.16. The Bidder shall not divulge either his Bids or any other exclusive details of BHEL to any other party.
- 8.17. In case BHEL decides to go for reverse auction, the H1 bidder (whose quote is highest in online sealed bid) may not be allowed to participate in further RA process.

# TECHNICAL CONDITIONS OF CONTRACT (TCC)

BHARAT HEAVY ELECTRICALS LIMITED



# TECHNICAL CONDITIONS OF CONTRACT (TCC)

## CONTENTS

---

<b>Sl no</b>	<b>Description</b>	<b>Chapter</b>	<b>No. Of pages</b>
<b>Volume-ia</b>	<b>Part-i: contract specific details</b>		
1	Project information	CHAPTER-I	1
2	Scope of works	CHAPTER-II	9
3	Facilities in the scope of contractor/BHEL (scope matrix)	CHAPTER-III	7
4	T&Ps and MME'S to be deployed by contractor	CHAPTER-IV	1
5	T&Ps and MME'S to be deployed by BHEL	CHAPTER-V	1
6	Time schedule	CHAPTER-VI	1
7	Terms of payment	CHAPTER-VII	1
8	Taxes and other duties	CHAPTER-VIII	3

# TECHNICAL CONDITIONS OF CONTRACT (TCC)

## Chapter - I : Project Information

	Project Information
1.1	<p><b><u>LOCATION AND APPROACH:</u></b></p> <p><b>Location :</b> Wanakbori, District-Kheda, Gujarat</p> <p><b>Nearest Railway Station :</b>Sevaliya (8KM) – Anand-Godhra main line</p> <p><b>Nearest Airport :</b> Vadodara (85 KM from site), Ahmadabad (100 KM from site)</p> <p><b>Nearest Sea Port :</b>Kandla</p> <p><b>Access By Road :</b> 10KM from Dakor-Godhra NH No. 8, 02 KM from Balasinor-Sevaliya SH No. 59</p> <p><b>Major Towns/Cities:</b> 13 KM from Balasinor and 10KM from sevaliya.</p> <p><b>Land:</b> Within existing Thermal Power Station. North-East side of the existing plot.</p> <p><b>Source Of Coal:</b> Indian coal sourced from captive mines Machha in Talchar,Orissa.</p> <p><b>Source Of Water:</b> River Mahi, flowing by side of existing Wanakbori Power Station.</p>
1.2	<p><b>CLIMATIC CONDITIONS:</b></p> <ol style="list-style-type: none"><li>1) Maximum ambient Temperature: 40.8 degree Centigrade</li><li>2) Minimum ambient Temperature: 10.8 degree Centigrade</li><li>3) Seismic Zone : Part 3, Zone-III as per IS:1893/84</li><li>4) Relative Humidity: 81.5 %</li><li>5) Wind Speed: 39m/sec</li></ol>

**The bidder is advised to visit and examine the site of works and its surroundings and obtain for himself on his own responsibility all information that may be necessary for preparing the bid and entering into the contract. All costs for and associated with site visits shall be borne by the bidder.**

# TECHNICAL CONDITIONS OF CONTRACT (TCC)

## Chapter – II : Scope of work

---

### 2.0 Scope of work

#### Office complex of following sizes

##### A.BHEL OFFICE:-

- 1) BHEL PSWR OFFICE:- 550 SQM
- 2) ALSTOM & SIEMEN OFFICE:-72 SQM
- 3) BHEL ISG OFFICE:- 110 SQM
- 4) BHEL TBG OFFICE:-55 SQM

##### B. CUSTOMER OFFICE:-

- 1) GSECL OFFICE-325.16 SQM

**CLEAR HEIGHT:** Between FFL & Bottom of truss (if any)/ Structural Member (if any) – 3.0 M.

**COLUMN SPACING:** 3.0 M (RECOMMENDED) on both longer & shorter side C/c. However suitable spacing can be provided as per design.

Bidder to freeze layout drawing in consultation of BHEL after award of contract.

This specification covers Design, Manufacturing, Supply, Receipt at Site, Erection & Finishing works if any etc and Handing over to site Pre- fabricated OFFICE BUILDING using PLASTOCRETE PANELS including Foundation, Electricals, Furniture, Sanitary, Septic tank, water tank & its supporting structure, internal & external plumbing & sewage connections all complete. This also includes guarantee for 1 year of Operations for the design performance, materials supplied & erected by him covered under the scope of the contract.

Entire civil work like excavation, foundation, etc. required for building office is under



# TECHNICAL CONDITIONS OF CONTRACT (TCC)

## Chapter – II : Scope of work

---

The scope of the contract.

Scope of the contract is splitted into two parts.

- A) Supply
- B) E&C.

### **A) Supply Contract:**

The work to be carried out under the scope of these specifications is broadly as under:

- a. Preparation of Design and detailed drawings, bill of materials, material codification, obtaining approvals from BHEL.
- b. **Supply of MAIN STRUCTURE&WALLS:** The Structural walls shall be made out of 25mmthick Plastocrete, concrete filled, Polymeric section filled with high density cellular concrete. The fixture will join together by tongue and groove method to ensure 100% leak proof. The Outer framing structure shall be fabricated with ISMC75x40x3mm MS "T" welded for securing Plastocrete panel with the span of 1m centre to centre. The above columns will be grouted to the exiting PCC flooring by means of expansion fasteners. Outer Doors shall be of molded FRP with necessary hinges, handle and pad locks. The aluminum windows with grills shall be of sliding type, covered with float glass of 4mm thick. The entrance will be provided with 2nos -portico should have a aesthetic look of size min 4m X 3m. The outer framing column will be covered with polymeric sleeve for protecting from weather and inner columns End will be covered similar polymeric sleeve matching with the interior complete
- c. **Supply of ROOF System:** Roof truss should be made up of anti corrosive painted 40mm square Tubular section designed to suit at roof structure with 0.47mm thick pre-coated profiled GI (ie. PPGI) roof sheet fixed with fasteners including gutters, rain water down pipes/spouts etc all complete.
- d. **Supply of FALSE CEILING System:** False ceiling shall be provided to entire office area including corridors etc excluding toilet block. Frame works made out of anti corrosive painted GI grid work with 250 x 6mm thick polymeric panels and these panels are joined together by tongue and groove using self tapping screws. Cutouts should be made where ever necessary for Fixing of electrical fittings.

**PARTITION:** Double side partition made up of anti corrosive painted 25 x 50mm MS and double side paneling with polymeric section of minimum 250x6 mm with an air gap of minimum 4 mm these panels are joined together by tongue and groove sing self tapping screws.

#### **MODULAR FURNISHINGS:**

Providing 1-maestro type table for Site in-charge including fixed side return table, mobile pedestal,

- 1. Conference hall table of 41 people capacity

# TECHNICAL CONDITIONS OF CONTRACT (TCC)

## Chapter – II : Scope of work

---

2. Modular Office type Cubicle including part cabins- 1200mm X 750mm with Necessary file storage racks, supporting pedestal, Keyboard tray, CPU trolley etc.
3. Chairs for senior executives
4. Chairs for executives
5. Chairs for visitors
6. Three, single seater sofa
7. tea-poy etc required, as per schematic drawing etc all complete.
  
8. Cabinets for files of push-pull type in steel including channels for smooth mounting, end stoppers, label holder, proper locking arrangement etc. as per approved drawing

Quantities of furniture should be as per tentative layout and BOQ.BHEL reserves the right to increase or decrease as per final approved layout drawing.

### Supply of DOOR & WINDOWS:

Internal doors Polymeric with half paneled smog glass. All external doors with Solid core PVC panel door. All doors to be provided with suitable hydraulic door closures of approved make. Windows shall be provided with aluminum type with grill and sunshade. However suitable no-of Windows shall be provided for enough ventilation & natural light.

**AIR CONDITIONING:** Supply of Split Air-conditioner shall be provided with a minimum capacity of 1 Ton and above for every 100Sq.ft area with complete installation including ancillary works, testing and commissioning as per manufacturers guidelines and specification. Design may be considered with a combination of 1 Ton, 1.5 Ton & 2 Ton preferably.

**FLOORING:** Supply of Office flooring shall be of Vitrified floor tiles 600x600mm of (min 8mm thick) 1st quality conforming to IS:15622 of approved make in colours such as White, Ivory, Grey, Fume Red Brown, to be laid on 20mm thick cement mortar 1:4 (1 cement : 4 coarse sand) including pointing the joints with white cement and matching pigment etc all complete. Toilet and passage flooring shall be of antiskid ceramic tile of size 300x300mm of thickness (min- 6mm) to be placed as mentioned above.

**ELECTRICAL & NETWORKING SYSTEM:-**Providing all Electrical fitting and Network system as per approved drawing. Bidder to supply electrical items like Main switch with Earth leakage protection (30A TPN), suitable sockets/switch units for required A/C points, wires, conduit, tees, bends,

# TECHNICAL CONDITIONS OF CONTRACT (TCC)

## Chapter – II : Scope of work

---

clamps, JB's, 5amps socket, Modular Switch boards & points for computers & telephone for each table/desk, earthing wires, Lighting system shall be designed to meet minimum 300Lux of modular type suitable for False ceilings. Also, the bidder should take care of aesthetics and energy conservation. A detailed schematic with BOM (brands/makes) of the electrical fittings shall be submitted to BHEL for approval before execution.

Delivering Supply item to Wanakbori project site as per specification, drawings and instructions of the Engineer.

### **B) E & C Contract:**

- a. Unloading, receipt, verifying, stacking, stock keeping, shifting, preservation & handling of supplied material using bidders own T & P and manpower at Wanakbori Project Site.
- b. Entire civil work like excavation, foundation, Toilet, Plumbing, Sewerage system etc. required for building office.
- c. Construction of Soak Pit and Septic Tank of Desired capacity.
- d. Construction of Lawn/Garden area.
- e. Pre- assembly, erection and installation of main structure, wall, Roof System, False ceiling, door window, partition, AC, Modular furniture, Electrical and Networking System etc including its alignment, bolting/ welding/ fastening, grouting, Commissioning as per approved Drawing /BHEL requirement etc.
- f. Installation of temporary structures (Scaffolding, Access ladders, Working Platforms etc.), Complete with all labour, electrodes and other consumables.
- g. Installation of all items required to complete office Building in totality.
- h. Material Re – conciliation and completion of facility include handing over of Pre – Engineered building as per specification, drawings and instructions of the Engineer.

### **TOILET:**

All toilets should have required towel rods, soap dispensers, glazed mirrors etc with Automatic flushing System including total required plumbing.

**Nos of toilet and its constituent is given in tentative drawing and BOQ. Bidder to get clearance from Engineer in charge before installing toilet complex. BHEL decision will be final.**

**WATER SUPPLY:** A separate structure shall be provided with steel sections to Support 1 no. 10000 litre water tank at a minimum height of 4m. The structure Shall be designed with steel as per standard IS specification to withstand the

# TECHNICAL CONDITIONS OF CONTRACT (TCC)

## Chapter – II : Scope of work

---

Water tank load and wind load in full & the legs of structure shall be suitably Anchored to the ground.

**SEWAGE CONNECTION:** Sanitary fitting along with sewage connections shall be Provided up to septic tank and soakpit. All internal and external plumbing (from Water tank to distribution system like toilet and pantry) shall be provided as per .

IMPORTANT NOTE:-DRAWING AND BOQ GIVEN IN TENDER IS INDICATIVE AND TENTATIVE ONLY.BIDDER TO GET APPROVAL OF DRAWING AND BBU AFTER AWARD OF WORK.

### **SALIENT TECHNICAL REQUIREMENTS**

**2.1** All design work of prefabricated office sheds shall have to be vetted by civil design agency of repute/ Civil Engineering department of reputed engineering college like IITs.

**2.2** Typical foundation drawing is enclosed. However, foundation should be designed for actual site conditions. Before starting the work the Vendor has to visit site to collect actual information. Bidder to take care of all Indian soil conditions while designing foundation. No extra cost shall be paid for any change in foundation.

**2.3** All designs have to be carried out as per relevant IS/International codes.

**2.4** Since these are detachable sheds & to be in repetitive use at other locations, proper marking (permanent) shall be made for identification to ease re-erection. The shed shall be so designed that it can be dismantled at any time and may be transported to be re-erected at other location.

**2.5** The roof truss should have bolted joints at crown /at both ends. Both roof and side cladding are to be made “Water Tight”.

**2.6** The bidder should submit a guarantee for 1 year of operations for the Materials supplied and erected by him.

**2.7** Agency shall submit two sets of proposed drawings of office along with foundation, Furniture arrangements, Electrical, Plumbing & other fittings etc., to BHEL before Commencement of work for approval within ten days from the receipt of LOI.

**2.8** Bidder shall submit five sets of proposed drawings of the shed to BHEL before Commencement of work. Five sets of final drawings, along with one soft copy in CD and one reproducible, shall be handed over to BHEL immediately after Finalization of design.

**2.9** Bidders should take care of all Indian site conditions, prevailing local laws etc. No claim shall be entertained to lack of knowledge of site condition.

**2.10** After completion of work, the building and areas around it should be cleared of

# TECHNICAL CONDITIONS OF CONTRACT (TCC)

## Chapter – II : Scope of work

---

all rubbish, debris etc. and handed over in fit condition for occupation.

### **3.0 SPECIFIC TECHNICAL REQUIREMENT FOR ERECTION AT SITE TECHNICAL INSTRUCTIONS**

3.1 The materials and workmanship must be of good quality and accepted standards and specifications. The site Engineer reserves the right to reject any material not up to the specification.

### **4.0 DRAWINGS**

4.1 The following drawings are enclosed strictly for the guidance of the bidder:

4.1.1 a) Schematic sketch of OFFICE BUILDING

b) Furniture Drawing

4.2 The following drawings are required to be submitted by the bidder for approval along With offer:

4.2.1 a) Schematic sketch of OFFICE BUILDING

b) Furniture Drawing

4.3 The following drawings are required to be submitted by the bidder for approval after Award.

4.3.1 a) Water supply and Sanitary system- Layout

b) Septic tank & water tank structure

c) Details of plinth

d) Details of footing

e) Footing cross sectional view

f) Plinth and footing cross sectional view.

### **5.0 PREFERABLE MAKE/BRANDS FOR VARIOUS ITEMS TO BE INSTALLED**

5.1 Cladding/Roof Sheeting & Structural: Tata Blue scope/SAIL/Lloyds sheeting.

5.2 Toilet/Sanitary Items: Hindware / Parryware/ Jaguar.

5.3 AC – Voltas/LG/Hitachi

5.4 Furniture - Godrej/Wipro/BP Ergo/Hayworth

5.5 Electrical

### **Component Make**

6.5.1 LT ACB: - L&T /TM/SIEMENS/GEC ALSTOM/GE

POWER CONTROLS: - SCHNEIDER / C&S / SPACEAGE /HYUNDAI

6.5.2 Fuse Switch Unit: - ALSTOM / SIEMENS / L&T / CGL / STANDARDS / HAVELS / SCHNEIDER / C&S / GE POWER

6.5.3 MCB/MCCB STANDARD: - MDS / INDO KOPP / C&S / SIEMENS / ABB

# TECHNICAL CONDITIONS OF CONTRACT (TCC)

## Chapter – II : Scope of work

---

**6.5.4** HRC Fuses: - SIEMENS / L & T / ALSTOM / S & S / STANDARD / INDO ASIAN / HAVELS / VERSATRIP / BUSMAN / GE POWER

**6.5.5** Control switches:-SIEMENS / ALSTOM / L & T / KAYCEE

**6.5.6** Indicating lamps (LEDs):- SIEMENS / L & T / ALSTOM / TM / BINAY / TECKNIC / VAISHNO

**6.5.7** Lighting Fittings: - PHILIPS / BAJAJ / CROMPTON / CEMA / GE / MYSORE LAMPS equivalent.

**6.5.8** Switch Socket outlet:-ALSTOM / CGL / BEST & CROMPTON / ESSEN

**6.5.9** Modular switch:-ANCHOR / ELLORA / MAK ELECTRIC / ALSTOM

**6.5.10** LT Power & Control Cables:-FORT GLOSTER / ASIAN CABLES / CCI / UNIVERSAL / NICCO / DELTON CABLES / FINOLEX /INDUSTRIAL CABLES / CMI / OMEGA / RADIANT CABLES /POLYCAB / KEI/GOVIND / BRIMSON / PREMIER / PARAMOUNT /PLAZA

**6.5.11** Terminal Blocks:- ESSEN / CONNECT WELL / ELMEX / PHOENIX / WAGO

# TECHNICAL CONDITIONS OF CONTRACT (TCC)

## Chapter – II : Scope of work

---

### **Specific for Supply Contract**

#### **2.1) Procurement of materials by successful contractors and testing:**

##### **MATERIAL SUPPLY**

All the required materials to be supplied and erected by the bidder are included within the quoted cost. The use of materials shall be subject to inspection at site before erection/installation. Any damaged materials received at site shall be suitably replaced.

##### **INSPECTION, TESTING AND INSPECTION CERTIFICATES**

The engineer, his duly authorized representative and/ or an outside inspection agency acting on behalf of BHEL/ owner shall have access at all reasonable times to inspect & examine the materials & workmanship of the works during its manufacture and if part of the works is being manufactured or assembled on other premises or works, the vendor shall obtain for the engineer and for their duly authorized representative permission to inspect as if the works were manufactured or assembled on vendor's own premises or works. Necessary arrangement for carrying out inspection including supply of labour, IMTEs, area illumination and scaffolding, if required will be vendor's responsibility and same has to be carried out within the quoted price.

To facilitate advance planning of inspection in addition to giving inspection notice the vendor shall furnish quarterly inspection program indicating schedule dates of inspection at customer hold point and final inspection stages. Updated quarterly inspection plans will be made for each 3 consecutive months and shall be furnished before beginning of each calendar month.

Before any plant/ equipment leaves the place of manufacture BHEL shall be given the option of witnessing inspections & tests for compliance with specifications & related standards. The vendor shall give the engineer/ inspector 15 days written notice of any material being ready for testing. Such test shall be to the vendor's account except for the expenses of the inspector. The engineer/ inspector, unless the inspection is waived will attend such tests within 15 days of the date on which the equipment is notified as being ready for test/ inspection, failing which the vendor may proceed with test which shall be deemed to have been made in the inspector's presence and he shall forthwith forward to the Inspector duly certified copies of test reports.

The engineer or inspector shall within 15 days from the date of inspection as defined herein give notice to the vendor of any objection w.r.t. drawing/ equipment/ workmanship which in his opinion not in accordance with the specification/ contract. The vendor shall either make modification as may be necessary to meet the said objection or explain to the engineer/ inspector giving reasons that no modifications are necessary to comply with the contract.

When the factory tests have been completed at the vendor's or sub-vendor's works, the engineer or inspector shall issue a certificate to this effect within reasonable time after completion of tests but if the tests are not witnessed by the engineer or Inspector the certificate shall be issued within 15 days of the receipt of vendor's test certificate by the engineer inspector. Completion of these tests or the issue of the certificates shall not bind BHEL to accept the equipment should it on further tests after erection be found not to comply with the contract.

In all cases where the vendor provides the tests at the premises of the vendor or any sub-vendor, the vendor except where otherwise specified shall provide free of charge such items as

# TECHNICAL CONDITIONS OF CONTRACT (TCC)

## Chapter – II : Scope of work

---

labour, materials, electricity, fuel, water, stores, apparatus and instruments as may be reasonably demanded by the engineer/ inspector to carry out effectively such tests on the equipment in accordance with the contract and shall give facilities to the engineer/ inspector to accomplish testing.



**TECHNICAL CONDITIONS OF CONTRACT (TCC)**  
**Chapter – III : Facilities in the scope of Contractor/BHEL**

---

**For E & C contract:**

Sl. No	Description <b>PART I</b>	Scope / to be taken care by		Remarks
		BHEL	Bidder	
3.1	<b>ESTABLISHMENT</b>			
3.1.1	<b>FOR CONSTRUCTION PURPOSE:</b>			
a	Open space for office (as per availability)	Yes		Location will be finalized after joint survey with owner
b	Open space for storage (as per availability)	Yes		For Pre assembly only. Location will be finalized after joint survey with owner.
c	Construction of bidder's office, canteen and storage building including supply of materials and other services		Yes	
d	Bidder's all office equipments, office / store / canteen consumables		Yes	
e	Canteen facilities for the bidder's staff, supervisors and engineers etc		Yes	
f	Fire fighting equipments like buckets, extinguishers etc		Yes	
g	Fencing of storage area, office, canteen etc of the bidder		Yes	

**TECHNICAL CONDITIONS OF CONTRACT (TCC)**  
**Chapter – III : Facilities in the scope of Contractor/BHEL**

Sl. No	Description <b>PART I</b>	Scope / to be taken care by		Remarks
		BHEL	Bidder	
3.1.2	<b>FOR LIVING PURPOSES OF THE BIDDER</b>			
a	Open space for labour colony (as per availability)		Yes	
b	Labour Colony with internal roads, sanitation, complying with statutory requirements		Yes	
3.2.0	<b>ELECTRICITY</b>			
3.2.1	<b>Electricity For construction purposes only</b> of Voltage 11 KV			FREE
a	Single point source	Yes		Bidder to arrange its own Arrangement in case they are not able tap from 11 KV source or non availability of electricity at their own cost.
b	Further distribution including all materials, Energy Meter, Protection devices and its service		Yes	
c	Duties and deposits including statutory clearances if applicable		Yes	
3.2.2	<b>Electricity for the office, stores, canteen etc of the bidder</b>			
a	Single point source		<b>yes</b>	

**TECHNICAL CONDITIONS OF CONTRACT (TCC)**  
**Chapter – III : Facilities in the scope of Contractor/BHEL**

Sl. No	Description <b>PART I</b>	Scope / to be taken care by		Remarks
		BHEL	Bidder	
b	Further distribution including all materials, Energy Meter, Protection devices and its service		Yes	
c	Duties and deposits including statutory clearances if applicable		Yes	
3.2.3	<b>Electricity for living accommodation of the bidder's staff, engineers, supervisors etc</b>			
a	Single point source		Yes	
b	Further distribution including all materials, Energy Meter, Protection devices and its service		Yes	
c	Duties and deposits including statutory clearances if applicable		Yes	
3.3.0	<b>WATER SUPPLY</b>			
3.3.1	<b>For construction purposes:</b>			<b>Chargeable @ Rs 11 per Kilo liter.</b>
a	Making the water available at single point	<b>yes</b>		
b	Further distribution as per the requirement of work including supply of materials and execution		Yes	
3.3.2	Water supply for bidder's office, stores, canteen etc.			

**TECHNICAL CONDITIONS OF CONTRACT (TCC)**  
**Chapter – III : Facilities in the scope of Contractor/BHEL**

Sl. No	Description <b>PART I</b>	Scope / to be taken care by		Remarks
		BHEL	Bidder	
a	Making the water available at single point		Yes	
b	Further distribution as per the requirement of work including supply of materials and execution		Yes	
3.3.3	<b><u>Water supply for Living Purpose</u></b>			
a	Making the water available at single point		Yes	
b	Further distribution as per the requirement of work including supply of materials and execution		Yes	
3.4.0	<b>LIGHTING</b>			
a	For construction work (supply of all the necessary materials) 1. At office/storage area 2. At the preassembly area 3. At the construction site /area		Yes	
b	For construction work (execution of the lighting work/ arrangements) 1. At office/storage area 2. At the preassembly area 3. At the construction site /area		Yes	

**TECHNICAL CONDITIONS OF CONTRACT (TCC)**  
**Chapter – III : Facilities in the scope of Contractor/BHEL**

Sl. No	Description <b>PART I</b>	Scope / to be taken care by		Remarks
		BHEL	Bidder	
c	Providing the necessary consumables like bulbs, switches, etc during the course of project work		Yes	
d	Lighting for the living purposes of the bidder at the colony / quarters		Yes	
3.5.0	<b>COMMUNICATION FACILITIES FOR SITE OPERATIONS OF THE BIDDER</b>			
a	Telephone, fax, internet, intranet, e-mail etc.		Yes	
3.6.0	<b>COMPRESSED AIR wherever required for the work</b>		<b>YES</b>	
3.7.0	<b>Demobilization of all the above facilities</b>		<b>YES</b>	
3.8.0	<b>TRANSPORTATION</b>			
a	For site personnel of the bidder		Yes	
b	For bidder's equipments and consumables (T&P, Consumables etc.)		Yes	

Sl.no	Description	Scope / to be taken care by	Remarks
-------	-------------	-----------------------------	---------

**TECHNICAL CONDITIONS OF CONTRACT (TCC)**  
**Chapter – III : Facilities in the scope of Contractor/BHEL**

---

	<b>Part ii</b> <b>3.9.0 Erection facilities</b>	<b>BHEL</b>	<b>Bidder</b>	
3.9.1	Engineering works for construction:			
A	Providing the erection/fabrication drawings for all the equipments covered under this scope		<b>Yes</b>	<b>In consultation with BHEL</b>
B	Drawings for construction methods		Yes	In consultation with BHEL
C	As-built drawings – where ever deviations observed and executed and also based on the decisions taken at site- example – routing of small bore pipes		<b>Yes</b>	"
D	Shipping lists etc for reference and planning the activities		Yes	"
E	Preparation of site erection schedules and other input requirements		Yes	"
F	Review of performance and revision of site erection schedules in order to achieve the end dates and other commitments	Yes	Yes	"
G	Weekly erection schedules based on SI no. E		Yes	"
H	Daily erection / work plan based on SI no. G		Yes	"

**TECHNICAL CONDITIONS OF CONTRACT (TCC)**  
**Chapter – III : Facilities in the scope of Contractor/BHEL**

---

Sl.no	Description  Part ii  3.9.0 Erection facilities	Scope / to be taken care by		Remarks
		BHEL	Bidder	
I	Periodic visit of the senior official of the bidder to site to review the progress so that works are completed as per schedule. It is suggested this review by the senior official of the bidder should be done once in every two months.		Yes	
J	Preparation of preassembly bed		Yes	
K	Arranging the materials required for preassembly		Yes	

# TECHNICAL CONDITIONS OF CONTRACT (TCC)

## Chapter – IV: T&Ps and MMEs to be deployed by Contractor

---

BIDDER TO ARRANGE ALL T&P REQUIRED TO COMPLETE PACKAGE WITHIN STIPULATED CONTRACT PERIODS.

### TENTATIVE T&P

S.NO	T&P	NOS
1	CONCRETE MIXER	3
2	VIBRATOR	3
4	TRACTOR	2
5	JCB	1
6	HYDRA	1
7	WELDING MACHINE	3
8	SHUTTERING MATERIAL	AS REQUIRED
9	WINCH MACHINE 2 TON	3
10	WATER TANKER	1
11	R/F CUTTING MACHINE	2

ABOVE LIST IS TENTATIVE ,BIDDER TO ARRANGE REQUIRED T&P AS DIRECTED BY INCHARGE TO COMPLETE WORK IN TIME SCHEDULE WITHOUT ANY EXTRA COST.NO EXTRA PAYMENT WILL BE MADE FOR ANY ADDITION OF T&P.



# TECHNICAL CONDITIONS OF CONTRACT (TCC)

## Chapter – V: T&Ps and MMEs to be deployed by BHEL

---

BHEL WILL NOT PROVIDE ANY T&P FOR THIS WORK

# TECHNICAL CONDITIONS OF CONTRACT (TCC)

## Chapter – VI: Time Schedule

---

### **6.1 Time schedule & mobilization**

#### **COMPLETION PERIOD**

6.1 The Contractor shall complete the entire job as per tender within 90 days from the date of LOI.

#### **6.2 EXECUTION SCHEDULE**

6.2.1 The contractor should submit the correct and complete drawings to BHEL site engineer for approval within 10 days from the date of LOI.

Subject to correctness and completeness of the drawing, BHEL shall approve the same within 15 days from date of LOI.

Mobilization at site shall be done within 15 days from date of LOI.

The Contractor shall supply materials in such a manner that supply & construction of all Facilities are completed within 75 days from the date of approval of drawing.

# TECHNICAL CONDITIONS OF CONTRACT (TCC)

## Chapter-VII: Terms of Payment

---

Term of payment:-

### 7.1 SUPPLY PAYMENT TERM AND CONDITION

Total value of supply portion will be 70% of total quoted price.

1. Eighty percent (80%) of basic price on receipt of Material at site, as per approved Billing schedule.

2 Twenty percent (20%) of the total basic price shall be released by Site authorities/ Region on Successful completion and handing over of Building system/ package

### 7.2 ERECTION & COMMISSIONING PAYMENT

Total value of E&C portion will be 30% of total quoted price.

1. Eighty percent (80%) payment on pro-rata basis for the work completed, as per Approved billing schedule, shall be released by Site authorities/ Region on Submission of protocols, duly signed by BHEL Site/ Owner.

2. Twenty percent (20%) of the total value shall be released by Site authorities/ Region on Successful commissioning of the complete system/ package.

7.3 Release of payment in each running bill will be restricted to **95% of the value of work admitted**, as per the percentage break-up for the stage of work completion stipulated vide clauses hereinafter.

**The 5% retention amount shall be released as per GCC clause no. 2.22.** The workmanship guarantee period for this contract shall be **12 months from the date of completion** of entire work as certified by BHEL

Successful Bidder to submit Billing schedule after placing of order for approval to site.

# TECHNICAL CONDITIONS OF CONTRACT (TCC)

## Chapter-VIII : Taxes and other duties

---

### 8.0 TAXES, DUTIES, LEVIES (Consolidated Rev 03 dated 09/04/2013)

#### 8.1. For All types of works (item No B of Vol-II-Price Bid Specification) excepting scope covered under sl no 8.2

##### 8.1.1

The contractor shall pay all (save the specific exclusions as enumerated in this contract) taxes, fees, license charges, deposits, duties, tools, royalty, commissions or other charges which may be levied on the input goods & services consumed and output goods & services delivered in course of his operations in executing the contract. In case BHEL is forced to pay any of such taxes, BHEL shall have the right to recover the same from his bills or otherwise as deemed fit.

**However, provisions regarding Service Tax and Value Added Tax (VAT) on output services and goods shall be as per following clauses.**

##### 8.1.2 Service Tax & Cess on Service Tax

Contractor's price/rates shall be exclusive of Service Tax and Cess on Services. In case, it becomes mandatory for the contractor under provisions of relevant act/law to collect the Service Tax & Cess from BHEL and pay the same to the concerned tax authorities, such applicable amount will be paid by BHEL at the prevailing Service Tax Rate (presently 12.36 %) on the admitted bill value.

**Contractor shall submit to BHEL documentary evidence of Service Tax registration certificate specifying name of services covered under this contract. Contractor shall submit serially numbered Service Tax and Cess Invoice, signed by him or a person authorized by him in respect of taxable service provided, and shall contain the following, namely,**

1. The name, address and the registration number of the contractor,
2. The name and address of the party receiving taxable service,
3. Description, classification and value of taxable service provided and,
4. The service tax payable thereon.

**All the Four conditions shall be fulfilled in the invoice before release of service tax payment.**

**Wherever, more than one route/option are available for discharge of service tax liability under a particular service, (e.g. "works contract Service"), contractor shall obtain prior written consent from BHEL site before billing the amount towards Service Tax.**

##### 8.1.3 VAT (Sales Tax /WCT)

As regards Value Added Tax (VAT)/CST on transfer of property in goods involved in Works Contract (previously known as Works Contract Tax) applicable as per local laws, the price quoted by the contractor shall be inclusive of the same and in no case input or output VAT/CST will be reimbursed extra.

In any case the Contractor shall register himself with the respective Sales Tax authorities of the state and submit proof of such registration to BHEL along with the first RA bill. Contractor will submit all the details of

# TECHNICAL CONDITIONS OF CONTRACT (TCC)

## Chapter-VIII : Taxes and other duties

---

VAT/CST paid for the contract in the prescribed format of the respective state VAT laws. Also, the contractor will issue the tax Invoices to BHEL as per the Tax laws of respective state on monthly basis. Contractor shall also be required to furnish to BHEL necessary proof of VAT remittance on monthly basis.

Deduction of tax at source shall be made as per the provisions of law and is to be construed as an advance tax paid by the contractor and no reimbursement thereof will be made.

Further, if BHEL, at the instance of customer or otherwise adopts the specific route for discharging output VAT liability itself, benefit of the reduction in liability of the contractor will be passed on to BHEL.

In case, BHEL is forced to pay any VAT liability on behalf of contractor, the same will be recovered from contractor's bill or otherwise as deemed fit

### 8.2 FOR item No A of Vol-II-Price Bid Specification

The contractor shall pay all (save the specific exclusions as enumerated in this contract) taxes, fees, license charges, deposits, duties, tools, royalty, commissions or other charges which may be levied on the input goods & services consumed and output goods & services delivered in course of his operations in executing the contract. In case BHEL is forced to pay any of such taxes, BHEL shall have the right to recover the same from his bills or otherwise as deemed fit. ( i.e. **rates quoted by bidder shall be inclusive of Service Tax, VAT/WCT and all other taxes and duties** )

However, Since the proposed work is in the nature of 'Works Contract service' as per Service tax law, Hence, For non-corporate contractors being Individual, HUF, Proprietary Firm, Partnership Firm or Association of Persons (AOP), BHEL shall recover the applicable Service Tax under reverse charge mechanism from the contractor and remit the same with the Government as per the provisions of Law. Necessary advice/confirmation of remittance shall be issued to the contractor. The contractor shall not be eligible for any refund/reimbursement of such service tax from BHEL. It shall be the responsibility of the contractor to submit proper invoice giving all the requisite details as per Service Tax Law for the determination of the service tax liability of BHEL under reverse charge mechanism. BHEL reserves the right to determine such liability based on the invoice submitted by the contractor or otherwise independently and remittance of the same with the Government.

### 8.3 New Taxes/Levies

In case the Government imposes any new levy/tax on the output service/ goods/work after award of the contract, the same shall be reimbursed by BHEL at actual.

In case any new tax/levy/duty etc. becomes applicable after the date of Bidder's offer, the Bidder/Contractor must convey its impact on his price duly substantiated by documentary evidence in support of the same **before opening of Price Bid**. Claim for any such impact after opening the Price Bid will not be considered by BHEL for reimbursement of tax or reassessment of offer.

# TECHNICAL CONDITIONS OF CONTRACT (TCC)

## Chapter-VIII : Taxes and other duties

---

No reimbursement/recovery on account of increase/reduction in the rate of taxes, levies, duties etc. on input goods/services/work shall be made. Such impact shall be taken care of by the Price Variation/Adjustment Clause (PVC) if any. In case PVC is not applicable for the contract, Bidder has to make his own assessment of the impact of future variation if any, in rates of taxes/duties/ levies etc. in his price bid.

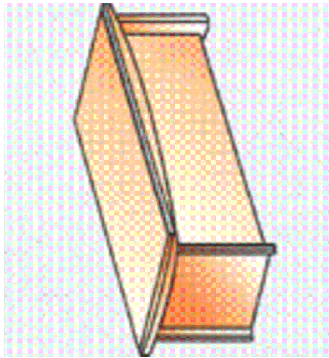

Desk-W180xD90xH75

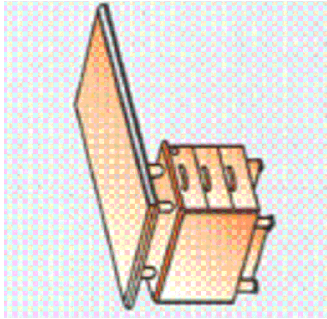

Fixed side return Desk  
W120xD60xH72

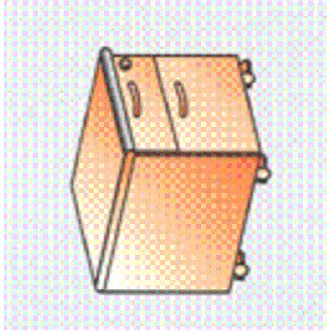

Mobile pedestal  
W120xD60xH72

**MAESTRO TYPE TABLE FOR SITE-INCHARGE**

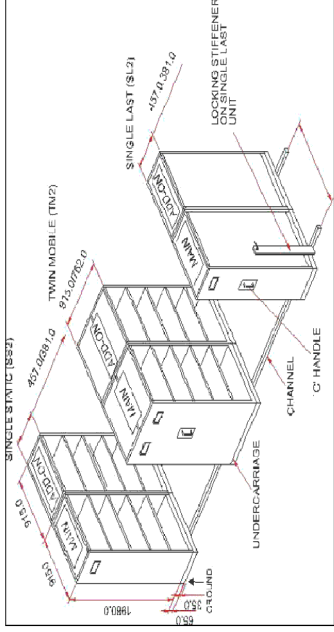

**PULL - PUSH TYPE OPTIMIZER**

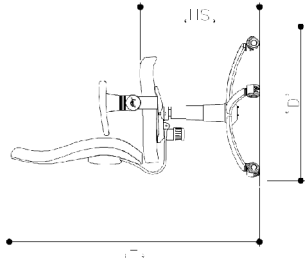

Chair for Senior executives  
W-70cm,  
D-70cm,  
H-102 to 115cm,  
SH-44 to 56.5cm  
Tolerance-  $\pm 0.5$ cm

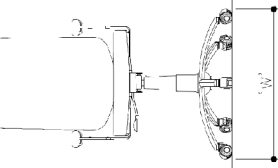

Chair for Executives & Conf. hall  
W-70cm,  
D-70cm,  
H-90 to 102.5cm,  
SH-44 to 56.5cm  
Tolerance-  $\pm 0.5$ cm

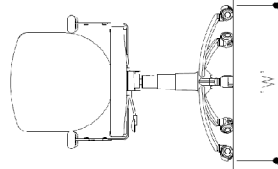
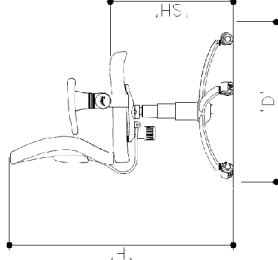

Chair for visitors:  
W-55cm,  
D-61cm,  
H-80.5 cm,  
SH-44 cm,  
Tolerance-  $\pm 0.5$ cm

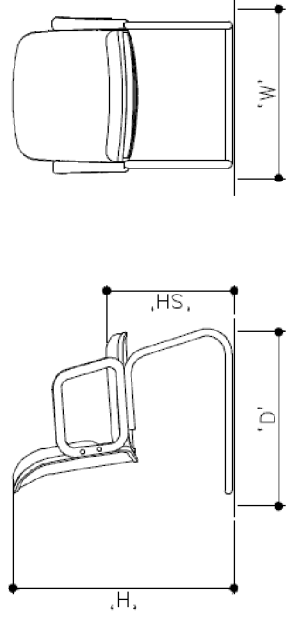

NOTE:—  
ALL DIMENSIONS SHOWN ARE ASSUMED AND  
SHOULD BE VERIFIED ACCORDINGLY



**BHARAT HEAVY ELECTRICALS LTD**

**TITLE: FURNITURE DRAWINGS**

DEPT:	CIVIL	STRUCTURAL	BHEL DRAWING NO.
SIGN			
DATE			
SHEET	1	OF	1
REV.	00		

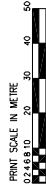

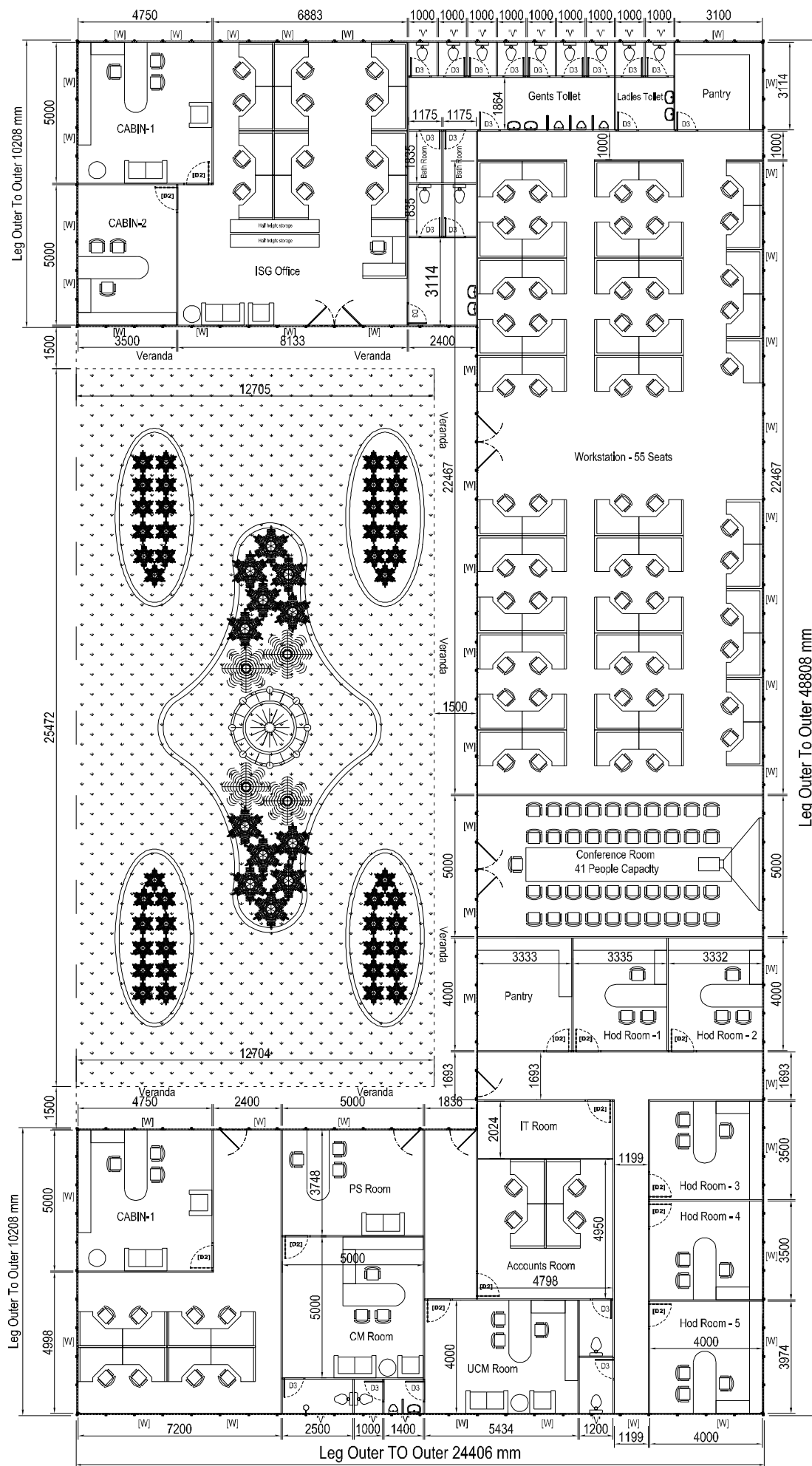



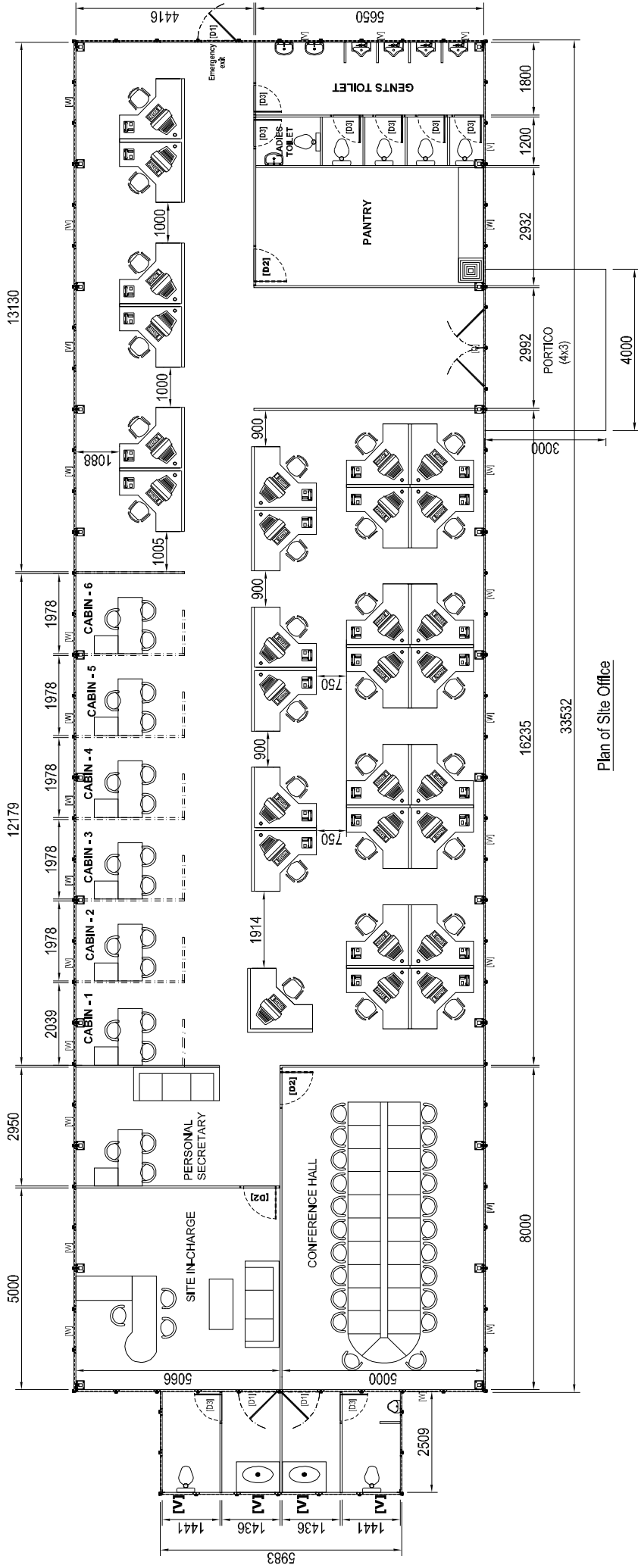

Plan of Site Office