



**CONTROLS & INSTRUMENTATION (FB)
PRE-QUALIFICATION REQUIREMENT (PQR)**

CI:PE:PQR:STA

Rev. No: 00

Dt. : 30-12-2021

SENSOR HOUSING & SONIC TUBE ASSEMBLY

SL. NO.	DESCRIPTION	BID REQUIREMENTS	BIDDER CONFIRMATION DOCUMENT INDEXED WITH PAGE REFERENCES
1.	In House Facility	a) Bidder should have all machineries and facilities for complete in-house manufacturing of Sensor housing & Sonic Tube Assembly. b) List of in-house machineries and facilities shall be furnished.	File Name: Page () to Page ()
2.	Outsourcing/Offloading	None of the processes involved in the manufacturing shall be outsourced / offloaded to sub vendors.	File Name: Page () to Page ()
3.	Testing Facility	a) Bidder should have Hydro testing facility of min. 15 kg/cm ² to test the complete assembly at their works. b) Bidder to furnish supporting documents in this regard.	File Name: Page () to Page ()
4.	Credentials in Power plant/ Heavy Industries	Bidder should have supplied assembly of comparable dimensions as called in enquiry to COAL FIRED THERMAL power plants in India. Reference list for the same to be furnished.	File Name: Page () to Page ()

**Bidder's Confirmation YES/NO/COMPLIED/CONFIRMED reply are not treated as valid reply.
Bidder to attach indexed clause wise document supporting each point in detail.**

BHARAT HEAVY ELECTRICALS LIMITED

HIGH PRESSURE BOILER PLANT, TIRUCHIRAPALLI 620 014.

CONTROLS AND INSTRUMENTATION / FB



TECHNICAL SPECIFICATION

FOR

SENSOR ASSEMBLY & SONIC TUBE ASSEMBLY (AUTO PURGE)

OF
BHELSONIC SYSTEM

SPEC. REF:- CI:BS10:AUTOPURGE:STASA

REVISION HISTORY

Rev. No.	DATE	DESCRIPTION	PREPARED MVR	CHECKED MVR	APPROVED AKP
00	08.04.2014	Initial Release	-sd/MVR	-sd/MVR	-sd/AKP
01	28.06.2016	Sonic tube assembly drawing revised	-sd/mvr	-sd/mvr	-sd/AKP
02	02.03.2017	Sonic tube assembly accessories added	Ramany.	Ramany.	Apanth.

CONTENTS:

1. GENERAL INSTRUCTIONS TO VENDORS
2. DRAWING & DATA SHEET LIST
3. QUALITY PLAN & INSPECTION
4. DOCUMENTATION
5. PACKING
6. SPECIAL INSTRUCTIONS TO VENDORS

Annexure:

1. Drg. No. 3-97-585-21634/03 - Sensor assembly.
2. Drg. No. 1-97-585-01335/01- Sonic Tube assembly.

Note:-

Clarification required, if any, on the enclosed specification shall be referred to the purchaser within 10 days from the date of enquiry.

1.0 GENERAL INSTRUCTIONS TO VENDORS:

- 1.1 In the event of order, the entire specification will form part of purchase order for compliance during execution.
- 1.2 Deviation if any shall be clearly brought out in the "Deviation schedule". Otherwise it will be construed that the vendor is fully complying with the specification.

2.0 DRAWING & DATA SHEET LIST:

- 2.1 Vendor shall supply all the items as indicated in the following drawings as loose supply.
 - a) Drg. No. 3-97-585-21634/03 – STLD - Sensor assembly.
 - b) Drg. No. 1-97-585-01335/01 – STLD - Sonic Tube assembly.
 - c) Refer project specific datasheet for Air filter regulator & solenoid valve.
- 2.2 Vendor shall submit detailed Bill of Material, indicating break up prices for all items.
- 2.3 15 meter length of pig tail cable will be supplied for each sensor assembly. BHEL will provide the same as a "free issue" item in one length to the vendor for cutting & soldering with the cable connector.

3.0 QUALITY PLAN & INSPECTION

- 3.1 Quality plan BHEL SQP ref QA:CI:STD:QP:73 shall be followed.
- 3.2 Advance information shall be intimated to BHEL, 7 days ahead from the date of Inspection for clearance/acceptance of material.

4.0 DOCUMENTS REQUIRED

A. Along with offer:

- i) Vendor to duly signed and stamped for compliance/confirmation for the BHEL specification

B. After Placement of Purchase Order:

Vendor shall manufacture sonic tube assembly and sensor assembly as per BHEL drawings.

5.0 PACKING:

Materials shall be packed as per packing procedure ref. No. QA:CI:STD:PR:04, Rev. 02 shall be followed.

Solenoid valve (SV) & Air filter regulator (AFR) shall be individually wrapped with bubbled polythene sheet, packed in moulded thermocole boxes, filled with tightly with thermocole beads and further packed suitable to avoid transport and storage damages.

6.0 SPECIAL INSTRUCTIONS TO VENDORS

6.1 Warranty: 18 months from the date of supply and 12 months from the date of commissioning.

6.2 Nothing in this specification shall be construed to relieve the vendor from his responsibility. This specification covers briefly the requirements of the system. It is the responsibility of the vendor to take care of other basic and essential requirements to manufacture a quality product and complete system.

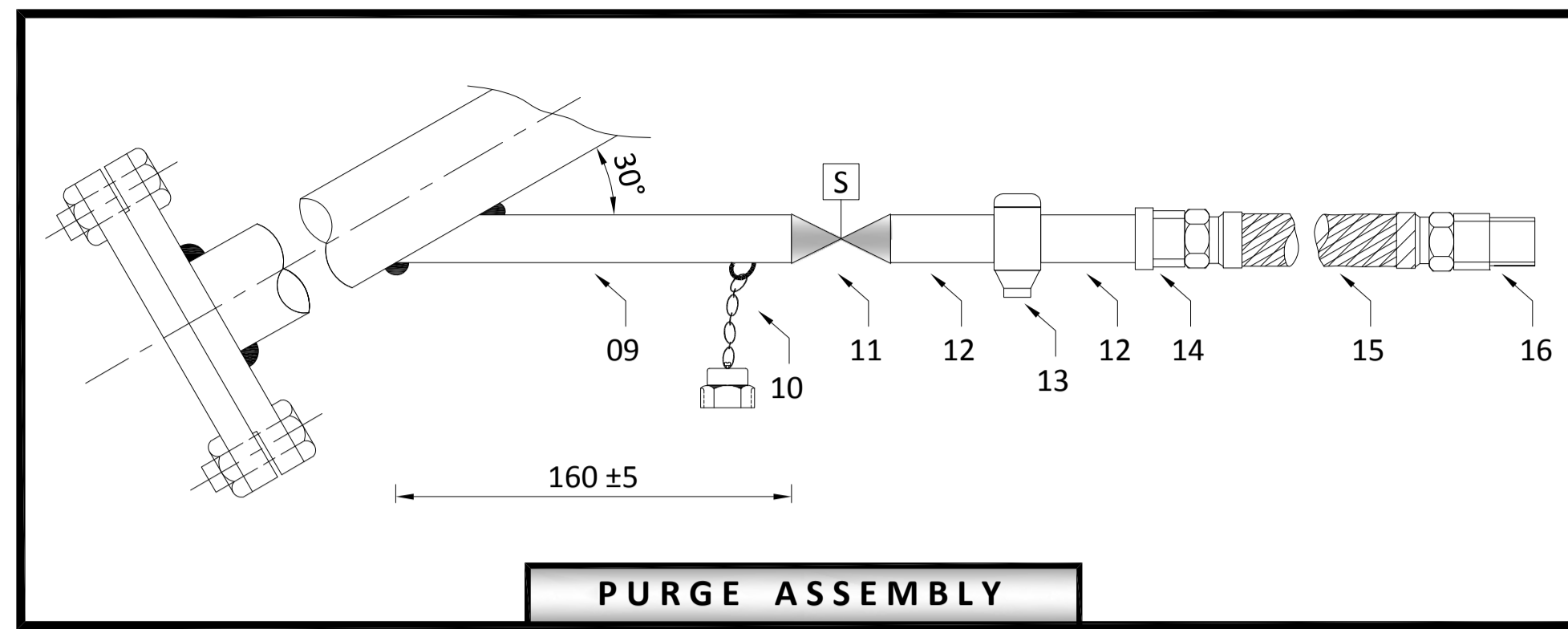
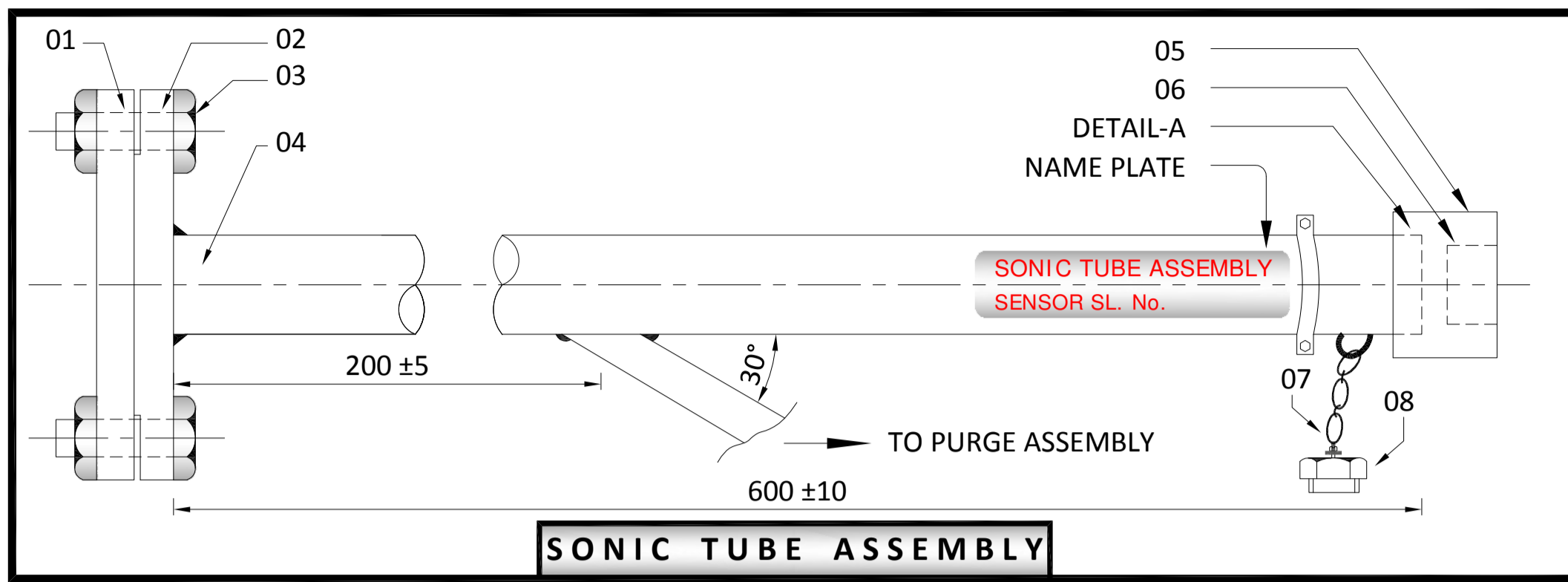

NOTE

1. ALL DIMENSIONS HAVE ±1mm TOLERANCE, IF NOT MENTIONED IN THE DRAWING.
2. ALL ITEMS ARE IN VENDOR SCOPE.
3. DURING INSPECTION, THE SAME DRAWING SHALL ONLY BE REFERRED.
4. PAINT COLOUR SHADE RAL-5012 & THICKNESS 70-80 MICRONS.
5. SENSOR LOCKING ARRANGEMENT IS PROVIDED BY MEANS OF GRUB SCREWS.
6. VENDOR CODE SHALL BE PUNCHED/ENGRAVED ON SONIC TUBE ASSEMBLY.

ITEM No.	DESCRIPTION	MATERIAL	QTY.
1.	TEFLON FLANGE	TEFLON	1 No.
2.	FLANGE	SA106 GR.-B	1 No.
3.	M12x100mm(L) BOLTS, NUTS & WASHER	MS ZINC. PASSIVATED	4 SETS
4.	PIPE Ø48.3 x 3.68	SA106 GR.-B	1 No.
5.	TEFLON COUPLING WITH 3 Nos. OF HIGH SPEED STEEL MATERIAL GRUB SCREWS.	TEFLON	1 No.
6.	SS SLEEVE	SS304	1 No.
7.	250MM LENGTH CHAIN.	SS304	1 No.
8.	END CAP ADAPTER - 2" BSP(M) SUITABLE FOR ITEM-06.	TEFLON	1 No.
9.	160MM LONG PIPE WITH ONE SIDE SOCKET WELD & 1/2" NPT(M) ON OTHER SIDE (OD 21.3 x 3.15mm THICKNESS)	SA106 GR.-B	1 No.
10.	END CAP ADAPTER - 1/2" NPT(F) SUITABLE FOR ITEM-09 WITH 350MM LENGTH CHAIN.	SS304	1 No.
11.	SOLENOID VALVE, 1/2" NPT(F) ON BOTH SIDES	SS304	1 No.
12.	90MM LONG PIPE 1/2" NPT(M) ON BOTH SIDES (OD 21.3 X 3.15MM THICKNESS)	SA106 GR.-B	2 Nos.
13.	AIR FILTER REGULATOR 1/2" NPT(F) ON BOTH SIDES.	DIE CAST ALUMINIUM	1 No.
14.	ADAPTER 1/2" NPT(F) & 1/2" BSP(M)	SS304	1 No.
15.	1/2" SS BRAIDED HOSE OF 3 METER LENGTH WITH END FITTINGS OF 1/2" BSP(F) ON BOTH SIDES WITH FEMALE THREADED SWIVEL NUT, WORKING PR. = 7 KG/SQ.CM.	SS304	1 No.
16.	ADAPTER 1/2" NPT(M) & 1/2" BSP(M)	SS304	1 No.

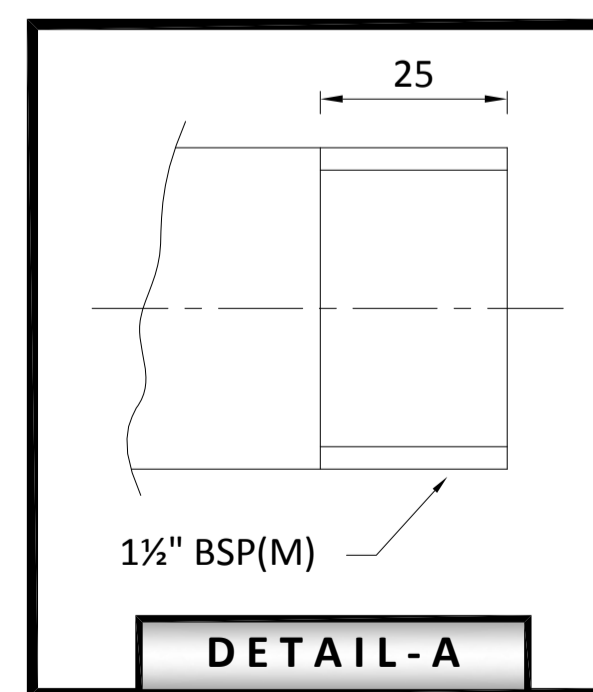
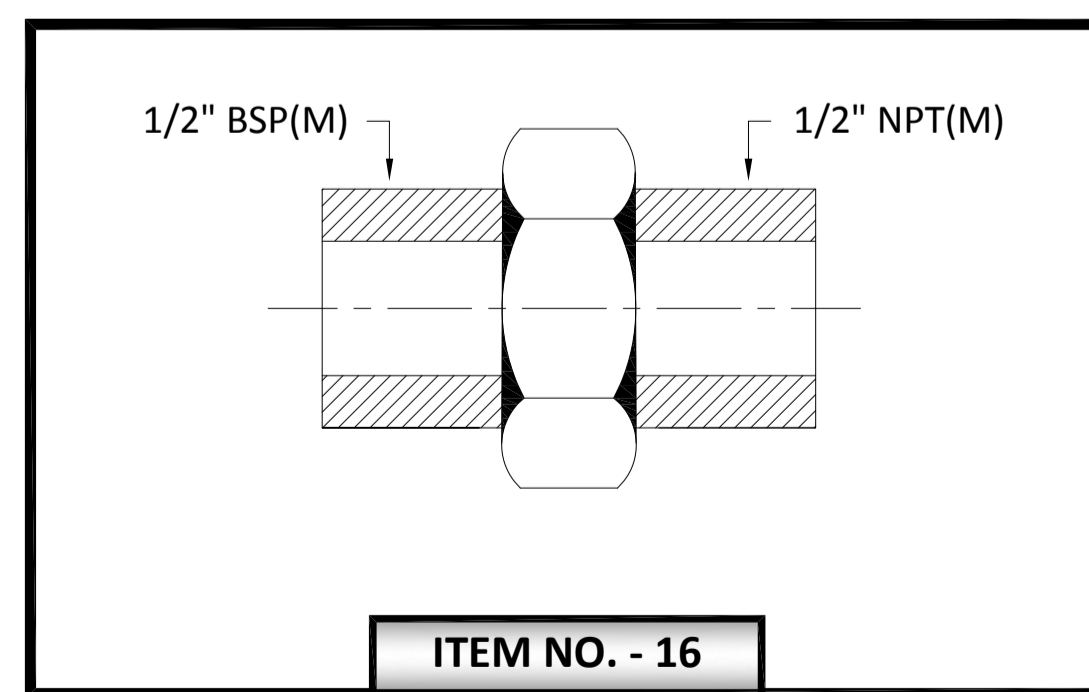
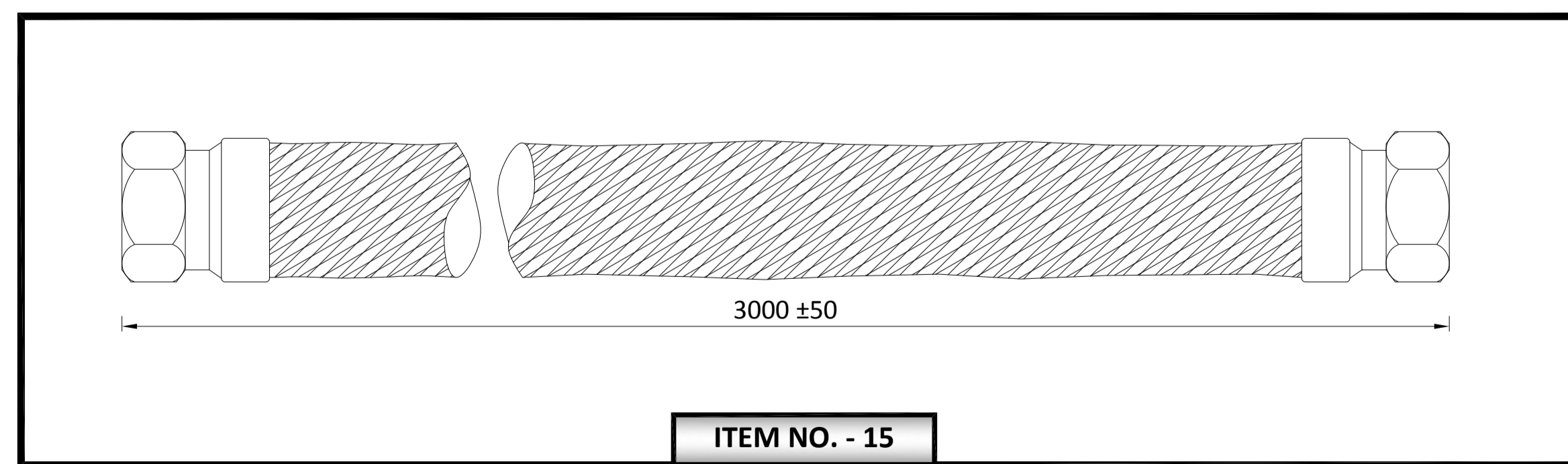
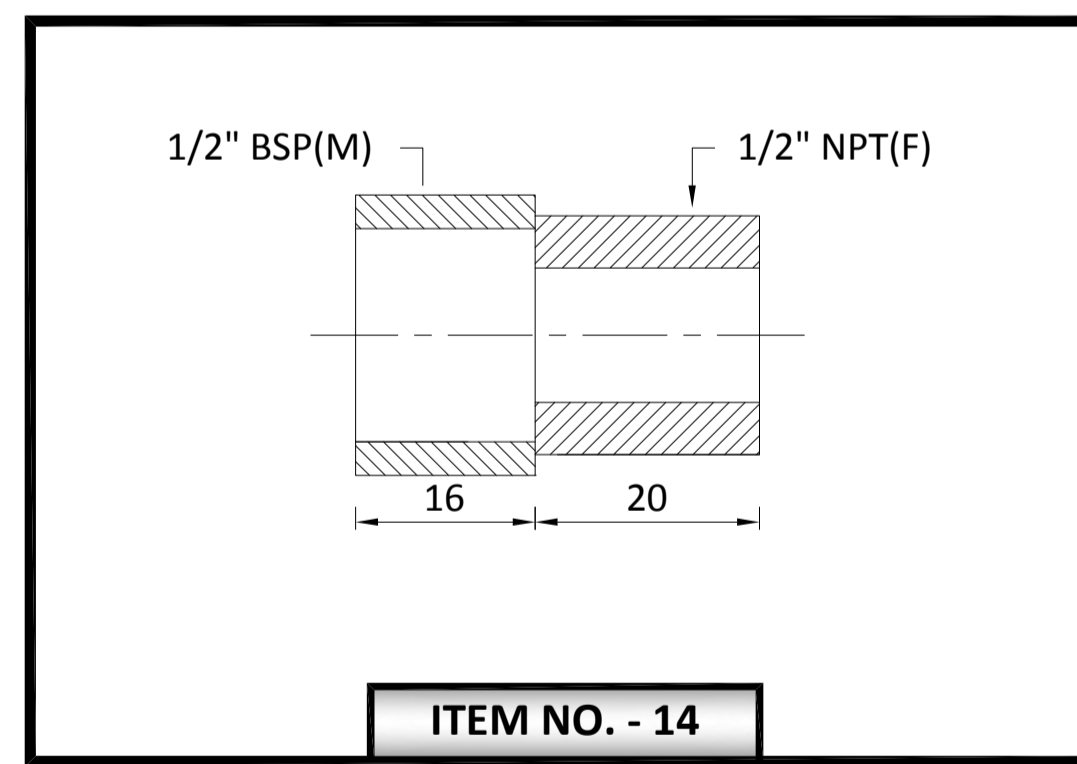
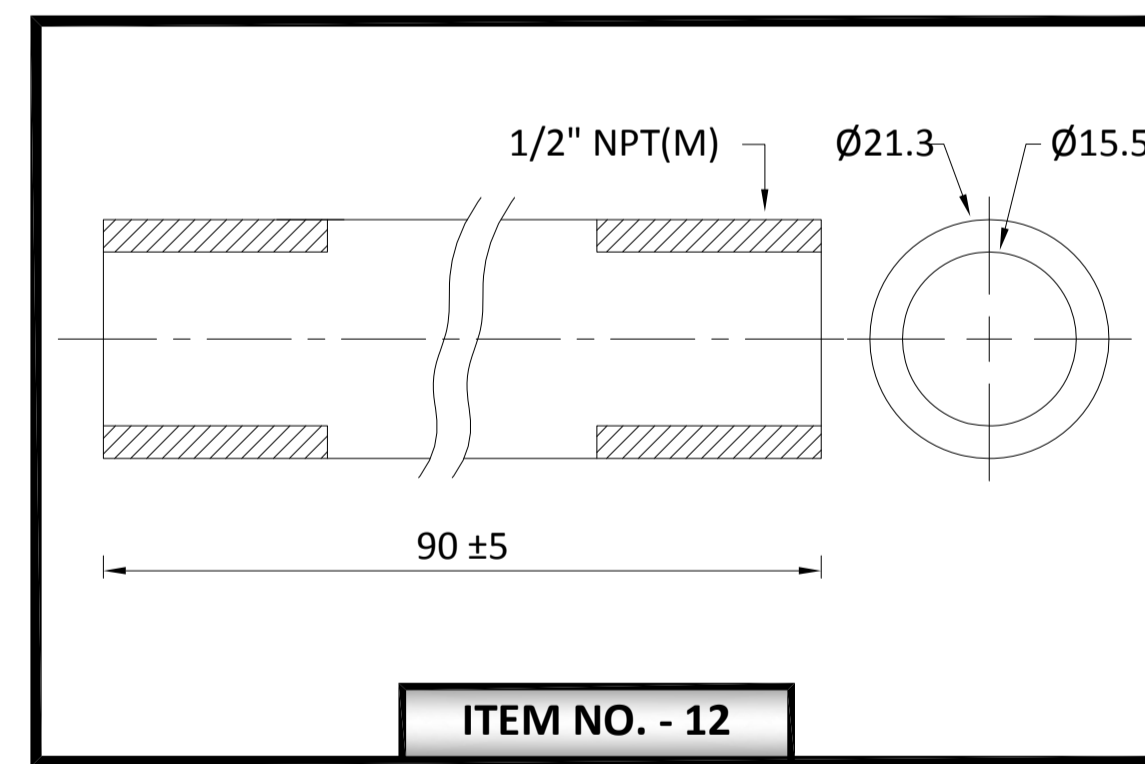
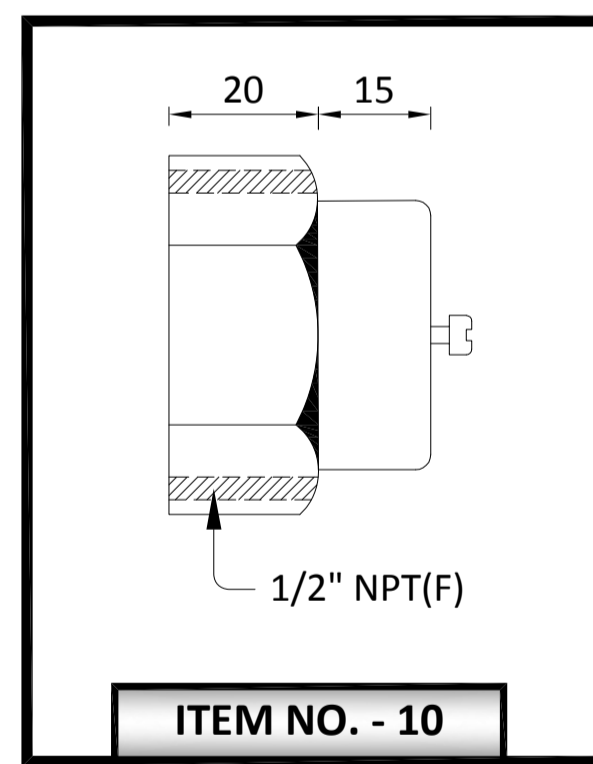
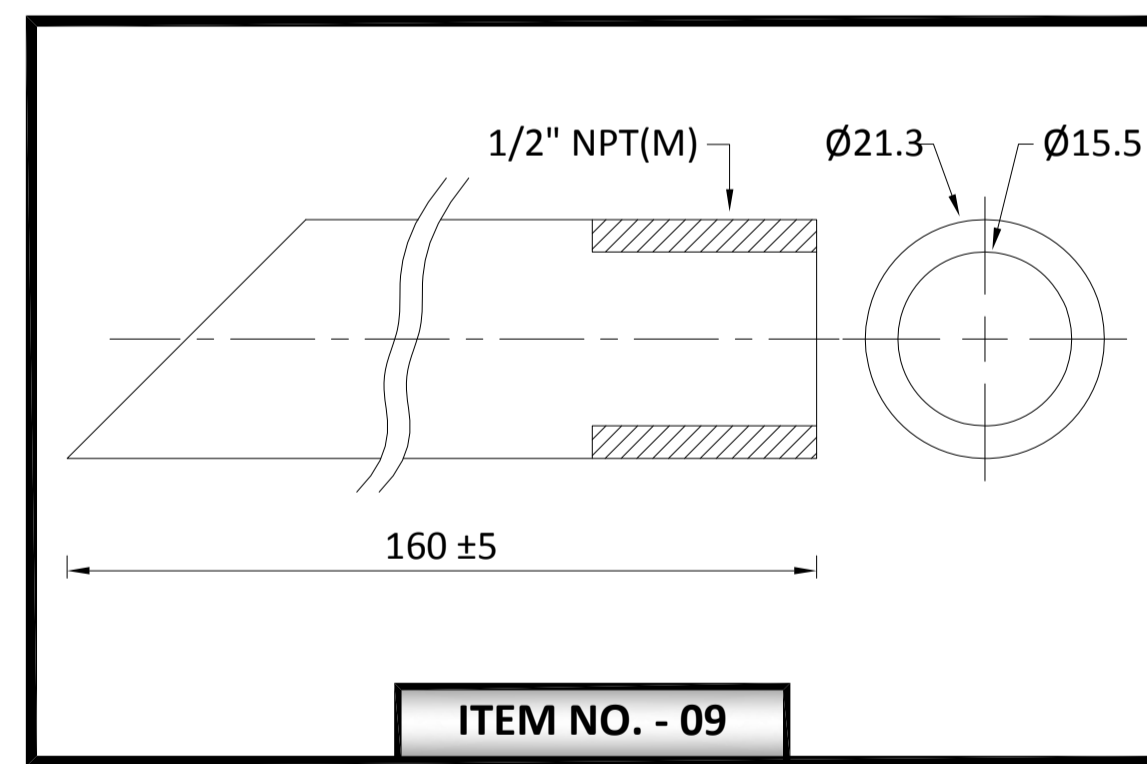
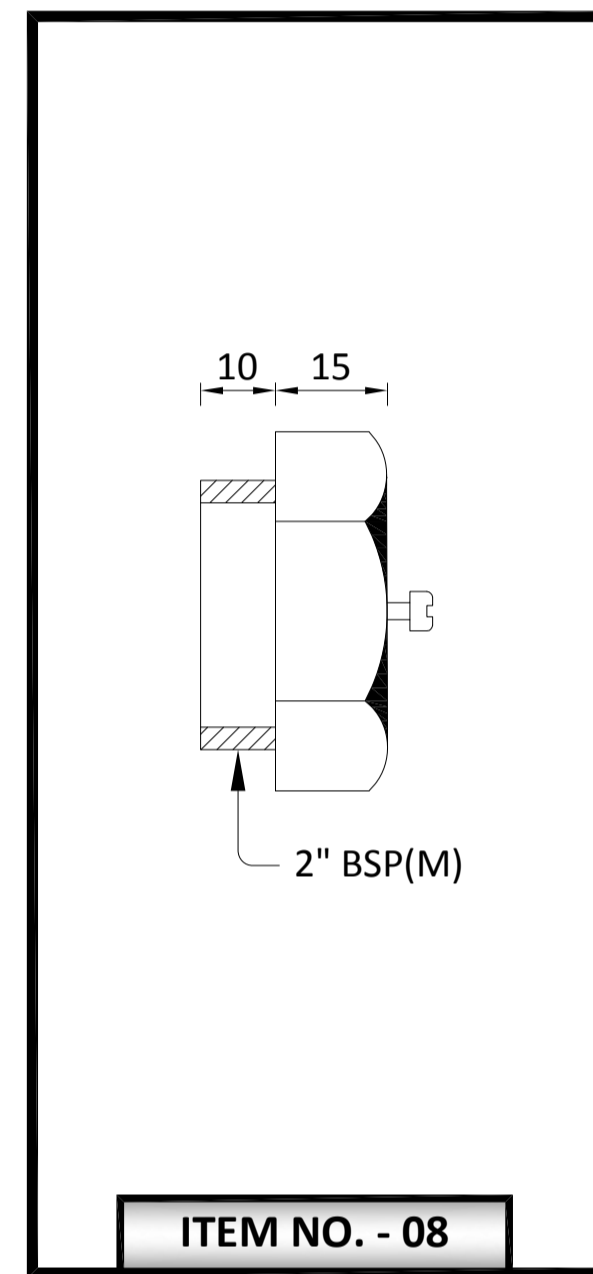
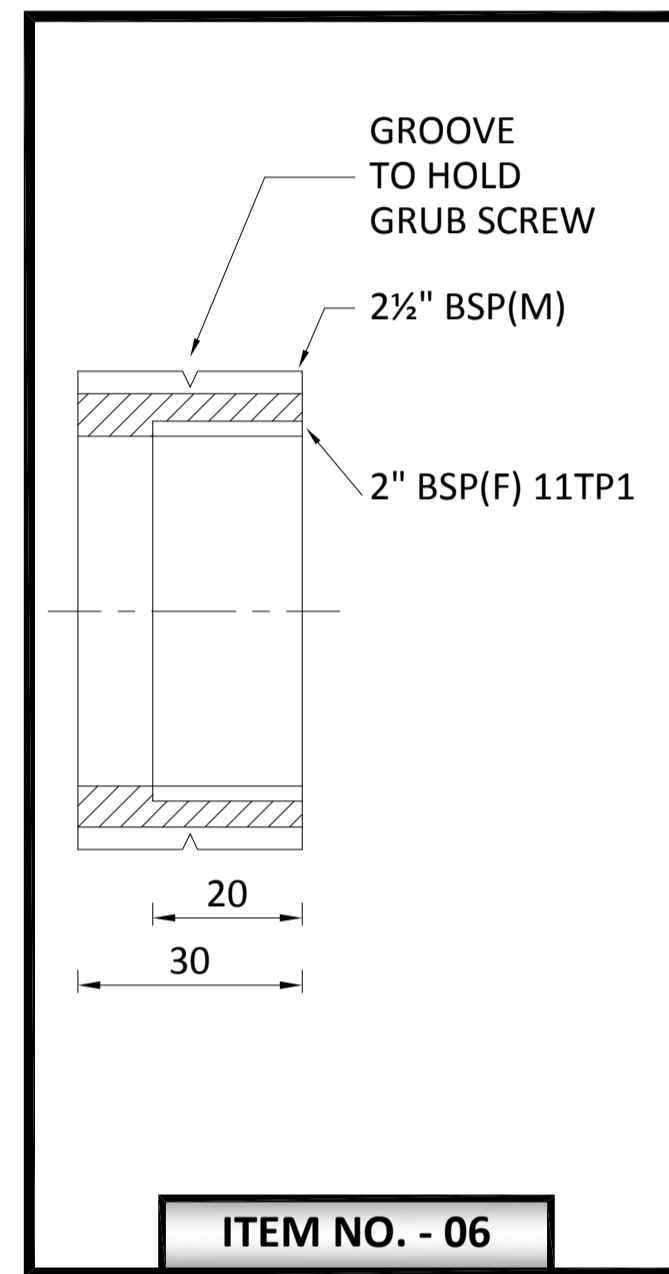
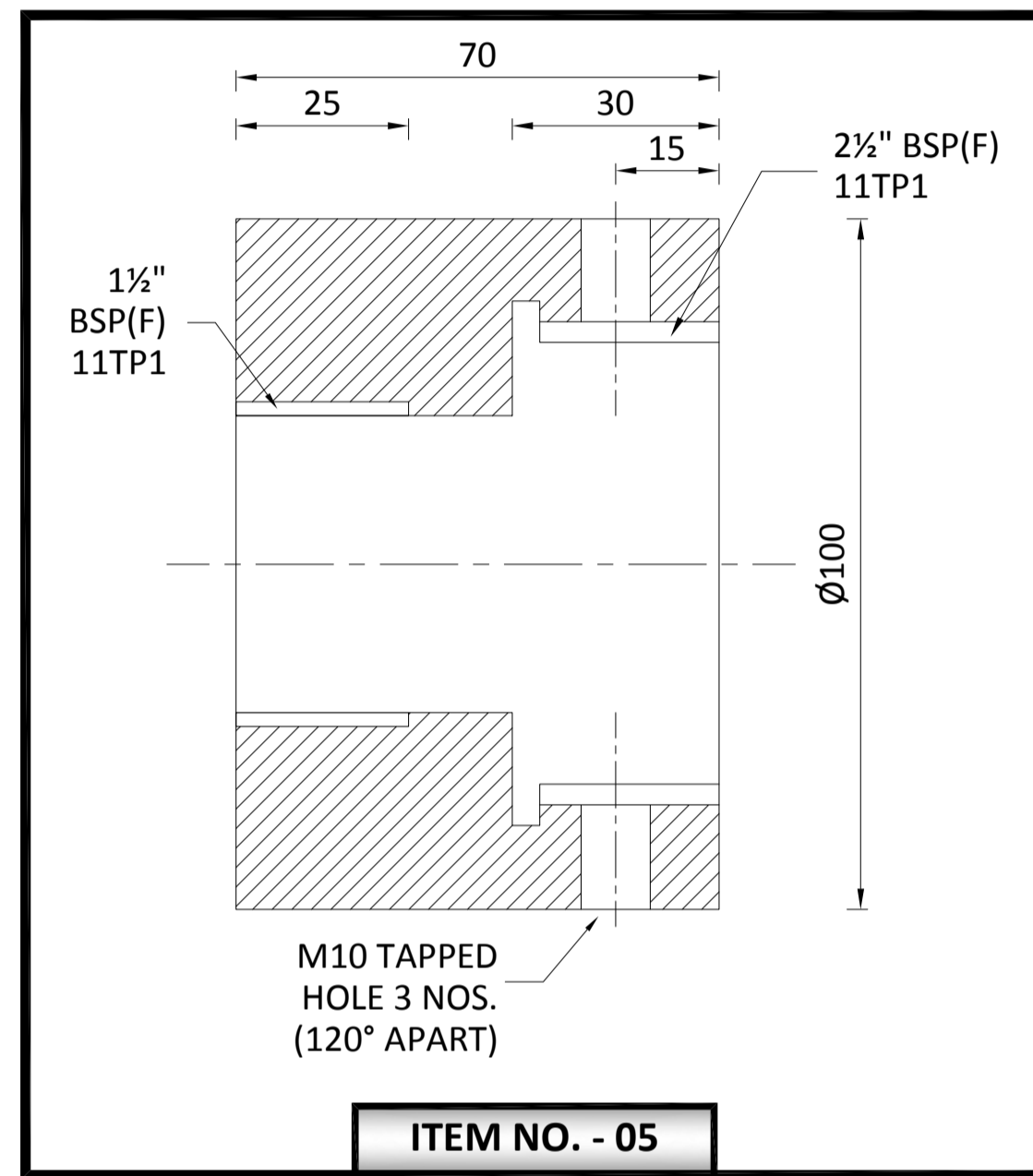
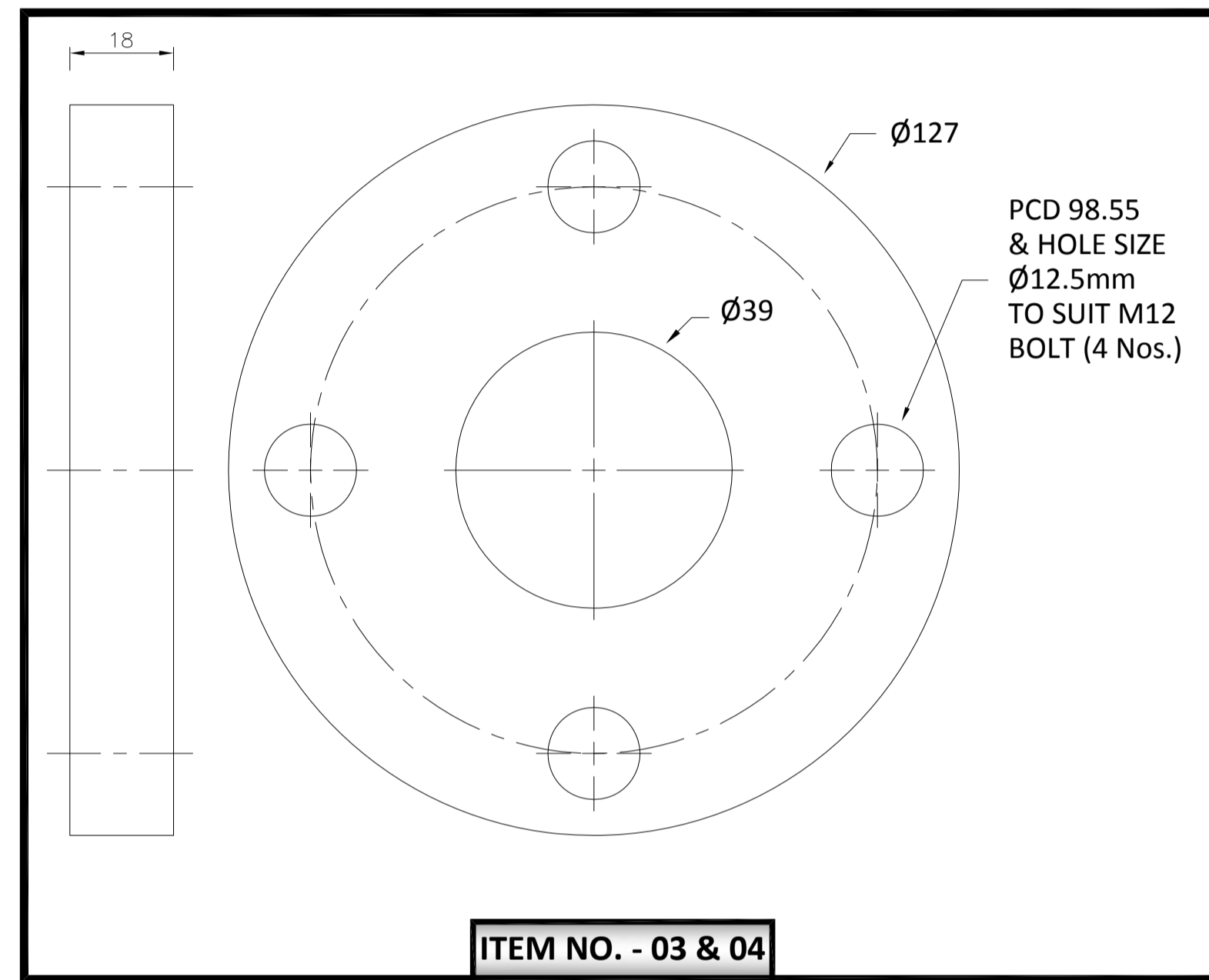

REV	DATE	ALTERED	BY
01	280217	CHD./APPD.	St. S. S. 280217
ZONE			
REVISED END CAP ADAPTER MATERIAL FOR ITEM NO-08 & 16.			

TYPE OF PRODUCT OR NAME OF CUSTOMER/PROJECT		STANDARD			
Bharat Heavy Electricals Ltd UNIT: HIGH PRESSURE BOILER PLANT TIRUCHIRAPPALLI - 620014		DRN	NAME	SIGNATURE	DATE
		CHD	A. T. H. a m b u r a	[Signature]	29-02-16
		APPD	M. Venkataramana	[Signature]	07-03-16
			A. K. Panda	[Signature]	07-03-16
DEPT. : C & I	ALL DIMENSIONS ARE IN MM	SCALE	WEIGHT (kg)	REF TO ASSY / OLD DWG	ITEM NO
CODE : 392		NTS			No OF ITEMS
TITLE			CARD CODE	DRAWING NO.	REV
BHELSONIC - ACOUSTIC STEAM LEAK DETECTION SYSTEM SONIC TUBE ASSEMBLY			U 01	1-97-585-01335	01
				01/01	

3-97-585-21634

DRAWING NO.:

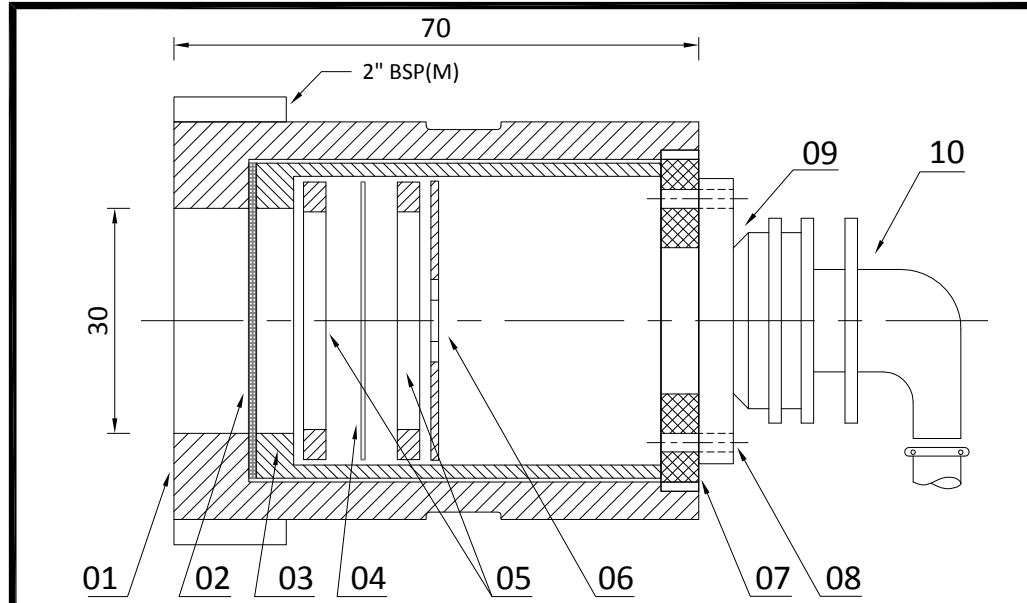

SENSOR ASSEMBLY

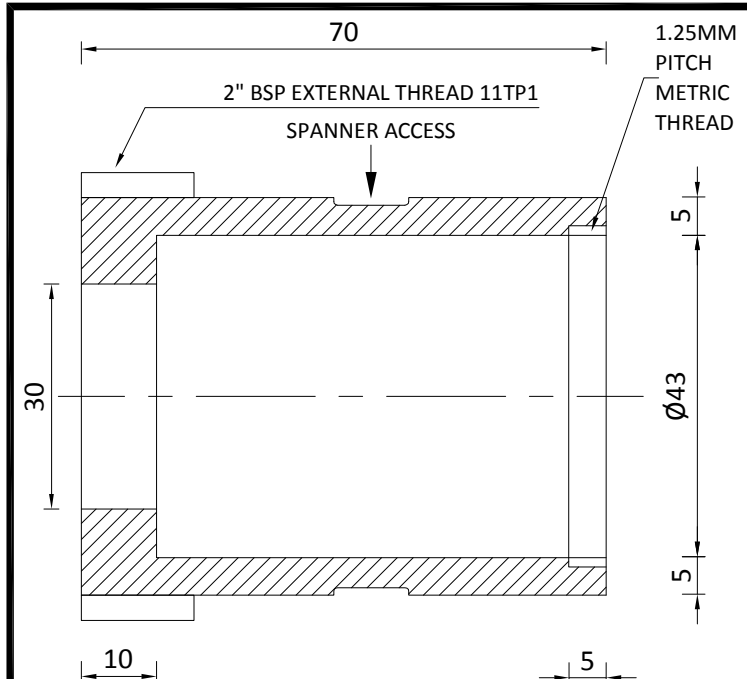

ITEM NO-01 (SENSOR HOUSING)

ITEM No.	DESCRIPTION	QTY.
01.	SENSOR HOUSING (SS 304)	1 No.
02.	WIRE MESH Ø42 (SS 304)	1 No.
03.	INNER SHIELD (TEFLON)	1 No.
04.	POLYESTER FILM, 1MIL THICKNESS (POLYESTER 100x100mm)	2 Nos.
05.	RUBBER BUSH (NEOPRENE)	2 Nos.
06.	PLASTIC DISC (TEFLON)	1 No.
07.	SS LID (SS 304)	1 No.
08.	SUITABLE FIXING SCREW, SS	4 SETS
09.	ALLIED CONNECTOR MS 3102R-14S-6S(FM)	1 No.
10.	ALLIED CONNECTOR MS 3108F-14S-6P(M)	1 No.

NOTE

- PCD TO SUIT CONNECTOR.
- ALL DIMENSIONS HAVE ±1mm TOLERANCE.
- SUITABLE SPANNER ACCESS TO BE PROVIDED AT 180° APART.
- VENDOR CODE SHALL BE PUNCHED/ENGRAVED ON SONIC TUBE ASSEMBLY.

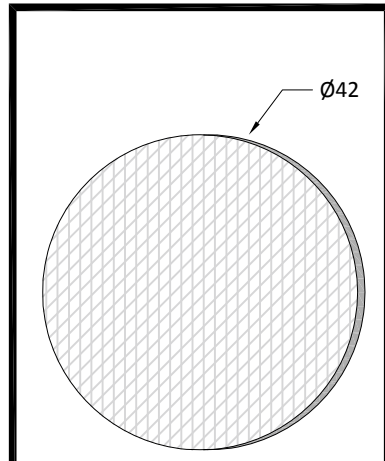

ITEM NO-02 (WIRE MESH)

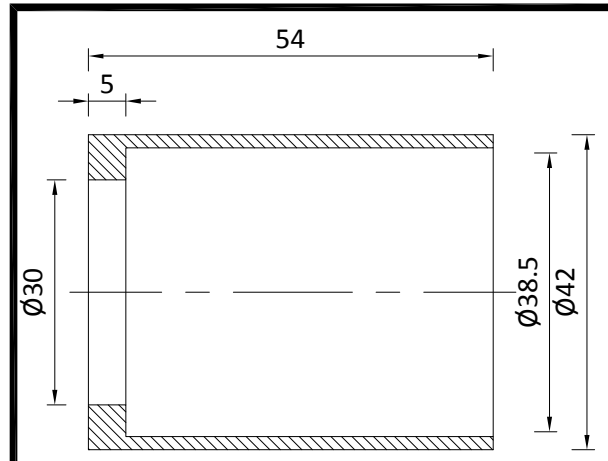

ITEM NO-03 (INNER SHIELD)

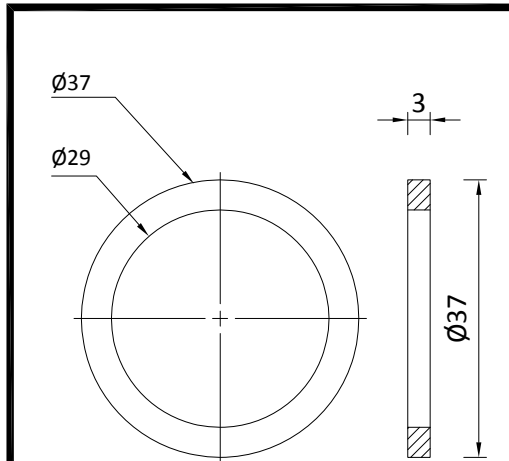

ITEM NO-05 (RUBBER BUSH)

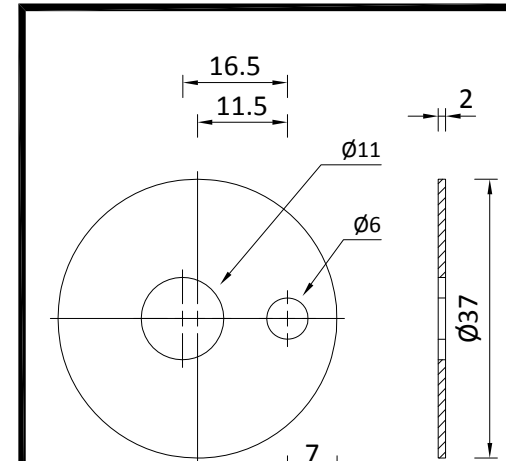

ITEM NO-06 (PLASTIC DISC)

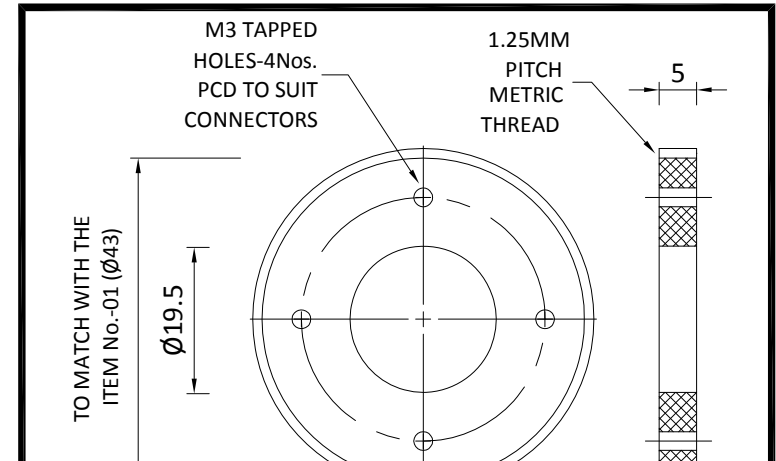

ITEM NO-07 (SS LID)

REV	DATE	ALTERED :	ZONE
02	140915	CHD./APPD. : Sd./MV-AKP	GENERAL REVISION

REV	DATE	ALTERED :	ZONE
03	280416	CHD./APPD. :	REVISD AS PER FES FEED BACK LETTER REF. CI:FE:FB:2015-2016:002
01	061213	CHD./APPD. : Sd./MV-AKP	GENERAL REVISION

CAUTION : The information on this document is the property of BHARAT HEAVY ELECTRICALS LTD. It must not be used directly or indirectly in any way detrimental to the interest of the company.

TYPE OF PRODUCT OR NAME OF CUSTOMER / PROJECT		STANDARD			
DEPT. : C & I CODE : 392		ALL DIMENSIONS ARE IN MM SCALE NTS WEIGHT (Kg)		DRN	NO. OF VAR
				CHD	—
				APPD	—
TITLE BHELSONIC - ACOUSTIC STEAM LEAK DETECTION SYSTEM - SENSOR ASSEMBLY		REF TO ASSY / OLD DWG —		NAME A.Thambu Raj SIGNATURE Sd. / MV DATE 19-07-13	NO. OF ITEMS —
CARD CODE U 01		DRAWING NO. : 3-97-585-21634		REV 03	



CONTROLS AND INSTRUMENTATION/QA/FB

STANDARD QUALITY PLAN FOR SENSOR, SONIC TUBE ASSEMBLY AND PURGE ACCESSORIES

REV	DATE	PREPARED	REVIEWED	APPROVED	REVISION HISTORY
00	15/06/2013	RM.VAIRAVAN <i>[Signature]</i>	N.SRIDHAR <i>[Signature]</i>	K.PALANIVEL <i>[Signature]</i>	Initial release.



BHARAT HEAVY ELECTRICALS LIMITED
TIRUCHIRAPPALLI - 620014

QUALITY PLAN FOR
SENSOR, SONIC TUBE ASSEMBLY AND
PURGE ACCESSORIES

QA:CI:STD:QP:73
Rev: 00 Page: 2 of 3

Sl. No	Component & Operation	Characteristics	Class	Type of Check	Quantum of check		Ref Doc. & Acceptance STD	Format of record	AGENCY			Remarks
					M	B/C			M	B	C	
A	Finished Product Inspection											
1.	Sensor Assembly	a. Material	Major	CHEM	Sample	Sample	IS 2062 & IS 1079	TC	V	V	-	
		b. Over all Dimension	Major	MEAS	100%	20%	BHEL Specification & BHEL Approved Drawings	TR	P	W	-	
		c. Verification of BOM	Major	VISU	100%	100%	-Do-	TR	P	W	-	
2	Sonic Tube Assembly	a. Material	Major	CHEM	Sample	Sample	IS 2062 & IS 1079	TC	V	V	-	
		b. Over all Dimension	Major	MEAS	100%	20%	BHEL Specification & BHEL Approved Drawings	TR	P	W	-	
		c. Verification of BOM	Major	VISU	100%	100%	-Do-	TR	P	W	-	
		d. Straightness of Assembly	Major	VISU	100%	20%	-Do-	TR	P	W	-	
		e. Bend Alignment	Major	VISU	100%	20%	-Do-	TR	P	W	-	
		f. Hydro test on Pipe Line	Major	ENVI	100%	100%	-Do-	TR	P	W	-	1.5 Times of rated pressure
		g. Paint shade & Surface Finish	Major	VISU	100%	20%	-Do-	TR	P	W	-	
3	Purge accessories	a. Material	Major	CHEM	Sample	Sample	IS 2062 & IS 1079	TC	V	V	-	
		b. Over all Dimension	Major	MEAS	100%	20%	BHEL Specification & BHEL Approved Drawings	TR	P	W	-	
		c. Alignment	Major	VISU	100%	20%	-Do-	TR	P	W	-	

M- MANUFACTURER/ SUB-VENDOR; B - BHEL / TPI ; C - CUSTOMER / TPI
P - PERFORM; W - WITNESS V - VERIFICATION;



BHARAT HEAVY ELECTRICALS LIMITED
TIRUCHIRAPPALLI - 620014

QUALITY PLAN FOR
SENSOR, SONIC TUBE ASSEMBLY AND
PURGE ACCESSORIES

QA:CI:STD:QP:73
Rev: 00 Page: 3 of 3

B.NOTES:

1.LEGENDS:

TR	:	Test Report	MEAS	:	Measurement
VISU	:	Visual	TC	:	Test Certificate
ENVI	:	Environment	CHEM	:	Chemical

- The vendor shall arrange all testing facilities at their works. Tests for which facilities are not available are to be carried out at recognized National Test Houses like ETDC/CIL/NPL/ERTL etc., at vendor cost.
- Through Log Book / any other documents available at the vendor's works, it shall be possible to correlate the finished products with raw material and in process stage checks / inspection carried out.
- All Measuring and Testing Instruments shall be periodically calibrated from recognized test houses & certificates made available during inspection for verification.

- Test reports for routine test are to be furnished by the vendor.
- Vendor to give tentative inspection program in advance and confirm exact date two weeks in advance for arranging BHEL's inspection.
- Packing shall be as per the "PACKING PROCEDURE" indicated in the specification.

C. REFERENCE STANDARDS:

(For Indicated Standards Refer the Latest Version)

IS 2062	:	Hot Rolled Medium and High Tensile Structural Steel-Specification
IS 1079	:	Hot Rolled Carbon Steel Sheet and Strip Specification



SQP73R0.DOC

M- MANUFACTURER/ SUB-VENDOR; B - BHEL / TPI ; C - CUSTOMER / TPI
P - PERFORM; W - WITNESS V - VERIFICATION;

**BHARAT HEAVY ELECTRICALS LIMITED
TIRUCHIRAPPALLI**

**CONTROLS AND INSTRUMENTATION / FB
QUALITY ASSURANCE**

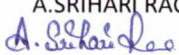
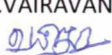
**STANDARD PACKING PROCEDURE
FOR
ALL INSTRUMENTS AND MISCELLEANEOUS ITEMS
(ELECTRICAL, ELECTRONIC AND PNEUMATIC)**

Rev	Date	Prepared	Checked	Approved	Revision History
00	01.01.96	Sd/-	Sd/-	Sd/-	Initial History
01	28.03.02	Sd/-	Sd/-	Sd/-	Department name changed
02	26.02.07	Sd/-	Sd/-	Sd/-	Revised after discussion with Shipping Dept.
03	17.12.16	A.SRIHARI RAO 	RM.VAIRAVAN 	S.DAKSHINAMOORTHY 	Revised to suit all type of instruments.

1. Scope

This procedure gives minimum guidelines to be complied with for packing of Electrical, Electronic and pneumatic Instruments. This packing shall be suitable for different handling operations and for the adverse conditions during transportation and during indoor / outdoor storage for period more than one year.

2. Material for packing

The individual instrument shall be packed in carton box (specifically made for particular instrument) and grouped together inside a box made of wood or plywood as per National / International standard.

3. Packing

- Items shall be inspected for cleanliness immediately before packaging. Dirt, oil, residue, metal chips or other forms of contamination shall be removed.
- Adequate protection shall be provided against mechanical damage and atmospheric corrosion in transit and, for equipment suitable for outside storage, for prolonged storage at the site prior to installation.
- Water proof barrier material – high density polythene shall be used as a resistant to grease and water; it shall protect items from airborne and windblown soils.
- Desiccants like silica gel to be used inside the carton box. Silica gel shall conform to IS 3401. The gel is to be packed in sachets placed at different positions inside the components for absorbing moisture. The quantity of silica gel shall be adequate for storage period of one year.
- All tapped openings in equipment shall be plugged with plastic plugs to protect internal / external threads.
- Use a sturdy cardboard shipping carton, large enough for at least 3 inch foam padding around the instrument.
- Do not use loose plastic foam pieces, which can shift during transport.
- Secure the box flaps with packaging tape or box staples.

3.1) Marking & Labelling:

- Components and their containers shall be identified by marking. Shipping marks shall be on all sides of package. The shipping marks shall be at least 3 inches high where space permits. Markings are to be in black paint or ink depending on shade of the package surface.
- Cautionary symbols to be stenciled in red waterproof paint or ink.

QA:CI:STD:PR:04 / Rev 03

- The gap between job and the box shall be filled with suitable material like jute, coir, thermo coal, etc.
- For export packing additional care shall be taken as per contract requirements if applicable. Otherwise, suitable box made of seasoned wood and / or plywood sheets of required thickness shall be used with suitable sea worthy packing protection.

4. Marking

- After completing the packing, Stencil marking, as per dispatch instructions and symbol marking as per Annexure – I shall be made. Please ensure the box is stenciled with “FRAGILE ITEM”, “HANDLE WITH CARE”.

5. Packing Slip

- A copy of the packing slip, kept in a polythene cover shall be kept inside the box. Another copy of the packing slip, kept in a polythene cover shall be kept outside the box and firmly fixed to the case.

6. Caution

- Do not pack any other Mechanical items with this case.

7. General

- These packing procedures are the minimum requirements in addition to the standard instructions mentioned in the Purchase Order and Specification.
- Deviation to meet the packing procedure requirements / non-clarity in packing approach in any quotation will be liable for rejection of offer.

ANNEXURE - 1

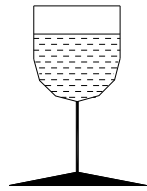

FRAGILE, HANDLE WITH CARE

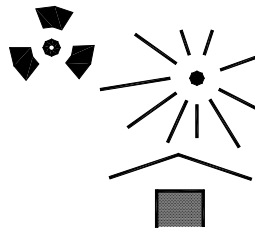

PROTECT FROM HEAT AND RADIOACTIVE SOURCES



USE NO HOOKS

NOTE: The design of heavy goods packages cannot always resist top lifting by grabhooks.



KEEP DRY

NOTE: Not all cases have waterproof internal liners; plywood used in the construction may not have a waterproof glue-line.

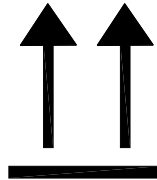

THIS WAY UP

NOTE: Certain designs of small cases make it difficult to distinguish top from bottom.

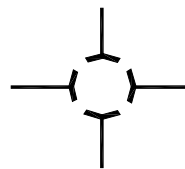

CENTRE OF GRAVITY

NOTE: This should be stencilled as a minimum on the two longest case sides (this information will normally be supplied by the manufacturer of the item(s) packed).

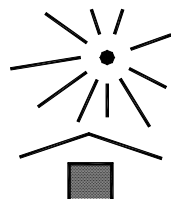

KEEP AWAY FROM HEAT

... kg max

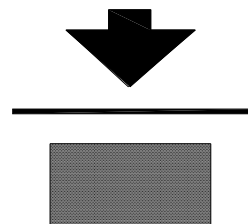

STACKING LIMITATION

NOTE: The maximum load in kilograms should be marked above the arrow.

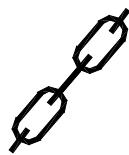

INTERNATIONAL "SLING HERE" SYMBOL

/ On Bidder's office letter pad /

Self-Declaration

Enquiry No.	GEM/2022/B/1940148
Enquiry Date	10.02.2022

In line with Government public procurement order Number P-45021/2/2017-B.E-II dated 15.06.2017, and further modified order dt.04.06.2020 issued by DPIIT,

I / We hereby declare that I / We are a "Local Supplier" meeting the requirement of minimum local content (.....%) defined in the above government notification for the goods against above mentioned enquiry Number.

Details of location at which local value addition will be made is as follows:

Door No.	
Street / Address 1	
Street / Address 2	
District	
State	
Country	
PIN Code	

We also understand that the false declarations will be considered as breach of Integrity and liable for action.

For Company Name:

Seal:

Signature:

Date:

Place:

(Please fill all the yellow color field)



MATERIALS MANAGEMENT / BOI

SUB-DELIVERY ENQUIRY DEVIATION FORMAT

Page : of

Schedule of deviation to
Sub-delivery Enquiry No. : **GEM/2022/B/1940148 dt 10.02.2022**

Description : **Sensor assembly for BHELSONIC SYSTEM**

Documents : **Specification: CI BS10 AUTOPURGE STASA R02**

Drawing No. : **3-97-585-21634 Rev 03**

Quality Plan : **QA:CI:STD:QP:73 Rev.00**

Packing Procedure : **QA:CI:STD:PR:04 Rev.03**

Document reference	BHEL called for	Firm's alternative offer

Certified that other than the above deviations, we are accepting all the other specifications and requirements in full to your Enquiry.

Station :

Date :

Signature of firm's representative

Firm seal

Note : 1. Deviations should be taken only in the extreme case
2. If necessary, use additional sheets with page control number

GEM/2022/B/1940148 dt 10.02.2022			
Sl no	Terms	Conditions	Vendor confirmation
1	Delivery term	Vendor shall quote unit price on FOR / BHEL Trichy stores basis inclusive of Packing & Forwarding, Freight & GST.	Quoted /Not quoted
2	Insurance	BHEL scope	Noted
3	Evaluation	Offer evaluation will be on Single Package basis .	Accepted
4	Delivery days	The indicated delivery days on GeM portal is from GeM PO receipt date. Delivery days shall inclusive of all the activities like manufacturing, inspection, Packing & Forwarding and dispatch.	Accepted
5	Payment term	100% direct payment within 60 days of issue of consignee receipt-cum-acceptance certificate (CRAC). MSE vendor payment will be made as per MSME act 2006 Any deviation in the above Payment Terms, any other conditions in payment terms or any other payment term will not be accepted and offers are liable to be commercially rejected.	Accepted
6	LD clause	As per present GEM T&C	Accepted
7	Guarantee period	18 months from the date of shipment (or) 12 months from the date of commissioning whichever is earlier	Accepted
8	HSN CODE	Indicate HSN code for quoted items	
9	GST	Pl Mention in GST % for quoted items	%
Document submission along with bid			
10	Attachments 1	Whether vendor belongs to MSE & Have you submitted Udyam registration certificate (To validate MSE status)	Yes / No
11	Attachments 2	Have you submitted filled ,sign & sealed point wise compliance for PQR with supporting documents . Please mention the corresponding page no also for each PQR point.	Yes / No
12	Attachments 3	Have you submitted Filled, signed & sealed “NIL Deviation Format ” .	Yes / No
13	Attachments 4	Have you submitted signed , sealed in the all pages of tender documents like “Technical Specification, Drawing /datasheet , testing procedure, Quality Plan & packing procedure” with respect to this tender along with offer.	Yes / No
14	Attachments 5	Have you Filled local content %, signed , sealed & submitted “Self declaration format for MII clause” as per BHEL format in your company letter head.	Yes / No
Note: vendor consents that the terms & conditions accepted, in GEM alone, shall be binding between BHEL and the Vendor; and no other terms mentioned, elsewhere in the un priced offer / Quotation will be considered / accepted by BHEL.			
VENDOR DETAILS			
1	Vendor Name		
2	Office Address		
3	Contact Person Name		
4	Mobile No		
5	E mail Id		
6	GSTN		

Vendor to fill & submit this Annexure with sign & seal along with offer .