

CAUTION: THE INFMM ON THIS DOCUMENT IS THE PROPERTY OF BHEL. IT MUST NOT BE USED DIRECTLY OR INDIRECTLY IN ANY WAY DETRIMENTAL TO THE INTEREST OF BHEL.

REV	DATE	ALTERED :
01		CHD & APPD :

FOR TOLERANCES OF UNTOLERANCED DIMENSIONS DURING MANUFACTURE REFER PLANT STD. NO TP 023 0299

- NOTES :** —
1. BOUNDARY DIMENSION AS PER ISO 3245.
 2. HARDNESS SHOULD BE 58 TO 65 HRC.

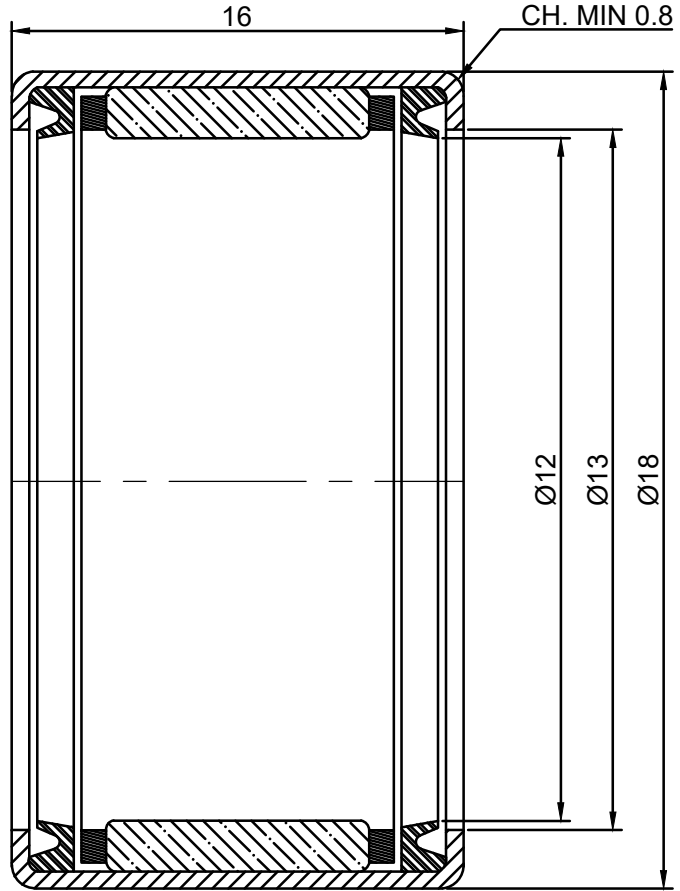

CALCULATION DATA		
BASIC DYNAMIC LOAD RATING	C	6.27 kn
BASIC STATIC LOAD RATING	Co	7.35kn
FATIGUE LOAD LIMIT	Pu	0.86kn



Bharat Heavy Electricals Ltd
 UNIT: HIGH PRESSURE BOILER PLANT
 TIRUCHIRAPALLI — 620014

DRN	NAME	SIGNATURE	DATE
	BIMAL CHOWDHURY	—SD—	25.10.2021
CHD	SRINIVASU ARUGULA	—SD—	25.10.2021
APPD	SARAVANAKUMAR G	—SD—	25.10.2021

DEPT	ALL DIMENSIONS ARE IN MM	PROJECTION	SCALE	WEIGHT (Kg)	REF TO ASSY / OLD DWG
FS			N.T.S	0.011	
CODE	129				

TITLE	DRAWING NO :	REV
NEEDLE ROLLER BEARING (FOR SCR CART)	4—SR—050—00017	00

05 - 213



GRAVIMETRIC FEEDER SPECIFICATION FOR RADIAL BALL BEARING GF-034

SPEC. No.

REV

01

MATERIAL CODE: 96-424-026 ✓

FEEDER SIZE: 36" ✓

NO. OFF/FEEDER: 12 ✓

LOCATION: INLET SPAN ROLLER
(65-736)

DESCRIPTION:



DEEP GROOVE RADIAL BALL BRG. WITH ONE SHIELD
SKF-6009-Z OR EQUIVALENT.



BASIC LOAD RATING:

STATIC - 12200 N. ✓

DYNAMIC - 21200 N. ✓

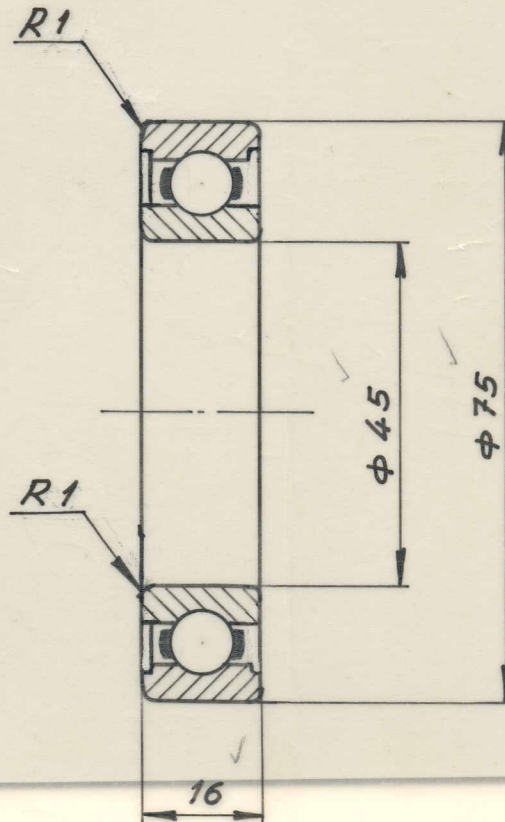

69

67

M/S STOCK PART NO. B-548

REV 01 6009-Z WAS 6009-RS1 CHANGED BASED ON THE MEETING HELD ON 26-07-90.

& "WITH ONE SHIELD" ADDED. *D.K. Raju* 6.8.90

	NAME	SIGN	DATE	MILLS & FEEDERS	SHEET NO.
PREPARED	R. Rengarajan.	<i>R. Rengarajan</i>	01 04 88		01
CHECKED	D. K. R.	<i>D. K. Raju</i>	22.4.88		NO. OFF SH.
APPROVED	M. A. S.	<i>M. A. S.</i>	22.4.88	01	

05 - 213



GRAVIMETRIC FEEDER SPECIFICATION FOR BALL BEARING

SPEC. NO

REV

GF.059

01

MATL CODE : 96-424-027

FEEDER SIZE : 36"

NO OFF/FEEDER : 1

LOCATION : 65-736

BELT DRIVE (HEAD
PULLEY ASSY)

DESCRIPTION :-

DEEP GROOVE BALL BEARING
SKF 6211 OR EQUIVALENT

△ BASIC LOAD RATINGS :-

STATIC - 25000 N.
DYNAMIC - 43600 N.

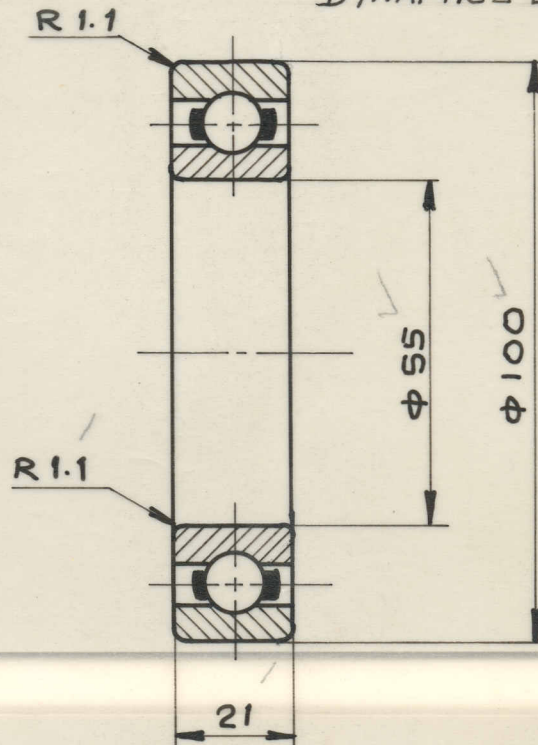

M/S STOCK PART No. B 551

REV. 01 BASIC LOAD RATINGS ADDED. D.K. Rindraal

01.03.90

	NAME	SIGN	DATE
PREPARED	R.SANKARAPANDI	R.Sankarapandi	22.4.88
CHECKED	D.K.R.	D.K. Rindraal	22.4.88
APPROVED	M.A.O.	M.A.O.	22.4.88

MILLS & FEEDERS

SH.No
01

No. OF SH

49
3



GRAVIMETRIC FEEDER SPECIFICATION FOR BALL BEARING

SPEC. NO REV.

GF-068 **03**

MATERIAL CODE: 96-424-022 / FEEDER SIZE: 36"

NO. OFF/FEEDER: 1 LOCATION: 65-736
(CLEANOUT CONVEYOR)

DESCRIPTION: Y-TYPE BALL BEARING WITH ECCENTRIC
LOCKING COLLAR. SKF-~~446209 D~~ ^{YEL 209} OR △03
FYH NA 209 OR EQUIVALENT. △01

BASIC LOAD RATING: DYNAMIC : 25 500 N (32078 N) * △01
STATIC : ~~18 600 N~~ (20012 N) * △03
21 600 N

NOTE:-

1. ★ APPLICABLE FOR FYH NA 209 BEARINGS.
2. OTHER DIMENSIONS ARE COMMON.

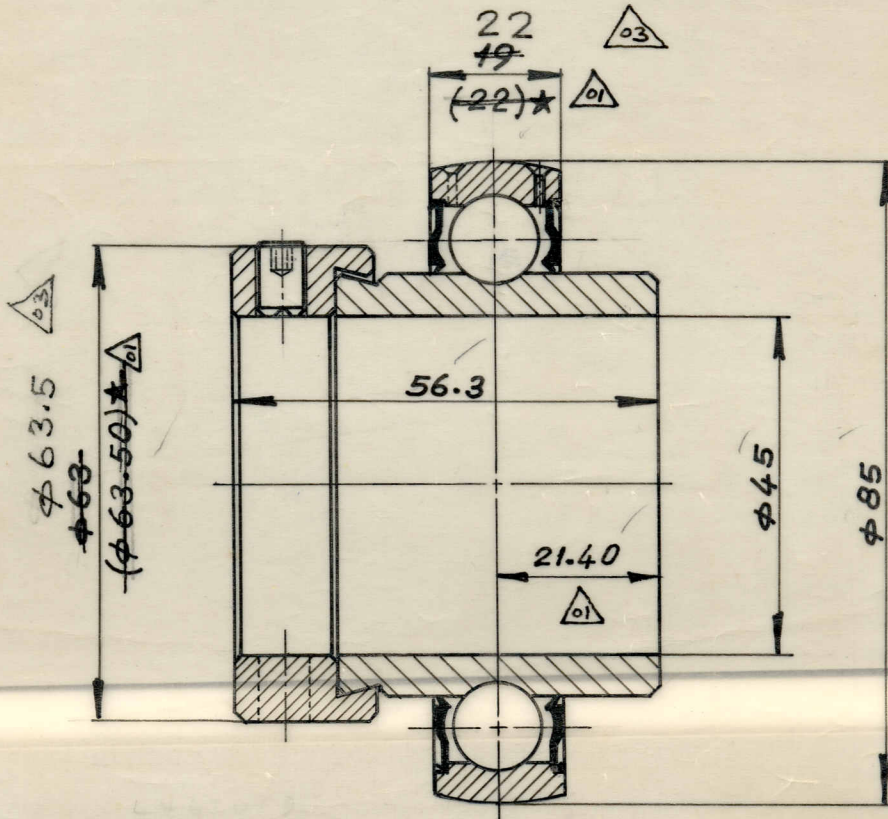

REV	SKF NO. WAS 446209 D.	
03	REVISED BASED ON SKF CATALOGUE. NOTE DELETED.	M/S STOCK PART NO. B-111
REV	FYH NA-209-28 BRG DIMNS. ADDED.	
01	NOTE ADDED.	REV 02 BRG. NO. WAS FYH-NA-209-28 REVISED BASED ON FYH CATALOGUE
	16.02.90.	17.6.93
NAME	SIGN	DATE
PREPARED	R. Rengarajan	23/04/88
CHECKED	P. K. Sundaran	23/04/88
APPROVED	M. A. Samy	23.4.88
MILLS & FEEDERS		SHEET NO. 1
		NO. OF SH. 1

BHARAT HEAVY ELECTRICALS LIMITED

TIRUCHIRAPALLI-620 014

Fuel Systems/PE (FB)



Title Sheet

***SPECIFICATION FOR
RADIAL BALL BEARING (24" Belt Type Feeder)***

SPECIFICATION NUMBER : GF-106

REVISION No. : 01

01	21.03.2006	Material code added Specn. prepared in Word.	D.V.K -Sd-
<i>Rev. No.</i>	<i>Rev. Date</i>	<i>Description</i>	<i>Chd. & Appd.</i>

	<i>Name</i>	<i>Signature</i>	<i>Date</i>
<i>Prepared</i>	<i>J.J</i>	<i>-Sd-</i>	<i>10.08.88</i>
<i>Checked</i>	<i>P.K.S</i>	<i>-Sd-</i>	<i>11.08.88</i>
<i>Approved</i>	<i>M.A.S</i>	<i>-Sd-</i>	<i>11.08.88</i>



SPECIFICATION FOR
RADIAL BALL BEARING

GF-106
REV.01

MATERIAL CODE : 964242360000 **FEEDER SIZE** : 24”
QUANTITY / FEEDER : 4 **PGMA** : 65-x24
LOCATION : 1. Clean-out conveyor take-up.
2. Belt take-up.
DESCRIPTION : Deep Groove Radial Ball Bearing.
SKF-6209-RS1 or equivalent.
BASIC LOAD RATING : Static : 18,600 N
Dynamic : 33,200 N.

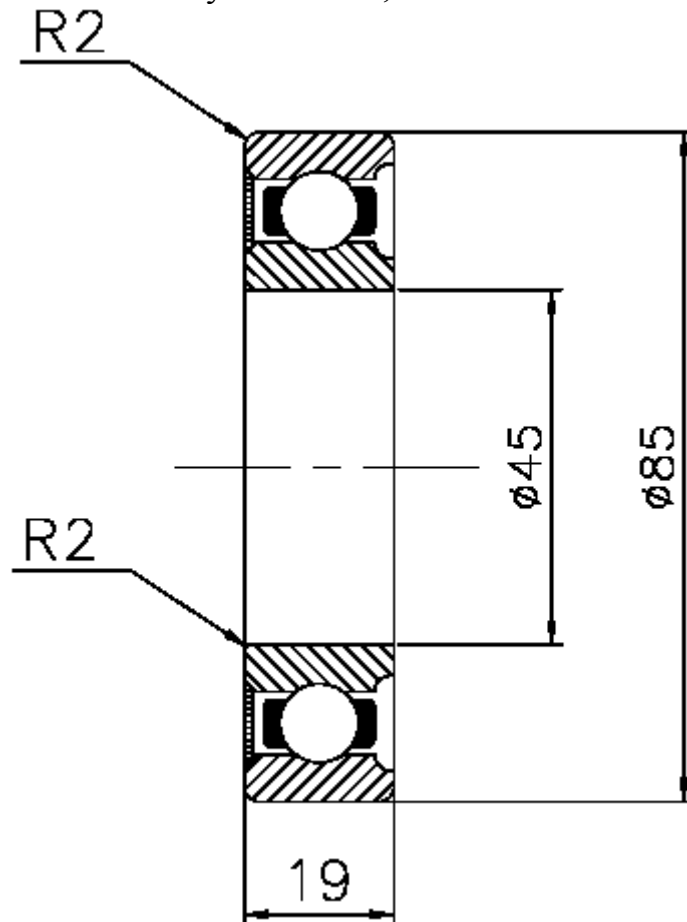

Stock part No.: B - 390

All dimensions are in mm



GRAVIMETRIC FEEDER SPECIFICATION FOR BALL BEARING

SPEC. NO.

REV.

GF-036

MATERIAL CODE: 96-424-020 ✓

FEEDER SIZE: 36"

NO. OFF/FEEDER: 6 ✓

LOCATION: 65-736

WEIGH SENSING SYSTEM,
WEIGH SPAN ROLL & WEIGH SPAN
ROLL WITH MOTION MONITOR.

DESCRIPTION: DEEP GROOVE BALL BEARING
SKF 6204 OR EQUIVALENT.

BASIC LOAD RATINGS: STATIC - 6200 N
DYNAMIC - 12700 N

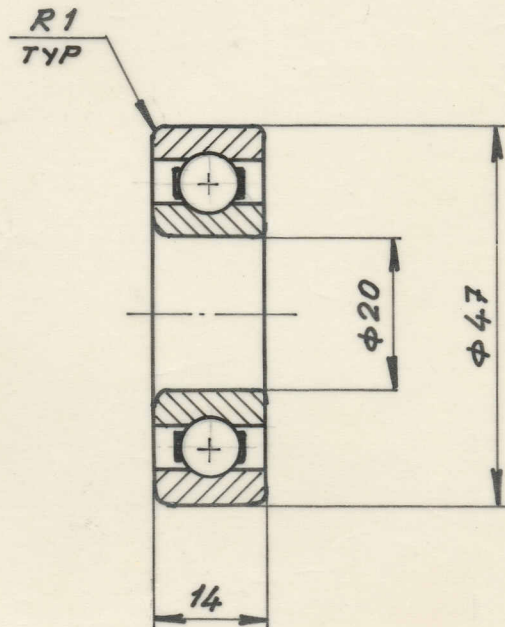

M/S STOCK PART NO. B-77

	NAME	SIGN	DATE	MILLS & FEEDERS	SHEET NO.
PREPARED	R. Rengarajan.	<i>R. Rengarajan</i>	19 04 88		01
CHECKED	D. K. R.	<i>D. K. R.</i>	22. 4. 88		NO. OF. SH.
APPROVED	M. A. C.	<i>M. A. C.</i>	22. 4. 88		