

Bharat Heavy Electricals Limited
ELECTRONICS DIVISION
Mysore Road, Bangalore - 560026

FACTORY SERVICES

NOTICE INVITING TENDERS

1. TENDER NUMBER : **BHE/315/11/2603/13 dt: 24/10/2011**
2. NAME OF WORK : Providing modular shelter to facilitate space for canteen services at BHEL-ESD premises, Bangalore.
3. ESTIMATED COST : Rs. 137.30 Lakhs (APPROX.)
4. EARNEST MONEY DEPOSIT : Rs.2.00 Lakhs
5. COMPLETION TIME : 06 Months
6. LAST DATE AND TIME FOR THE SUBMISSION OF DULY FILLED IN TENDER DOCUMENT : BEFORE 02:15 P.M ON 18-11-2011
7. PLACE OF SUBMISSION OF TENDER DOCUMENT : AT THE RECEPTION TENDER BOX /FS&T BHEL - ELECTRONICS DIVISION, MYSOREROAD, BANGALORE -560 026.
8. DATE AND TIME OF TECHNICAL BID OPENING : ON 18-11-2011 AT 02:30 PM

CONTRACTOR

EMPLOYER

NOTE: The Tenderer shall return the duly filled in Tender document after affixing signature on all pages and submit.

TO,
AGM /FACTORY SERVICES - CIVIL
BHEL – ELECTRONIC DIVISION
MYSORE ROAD
BANGALORE – 560026.

Bharat Heavy Electricals Ltd
Electronics Division
Mysore Road, Bangalore – 560026

Tender Document

FOR

Providing Modular shelter to facilitate space for canteen
services at BHEL-ESD premises, Bangalore

TECHNICAL BID

DATE OF OPENING

18/11/2011

Part – I	} Technical cum Commercial Bid	44 Pages
Part – II		

Note: Part – I: To be submitted in a separate sealed cover.

Part – II: To be submitted in a separate sealed cover.

Earnest Money Deposit of Rs. 2.00 Lakhs to be submitted
in a separate sealed cover.

Part-I, Part-II & EMD sealed covers should be put in outer
envelope and Super scribing the Name of work and Name
& Address of the Tenderer.

PART-I

BHARAT HEAVY ELECTRICALS LIMITED, ELECTRONICS DIVISION
MYSORE ROAD, BANGALORE-560026

DEPARTMENT: FACTORY SERVICES

SECTION : **CIVIL**

REF.TENDER ENQUIRY NO: BHE/315/11/2603/13 dt: 24/10/2011

TECHNICAL-CUM-COMMERCIAL BID

(To be furnished by the Bidders)

- 01. NAME OF THE WORK : **Providing modular shelter to facilitate space for canteen services at BHEL-ESD premises,Bangalore..**
- 02. APPROXIMATE ESTT.COST RS. : 137.30 Lakhs
- 03. COMPLETION PERIOD : **06 MONTHS** (FROM DATE OF COMMENCEMENT)
- 04. NAME OF THE CONTRACTOR :
- 05. ADDRESS
 - (A) OFFICE :
 - TEL. PH. NO. :
 - (B) RESIDENCE :
 - TEL.PH NO :
- 06. QUALIFICATION :
- 07. STAFF STRENGTH :
 - (A) TECHNICAL :
 - (B) GENERAL :
- 08. PLANT/EQUIPMENTS : List enclosed/not enclosed
- 09. IN CASE OF TENDER DOCUMENT DOWNLOADED FROM WEBSITE, THE RELEVANT TENDER DOCUMENT FEE OF RS 1000/- IN THE FORM OF DD IN FAVOUR OF BHEL EDN, BANGALORE SHALL BE SUBMITTED ALONG WITH TECHNICAL BID & FURNISH THE DETAILS :
- 10. a) SCOPE OF WORK : UNDERSTOOD/ NOT UNDERSTOOD
(As per schedule of items)
- b) ACCEPT TO EXECUTE IN TOTAL : YES/ NO

CONTRACTOR

EMPLOYER

11. AUDITED BALANCE SHEET FOR THE LAST
3 YEARS (Enclose Documents) :
12. SOLVENCY (not less than 10% of Estimated cost) :
(Certificate from the Bank not older than One year
to be furnished)
13. EXPERIENCE CERTIFICATE SUCCESSFULLY COMPLETED
SIMILAR CIVIL WORKS DURING LAST 7 YEARS
(Copy of completion certificate to be enclosed)
 - (A) Three similar completed works (each not less
than 40% of the Estimated cost) OR :
 - (B) Two similar completed works (each not less
than 50% of the Estimated cost) OR :
 - (C) One similar completed works not less
than Equal to 80% of Estimated cost :
14. EMD PARTICULARS :
 - (A) CASH :
 - (B) DEMAND DRAFT :
15. ACCEPTANCE
 - (A) DRAWINGS : Acceptable/ Not acceptable
 - (B) DESIGNS : Acceptable/ Not acceptable
16. a). WHETHER REGISTERED WITH GOVT. AGENCIES
SUCH AS CPWD/STATE PWD/MES/RAILWAY/
OTHER PUBLIC SECTOR UNDERTAKINGS : Yes/No
 - b) If yes, VALIDITY OF REGISTRATION/DETAILS : Copy Enclosed/Not Enclosed
17. a) BHEL'S PAYMENT TERMS : ACCEPTABLE / NOT ACCEPTABLE
 - b) Whether agreeable to make necessary
Statutory payments as per BHEL EDN terms : YES/NO
18. a). Whether registered with ESI/PF authority : YES/ NO
and have Registration No. (If yes indicate nos.)
 - b) Constitution of Firm : Individual / Sole Proprietorship Concern /
Partnership Firm / Public Ltd. Company/
Private Ltd. Company
19. Electronic Funds Transfer (EFT) form enclosed : Please fill up the form in ANNEXURE-II
(Ref. Page No. 43 – Tender document)
20. PAN Card details : Please enclose PAN Card details
21. Service Tax Registration No. : Please enclose Service Tax Registration No.

NOTE: Sl.no. 11,12 & 13 are essential criteria.

CONTRACTOR

EMPLOYER

Bharat Heavy Electricals Limited
ELECTRONICS DIVISION
MYSORE ROAD- BANGALORE-26

INSTRUCTIONS TO TENDERER

1. Sealed Tender for the above noted work is hereby invited from Contractors experienced in works of similar kind and magnitude.
2. Tenders should be addressed to the AGM /FS-CIVIL Electronics Division, Bharat Heavy Electricals Limited, Mysore road, Bangalore – 560 026. In two separate sealed cover for “Technical cum Commercial Bid” and Price Bid duly super scribed and put in a outer envelope, super scribing the Name of work and Name and address of the Tenderer.
2. a The local address of the Contractors, the name of the person to whom all the Correspondence are to be addressed should be indicated, with telephone number (both office and residence).
3. All entries in tender documents should be in one ink (preferably blue ink). Erasing and overwriting is not permitted. All corrections should be duly signed by tenderer concerned.
4. Tenderers shall fill in all the required particular in the blank space provided for this purpose in the tender documents and also sign in each and every page of the tender document including the drawings attached there to before submitting tender.
5. Unit rate should be quoted in figures as well as in words in Indian Currency only i.e. Rupees and Paise with reference to each item and for the items shown in the attached schedule. These rates shall be for the finished work at site. The rate shall include all taxes and duties payable on account of Octroi, Sales Tax, tax on work contract etc., and also expenses towards PF and ESI contributions (see clauses 8, 39 and Annexure ‘C’). Amount of each item and total on each sheet as also the grand total amount of the whole contract shall be filled by the tenderers.
6. In case the rate quoted in figures differs from those quoted in words, the lower of the rates quoted will be taken as the tendered rate and shall be binding on the tenderer.

7. The rate to be quoted by the tenderer shall be firm and shall cover and include all statutory levies such as “Octroi, sales tax, excise duty etc., arising from Act passed by Parliament or State Legislature and rules framed there under. The rates shall further be deemed to include statutory levies arising from such Acts, Central or State, which may come into force, subsequent to submission of tenders. The tenderer shall note that claim for variation of rates, on the ground that existing statutory levies have been increased/decreased or those new statutory levies have come into effect after tender, or on any other ground, will be entertained as applicable.
8.
 - (a) The rate quoted in the tender shall remain valid for a period of ‘ THREE MONTHS’ from the date of opening tender.
 - (b) Tenderer shall not increase quoted rates, once the tenderer has submitted offers/quotation/price and during execution of contract in case tender is accepted.
 - (c) Successful bidder should execute the work strictly in accordance with Tender schedule quoted rates as accepted by BHEL.
9. Quantities shown in the schedule are only approximate and are liable to variation to an extent of 20% (Twenty percent). Within this variation, the contractor is entitled for compensation.
10. Before tendering, the tenderer are advised to inspect the site of work and its environments and be well acquainted with the actual working and other prevailing conditions, position of material and labour. They should be well versed with BHEL General Conditions of Contract instruction to the tenderers, drawing and specification and all other documents which form part of the agreement to be entered into subsequent to award of work. The tenderer should be specially note that it is tenderers responsibility to provide any items which is not specifically mentioned in the specifications and drawing, but which is necessary to complete the work.
11. Details and quantities of each item of work shown in the bill of quantities attached here to only approximate. They are given as a guide for the purpose of tendering only and are liable for variation and alteration at the discretion of the competent authority. The work under each item as executed shall be measured and price at the corresponding rates to be quoted by the Contractor in the bill of quantities attached hereto.

12. Should a tenderer find discrepancies or omission in the drawing attached to the tender documents or should be in doubt as to their meaning he should at once address to the authority inviting the tender for clarifications. Every endeavor is made to avoid any error which can materially affect the basis of the tender but successful tenderer shall take upon himself to provide for the risk of any error which may be subsequently discovered and shall make no subsequent claim on account thereof.
13. In the event of the tender being submitted by a firm the tender must be signed separately and legibly by each partner or member of the firm or in their absence, by the person holding the power of Attorney on behalf of firm concerned. In the later case, a copy of the power of Attorney duly attested by the Gazetted Officer must accompany the tender.
14. If in any case, the date of Tender Opening falls on holiday, the Tender will be opened on the next working day.
15. Every tender must be accompanied by Earnest Money Deposit. This earnest money will be refunded to the unsuccessful tenderer after finalization of the award of work. In the case of successful tenderer, the earnest money will be retained as a part of Security Deposit for satisfactory completion of the work in accordance with Clause-16 of BHEL General Conditions of the Contract. Tenders without Earnest Money Deposit receipt are liable to reject. No interest will be paid on the earnest money deposit.
16. The Earnest money deposit may be furnished in any of the following forms:
 - a) Cash.
 - b) Pay order.
 - c) Demand Draft in favour of BHEL EDN, Bangalore – 560026.
17. For reimbursement of Earnest Money Deposit, the tenderer should fill the enclosed EFT form, obtain the Banker's signature and also enclose a photocopy of cancelled cheque leaf.
18. Unless the bidder whose tender is accepted signs contract agreement within fifteen days (15 days) of the date of the order directing to do so, the amount of Earnest Money already deposited by bidder will be forfeited and acceptance of the tender withdrawn.

19. If after opening of tenders a tenderer revokes the tender or increase of earlier quoted rates or after acceptance of his tender does not commence the work in accordance with the instruction of Engineer-in-charge, the Earnest Money Deposited by bidder will be forfeited and acceptance of bidder's tender withdrawn. If only a part of work included in the tender had been awarded to the tenderer, the amount of Earnest Money to be retained will be based on value of the contract so awarded.
20. The BHARAT HEAVY ELECTRICALS LIMITED reserve the right to reject any or all the tenders received or accept any tender or part thereof without assigning reason thereof. In the case of acceptance of a part of tender, the time for completion may also be reduced to the extent considered necessary by the accepting authority.
21. Conditional and Unsigned tenders, tenders which are incomplete or otherwise considered defective, tenders which are not in accordance with the tender conditions laid down by the accepting officer and tenders not submitted in the prescribed forms are liable to be rejected.
22. The tenderers should enclose relevant documents regarding constitution of firm i.e. Individual / Sole Proprietorship Concern / Partnership Firm / Public Limited Company / Private Limited Company to satisfy Clause 17(b) , Part –I of NIT.
23. The tenders should be enclosed with a list of contracts already held by the tenderer at the time of submitting the tender and giving the following particulars:
 - a) Name of the work, value and address.
 - b) The balance work remaining to be done on the same.
24.
 - a) The filled in tender sealed cover should be dropped in the Tender box kept in the reception of BHEL-EDN, in case the sealed tender document is large and not possible to drop the same in the Tender box, it should be handed over at office of AGM/FS-CIVIL before the time fixed for submission of tender.
 - b) Tenders received after the due date & time of opening of tenders will be rejected.

25. The Contractors responsibility under this contract shall commence from date of receipt of the order or acceptance of tender.
26. If proprietor or partner of a firm expires after the submission of tender or after the acceptance of tender, BHEL reserves the right to cancel the contract if the character of the firm undergoes a substantial change.
27. THE BHARAT HEAVY ELECTRICALS LIMITED will not be bound by any power of Attorney granted by the tenderer or changes in the composition of firm made subsequent to signing of the contract. They may however recognize such power of Attorney and changes after obtaining proper legal advice.
28. If the tenderer deliberately gives wrong information on tender regarding past unsatisfactory performance with BHEL sister units, BHEL reserves the right to reject such tender at any stage including contract execution period.
29. Words imparting the singular number shall also be deemed to include the plural number and vice-versa where the context so require.
30. The General and Special Conditions are complementary to each other and where they are in conflict, the special condition shall prevail.
31. The expenses for completing the stamping agreement shall be paid by the contractor.
32. Unless or otherwise stated above tendered work includes supply, erection, testing and commissioning of equipments as agreed to in the contract.
33. After completing of the job, the contractor has to furnish actual drawings of work done in consultation with Engineer-in-charge.
34. Any covering letter and comments of the tenderer should be submitted along with the offer.
35. Cement and steel for carrying out Civil Works will have to be procured by the Contractor.
36. The Contractor shall provide all the materials needed for trial run, testing including chemicals, consumables etc. In quoting their rates, the Contractors are advised to take into account the cost of the above materials.
37. Should a tenderer or a contractor has a relative or in the case of firm or company, any of its share holders relative is employed in Bharat Heavy Electricals Limited, the authority inviting tenders shall be informed of this fact at the time of submission of the tender, failing which tender may be disqualified or if such fact subsequently comes to light.

38. These 'INSTRUCTIONS TO TENDERER' & GENERAL CONDITIONS OF CONTRACT OF BHEL' shall be deemed to form an integral part of the Contract agreement for the work to be entered into. The Contractor has to scrutinize the same, and when submitting his tender, indicate his acceptance of both. In cases of variation between the two in any matter, the conditions in the 'THE INSTRUCTIONS TO TENDERER' shall prevail. (Extracts of important clauses of BHEL GCC are enclosed).
39. All operations to be carried out by the Contractor during the execution of the contract such as drilling, welding etc., shall be done with proper equipments to be brought by the tenderer. Suitable power point will be provided and tapping from the power point equipment shall be done using proper size of cables equipments and after getting approval of connections from our Engineer-in-charge.
40. The Contractor shall comply with the provision of Employees Provident Fund's and miscellaneous Provisions Act 1952 and rules, regulations and other orders issued there under. He as an employer shall be liable to pay employer's contribution/deductions towards PF under the PF Act in respect of all labour employed by him for the execution of the contract in accordance with the provisions of the Employees' Provident Funds and Miscellaneous Provisions Act, 1952 as amended from time to time. For this purpose he shall indicate the code number obtained from the Regional Provident Fund Commissioner or he should obtain a code number if he has not and produce the Photostat copy of the challan receipt of monthly remittance of the contribution made by him to the Commissioner. He shall also furnish such returns such returns as are due, under the Act, to be sent to the appropriate authorities through the Principal Employer".
41. The Contractor should get himself registered with the E.S.I Authorities as an independent Employer, obtain a separate code number and remit the dues in respect of the Labour employed by him for the work and produce the challans/Receipts of remittance of the ESI contributions due under the E.S.I Act to the Company authorities. He shall also furnish such returns, as are due, under the Act, to be sent to the appropriate authorities' through the Principal Employer. The contractor can remit their ESI & PF through a sub-agent who processes the ESI & PF code and agrees to enter an MOU with the contractor.

42. If any action is brought in by P.F. Commissioner/ESI authorities on BHEL for the work done by the Contractor for his labourers regarding PF/ESI amount due, short remittances, non remittances etc., the Contractor shall defend the case on behalf of BHEL and / or reimburse BHEL the expenses so incurred.
43. The Contractor shall apply and obtain license under Contract labour(R&A) Act 1970 and comply the relevant provisions of this Act in respect of the labour employed by him for executing this contract. The contractor shall furnish necessary returns to the authority through the Principal Employer.
44. Contractor shall insure all his labourers and material. Any claim by his Employees for damages shall be settled by the Contractor even if action is against BHEL or to reimburse the legal expenses incurred by BHEL.
45. Any action brought in by anybody on BHEL regarding patent, right etc., used by Contractor in execution of work shall be defended by the Contractor and / or reimburse BHEL the cost of the same.
46. Contractor shall produce necessary records, documents; explanation whenever he is called upon to do by any Government Agencies.
47. Contractor should obtain “Workmen Compensation Policy” for their Employees.
48. LEAD, LIFT, DEWATERING ETC.,
 - a) Unless otherwise specified in the tender schedule, the rates for all items will be deemed to include all leads, lifts and descents involved in the work.
 - b) No separate payment will be made for dewatering (including seepage, surface drainage and monsoon water) desludging and allied operations at any stage of the work, and the cost of such operations will be deemed to be included in the contract rates.
 - c) No separate payment will be made for curing including pumping of curing water where ever necessary.

49. EXTRA ITEMS

No extra items of work shall be carried out by the contractor other than those authorized to do so in writing by the Engineer. For any such items of work executed as per instructions of Engineer. The rates will be fixed on the basis indicated under clause 50 of BHEL GCC.

The schedule of rates to be followed in this case will be CPWD schedule of rates.

50. REVERSE AUCTION

- BHEL reserves the right to go for reverse auction at any point of time before opening of Price Bid
- Bids with non-acceptance of reverse auction will be liable for rejection.
- Opening of Price Bid at discretion of BHEL.
- BHEL shall be at liberty to cancel the tender at any time, before ordering, without assigning any reason.

BHARAT HEAVY ELECTRICALS LIMITED
(ELECTRONICS DIVISION)
MYSORE ROAD- BANGALORE-26
GENERAL CONDITIONS OF CONTRACT

It is hereby agreed by me/us that the BHEL General Conditions of Contract including subsequent amendments/ additions/deletions to clauses if any, and conditions pertaining the settlement of disputes by Arbitration form an integral part of the tender documents and that the tender submitted by me/ us is subject to the aforesaid BHEL General Conditions of Contract which has been read and accepted by me/us.

ENCLOSURE: A

CLAUSE 20 OF GENERAL CONDITIONS OF CONTRACT

LABOUR

The Contractor shall employ labour in sufficient numbers either directly or through sub-contractors to maintain the required date of progress and of quality to ensure workmanship of the degree specified in the contract and to the satisfaction of the Engineer-in-charge. The contractor shall not employ in connection with the works any person who has not completed his eighteen years of age.

The contractor shall furnish to the Engineer-in-charge at the intervals specified by him. A distribution return of the number and description by trades of the work people employed on the works. The Contractor shall also submit on the 4th and 19th or every month to the Engineer-in-charge a true statement showing in respect of the second half of the preceding month and the first half of the current month (I) the accidents that occurred during the said fortnight showing the circumstances under which they happened and the extent of damage and injury caused by them and (ii) the number of female workers who have been allowed maternity benefits as provided in the maternity benefit Act, 1961 or Rules made there under and the amount paid to them.

The contractor shall pay to labour employed by him either directly or through sub-contractors wages not less than fair wages as defined in the contractors Labour Regulations.

The Contractor shall in respect of labour employed by him either directly or through sub-contractors complies with or causes to be complied with contractors labour Regulations in regard to all matters provided therein.

The Contractors shall comply with the provisions of the payment of wages Act, 1936, Minimum Wages Act, 1948, Workmen's Compensation Act 1923, Industrial Disputes Act, 1947, Maternity Benefit Act 1961 or any modifications there of or any other law relating thereto and rules made there under from time to time.

The Contractors shall be liable to pay his contribution and the employees' contribution of the State Insurance Scheme in respect of all labour employed by him for the execution of the contract, in accordance with the provision of "The Employees', State Insurance Act, 1948", as

CONTRACTOR

EMPLOYER

amended from time to time. The Contractors shall apply to the ESI Authorities, get himself registered with them and obtain a code Number. He shall pay the remittances under his code Number only.

The Contractor shall be liable to pay his contribution and the Employees' contribution towards PF as per Provident Fund Rules and Regulations in respect of all labour employed by him for the execution of the contract. The contractor shall apply to the PF Authorities, get himself registered and obtain a code number from them. He shall pay the remittances towards PF under his code Number only.

The Engineer-in -charge shall on a report having been made by an Inspecting Officer as defined in the Contractors Labour Regulations have the power to deduct from the moneys due to the Contractor any sum required or estimated to be required for making good the loss suffered by a worker or workers by reason of non fulfillment of the conditions of the contract for the benefit of workers, non - payment of wages or of deductions made from him or their wages which are not justified by the terms of the contract of non observance of the said contractor's Labour Regulations.

The Contractors shall indemnify the BHEL against any payment to be made under and for observance of the Regulation aforesaid without prejudice to his right to claim indemnity from these sub-contractors.

MODEL RULES FOR LABOUR WELFARE

The Contractor shall at his own expense comply with or cause to be complied with model Rules for Labour Welfare as appended to these conditions or rules framed by Government from time to time for the protection of health and for making sanitary arrangements for workers employed directly or indirectly on the works, In case the Contractors fails to make arrangements as aforesaid the engineer-in-charge shall be entitled do so and recover the cost thereof from the contractor.

ENCLOSURE: B

CLAUSE 38 OF BHEL GENERAL CONDITIONS OF CONTRACT
INSURANCE OF WORKS AGAINST DAMAGE AND LOSS DUE TO FIRE, STRIKE,
TEMPEST, FLOODS, EARTHQUAKE, RIOT AND AGAINST DAMAGE BY AIRCRAFT

The Contractor shall, within one month after the date of acceptance of the contract, insure the work against loss and damage by fire, tempest, floods, earthquake, riots, strike & against damage by air-craft with an insurance office approved by the Accepting officer from the date of acceptance of work or actual commencement of work whichever is earlier. Such insurance shall be effected in the name of BHEL and shall be for the full value of the contract sum. The contractor shall lodge with the BHEL the policies and receipts of the premiums for such insurance and shall maintain such policies in force until the entire completion of the work as certified by the Senior Engineer.

If the contractor fails to comply with the terms of this condition the Accepting Officer may insure the work and may deduct. The amount of premium from any money that may become payable to the contractor or may at his discretion refuse payment of any advance to the contractor until the contractor shall have complied with the terms of this condition.

Such insurance whether effected by the Accepting Officer or the Contractor shall not be a limit or bar to the liability and obligation of the contractor to complete the entire work in all respects as certified by the Senior Engineer.

In case of such a loss or damage as aforesaid, the money payable under any such insurance shall be received and may be retained by the BHEL until the work is finally completed and shall then be credited to the contractor in the final statement of accounts in the event of the contract not having been previously cancelled under these conditions after taking into account the delay in completion, settlement to his workers for damages, damage to BHEL property etc.

CONTRACTOR

EMPLOYER

SAFETY CODE
RESPONSIBILITIES OF THE CONTRACTOR IN RESPECT OF
SAFETY OF MEN, EQUIPMENT, MATERIAL AND ENVIRONMENT

1. Before commencing the work, contractor submits a “SAFETY PLAN” to the authorized BHEL Official. The ‘SAFETY PLAN’ shall indicate in detail the measure that would be taken by the contractor to ensure safety of men, equipment, material and environment during execution of the work. The plan shall take care to satisfy all requirements specified hereunder. The contractor shall submit Safety Plan along with his offer. During negotiations before placing of work order and during execution of the contract BHEL shall have right to review and suggest modification in the Safety Plan. Contractor shall abide by BHEL decision in this respect.
2. The contractor shall take all necessary safety precautions and arrange for appropriate appliances as per direction of BHEL or its authorized officials to prevent loss of human lives, injuries to personnel engaged, and damage to property and environment.
3. The contractor shall provide to its work force and ensure the use of the following personal protective equipment as found necessary and as directed by the authorized BHEL officials:-Safety Helmets conforming to IS-2925: 1984.
 - (i) Safety Belts conforming to IS-3521: 1983.
 - (ii) Safety Shoes conforming to IS-1989: 1978.
 - (iii) Eye and Face protection devices conforming to IS-8520: 1977 and IS-8940: 1978.
 - (iv) Hand and body protection devices conforming to:
 - IS-2573: 1975
 - IS-6994: 1973
 - IS-8807: 1978
 - IS-8519: 1977

All tools, tackles, lifting appliances, material handling equipment scaffolds, cradles, safety nets, ladders, equipment’s etc. used by the contractor shall be of safe design and construction. These shall be tested and certificate of fitness obtained before putting them to use and from time to time as instructed by authorized BHEL official who shall have the right to ban the use of any item.

All electrical equipment's, connections and wiring for constructions power, its distribution and use shall conform to the requirement of the Indian Electricity Act and Rules. Only electricians licensed by the appropriate statutory authority shall be employed by the contractor to carry out all types of electrical works. All electrical appliances including portable electric tools used by the contractor shall have safe plugging system to source of power and be appropriately earthed. The contractor shall not use any hand lamp energized by electric power with supply voltage of more than 24 volts. For work in confined space lighting shall be arranged with power sources of not more than 24 volts.

The Contractor shall adopt all fire safety measures as laid down in the "Code for fire Safety at Construction Sites" issued by the Safety Department of the Construction Management (HQ) of BHEL and as per directions of the authorized BHEL official. A copy of the above referred "Code of Fire Safety at the Construction Sites" shall be made available by BHEL to the contractor for reference, on demand by the contractor, during tendering stage itself.

Where it becomes necessary to provide and/or store petroleum Products, explosives, chemicals and liquid or gaseous fuel or any other substance that may cause fire or explosion, the contractor shall be responsible for carrying out such provisions and/or storage in accordance with the rules and regulations laid down in the relevant government acts, such as Petroleum Act, Explosives Act, Petroleum and Carbides of Calcium Manual of the Chief Controller of Explosives, Govt. of India. etc., prior approval to the authorized BHEL official at the site shall also be taken by the contractor in all such matters.

The contractor shall arrange at his cost (wherever not specified) appropriate illumination at all work spots for safe working when natural daylight may not be adequate for clear visibility.

The contractor shall be held responsible for any violation of statutory regulations local, state or central and BHEL instructions that may endanger safety of men, equipment, material and environment in his scope of work or another contractor or agencies. Cost of damages if any, to life and property arising out of such violation of statutory regulations and BHEL instructions shall be borne by the contractor.

CONTRACTOR

EMPLOYER

In case of a fatal or disabling injury accident to any person at construction sites due to the lapses by the contractor, the victim and/or his/her dependents shall be compensated by the contractor as per statutory requirements. However, if considered necessary, BHEL shall have the right to impose appropriate financial penalty on the contractor and recover the same from payments due to the contractor for suitably compensating the victim and/or his/her dependents. Before imposing any such penalty, appropriate enquiry shall be held by BHEL giving opportunity to the contractor to present his case.

In case of any damage to property by the contractor, BHEL shall have the right to recover cost of such damages from payments from payments due to the contractor after holding an appropriate enquiry.

In case of any delay in the completion of a job due to mishaps attributable to lapses buy the contractor; BHEL shall have to recover cost of such delay from payments due to the contractor, after notifying suitably and giving him opportunity to present his case.

If the contractor fails to improve the standards of safety in its operation to the satisfaction of BHEL after being given a reasonable opportunity to do so; and/or if the contractor fails to take appropriate safety precautions or to provide necessary safety devices and equipment or to carry out instructions regarding safety issued by the authorized BHEL official, BHEL shall have the right to take corrective steps at the risk and cost of the contractor after giving a notice of not less than seven days indicating the steps that would be taken by BHEL.

The contractor shall submit report of all accidents, fires and property damage, dangerous occurrence to the authorized BHEL official immediately after such occurrence, but in any case not later than twelve hours of the occurrence. Such reports shall be furnished in the manner prescribed by BHEL. In addition, the contractor to the authorized BHEL official shall also submit periodic reports on safety from time to time as prescribed.

Before commencing the work, the contractor shall appoint/nominate a responsible officer to supervise implementation of all safety measures and liaison with his counterpart of BHEL.

If safety record of the contractor in execution of the awarded job is to the satisfaction of Safety Department of BHEL, issue of an appropriate certificate to recognize the safety performance of the contractor may be considered by BHEL after completion the job.

SPECIAL CONDITONS OF CONTRACT

1. GENERAL

The special conditions of contract and other contract documents are complimentary to each other and shall be read in conjunction with each other. In case of any conflict of meanings between the special conditions of contract and the BHEL General Conditions of Contract the provisions of the special conditions of contract shall override the corresponding provisions of the BHEL General Conditions of Contract.

2. SCOPE OF WORK

The scope of work includes for the full, final and entire completion of all Civil Engineering works as detailed in specifications and drawings, which forms part of this Contract. The scope of work also includes cleaning/removing all debris beyond 200 mtrs or as stipulated in the item schedule from building location and leveling the areas as per direction of the Engineer-in-charge.

The scope of work under this contract shall cover supply of all materials, labour, tools, and plants etc., unless otherwise specified in the specifications, descriptions of items or in foregoing clauses.

3. SITE CONDITIONS

a) Before tendering the Contractor shall get themselves acquainted with site conditions such as the nature of soil likely to be encountered during the course of the work etc,. The rates quoted by the contractor shall be deemed to have been quoted after getting acquainted with the prevailing site conditions. Initial jungle clearance, stripping of top soil etc., shall also be included in the quoted rates. No claims on the pretext of ignorance of site conditions shall be entertained.

b) The site of work is as mentioned in the Tender document.

4. SITE FACILITIES: -

A. LAND

The Employer will allot land as available free of cost to the contractor for his office stores. He must maintain the areas allotted to him in a neat and clean conditions as required by the Employer. The contractor shall provide adequate storage and office facilities with approval from the Engineer. The rate quoted by the contractor shall be deemed to include for these and no separate payment will be made towards these.

On completion of work, the site shall be cleaned by the contractor of all materials, temporary debris, rubbish plants and equipment's, belonging to the contractor at no extra cost. The site and surroundings shall be handed over in a neat and clean condition. In case of any failure by the contractor, the employer will get inside cleared at risk and cost of the Contractor.

B. POWER AND WATER SUPPLY

Subject to availability water and electricity for the work may be provided by BHEL at one point and the contractor will have to make further arrangements for utilizing the supply from other points if required cost there of shall be recovered from the contractors from the bills due to them at the prevailing cost rates worked out by BHEL. At present, the cost rates of recovery by BHEL are Rs.15.00/- per1000 liters of water and Rs.5.90 per unit of Electricity. BHEL is not responsible for any failure of water/electricity supply and the contractor will have to make his own arrangements for the same, without claiming any extra rate.

5. MACHINERY

The Contractor shall at his own expense, supply all tools, plant and equipment (hereinafter referred to as T & P) required for execution of contract, as specified in the tender documents.

No. P.O.L. can be supplied by the Employer.

- a) The whole of the works shall be executed in perfect conformity with the specifications and drawings. If contractor perform any works in a manner contrary to the specifications and drawings and without reference to the Engineer he shall bear all the costs arising or ensuring there from.

- b) All technical documents regarding the construction of works are given in the metric system and work should be carried out according to metric system.
- c) The work shall be carried out as per detailed drawings supplied by the employer. Only two copies of the working drawings shall be supplied progressively to the contractor free of cost. The contractor shall keep one set of drawings at his own expenses always available at site for reference of Engineer-in-charge and other representatives.
- d) In case the contractor desires to obtain additional copies of drawings, the same shall be supplied by the Employer on payment of charges as fixed by the Engineer-in-charge.
- e) The works shall be carried out as per detailed specifications enclosed with the tender. For items for which there is no mention in the drawings, detailed specification relevant IS specification (latest edition) shall be followed.
- f) The contractor shall submit to the Employer for their approval complete drawings, of all temporary works and staging which he may require for carrying out the works shown in the drawings. He shall at the same time if so required by the Employer submit his calculations relating to strength and anticipated deflection in respect of any aforesaid temporary works. He shall also submit for the approval of Employer drawings showing the methods he proposes to adopt for the erection of the various parts of the temporary works. Any modification to the drawings that may be required by the Employer shall be made by the contractor at his own cost. However, notwithstanding the approval of modification required for temporary works, the contractor shall be fully responsible for their efficiency, security and maintenance and for all obligations and risks in regard to such works, specified or implied in this contract and he shall reinstate the same at his own cost, should any mishap or accident occur causing damage or injury there from, subject however, to such clauses of the General conditions as may be applicable in such cases.

6. BENCH MARKS AND REFERENCE POINTS

The contractor shall construct and maintain proper benchmarks and reference points of the inter section of all main walls, no separate payment shall be made for this and rates quoted deemed to include this cost.

7. SAFETY PRECAUTIONS

The contractor shall at times observe the safety code and make necessary action as required in the tender. In default thereof, the employer may get this done departmentally or through other agencies and recover the cost from the contractor.

The Contractors shall also abide by all the security regulations promulgated from time to time by employer.

8. RATES

The rates to be quoted are intended to provide for works duly and properly completed in accorded with the general and special conditions of contract and specifications and drawings together with such alteration and or conditions as may be required / ordered without prejudice to the generality thereof shall include for detail of construction which are obviously and fairly intended and which may not have been specifically referred in these documents and working drawings and but are essential for execution and satisfactory completion of work including those of minor nature and shall be deemed to include and cover internal the followings.

The cost of all superintendence and labour materials, tools, plants, equipment's, mobilizing and demobilizing equipment fuel lubricants, fixture, transport charges, temporary and permanent works and quarrying charges, testing, screening, washing, handling of materials, stacking and removal charges, of any rejected materials and water and power arrangements and satisfactory maintenance of the same satisfactory completion of the work intended.

All fees, duties, royalties, rent and compensation to owner for surface damage or taxes and impositions payable to local authorities, in respect of land an structure, for all materials supplied for the work or any other duties/expenses for which the contractor may become liable or may be put to under any provision of the law for the purpose of in connection with the execution of the contract including revise payable on the transactions. Watching and lighting arrangements as required for satisfactory performances.

Settings out of works profiles etc., and of construction repair and up-keep of all centre lines, bench marks and levels and page there of including provisions of masonry/concrete pillars showing the centre line of structure/gridlines and levels and maintenance and protection of the some including providing fencing etc., throughout the period of contract.

- a) Breaking, maintenance and removal of temporary works and buildings.
- b) Supply of complete, Moulds, cost of testing of materials etc.
- c) Working in all conditions including in/under water liquid, conditions etc., and shall also include bailing or pumping out water from the foundations, basements or any other sources of whatsoever desludging and allied operation at any stage of work including all suspension period and delays whatsoever. Cost of curing including pumping and cost of water whatever necessary.
- d) In the interest of completion of work within the stipulated time, certain works are to be carried out during the monsoon period also. No separate payment will be made to the contractor for such works and it will be deemed to be included in the contract rates.
- e) Diversion and draining works, protection works, temporary facilities, bridges, gangway.
- f) Work at all depth in foundation below the ground level and in superstructure up to all height above ground level including all lifts and distances involved at any other place of work and disposed/barrow areas.
- g) Unless otherwise specified in the specification schedule cost of all leads/lifts etc.
- h) Provision of centering, scaffolding, strutting props etc.,
- i) All materials and labour required for fencing in a protection against risk of accidents and for providing necessary/planking strutting with hand rails, gumboots, helmets, safety belts etc., during the progress of work.
- j) Prevention on trespassing by providing barrier arrangements for the safety of the public or employees during the provision of works.
- o) Works in all shapes include and curved all sizes as shown are as required.
- p) Cleaning the site after the completion of work all debris, left out construction materials machine equipment's, temporary offices, stores, works shop etc., including dressing the area neat and clean shape.
- q) Such other incidental charges or contingencies as may have been provided for in the specifications.

09. LABOUR COLONIES:-

No labour camp will under any circumstance be permitted within the Factory premises.

10. PRICE VARIATION CLAUSE:

The price variation clause as given under shall be followed.

Clause 10C: Payment on Account of increase in Prices/Wages due to Statutory Order(s)

If after submission of the tender, the price of any material incorporated in the works (not being a material supplied from the Engineer-in-charge's stores in accordance with clause 10 thereof) and/or wages of labour increases as a direct result of the coming into force of any fresh law, or statutory rule or order (but not due to any changes in sales tax/VAT) and such increase in the price and/or wages prevailing at the time of the last stipulated date for receipt of the tenders including extensions if any for the work, and the contractor there upon necessarily and properly pays in respect of that material (incorporated in the works) such increased price and/or in respect of labour engaged on the execution of the work such increased wages, then the amount of the contract shall accordingly be varied, and provided further that any such increase shall not be payable if such increase has become operative after the stipulated date of completion of work in question.

If after submission of tender, the price of any material incorporated in the works (not being a material supplied from the Engineer-in-charge's stores in accordance with Clause 10 thereof) and /or wages labour is decreased as direct result of the coming in to force of any fresh law or statutory rules or order but not duo to any charges in sales tax /VAT) and such decrease in the prices and/or wages prevailing at the time of receipt of the tender for the work. Government shall in respect of materials incorporated in the works (not being materials supplied from the Engineer-in-charge's stores in accordance with Clause-10 hereof) and/or labour engaged on the execution of the work after the date of coming into force of such law statutory rule or order be entitled to deduct from the dues of the contractor, such amount as shall be equivalent to the difference between the prices of the materials and/or wages as prevailed at the time of the last stipulated date for receipt of tenders including executions if any for the work and the prices of materials and/or wages of labour on the coming into force of such law, statutory rule or order.

The contractor shall, for the purpose of this condition, keep such books of account and other documents as are necessary to show the amount of any increase claimed or reduction available and shall allow inspection of the same by a duly authorized representative of the Government, and further shall, at the request of the Engineer-in-charge may require any documents so kept and such other information as the Engineer-in-charge may require.

The contractor shall, within a reasonable time of his becoming aware of any alteration in the price of any such material and/or wages of labour, give notice thereof to the Engineer-in-charge stating that the same is given pursuant to this condition together with all information relating thereto which he may be in position to supply.

Clause 10CA: Payment due to variation in prices of materials after receipt of tender

If after submission of the tender, the price of materials specified in Schedule F increases/decreases beyond the price (s) prevailing at the time of the last stipulated date for receipt of tenders (including extensions, if any) for the work, then the amount of the contract shall accordingly be varied and provided further that any such variations shall be effected for stipulated period of contract including the justified period extended (under the provisions of Clause of the contract without any action under relevant Clause of contract)

However for work done/during the justified period extended as above, it will be limited to indices prevailing at the time of stipulated date of completion or as prevailing for the period under consideration, whichever is less.

The increase/decrease in prices shall be determined by the All India Wholesale Price Indices of Materials as published by Economic Advisor to Government of India, Ministry of Commerce and Industry and base price for materials as issued under the authority of Director General (Works), CPWD as valid on the last stipulated date of receipt of tender, including extension if any and for the period under consideration. In case, price index of a particular material is not issued by Ministry of Commerce and Industry, then the price index of nearest similar material as indicated in Schedule 'F' shall be followed. The amount of the contract shall accordingly be varied for all such materials and will be worked out as per the formula given below for individual material:-

Adjustment for component of individual material

$$V = P \times Q \times \frac{CI - CI_0}{CI_0}$$

Where,

V = Variation in material cost i.e. increase or decrease in the amount in Rupees to be paid or recovered.

P = Base price of material as issued under authority of DG (W), CPWD valid at the time of the last stipulated date of receipt of tender including extensions, if any.

Q = Quantity of material used in the works since previous bill.

CI₀ = All India Wholesale Price index for the material as published by the Economic Advisor to Government of India, Ministry of Industry and commerce as valid on the last stipulated date of receipt of tenders including extensions, if any.

CI = All India Wholesale Price Index for the material for period under consideration as published by Economic advisor to Government of India, Ministry of Industry and Commerce.

(In respect of the justified period extended under the provisions of the contract without any action, the index prevailing at the time of stipulated date of completion or the prevailing index of the period under consideration, whichever is less shall be considered.) provided always that provisions of the preceding Clause 10 C shall not be applicable in respect of Materials covered in this Clause.

11. QUANTITY

The probable quantities of the several items of work are furnished in the schedule of quantities. It must be clearly understood that neither the probable quantities nor the value of individual items nor the aggregate value of the entire work shall be binding on the Employer/Engineer does not in any way assure the contractor or Guarantee that the said probable quantities are correct or that the work will correspond to these. The Employer/Engineer reserve the right to omit, vary or add to the item/work described in the schedule, of quantities and no claim for compensation will be entertaining on this account.

12. VARIATION/DEVIATION IN QUANTITIES

The contractor shall not make any alteration in addition to or omission from the work as described in the tender document except in pursuance of the written instructions of the Engineer-in-charge. No such deviation from the work described in the tender documents shall be valid unless the same has been specifically confirmed and accepted by the accepting officer in writing and incorporated in the contract.

The rates quoted are firm for deviation subject to minimum of (-) 20% and maximum (+) 20% of the total value of work awarded. Deviation beyond the above limits is subject to the standard terms and conditions of BHEL.

13. MATERIALS

BHEL will not supply any materials unless otherwise specified.

14. SUPPLY OF CEMENT AND STEEL IS TO BE MADE BY CONTRACTOR

15. SUPPLY BY CONTRACTOR

The work is for a completed job including labour and supply of all materials except those otherwise specified in the bid document.

All materials supplied by the contractor according to the contract conditions shall be subject to inspection and passing by the Engineer or his representatives from time to time, the contractor providing all facilities for such instruction free of cost. BHEL officers connected with the contract shall have the power at any time to inspect and examine any stores or materials intended to be used in or on the work, whether on the site or at any factory or workshop or other place where such stores or materials are being fabricated or manufactured or at any place the same are lying and the contractor shall give necessary facilities for such inspection and examination.

The Engineer-in-charge shall be entitled to have tests made of any stores or materials supplied by the contractor shall provide at his own expense all facilities which the Engineer-in-charge may require for this purpose. If at the discretion of the Engineer-in-charge an independent expert is employed to make any such tests his charges shall be borne by the contractor only if the tests disclosed that the said stores or materials are not in accordance with the provision of the contract.

Should the Senior Engineer/Civil consider at any time during the construction or reconstruction on prior to the expiry of the Maintenance Period that the stores or materials provided by the contractor are unsound or of quality inferior to that contracted for, or otherwise not in accordance with the contract (in respect where the decision of the Senior Engineer/Civil shall be final and conclusive) the contractor shall on demand, in writing from the Sr.Engineer-civil specifying the stores an demand or materials complained of, not with-standing that the same may have been inadvertently passed, certified that and paid forth with remove the stores or materials so specified and provide other and suitable stores or materials at his own expense, to the entire satisfaction of the Sr.Engineer/Civil Engineer/Civil and in the event of his failing to do so within a period to be specified by the Senior Engineer/C,E/C, in his demand aforesaid, the Sr.Engineer/Civil Engineer/Civil may replace within the other stores or materials complained of at the risk and expense in all respect of the contractor. The liability of the contractor under this conditions, shall not extended beyond the maintenance period aforesaid except as regards stores or materials which the Sr.Engineer/Civil Engineer/Civil shall have previously given notice to the contractor to replace (Maintenance, period for any work under this organisation will be six months from the date of actual completion of the particular work and handing over to BHEL).

16. INTERRUPTION TO THE WORKS: -

In quoting the rates/prices the Contractor should take in to account the fact that due to the design or other stipulations at site, or the necessity to follow a particular sequence of overall construction operation, or non-supply of particular drawings, or the connected work or other reasons, interruptions are likely to be encountered in a work of this nature and magnitude. No claims for such interruptions will be entertained on any account.

17. EXTENSION OF TIME OR PENALTY/LIQUIDATED DAMAGES

Extension of time or penalty/liquidated damages as the case may be will be determined as stipulated in clause 7, 9 and 41 of BHEL General Conditions of Contract.

18. COMPLETION OF WORK AND MEASUREMENT

- a) All work shall be carried out according to authorized dimensions and measurement will be restricted to those authorized dimension even though the Contractor may for convenience of this work exceed the authorized dimensions.
- b) All work shall be measured in accordance with the applicable standard method of measurements prescribed by the Indian Standard Institution (1200 latest edition) unless otherwise specified.
- c) The Contractor shall admit for technical inspection, works which are likely to be embedded or covered by other works and have the necessary measurement books and certificates to this effect duly signed by the Engineer before the works are covered.
- d) On completion of the work, the Contractor must submit to the Engineer the following documents for passing of works.
 - i) A copy of the working drawing showing thereon all addition and alterations in the process of execution.
 - ii) A certificate for embedded and covered up works as in sub-para (C) above
- e) The authorized Contractors representative and a representative of the Employer shall jointly sign a certificate of handing over any completed work and date of signature of that certificate will be that the date from which the maintenance period of that unit will reckoned.
- f) Notwithstanding the above insurance cover has to be taken by the contractor for the full value of work as also for the duration of the contract period., 50% of the Security Deposit shall be released only on the total completion of the building and handed over to BHEL to their satisfaction. Remaining 50% of Security Deposit shall be released subject to the stipulation in our GCC after 6 months from the date of completion of the building.

19. MAINTENANCE OF WORK

The contractor will be responsible for the maintenance of works during the period of construction until the various items are taken over, and for a further period of six months, from the date of taking over.

If the contractor fails to maintain the building satisfactorily, it will be got done by other agency and cost towards such maintenance together with departmental charges will be recovered from his bills/dues.

20. SECURITY DEPOSIT

Upon acceptance of the tender, the successful tenderer shall remit the security deposit with Bharat Heavy Electricals Ltd within the time as specified in the Letter of Intent.

The rate of Security Deposit will be as below:

Up to Rs.10 Lakhs	10%
Above Rs. 10 Lakhs up to Rs.50lakhs	Rs .1 Lakhs + 7.5% of the amount exceeding Rs. 10 Lakhs
Above Rs.50 Lakhs	Rs. 4 Lakhs + 5% of the amount exceeding Rs. 50 Lakhs

The contractor should submit the Security Deposit before the start of the work.

- i) Cash (as permissible under the income Tax Act).
- ii) Pay order, demand draft in favour of BHEL.
- iii) Local cheques of scheduled banks, subject to realization.
- iv) Securities available from Post Offices such as National Saving Certificates, Kisan Vikas Patras etc.,
(Certificate should be held in the name of contractor furnishing the security and duly pledged in favour of BHEL and discharged on the back)
- v) Bank Guarantee from scheduled Banks/Public financial Institutions as defined in the companies Act subject to a maximum of 50% of the total security deposit value. The balance 50% has to be remitted either by cash or in the other form of security. The Bank Guarantee format should have the approval of BHEL.
- vi) Fixed Deposit Receipt issued by scheduled Banks/Public Financial Institutions as defined in the Companies Act. The FDR should be in the name of the contractor, A/C BHEL, duly discharged on the back.
- vii) Security Deposit can also be recovered at the rate of 10% from the running bills. However in such cases at least 50% of the Security Deposit should be collected before start of the work and balance 50% may be recovered from the running bills.
- viii) EMD of the successful tenderer shall be converted and adjusted against the Security Deposit.
- ix) The Security Deposit shall not carry any interest.

NOTE: Accepting of Security Deposit against Sl. No. (iv) and (vi) above will be subject to hypothecation or endorsement on the documents in favour on BHEL. However, BHEL will not be liable or responsible in any manner for the collection of interest or renewal of the documents or in any other matter connected therewith.

For extra items of work and deviated quantities, security deposit will be recovered at 10% of the value of deviated amount. The security deposit will be released as stipulated under clause 16(IV) of GCC.

21. RUNNING ACCOUNT PAYMENTS

During execution of work, monthly payments of all works in place will be made on the basic measurements recorded in measurement sheet/book in respect of items executed but no claim on the account will be entertained, if for any reason payments are not so made.

22.1 Mobilization Advance

Mobilization advance not exceeding 5% of work order value excluding taxes & duties or 5% of the estimated cost put to tender whichever is less will be given, if requested by the contractor in writing within one month of the order to commence the work. The advance will be released against executing a bank Guarantee Bond by the contractor from a Scheduled Nationalized Bank as specified by the Engineer-in-charge for the full amount of such advance is released. The contractor has to furnish a proof of the satisfactory utilization of the advance released by the company.

22.2 Interest & Recovery

The mobilization advance above bear simple interest at the prime lending rate of SBI plus 2% per annum and shall be calculated from the date of payment to the date of recovery, both days inclusive, on the outstanding amount of advance. Recovery of such sums advanced will be recovered by installments through deduction from the contractor's bills at 10% of the bill value till the full advance is recovered.

The said bank guarantee for advances shall initially shall be made for the full amount and valid for the contract period, and be kept renewed from time to time to cover the balance amount and likely period of complete recovery together with interest.

23. Statutory Deduction towards Income Tax will be made as per rules.

24. In respect of all labour directly or indirectly employed on the work by the Contractor, the Contractor shall comply with the provisions of the contract labour (Regulation and Abolition) Act 1970 or any amendment thereof and all legislations and rules of the State and or Central Government or other Authority, framed from time to time governing the protection of health, sanitary arrangements, wages, welfare and safety for labour employed on building and construction works. The rules and other statutory obligations with regard to fair wages, welfare and safety measures, maintenance of the register etc., will be deemed to be part of the contract.

25. The Contractor is required to take insurance for all workers employed on works towards payment for workmen compensation. The insurance has to be taken out within 15 days of the award of work and has to be produced at the time of signing agreement. Half (1/2%) shall be deducted for every bill if the contractor fails to produce a proof of having taken such an insurance to cover his workmen.

However the contractor shall be fully responsible for all the consequences arising out of such default. This may also be read with clause 20 of BHEL GCC.

26. **TIME OF COMPLETION**

The date of commencement of work shall be counted from the date of handing over the site to the contractor. The contractor shall plan the work in such a manner that all roofs are laid before the start of the rainy season and the work is not hampered due to rain. It may be clearly understood that time is the essence of the contract and the entire work should be completed within the time imposed in the tender document letter of intent.

27. The Contractor has to pay the Works Contract Tax (Under Sec.19A of the KST Act 1957) of their own on Monthly basis.
28. The management of BHEL shall be at liberty to terminate the contract by issuing a month's notice to the contractor without assigning any reason what so ever. As regards unsatisfactory performance or non compliance with any of the terms & conditions of the contract by the contractor. The management of BHEL shall have the right to terminate the contractor forthwith without notice & rearrange the balance work through other agencies at the risk & cost of the contractor & under such circumstances, the Earnest Money Deposit/Security Deposit paid by the contractor shall stand forfeited.

SPECIAL CONDITIONS OF TENDER

- i. The successful bidder should open local office for Technical staff/Administrative group at Bangalore City for easy interactions/ monitoring of work at site.
- ii. Tenderers should not disclose any price bid details/discounts in the technical bids.
- iii. The successful bidder should construct site office / toilets for their workmen at site in consultation with Engineer-in-charge.

LIST OF INDIAN STANDARD

Following is the list of various Indian Standards,
Relevant to the Civil Engg., work

1. EARTH WORK

- i) IS 1200-1992, Method Part I Earthwork, Measurement of Building, and Civil Engineering works, and chapter No.2 of CPWD/specification 1977.

2. MORTAR (PLASTERING)

- i) IS 2394-1984: Code of practice for application of lime plasters finish.
- ii) IS 1661-1972: Code of practice for application of cement lime plasters finish.
- iii) IS 2402-1963: Code of practice for external rendered finishes.

3. CONCRETE WORK & RCC WORK

- i) IS 456-2000: Code of practice for plain and reinforced concrete.
- ii) IS 432(part 1) –1982(Third Revision): Mild steel and medium tensile steel bars
- iii) IS 1766-1998: Cold twisted steel bars for concrete reinforcement.

4. BRICK WORK

- i) IS 2212-1991: Code of practice for brick work.

5. STONE WORK

- i) IS 1597-1992 (Part – I & II): Code of practice for construction of stone masonry.

6. MARBLE WORK

- i) IS 1124-1974: Methods of test for water absorption of natural building works.

7. STEEL WORK

- i) IS 800-2007(Third Revision): Code of practice for use of structural Steel in general building construction.
- ii) IS 1308-1984: Steels doors, windows and ventilators
- iii) IS 1081-1960: Code of practice for fixing glazing of metal (steel & aluminium doors, windows & ventilators)
- iv) IS 1161-1998: Steel tubes for structural purposes.
- v) IS 4351-2003: Steel doorframes.
- vi) IS-6245-5245-1971: Metal rolling shutters and rolling grills.

8. FLOORING

- i) IS 2114-1984: Code of practice for laying in situ terrazzo floor finish.
- ii) IS 2571-1970: Code of practice for in situ cement concrete flooring.
- iii) IS 5318-1969: Code of practice of laying of flexible P.V.C. sheet & tiles flooring.

9. ROOFING

- i) IS 3007(pt-I)-1999: Code of practice of laying of corrugated cement sheets.

10. FINISHING

- i) IS 133-2004: Enamel, Interior (a) under coating (b) Finishing colour as required.
- ii) IS 348-1968: French Polish.
- iii) IS 427-2005: Distemper, dry colour as required.
- iv) IS 425-1969: Distemper, oil emulsion as required.
- v) IS 5410-1992: Cement paint, Colour as required.
- vi) IS 5411 (pt.1)-1974: Plastic emulsion paint for interior use.
- vii) IS 6278-1971: Code of practice for white washing & colour washing.

11. DEMOLITION AND DISMANTLING.

- i) IS 1200 (pt 18)-1974: Method of measurements of demolition and dismantling.

12. SAFETY CODE

- i) IS 5916-1970: Safety code for construction including use of hot bituminous materials.
- ii) IS 4130-1991: Safety code for demolition of building.
- iii) IS 3754-1966: Safety code for excavation works.
- iv) IS 3696(Pt-1)-1987: Safety code for Scaffolds.

APPROVED BRAND OF PAINTS TO BE USED

1. DISTEMPER/ SYNTHETIC ENAMEL/ PLASTIC EMULSION/EXTERIOR EMULSION

BRAND: - ASIAN, BERGER, BRITISH PAINTS, JENSON & NICHOLSON,
NEROLAC

2. WATER PROOF CEMENT PAINT

SUPER SNOWCEM

A) DISTEMPERING ON NEW SURFACE. (OILBOUND)

1. COAT OF PRIMER 0.07 Litre/Sq.m (one coat)
2. COAT OF DISTEMPER 0.10 Kg/Sq.m (2 coats)

DISTEMPERING WITHOUT PRIMER

- FOR 1 COAT 0.10 Kg/Sq.m (For 1 coat)
FOR 2 COATS 0.15 Kg/Sq.m (For 2 coats)

B) SYNTHETIC ENAMEL PAINT.

- a) ON NEW SURFACE ... PRIMER 0.09 Litre/Sq.m (For1 coat)
ENAMEL PAINT (2 COATS) 0.15 Litre/Sq.m (For 2 coats)

b) ON OLD SURFACE

- 2 COATS WITHOUT PRIMER ... 0.20 Litre/Sq.m
1 COAT ... 0.10 Litre/Sq.m

c) WATER PROOF CEMENT PAINT

- 1 COAT ... 0.18 Kg/Sq.m
2 COAT ... 0.30 Kg/Sq.m

d) PLASTING EMULSION PAINT:

- 2 COATS OF PLASTIC EMULSION 0.09 Litre/Sq.m
1 COAT OF PLASTIC EMULSION 0.073 Litre/Sq.m

ON NEW SURFACE

- 1 COAT PLASTIC FIX PRIMER ... 0.081 Litre/Sq.m
2 COATS PLASTIC EMULSION ... 0.09 Litre/Sq.m

However the co-efficient should be not less than the manufacturer's recommendations.

LIST OF MATERIALS OF APPROVED BRAND OF MANUFACTURERS

1. Cast Iron Pipes : a) Indo-Swedish Pipe Mfg. Co. Ltd.
b) Bengal Iron Foundry
c) Hindustan Engineering Products
2. G.I Pipes : TATA, Zenith, Surya prakash,Jindal
3. G.I.FITTINGS : R Brand, TATA
4. C.P.FITTINGS : Ark, ESS ESS, plumber,
Jaquar, Parryware
5. Gun Metal Valves : Leader,
Neta
6. W.C pans, wash basins,) : Hindware, Parryware
Toilet paper holder,) Cera, Neycer.
Soap trays, Urinals and)
Auto Flushing tanks.)
7. W.C Seats : Commander,
Bestolite
8. Mirrors : Atul Glass Works, Warrior
9. Stoneware Pipes : Dalmia
Mysore Stoneware Pipe & Co.,
Andhra Pradesh Stoneware Pipe Company
10. Door Shutters : Kutty Flush Doors and Furnishers Co.,
Commercial ply teak Mysore Plywood
Veneered flush shutters Nikky
With ISI make. Assam
11. Door framed cold rolled : NSL section, T.I. Section
framed sheet sections
conformed sheet to
IS 4351-1976.

13. Commercial Ply/teak
Veneered ply block board. : Anchor, Mafatlal, Arch, National
14. Steel windows with
shutter frame. : Approved fabricators
15. Rolling shutters : Kohinoor,
Hercules
16. Bottle traps. : a) Orient
b) ARK
17. PVC pipes : a) Oriplast
b) Prince
c) Premier
d) Finolex
e) Supreme
18. Aluminium Sections : a) Indal
b) Zindal
19. Cement : a) Zuari
b) ACC
c) Cormandala
d) Ultratech
e) Birla
f) Rassi
20. Reinforcement steel : a) TISCO
b) SAIL
c) VISL

FORM OF TENDER

Having examined the invitation to bid, Instructions to Bidder, General conditions of contract, special conditions, specifications tender schedule, contract drawings and other documents for the above work, we the undersigned, offer to construct, erect complete and maintain the whole of the said in conformity with the said bid documents on the terms and conditions and under the provisions set out or called for in the contract documents at the rates listed in the schedule of unit prices or else wherein the contract documents.

We undertake if our bid is accepted, to commence the works within 7 days from the date of issue of award and to complete and delivery the whole of the works comprised in the contract as per the time schedule agreed to the contract document.

We agree to abide by this bid for the period of three months from the date fixed for receiving the same and it shall remain binding upon us and may be accepted at any time before expiry of the period.

Until and unless a formal agreement is prepared and executed this bid, together with your award thereof shall constitute a binding contract between us.

ENCLOSURE: C

CLAUSE 58 OF GENERAL CONDITIONS OF CONTRACT

ARBITRATION:

Except where otherwise provided for in the contract all questions and disputes relating to the meaning of the specifications, designs, drawings and instructions herein before mentioned as to the quality of workmanship or materials used on the work or as to any other question, claim, right, matter or thing whatsoever in any way arising out of or relating to the contract, designs, drawings, specifications, estimates, instructions, orders or these conditions or otherwise concerning the works, or the execution or failure to execute the same whether arising during the progress of the work or after the completion or abandonment thereof shall be referred to the sole arbitration of the Executive Director/General Manager of BHEL and if the Executive Director/General Manager is unable or unwilling to act to the sole Arbitration of some other person appointed by the Executive Director / General manager willing to act as such Arbitrator. There will be no objection if the arbitrator so appointed is an employee of BHEL or an employee of any other unit of BHEL and that he had to deal with the matters to which the contract relates and that in the course of its duties as such he had expressed views on all or any of the matters in dispute or difference. The Arbitrator to whom the matter is originally referred being transferred or vacating his office or being unable to act for any reason, such Executive Director / General Manager as aforesaid at the time of such transfer vacation of office or inability to act, shall appoint another person to act as arbitrator in accordance with the terms of the contract. Such person shall be entitled to proceed with the reference from the stage at which it was left by his predecessor. It is also a term of this contract that no person other than a person appointed by such Executive Director/General Manager or an employee appointed as arbitrator as aforesaid should act as arbitrator and the arbitrator shall give reasons for the award.

Subject as aforesaid the provision of the Arbitration Act, 1940 or any statutory modification or re-enactment thereof and the rules made there under and for the time being in force shall apply to the arbitration proceeding under this clause.

CONTRACTOR

EMPLOYER

It is a term of a contract that the party invoking arbitration shall specify the disputes to be referred to arbitration under this clause together with the amount or amounts claimed in respect of each such dispute.

The arbitrator(s) may from time to time with consent of the parties extend the time, for making the publishing the award.

The work under the contract shall, if reasonably possible, continue during the arbitration proceeding and no payment due or payable to the contractor shall be withheld on account of such proceedings.

The arbitrator shall be deemed to have entered on the reference on the date he issued notice to both the parties fixing the date of the hearing.

The arbitrator shall give a separate speaking award in respect of each dispute or difference referred to him.

The venue of arbitration shall be such place as may be fixed by the arbitrator in his sole discretion.

The award of the arbitrator shall be final, conclusive and binding on all parties to this contract.

ANNEXURE –I

GUIDELINES FOR REVERSE AUCTION PROCEDURE

Against this enquiry for the subject items/system with detailed scope of supply as per enquiry specifications, BHEL-EDN proposes to resort to “REVERSE AUCTION PROCEDURE” i.e., ONLINE BIDDING ON NETWORK, before finalizing the purchase order on technically competent bidders as per the guidelines given below:

1. Reverse auction procedure shall be applicable for 2 part bid tenders only.
2. For the proposed reverse auction, technically and commercially acceptable bidders only shall be eligible to participate, BHEL will engage the services of a service provider, having network all over the world. The online bidding can be done from the vendor’s respective offices on their computers with internet facility or at any of the cyber café, for which services provider’s representative will provide all necessary training and assistance before commencement of on line bidding. Training is free of cost.
3. Vendors have to fax the compliance form in the prescribed format (provided by Service provider) before start of reverse auction. Without this, Reverse Auction will not be started. Delay in fixing the above will lead to disqualification.
4. BHEL will send the Auto formulated EXCEL sheet which will help to arrive at “Total Cost to BHEL” like Basic Materials Cost, Packing & forwarding charges, Excise duty, Sales tax/VAT, Freight charges, Insurance (by BHEL), Service Tax for Service,(-) ED disclaimer if any, loading factors (for non-compliance to BHEL standard Commercial terms & conditions) for each of the vendor to enable them to fill-in the price and keep it ready for keying in during the auction.
5. Reverse Auction will be conducted on mutually agreed schedule and time.
6. After Reverse Auction is conducted, successful bidder has to FAX the filled- in Excel sheet showing the final value accepted in Reverse Auction with breakup of each element as indicated in SI No.4 above to the service provider within 48 hours of auction without fail.

Note: No Charges are allowed in rate of excise Duty, Sales Tax, Freight, Insurance, Service Tax and Loading factors after auction is completed.

7. After the reverse auction is conducted, the bidder whose price is lowest (total cost to BHEL, after considering all factors as per enquiry including loading factors for deviations to BHEL standard Commercial Terms & conditions), BHEL will process the tender as per BHEL purchase norms. Purchase order will be issued without loading factors for deviations.

Note: BHEL will also reserve the right to open the sealed price offer submitted by the vendors for comparison purpose, if deemed necessary, without any intimation to the technically and commercially accepted bidders.

8. In case BHEL decides not to go for Reverse Auction procedure for this tender enquiry, the Price Bids and Price impacts (if any) already. Submitted and available with BHEL shall only be opened as per BHEL's standard practice without seeking anymore price impacts on account of BHEL not going for Reverse Auction. Hence please quote your best lowest price in first instant itself.
9. Training by service provider will be given only for the subsequent reverse auction. Training will not be given for a company which has already taken training for the FIRST REVERSE AUCTION conducted by BHEL-EDN, Bangalore.
10. **Activities involved in Reverse Auction:**
 - a) BHEL will inform the vendor in writing, the Service provider's information to enable them to contact & get trained. Along with above information Business rules/policy also will be sent.
 - b) Vendors have to contact Service provider and send Compliance form for having understood Reverse Auction procedure and ready for auction.
 - c) BHEL will sent the Auto formulated Excel sheet (blank format without prices) as mentioned in SI No.4 above to the respective vendors.
 - d) Vendors have to fill-in the Excel sheet (provided by BHEL) including loading factors and get ready for reverse auction.
 - e) Date & Time of reverse Auction and Website address will be intimated by Service provider.
 - f) Bid decrement will be indicated in the website after the Sealed bid is over and before start of Reverse auction.
 - g) Vendors will be have to key-in the "Total cost to BHEL" (as worked out in the Excel sheet mentioned in SI No.4 above) in the "Sealed Bid" of the Reverse Auction within specified time duration of 20 to 30 minutes. After "Sealed Bid" auction, the lowest bidders value or BHEL's start bid price will be the starting bid value for the commencement of Reverse auction(English Reverse).
 - h) At the end of Reverse auction time (English Reverse), the lowest bidder will be known on the network.
 - i) Successful bidder has to fax filled-in EXCEL sheet showing the final value accepted in the Reverse auction with breakup of each component within 48 hours of completion of the Reverse Auction without altering any of the terms to the service provider. Any alterations will be taken as sabotaging the tender process and will invite disqualification of vendor to conduct business with BHEL for the period of 2 Years.
 - j) The loading factors for non-conformance to BHEL standard commercial terms are only for arriving at lowest bidder. In the event of purchase order, same will be issued without Loading factor values indicated in EXCEL sheet. We repeat PO, will be issued for scope of Supply + Packing & Forwarding charges if any, Excise duty, Sales tax, Service tax for service and Freight Insurance. Insurance will be to BHEL account.

11. This tender BHEL-EDN Proposes to resort to (Reverse Auction Procedure) that is online bidding on network to finalize the tender on technically and commercially Competent Vendor.

ANNEXURE -II
ELECTRONIC FUNDS TRANSFER (EFT) OR
PAYLINK DIRECT CREDIT FORM

Please Fill Up the form in CAPITAL LETTERS only:

TYPE OF REQUEST (Tick one): CREATE _____ CHANGE: _____

BHEL Vendor/Supplier Code:

Company Name:

Permanent account Number(PAN):

Address:

City: _____

PINCODE

STATE

Contact Person(s)

Telephone No:

Fax No:

E-Mail-Id:

1.Bank Name:

2.Bank Address:

3.Bank Telephone No:

4Bank Account no:

5.Account Type: Saving/Cash Credit

6.9Digit Code Number of Bank and branch

Appearing on MICR cheque issued by Bank

7.Bank Swift Code (applicable for EFT only)

8.Bank IFSC Code(applicable for RTGS)

9.Bank IFSC Code (applicable for NEFT)

I here certify that the particulars given above are true, correct and complete and that I, as a representative for the above named Company, hereby authorize BHEL,EDN, Bangalore to electronically deposit payments to the designated bank account. If the transaction is delayed or not effected at all for reasons of incomplete or incorrect information, I would not hold BHEL/Transferring Bank responsible. This authority remains in full force until BHEL - EDN Bangalore receives written notification requesting a change or cancellation.

I have read the contents of the covering letter and agree to discharge the responsibility expected of me as a participant under ECS/EFT.

Date:

Authorized Signatory:

Designation:

Telephone No. with STD

Code

Company seal

BANK CERTIFICATE

We certify that _____ has an Account No _____ with us and we confirm that the bank details given above are correct as per our records.

Date:

Place:

(.....)

Signature

Please return completed from along with a blank cancelled cheque or photocopy thereof to:

Bharat Heavy Electricals Ltd.,

Attn:

Electronics Division, Mysore Road,

BANGALORE -560026

**BHARAT HEAVY ELECTRICALS LTD
ELECTRONICS DIVISION
MYSORE ROAD. BANGALORE- 560026**

PART II - PRICE BID

To be submitted in separate sealed cover

**NAME OF WORK: Providing Modular shelter to facilitate space for
canteen services at BHEL-ESD premises, Bangalore**

**Special Instructions
(Schedule –F)**

- Contractor has to procure Structural & Reinforcement steel from SAIL, TISCO, and VISL.
- Contractor has to procure ISI brand 43/53 grade cement of ACC, Ultratech, Zuari, Birla, Rassi and Cormandala.
- Basic prices fixed by CPWD for steel, cement & other materials considered are as specified below:
 - a) Cement - Rs 7200.00/MT
 - b) Steel
 - i) Reinforcement (TMT) - Rs 50800.00/MT
 - ii) Structural - Rs 49600.00/MT
 - c) Aluminum sections - Rs 312.00/Kg
 - d) 12 mm prelaminated particle board
 - i) One side decorated - Rs 952.00/Sq.m
 - ii) Both side decorated - Rs 1000.00/Sq.m
- However the rates fixed by CPWD as on date of Tender Submission will be considered to derive the basic price of the materials to operate PVC clause.

CONTRACTOR

--i--

EMPLOYER

The PVC clause will be as per clause 10CA of CPWD manual-2007 formula as specified.

FORMULA AS PER CLAUSE 10CA:

$$V = P \times Q \times \frac{CI - CI_0}{CI_0}$$

Where,

V = Variation in material cost i.e. increase or decrease in the amount in Rupees to be paid or recovered.

P = Base price of material as issued under authority of DG (W), CPWD valid at the time of the last stipulated date of receipt of tender including extensions, if any.

Q = Quantity of material used in the works since previous bill.

CI₀ = All India Wholesale Price index for the material as published by the Economic Advisor to Government of India, Ministry of Industry and Commerce as valid on the last stipulated date of receipt of tenders including extensions, if any.

CI = All India Wholesale Price Index for the material for period under consideration as published by Economic advisor to Government of India, Ministry of Industry and Commerce. (In respect of the justified period extended under the provisions of clause 5 of the contract without any action under clause 2, the index prevailing at the time of stipulated date of completion or the prevailing index of the period under consideration, whichever is less shall be considered.)

Name of the work: Providing Modular Shelter to facilitate space for Canteen services at BHEL-ESD Premises,Bangalore.

ABSTRACT

Dismantling Portion	
Building portion	
Toilet portion	
Total Amount	

Total Amount in words

.....

BHEL-ESD-BANGALORE DETAILED ESTIMATE

SCHEDULE

Name of Work : Providing Modular Shelter to facilitate space for Canteen services at BHEL-ESD Premises, Bangalore.

Sl. No.	Descrip on of Work	Qty	Unit	Rates in gures & words		Amount	
				Rs	Ps	Rs	Ps
<u>A. DISMANTLING PORTION</u>							
1	Demolishing lime concrete and disposal of material within 50 mtrs lead at all heights & levels	420	CUM				
2	Dismantling tile work in floors and roofs laid in cement mortar including stacking materials within 50 mtrs lead for thickness of tiles 10 mm to 25 mm. Contractor has to dismantle WPC tiles from roof mosaictiles any types of tiles as per the direction of Engineer-in-charge at all heights & levels	1100	SQM				
3	Demolishing cement concrete including disposal of material within 50 mtrs lead in (1 : 3 : 6) or richer mix	10	CUM				
4	Demolishing RCC work including stacking of steel bars and disposal of unserviceable material with in 50 mtrs lead at all heights & levels	5	CUM				
5	Demolishing brick work including stacking of serviceable materials and disposal of unserviceable materials within 50 mtrs lead in cement mortar at all heights & levels	65	CUM				
6	Dismantling Doors, Windows, clerestory steel / wood windows, MS Doors, Rolling shutters (steel) at all heights & levels including chowkhats, architrare hold fasts etc complete stacking within 50 mtrs lead						
a	Area 3.00 SQM & below.,	4	EACH				
b	Area beyond 3 SQM	2	EACH				
7	Dismantling steel work in built up sections in angles, tees flats & channels including all gusset plates, bolts, nuts, MS frames / ladders / supports / beams etc., cutting rivets, welding etc., including all labours at all heights and levels.	200	KG				

Sl. No.	Description of Work	Qty	Unit	Rates in figures & words		Amount	
				Rs	Ps	Rs	Ps
8	Dismantling roofing including ridges, hips, valleys and gutters etc., and stacking the materials within 50 mtrs lead of asbestos sheet	20	SQM				
9	Dismantling wooden / aluminium partition boarding in lining of walls and partitions, including supporting members and stacking within 50 mtrs lead at all heights / floors	5	SQM				
10	Dismantling C I or asbestos rain water pipes & fittings and clamps including stacking of the materials within 50 mtrs lead for 100 mm dia pipe and any diameter	25	RM				
11	Dismantling GI pipes (external work) including excavation and refilling trenches after taking out the pipes including stacking of pipes within 50 mtrs lead,						
a	15 to 40 mm nominal bore	20	RM				
b	Above 40 mm nominal bore	30	RM				
12	Collecting conveying of debris / building rubbish, earth and excavated rocks etc., complete from factory premises to outside upto 20 kms lead including loading, unloading, all labours, hire charges of machinery etc., complete	300	CUM				
13	Earth work in excavation in foundations trenches, drains or foundation of columns, walls, lift-pits etc., not exceeding 5 m in width or 25 sqm on plan including dressing of sides and ramming of bottoms lift upto 1.5m to 3.0m including getting out the excavated soil and disposing of surplus excavated soil as directed within a lead of 50m in all types of hard and gravelly soil.	15	CUM				
TOTAL VALUE OF DISMANTLING PORTION							

Sl. No.	Description of Work	Qty	Unit	Rates in Rupees & Paise		Amount	
				Rs	Paise	Rs	Paise
B. BUILDING PORTION							
1	Providing and laying in position machine batched machine mixed and machine vibrated design mix cement concrete of specified grade for reinforced cement concrete structural elements, excluding the cost of centering, shuttering finishing and reinforcement including admixtures in recommended proportions (as per IS 9103) to accelerate / retard setting of concrete, improve workability without impairing strength and durability as per direction of Engineer-in-charge for the following grades of reinforced cement concrete at all heights & floors.						
In M25 Grade Ready mix concrete							
a	M 25 grade RCC Columns	15	CUM				
b	M 25 grade RCC Beams	10	CUM				
c	M 25 grade RCC Machine Foundations	2	CUM				
d	M 25 grade RCC slabs	60	CUM				
e	M 25 grade RCC Chajjas and Facia / Fins	5	CUM				
f	M 25 grade RCC Lift Wall	70	CUM				
2	Centering and shuttering including strutting, propping etc., and removal of Form for at all heights and levels for						
a	Columns, pillars, piers, abutments, posts and struts	140	SQM				
b	Lintels, Beams, plinth beams, girders, bressumers and cantilevers	250	Sq. Mtr				
c	Roofs, Suspended floors, landings, balconies & access platform	380	Sq. Mtr				
d	Lift walls at all heights & levels	450	Sq. Mtr				
3	Providing and laying in position reinforcement for RCC work including straightening, cutting, bending, placing in position and binding for bars with 16 gauge G I wires welding of reinforcement where required, providing cover to reinforcement all complete in THERMO MECHANICALLY TREATED BARS	24300	Kg				

Sl. No.	Description of Work	Qty	Unit	Rates in figures & words		Amount	
				Rs	Ps	Rs	Ps
4	Providing and constructing 230 mm thick brickwork with bricks of class designation 75 at all levels in CM (1:6) including providing necessary staging, scaffolding curing removing the staging and scaffolding, complete work.	60	CUM				
5	Providing 115 thick brick work in CM (1:4) with bricks of class designation 75 at all levels including providing a layer of reinforced concrete every 6th course with 2 Nos., of 6 mm dia MS bars, providing scaffolding curing, removing scaffolding etc., complete	15	Sq. Mtr				
6	Providing surfaces and ceiling, portico etc., with plaster of cement mortar (1:3) 12 mm thick average to get a plain and even surface finished smooth with thin coat of lime rendering at all levels including providing scaffolding, curing, etc., complete (Ceiling)	400	Sq. Mtr				
7	Providing surfaces of walls inside such other members with plaster of cement mortar (1:6) 15 mm thickness to get a plain and even surface, lime rendering finished smooth with all labour, materials & providing and removing scaffolding complete at all heights and levels	400	Sq. Mtr				

Sl. No.	Description of Work	Qty	Unit	Rates in Rupees & words		Amount	
				Rs	Ps	Rs	Ps
8	Providing surfaces of walls outside periphery of chajja etc., with plaster of CM (1:6) 15 mm average thickness to get a plain and even surface finished rough at all levels including providing and removing scaffolding	120	Sq. Mtr				
9	Providing rough cast plaster upto 10 m height above ground level with a mixture of sand and gravel or crushed stone from 6 mm to 10 mm nominal size dashed over and including the fresh plaster in two layers, under layer 12 mm cement plaster 1 : 4 (1 cement : 4 coarse sand) and top layer 10 mm cement plaster (1 : 3) (1 cement : 3 fine sand) mixed with water proof compound	120	Sq. Mtr				
10	<p>Providing and fixing anodised aluminium work for doors, windows, ventilators and partitions with extruded built up standard tubular and other sections of approved made conforming to IS : 733 and IS : 1285 anodised transparent or dyed to required shade according to IS : 1868 (minimum anodic coating of grade AC 15), fixed with rawl plugs and screws or with fixing clips, or with expansion hold fasteners including necessary filling up of gaps at junctions at top, bottom and sides with required PVC / neoprene felt etc., Aluminium sections shall be smooth, rust free straight mitred and jointed mechanically wherever required including cleat angle, aluminium snap beading for glazing.</p> <p>panelling, CP brass / stainless steel screws, all complete as per architectural drawings and the directions of Engineer-in-charge (Glazing and panelling to be paid for separately) for shutters of doors, windows and ventilators including providing and fixing hinges / pivots and making provision for fixing of fittings wherever required including the cost of PVC / Neoprene gasket required (fittings shall be paid for separately.</p>						
(a)	For Fixed portion	30	Kg				
(b)	Aluminium Door openable with pivots / sliding including cost of all accessories	105	Kg				
(c)	Aluminium Window fixed portion	150	Kg				
(d)	Aluminium sliding window two track with shutter and locking arrangement	55	Kg				
11	Providing and fixing glass in aluminium door, window, ventilator shutters and partitions etc., with PVC / neoprene gasket etc., complete as per the architectural drawings and the directions of Engineer-in-charge						
a	With plain/tinted glass panes of 4.00 mm thickness	16	Sq. Mtr				
b	With tinted/frost glass panes of 5.00 mm thick for partition and Aluminium Doors	9	Sq. Mtr				

Sl. No.	Description of Work	Qty	Unit	Rates in figures & words		Amount	
				Rs	Ps	Rs	Ps
12	Providing and painting ceilings, porticos, inside walls etc with a priming coat of cement primer and two or more coats of oil bound distemper of approved brand quality and make to give an even shade including applying putty of approved brand quality, scrubbing the surface for getting perfectly uniform and true finish as required providing scaffolding, curing wherever necessary removing scaffolding and providing touch-ups as required for ceiling.	200	Sq. Mtr				
13	Providing and painting ceilings, porticos inside walls, etc., with a priming coat of primer and two or more coats of Acrylic plastic emulsion of approved brand and make to give an even shade including applying putty of approved brand quality scrubbing the surface for getting perfecting uniform and true finish as required providing scaffolding and providing touch-ups as required complete works for walls.	450	Sq. Mtr				
14	Providing and painting ceilings porticos inside walls etc with a priming coat of suitable approved primer and two or more coats of synthetic enamel of approved quality and make to give an even shade including applying putty of approved brand quality, scrubbing the surface for getting perfectly uniform and true finish as required providing scaffolding and removing scaffolding etc., complete at all heights and levels	100	Sq. Mtr				
15	Providing and Applying one or more coat of cement primer / exterior primer of approved brand and manufacture on wall surfaces	300	Sq. Mtr				
16	Providing and Finishing walls with Acrylic smooth exterior paint "Trump" of M/s. Snowcem India Ltd., or equivalent of required shade on new work (two or more coats applied @ 1.67 Ltrs / 10 Sqm) (at all levels) as per the directions of Engineer-in-charge	300	Sq. Mtr				
17	Providing and fixing double action hydraulic floor spring of approved quality and make (conforming to IS 6315) for aluminium doors including cost of cutting floors as required, embedding in floors and cover plates etc., complete as per the directions of Engineer-in-charge	10	Each				
18	providing and fixing IS 3564 marked aluminium die cast body tubular type universal hydraulic door closer with necessary accessories and screws etc., complete.	4	Each				

Sl. No.	Description of Work	Qty	Unit	Rates in figures & words		Amount	
				Rs	Ps	Rs	Ps
19	Providing and fixing on wall face unplasticised rigid PVC rain water pipe 110 mm dia conforming to IS 13592 type A including jointing with seal ring conforming to IS 5382 leaving 10 mm gap for the thermal expansion including all fittings like bends, tees, clamps, screws, cleats etc., complete at all heights and levels as directed by the Engineer-in-charge						
a)	110 mm dia	14	RM				
b)	150 mm dia	10	RM				
20	Providing and laying 18 mm thick mirror polished granite machine cut for wall dadoos, lift front face wall, floors, stair case steps etc. and similar locations of required size of approved shade colour and texture laid over 20 mm thick base cement mortar (1:4) (1 Cement : 4 Coarse Sand) plaster and fixing the granite slab with cement slurry and joints treated with cement, mixed with matching pigment, epoxy touchups, including rubbing, curing etc., complete at all heights and levels for granite pink / grey colour as directed by Engineer - in - charge	600	Sq. Mtr				
a)	Extra for providing edge moulding / nosing to 18 mm thick granite as per design approved by engineer in charge.	50	RM				

Sl. No.	Description of Work	Qty	Unit	Rates in Rupees & words		Amount	
				Rs	Ps	Rs	Ps
21	<p>Providing and laying integral cement based water proofing treatment including preparation of surface as required for treatment of roofs, balconies, terraces etc., consisting of following operations.</p> <p>(a) Applying and grouting a slurry coat of neat cement using 2.75 kg/sqm. of cement admixed with proprietary water proofing compound conforming to IS:2645 over the RCC slab including cleaning the surface before treatment.</p> <p>(b) Laying cement concrete using broken bricks/brick bats 25mm to 100mm size with 50% of cement mortar 1:5 (1 cement:5 coarse sand) admixed with proprietary water proofing compound conforming to IS:2645 over 20mm thick layer of cement mortar of mix 1:5 (1 cement : 5 coarse sand) admixed with proprietary water proofing compound conforming to IS:2645 to required slope and treating similarly the adjoining walls up to 300mm height including rounding of junctions of walls and slabs.</p> <p>(c) After two days of proper curing applying a second coat of cement slurry admixed with proprietary water proofing compound conforming to IS:2645.</p> <p>(d) Finishing the surface with 20mm thick joint-less cement mortar of mix 1:4 (1 cement : 4 coarse sand) admixed with proprietary water proofing compound conforming to IS : 2645 and finally finishing the trowel with neat cement slurry and making of 300x300 mm square.</p> <p>(e) The whole terrace so finished shall be flooded with water for a minimum period of two weeks for curing and for final test all above operations to be done in order and as directed and specified by the Engineer-in-charge.</p> <p>With average thickness of 120 mm and minimum thickness of khurra as 65mm.</p>	420	Sq. Mtr				
22	<p>Providing and laying pressed split clay tiles (as per approved pattern) 20 mm nominal thickness on roofs jointed with cement mortar mixed with 2 % integral water proofing compound laid over a bed of 20 mm thick cement mortar (1 : 4) (1 cement : 4 Coarse Sand) and finished neat complete at all heights and levels as directed by the Engineer-in-charge.</p>	280	Sq. Mtr				
23	<p>Providing and laying 52 mm thick concrete smooth finished flooring with " Hard Crete " concrete hardener topping under layer 40 mm thick cement concrete (1:2:4) (1 Cement : 2 Coarse Sand : 4 Graded stone aggregate 6 mm nominal size) and top layer 12 mm thick hardcrete cement hardener consisting of mix (1:2) (1 cement hardner mix : 2 stone aggregate 6 mm nominal size) by volume with which hardcrete hardening compound of Snowcem India Ltd., or equivalent is mixed @ 2 litre hard crete per 50 kg of cement including cement slurry but excluding the cost of nosing of step etc., complete</p>	100	Sq. Mtr				

Sl. No.	Description of Work	Qty	Unit	Rates in Rupees & words		Amount	
				Rs	Ps	Rs	Ps
24	Providing and fixing aluminium sliding door bolts ISI marked anodised (anodic coating not less than grade AC 10 as per IS : 1868) transparent or dyed to required colour or shade with nuts and screws.						
	a) 250 X 16 mm size at all heights & levels	4	Each				
25	Providing and fixing aluminium ISI marked anodised(anodic coating not less than grade AC 10 as per IS:1868) with nuts and screws						
	a) ISI marked tower bolts of size 250 X 10 mm size tower bolt	4	Each				
	b) aluminium handles of 125 mm size with nuts & screws	10	Each				
	c) aluminium hanging floor door stopper of single rubber stopper with screws for fixing stopper.	10	Each				
26	Providing and fixing bright finished brass 100 mm mortice latch and lock ISI marked with six levers and a pair of anodized (anodic coating not less than grade AC 10 as per IS : 1868) aluminium lever handles with necessary screws etc complete (best make of approved quality)	6	Each				
27	Providing & fixing 40 X 5 mm flat iron hold fast 40 cm long including fixing to frame with 10 mm diameter bolts, nuts and wooden plugs & embedding in cement concrete block 30 x 10 x 15 cm (1 : 3 : 6) mix (1 Cement : 3 Coarse sand : 6 graded stone aggregate 20 mm nominal size) at all levels	10	Each				
28	Providing and fixing 12 mm thick prelaminated three layer medium density (exterior grade) particle board Grade - I, Type II conforming to IS : 12823 bonded with phenol formaldehyde synthetic resin, of approved brand and manufacture in panelling fixed in aluminium doors, windows shutters and partition frames with CP brass / stainless steel screws etc., complete as per architectural drawings and directions of Engineer-in-charge for prelaminated particle board with decorative lamination on both sides for Door / Windows / Partitions	10	Sq. Mtr				
29	Providing and fixing 30 mm thick factory made PVC rigid foam panelled door shutters manufactured by M/s. Rajshri or equivalent made from MS tube of 19 gauge thickness, size 19 x 19 mm for styles and 15 x 15 mm for top and bottom rails, covered with heat moulded PVC " C " channel of 5 mm thick sheet and 30 X 50 mm wide to form styles and 5 mm thick & 75 mm wide PVC sheets for top rail, lock rail and bottom rail on either side and 5 mm thick 20 mm wide cross PVC sheet as gap insert for top rail and bottom rail and panelling of 5 mm thick PVC sheet fitted in the MS frame welded / sealed to the styles and rails with 5 x 30 mm PVC sheet beading on either side and jointed together with solvent cement adhesive etc. , complete as per manufacturers specification and directions of Engineer-in-charge fixed to frames with 4 Nos., MS powder coated butt hinges (for WC and Bath room shutters) at all levels.	7	Sq. Mtr				

Sl. No.	Description of Work	Qty	Unit	Rates in Rupees & words		Amount	
				Rs	Ps	Rs	Ps
30	Providing & fixing factory made PVC door frame manufactured by M/s. Rajshri or equivalent of size 50 x 47 mm with a wall thickness of 5 mm, made out of extruded 5 mm rigid PVC foam sheet mitred at corners and joined with 2 nos of 150 mm long brackets of 15 x 15 mm MS square tube, the vertical door profiles to be reinforced with 19 x 19 mm Ms Square tube of 19 gauge, EPDM rubber gasket weather seal to be provided through out the frame. The door frame to be fixed to the wall using MS screws of 65 / 100 mm size complete as per manufacturers specification & directions of Engineer-in-charge at all levels and floors	15	RM				
31	Providing and fixing aluminium sliding bolts for door ISI marked anodized (anodic coating not less than grade AC 10 as per IS : 1868) transparent or dyed to required colour or shade with nuts and screws etc., complete for 300 x 16 mm	4	Each				
32	Providing and fixing vertical venetian blinds of approved colour and brand cost is inclusive of supply of materials, fixing, labour charges, transportation all leads, lifts, taxes etc., complete at all heights and levels	25	Sq. Mtr				
33	Providing and laying vitrified floor tiles of size 600 x 600 mm of thickness not less than 10 mm of M/s. Johnson (Marbonite) or equivalent in light colours and shades laid on 20 mm thick CM (1:3) (1 cement : 3 coarse sand) and curing and filling the joints with filler to match with colour of tiles complete as per the directions of the Engineer-in-charge at all levels and floors	1000	Sq. Mtr				
34	Providing S.S. Hand Rail (Stainless Steel) and Baluster system of kitchen A/S Grade (grade 304) as per Manufacture details and of design approved by Engineer - in - charge at all heights and levels.						
(a)	Top Mounted 38 mm Dia S.S. Hand rail with double Balusters of 16 mm Dia each and three 16mm dia horizontal rails.	25	RM				
(b)	Wall Mounted 38 mm Dia S.S. Hand rail with double Balusters of 16 mm Dia each and three 16mm dia horizontal rails..	20	RM				
35	Providing cement concrete flooring (1:2:4) (1 Cement : 2 Coarse Sand : 4 Graded Stone aggregate) finished with a floating coat of neat cement including cement slurry, but excluding the cost of nosing of steps etc., complete for 50 mm thick with 20 mm nominal size stone aggregate	1250	Sq. Mtr				

Sl. No.	Description of Work	Qty	Unit	Rates in figures & words		Amount	
				Rs	Ps	Rs	Ps
36	Structural steel TUBULAR SECTION work welded in built up section , trusses and framed work,gate etc, including cutting ,hoisting fixing in position and applying priming coat of steel primer paint and synthetic paint at all height and levels.as per drawings and direction of Engineer-in-charge	17400	kg				
37	Structural steel work in single section fixed with connecting plate including cutting, hoisting, fixing in position and applying a priming coat and synthetic paint of approved steel primer all complete	27000	kg				
38	Providing and fixing colour coated galvanised sheet 0.5 mm (0.45-0.50 mm thick) 1100 mm width. Galvanising coating mass 120 GSM coating standard IS :277/JIS 3302. Yield strength 240 Mpa colour .(Sheets for roof and sandwich panels for wall panelling) AT ALL HEIGHT AND LEVELS.as per drawings and direction of Engineer-in-charge of required profile	3700	Sq. Mtr				
39 Do.... Gutter 610 mm girth	29.28	Sq. Mtr				
40	Providing and fixing fiber glass clear/colour sheet 2mm thick of required profile for roofing and fixing with G.I J or L bolt and nuts 8mm Dia including G.I plain and bitumen washers complete excluding the cost of purlin, rafter and trusses up to 60 pitch at all heights and levels as directed by engineer- in - change etc, complete.	370	Sq. Mtr				
41	Labour charges for structural steel welded work in built up section ,trusses,hoisting fixing in position and applying a priming coat of approved steel primer all complete.	2000	Sq. Mtr				
TOTAL VALUE OF BUILDING PORTION							

Sl. No.	Description of Work	Qty	Unit	Rates in figures & words		Amount	
				Rs	Ps	Rs	Ps
	<u>B. WASH AREA/TOILET AREA</u>						
1	Providing and fixing GI pipes complete with GI fittings and clamps, including cutting, painting with anti corrosive bitumastic paint where ever required, and making good the walls (internal works)						
a)	20 mm dia nominal bore	15	RM				
b)	25 mm dia nominal bore	15	RM				
c)	40 mm dia nominal bore	15	RM				
d)	50 mm dia nominal bore	10	RM				
2	Providing and fixing GI pipes complete with GI fittings including trenching refilling, sealing the joints, etc., 25 mm nominal bore	40	RM				
3	Making connection of GI distribution branch with GI main of the existing size by providing and fixing tee and other necessary fittings including cutting and threading the pipe, sealing the joints, etc., complete for 25 to 40 mm nominal bore	4	Each				
4	Providing and fixing brass stop cock of approved design, quality and make 15 mm NB	10	Each				
5	Providing and fixing brass gate valve with C I wheel of approved quality (screwed end) for 25 mm dia nominal bore with reducer if necessary at all heights & levels	4	Each				
6	Providing & fixing 100 mm sand cast iron grating for gully, floor or nahani trap at all heights and levels	5	Each				

Sl. No.	Description of Work	Qty	Unit	Rates in figures & words		Amount	
				Rs	Ps	Rs	Ps
7	Providing and fixing CP towel rod of Jaguar or equivalent 2 feet long including all labours lead lift etc., at all heights & floors.	10	Each				
8	Providing and fixing (laying) 7.5 mm thick Anti-skid vitrified ceramic tiles conforming to IS 4457 - 1982 for flooring over a bed of 25 mm thick cement Mortar (1:4) (1 cement : 4 coarse sand) with 2.5 mm wide joints / using spacers treated with white cement mixed with pigment to match the shades etc., complete as directed by the Engineer-in-charge of any approved colour tiles at all heights and levels	110	Sq. Mtr				
9	Providing and fixing PVC, soil waste and vent pipes conforming to IS 4985 of SWR quality 4 Kg & 6 Kg / Sq cm, pressure. The rate shall include cost of all fittings like plain elbow, plain tee, plain Y, 4 way tee and all required necessary specials etc., complete. jointing with rubber ring and solvent joints providing MS brackets grouted in the wall and fasteners cutting and making good the walls and floors (pipes running expose in sanitary ducts) supreme or prince quality pipes.						
a)	75 mm dia	10	RM				
b)	110 mm dia	25	RM				
10	Providing MS foot rests including fixing in man holes with 20 x 20 x 10 cm Cement concrete blocks (1 : 3 : 6) (1 Cement : 3 Coarse Sand : 6 graded stone aggregate 20 mm nominal size) as per standard design with 20 x 20 mm square bar	5	Each				
11	Providing and fixing vitreous china wash basin coloured basin conforming to IS including pedastal of hindware / parryware make CI / MS brackets, fittings & connectios single pillar tap CP of Jaguar / equivalent testing for non leaky performance, cutting and making good the walls where required painting the brackets etc., complete for flat back coloured wash basin of size 630 x 450 mm at all heights & floors.	10	Each				

Sl. No.	Description of Work	Qty	Unit	Rates in Rupees & words		Amount	
				Rs	Ps	Rs	Ps
12	Providing and fixing mirror of rectangular shape 453 x 357 mm with plastic moulded frame of approved make and shade with 6 mm thick hard board backing at all heights & floors.						
a)	453 x 357 mm size	4	Each				
13	Providing and fixing white water closet Squatting type pan (Indian Type) Orissa pattern of size 580 x 440 mm with 100 mm sand cast iron ' P or S ' trap 10 litre low level white PVC flushing cistern with manually controlled device (handle lever) conforming to IS : 7231 parry ware / hindware / seabird / orient (coral) with all fittings and fixtures complete including cutting and making good the walls and floors where ever required etc., complete.	2	Each				
14	Providing and fixing coloured vitreous china pedasal type water closet (european type) with seat & lid, 10 litre low level flushing cistern with fittings and CI / MS brackets, 40 mm flush bend, over flow arrangement with specials of standard make and mosquito proof coupling of approved municipal design complete including painting of fittings and brackets, cutting and making good the walls and floors where ever required WC pan with ISI marked coloured solid plastic and lid with coloured vitreous china flushing cistern and CP flush bend (low level cistern)	3	Each				
15	Excavating trenches of required width for pipes, cables etc., including excavation of sockets, dressing of sides and ramming of bottoms depth upto 1.50 mtr including getting out the excavated soil and then returning the soil as required in layers not exceeding 20 cm in depth including consolidating each deposited layer by ramming, watering etc and disposal of surplus excavated soil as directed with in a lead of 50 mtrs in all kinds of soil for pipes, cables etc exceeding 80 mm dia but not exceeding 300 mm dia	5	RM				

Sl. No.	Description of Work	Qty	Unit	Rates in Rupees & words		Amount	
				Rs	Ps	Rs	Ps
16	Providing, laying and jointing glazed stone ware pipes grade 'A' with stiff mixture of Cement mortar in the proportion 1 : 1 (1 cement : 1 fine sand) including testing of joints etc complete						
(a)	For 150 mm dia	5	RM				
(b)	For 250 mm dia	5	RM				
17	Providing and fixing constructing road gully chamber 50 x 45 x 60 cm with bricks of class designation 50 in cement mortar 1:5 (1 cement : 5 fine sand) including 500 x 450 mm pre cast RCC horizontal grating with frame complete as per standard design with FPS bricks	2	Each				
18	Making connection of drain or sewer line with existing manhole including breaking into and making good the walls, floors with cement concrete(1:2:4) (1 cement : 2 coarse sand : 4 graded stone aggregate 20 nominal size) cement plastered on both sides with cement mortar 1:3 (1 cement : 3 coarse sand) finished with a floating coat of neat cement and making necessary channels for the drain etc., complete for pipes 100 to 230 mm diameter	3	Each				
19	Constructing masonry chamber 60 X 45 X 50 cm inside with 75 class designation brick work in CM (1 : 5) (1 cement : 5 fine sand) and C I double Flap surface box 400 x 200 x 200 mm (inside) with locking arrangement and RCC top slab (1 : 2 : 4) mix (1 cement : 2 coarse sand : 4 graded stone aggregate nominal size 20 mm) necessary excavation foundation concrete (1 : 5 : 10) (1 cement : 5 fine sand : 10 graded stone aggregate 40 mm nominal size) and inside plastering with CM (1 : 3) (1 cement : 3 coarse sand) 12 mm thick finished with a floating coat of neat cement complete as per standard design with FPS bricks	2	Each				
20	Providing and fixing PVC Nahani Traps of ISI Make of 100 x 100 mm at all heights and levels size	3	Each				
21	Providing and fixing fancy CP brass fittings and flange of approved brand and manufacture(oriental series of MARC or pearl/jade series of Parryware or Continental clasion series of JAGUAR or crystal series of MARC)						
(a)	15 mm nominal health faucet	3	no.				
(b)	15 mm dia nominal size push cock with 20 mm BSP female thread 100 mm long ,57 mm high and 33 mm wide with 12 mm seat dia & replaceable washer weighing not less than 75 gms.	2	no.				

Sl. No.	Description of Work	Qty	Unit	Rates in figures & words		Amount	
				Rs	Ps	Rs	Ps
22	Providing and fixing liquid soap dispenser and holder as per approved design.	6	No				
23	Providing and fixing 15mm dia approved and tested quality screw down long body C.P bib cock including the cost of all materials and labour at all heights and levels	2	No				
24	Providing and fixing C.P.flanges to the bib-cock of all approved quality at all heights and levels.	2	No				
25	Providing and fixing 32mm dia C.P.waste coupling of approved and tested quality including cost of all materials and labour at all heights and levels.	2	No				
26	Supplying and fixing C.I. Centrifugally cast socket & spigat, soil, waste & vent pipe with lead joints and all fittings with all necessary pipe tees, nails, 'Y' junctions, bends, collars, wooden blocks etc., with holder bat clamps, screws, digging trenches & refilling, cutting holes in floors and walls wherever required and making good the damages including painting exposed pipes with 2 coats of approved quality paint and underground pipe with 2 coats of approved anticorrosive paint complete at all heights and floors for following diameter.						
(a)	110mm dia	15	RM				

Sl. No.	Description of Work	Qty	Unit	Rates in figures & words		Amount	
				Rs	Ps	Rs	Ps
27	Providing and fixing 100mmx75mm CI Floor trap/urinal trap of approved quality of type including all materials and labour complete setting or constructing cistern in 1:2:4 proportion at all heights and floors	2	No				
28	Providing and fixing CI cowl of approved and tested quality including cost of all materials & labour at all heights and levels						
	a) 100mm diameter	2	No				
29	providing and fixing electric hand dryer of approved make, complete as per direction of engineer in charge	2	each				
30	Supplying and filling up the sunken floor with broken light weight bricks or cinder filling as directed by Engineer-in-charge	45	CUM				
31	Providing and fixing white vitreous china flat half stall flat back urinal of 580 x 380 x 350 mm Parryware / Hindware / Seabird / Orient (coral) with fittings standard size CP brass flush pipe, spreaders with unions and clamps (all in CP Brass) with waste fittings as per IS : 2556, CI trap with out let grating and other couplings in CP brass including painting of fittings and brackets, cutting and making good the walls and floors wherever required single half stall urinal with 5 litres PVC automatic flushing cistern at all heights and floors	9	Each				
TOTAL VALUE OF TOILET PORTION							

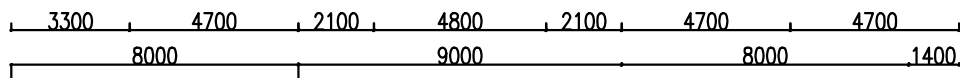
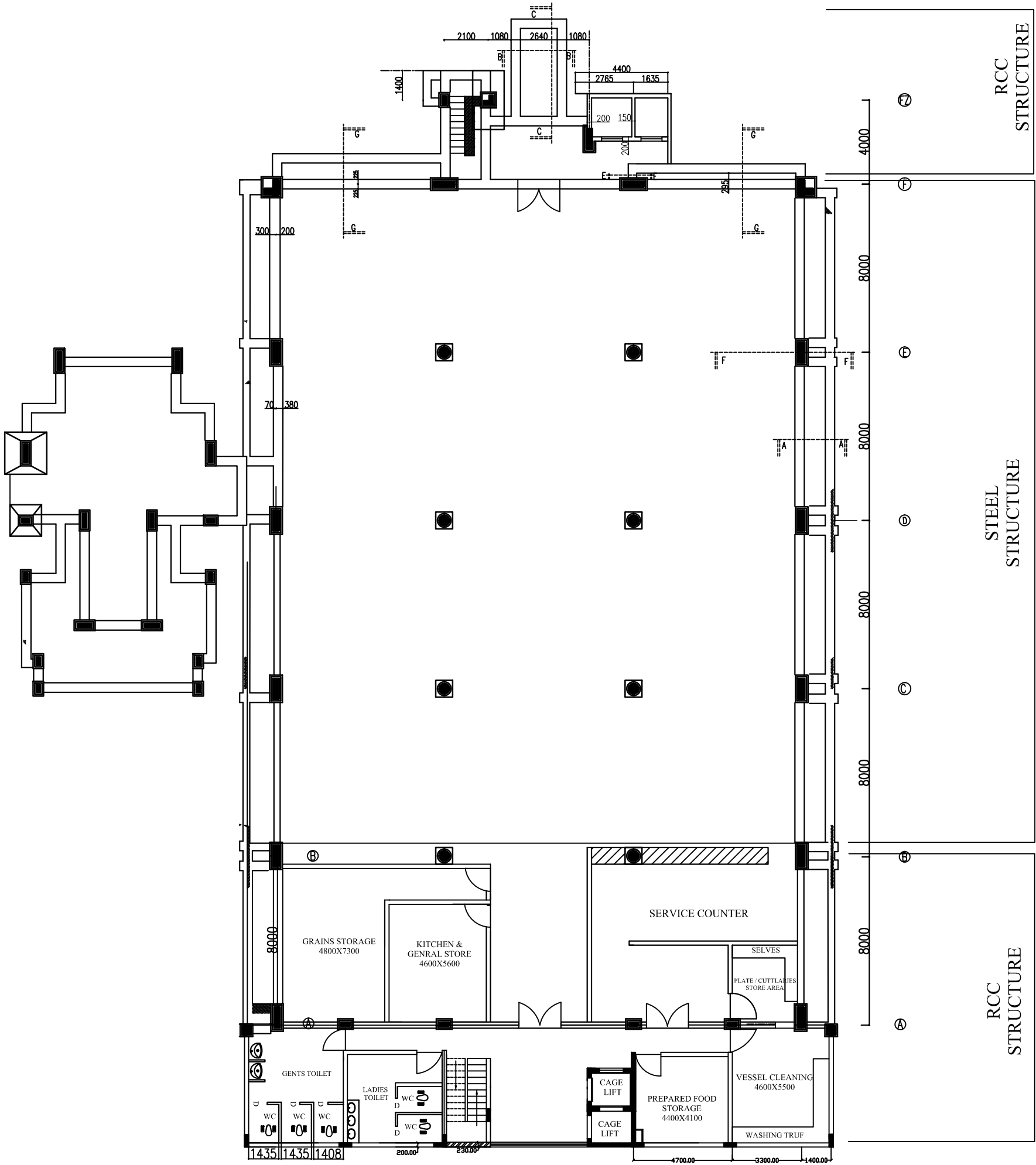

LOCATION:
OVER FIRST FLOOR OF
EXISTING PRODUCTION BLOCK

BHARAT HEAVY ELECTRICALS LTD
At Site No 91, Electronics city,
Hosur Road. BANGALORE-56010

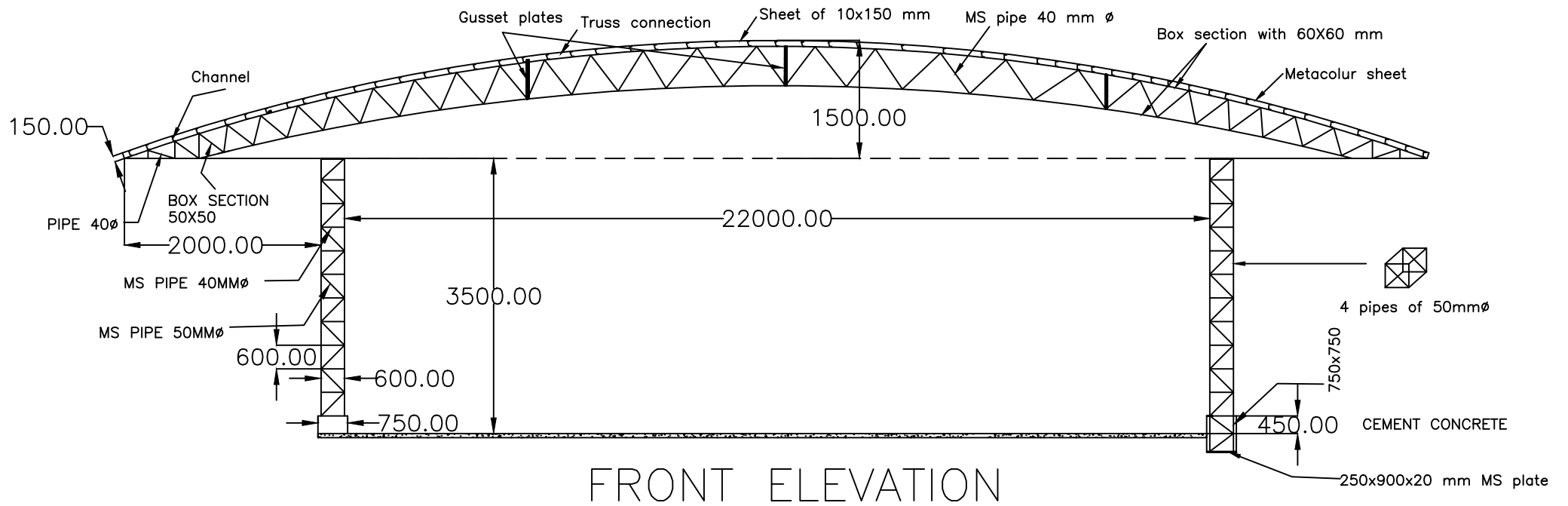

BHARAT HEAVY ELECTRICALS LIMITED
ELECTRONICS DIVISION
BANGALORE – 560026

GENERAL CONDITIONS OF CONTRACT
FOR
LUMP-SUM, ITEM-RATE AND PERCENTAGE
CONTRACT

REVISED GENERAL CONDITIONS OF CONTRACT w.e. f. 1-4-1975

CONTENTS

Condition Number	Description
---------------------	-------------

CHAPTER –I

1. Definitions

CHAPTER-II

2. Heading to the contractor
3. Contract documents
4. Works to be carried out
5. Provisional items
6. Deviations
7. Time
8. Stores & materials
9. Delay & Extension of time
10. Patent Rights
11. Octroi & other duties
12. Royalties
13. Plant & Equipment
14. Assignment or Transfer of contract
 - a) Sub -contract
15. Compliance to Regulations and Bye –laws

CHAPTER –III

16. Security deposit
17. Orders under the contract
18. Admission to site
19. Contractor's Supervision
20. Labour
21. Water
22. Temporary Workshops, stores etc.,
23. Stores & materials-on-site etc
24. Tools & plant on site
25. Statement of Hire charges
26. Precautions against Risks
27. Notices & Fees
28. Setting out of the works and protecting & maintaining signal marks
29. Site drainage
30. Excavations, reliefs, etc.,
31. Foundations
32. Covering in work
33. Approval of works by stages
34. Execution of works
35. Day work
36. Inspection of the work
37. Responsibility for building
38. Insurance of works against damage and loss, due to fire, tempest, floods etc.
39. Damage or loss to private property and injury to workman.
40. Completion
41. Compensation for delay.

42. Laws governing the content.
43. Cancellation of contract for corrupt act.
44. Cancellation of contract for insolvency, assignment or sub-letting of contract
45. Cancellation of contract for default.
46. Termination of contract for death.
47. Special powers or determination.
48. Fair wage.

CHAPTER-IV

49. Records and measurements.
50. Valuation of deviations.
51. Reimbursement / refund on variation in price.
52. Advances on account.
53. Final bill.
54. Payment of bills.
55. Recovery from contractor.
56. Post-technical audit of work and bills.
57. Refund of security deposit.

Annexure-‘A’

BHEL contractor’s Labour Regulation and BHEL safety code (See Condition 20)

1. DEFINITIONS

In these general conditions of contract, the following terms shall have the meaning hereby assigned to them except where the context otherwise requires:

- a) The “CONTRACT” means the documents forming the tender and acceptance thereof, together with all the document referred therein including general and Special Conditions of Contract, Schedules ‘A’, ‘B’, ‘C’, ‘D’, ‘E’ and/or General Summary attached to the form of tender, the Karnataka P.W.D. Schedule of Rates as amended up to 1979-80 the specifications and the Drawings. All these documents as applicable taken together shall be deemed to form one contract and shall be complementary to one another.
- b) The “TENDER DOCUMENTS” means the form of tender, the applicable schedules ‘A’, ‘B’, ‘C’, ‘D’, ‘E’ and/or General and Special conditions of contract and the specifications and / or drawings as given to contractors on payment for the purpose of preparing their tenders
- c) The ‘WORK’ means the work described in the tender documents, in individual work orders and/or accompanying drawings and specifications as may be issued from time to time to the Contractor by the Senior Engineer (Civil) deputy manager (projects) or the Engineer-in-charge within the powers conferred upon them, including all modified or additional works and obligations to be carried out either at the site or at any Factory workshop or other place as required for the performance of the contract.
- d) The “SITE” means the land and /or other places on, in, into or through which the work is to be executed under the contract or any adjacent land, path or street which may be allotted to or used for the purpose of carrying out the contract.
- e) The “CONTRACTOR” means the individual, firm or company, whether incorporated or not, undertaking the work and shall include the legal personal representatives of such individuals or the persons composing the firm or company, or the successors of the firm or Company and the permitted assigns of such individual or the firm or company.
- f) The abbreviations DGM/P, Sr. M/P, S.E/C means Dy. General Manager /Projects, Senior Manager / Projects, and Senior Engineer / Civil respectively, who direct the contract and the letters E/C means Engineer / Civil in-charge of the particular work pertaining to the contract.
- g) The “Engineer – in – charge” means the Engineer / Civil deputed by Senior / Civil to supervise the work, or part of the work.
- h) “APPROVED” and “DIRECTED” means the approval or direction of the DGM/P. Sr. M/P, or S.E/C. or person deputed by them for the particular purpose.
- i) “BHARAT HEAVY ELECTRICALS LIMITED” hereinafter referred to as BHEL SHALL mean the board of directors, Resident Director, General Manager/ Project Administrator or other Administrative Officers, of the said company including the project officer, Sr. Manager / Projects, or Senior Engineer / Civil, Engineer/ Civil authorized to invite tenders and enter into the contracts for works on behalf of “Bharat Heavy Electrical Limited”, Unit: Electronics Division, Mysore Road, Bangalore – 26.
- j) In the case of lump sum contracts, CONTRACTOR’S PERCENTAGE” means the percentage offered by the contractor as addition to or deduction from the cost of buildings, or other works listed in schedule, ‘A’ to provide a lump sum quotation for performance of the contract inclusive of all extra costs, profit, establishment charges, carriage, insurance etc., complete.

In the case of percentage rate contracts, “Contractor’s percentage” shall, if the context so permits, mean the uniform percentage tendered by the contractor and accepted by the Accepting Officer, and the expression “CONTRACT RATE” shall likewise mean the rates in the K.P.W.D. schedule of rate as amended up to 1979 - 80 as adjusted by the said Contractor’s percentage, if any.

- k) The “CONTRACTOR SUM” means the sum accepted, or the sum calculated in accordance with the prices accepted in the tender and / or the contract rates as payable to the Contractor for the entire execution and full completion of the work.
 - l) The “FINAL SUM” means the actual amount payable under the contract by BHEL, to the Contractor for the entire execution and full completion of the work.
 - m) The “DATE OF COMPLETION” is the date or dates for completion of the whole or any part of the work as set out in or ascertained in accordance with the individual work orders or the tender documents, or any subsequent agreed amendment thereto.
 - n) A “WEEK” means seven days without regard to the number of hours worked or not worked in any day in that week.
 - o) A “DAY” means a day of 24 (Twenty four) hours irrespective of number of hours worked or not in that day A “WORKING DAY” means any day other than that prescribed by the Negotiable instruments ACT as being a holiday, consists of the number of hours of labour as commonly recognized by good employers in the trade in the District where the work is carried out or as laid down in the BHEL Regulation.
 - p) “DEVIATION ORDER” means any an order given by the Senior Engineer/Civil or Engineer-in-charge to effect an alteration, addition or deduction, which does not radically affect the scope of nature of the contract.
 - q) “EMERGENCY WORK” means any urgent measures which, in the opinion of the Engineer-in-charge, become necessary during the progress of the work to obviate any risk of accident or failure or which become necessary for security.
 - r) “PROVISIONAL SUM” or “PROVISIONAL LUMPSUM” means a lump-sum include by the BHEL in the tender documents and represent the estimated value of work for which details are not available at the time of inviting the tender.
 - s) “PROVISIONAL ITEMS” means items for which approximate quantities have been included in the tender documents.
 - t) “DAY WORK” means on item of work requiring the employment of labour with or without materials as the case may be, which, in the opinion of the Senior Engineer /Civil-in-charge, is not capable of being evaluated by the accepted methods of measurement or assessment and is paid for on the basis of the actual labour and materials utilised on the particular item of work referred to.
-

CHAPTER-II

SCOPE OF CONTRACT

2. HEADING TO THE CONTRACT

The heading to these conditions shall not affect the interpretation thereof

3. CONTRACT DOCUMENTS:

The accepting officers shall furnish to the Contractor on demand "FREE OF COST" three copies of signed Drawing and one copy of the signed agreement comprising of preamble to Agreement, General and Special Specifications, Schedules 'A' 'B' 'C' 'D' and 'D' etc., (but excluding General Conditions of Contract and Drawing) and three copies of all further drawings issued during the progress of work.

However, for any additional copies of the agreement or drawings required by the Contractor, the same will be supplied on payment the Specified Cost.

The contractor shall keep one copy of all the drawings and of the specifications on the site and the Engineer-in-charge or his representative shall at all reasonable times have access to them.

4. WORK TO BE CAREED OUT :

The Contract shall, except as provide under Schedules 'B' and 'C' include all labour , materials, tools, plant , equipment and transport which may be required in preparation for , and in the execution and full completion of the work. Schedule 'A' shall be deemed to have been prepared in accordance with good practice and recognized principles and unless otherwise stated , the descriptions given therein shall be held to include waste on materials, carriage and cartage, lead ,return of empties , hosting, setting, fitting in position and all other labour necessary in and for the entire execution and full completion aforesaid. Any error in description or quantity in Schedule 'A' or any omission there from shall not vitiate the Contract or release the Contractor from the execution of the whole or any part of the work comprised therein according to the drawings and specifications, or from any of his obligations under the contract. The insertion of the name of any firm of suppliers in the Tender Document is for the purpose of obtaining a particular class or quantity of materials or workmanship but the articles or materials specified may be obtained from any other firm subject to the prior written approval of the Senior Engineer / Civil / Engineer/Civil.

In the case of a discrepancy between Schedule 'A' the Specifications and/or the drawings, the accepting officer shall be the sole deciding authority as to which shall prevail and his decision shall be final and conclusive. If neither drawings nor specifications contain any mention of minor details of construction, which in the opinion of the Accepting Officer whose decision shall be final and conclusive, are responsible and obvious and fairly intended for the satisfactory completion of the work, such details shall be provide by the Contractor without any extra cost as if they were specially mentioned and shall be deemed to be included in the contract.

The Contractor will be deemed to have satisfied himself as to the nature of the site, local facilities of access and all matters affecting the execution and completion of the work. No extra charges consequent on any misunderstanding in this respect or otherwise will be allowed.

5. PROVISIONAL ITEMS:

The full amount of provisional lump-sum and the value annexed to each provisional item inserted in the Tender documents shall be deducted from the contract sum and the value of work ordered and executed there under shall be ascertained by measurement or valuation as for deviations.

No work under these items is to be begun without instructions in writing from the Engineer- in -charge.

The extend of quantities or items described as "provisional " shall not be held to guarantee or limit the amount and description of the work to be executed by the Contractor either respect of the item concerned or the work as a whole.

No addition or deduction shall be made by the Contractor to the amount of the provisional lump-sums as included in the tender documents.

6. DEVIATIONS:

The contractor shall not make any alteration to or omission from the work as described in the tender documents except in pursuance of the written instruction of the Engineer –in charge. No such deviation from the work described in the tender documents shall be valid unless the same has been specifically confirmed and accepted by the Accepting Officer in writing and incorporated in the contract.

The accepting Officer may deviate, either by way of addition or deduction, from the work so described, provided that the contractor sum be not thereby varied on the whole by more than the percentage set out in the tender documents. The value of all additions and deductions will be added to, or deducted from the contract sum. Whenever the Accepting Officer intends to exercise such a right, his intention shall specify the deviation which are to be made, the lump-sum assessment or the proposed basis of payment, the extra time allowed, if any and the date for completion of the entire contract.

Any objection by the Contractor to any matter concerning the order shall be notified by him in writing to the Senior Engineer (Civil) / Engineer-in-charge within SEVEN DAYS from the date of such order, but under no circumstances shall the work be stopped (unless so order by the Senior Engineer/Civil /E/C owing to differences or controversy that may arise from such an objection. In the absence of such a notification of objection, by the contractor, he will be deemed to have accepted the ordered and the conditions stated therein. In the event of the contractor, failing to agree with the Senior Engineer/ Civil /E/C regarding the terms of the proposed deviation, the objection shall e referred to the DGM/P/Sr.M/P, whose decision shall be final, conclusive and binding on the Contractor.

7. TIME:

Time is the essence of the contract and is specified in the tender document or in each individual work order.

As soon as possible after the contract is let or any substantial work order is placed and before work under it is begun, the Senior Engineer/Civil or Engineer-in-charge and the contractor shall (if so required by the Sr. E/C) agree to a time and Progress chart. The chart shall be prepared direct relation to the time stated in the tender documents or the Work Order for the completion of the individual items thereof, and/or the contract or Orders a whole. It shall indicate the forecast of the dates for the commencement and completion of the various trade processes or sequences of the work, and shall be amended as may be required by agreement between the Sr. E/C or Engineer-in-charge, and the contractor within the limitation of the time imposed in the tender documents or ORDER.

In the absence of any specific Time and Progress Chart to be agreed to between the Contractor and the Sr. E/C. or Engineer –in-charge, the contractor shall ensure and maintain uninterrupted progress of the work such that the entire work shall be completed within the time imposed in the tender document or order and that the proportion of work completed up to any time in relation to the entire work to be done under the Contract or Order shall not be less than the proportion that the time elapsed bears to total time of completion provided in the tender Document or Order.

The Contractor shall suspend the execution of the work, or any part or parts there of whenever called upon in writing by the Engineer –in –charge to be so, and shall not resume work there on unit so directed in writing by the Engineer –in –charge. The Contractor will be allowed an allowed an extension of time for completion not less than the period of suspension but no other claim in this respect for completion or otherwise how so ever will be admitted. This may also be extended to allow for alteration of work made by the deviation order.

8. STORES AND MATERIALS:

The contractor shall, at his own expense , supply all stores and materials required for the contract, other than those listed in Schedule ‘B’ which may be provided by Bharat Heavy Electricals Limited at the rates detailed therein subject to their availability at the place of issue indicated therein. All stores and materials to be supplied by the Contractor shall be of the best kind as described in the Specifications and the Contractor shall,

if required by the Engineer –in- charge furnish him with proof to his satisfaction that the store and materials so comply with the specifications.

The contractor shall, at his own expense and without delay, supply samples of stores and materials proposed to be used in the execution of the work for the approval of the Engineer-in charge, who may reject all stores and materials not corresponding either in quality or character to the approved samples.

In the case of stores provided under Schedule 'B' the Contractor shall bear the cost of loading, transporting to site, unloading, storing under cover as required, assembling & jointing the several parts together as necessary and incorporating & fixing these stores & materials in the work, including all preparatory work of whatever description that may be required, and closing, preparing, loading and returning empty cases or containers to the place of issue without any extra charges.

9. DELAY AND EXTENSION OF TIME:

If, in the opinion of senior Engineer/Civil/engineer/Civil the work is delayed:

- i) by reason of abnormally bad weather, or
- ii) by reason of serious loss or damage by fire, or
- iii) by reason of civil commotion, local combination of workmen, strike or lockout, affecting any of the trades employed on the work, or
- iv) by delay on the part of the agency or tradesman engaged by BHEL in executing work not forming part of this contract, or
- v) by reason of any other cause which in the absolute discretion of the Sr. M/P. Sr. E/C. or E/C is (when he is the Accepting Officer of the Contract) beyond the contractors control, then in any such case, the Accepting Officer, on the recommendation of the Sr. E/C., E/C (or higher authority) may make fair and reasonable extension in the completion dates of the individual items of work or the contract as a whole. Such extension which will be communicated to the contractor by the Sr. E/C. /E/C. in writing shall be final and binding on the contractor. No other claim in this respect for compensation or otherwise howsoever is admissible. Upon the happening of any such event causing delay, the contractor shall immediately give notice thereof in writing to the Sr. E/C/E/C but shall do all that may reasonably be required to the satisfaction of the Sr. E/C/E/C to proceed with the work.

10. PATENT RIGHTS:

The contractor shall fully indemnify BHEL, or the agent, servant, or employee of BHEL, against any action, claim or proceeding relating to infringement or the use of any patent or design or any alleged patent or design rights, and shall pay any royalties which may be payable in respect of any article/ or part thereof included in the contract.

In the event of any claims being made or action brought against BHEL, or any agent, or servant or employee of BHEL., in respect of any of the matters aforesaid, the contractor shall not apply when such increment has taken place in complying with the specific directions issued by the BHEL but the contractor shall pay any royalties payable in respect of any such use.

11. OCTROI AND OTHER DUTIES:

All charges on account of Octroi, Terminal or Sales Tax and / or other duties on materials obtained for the work (excluding materials provided by BHEL, on payment) shall be borne by the contractor.

12. ROYALTIES:

Royalties fixed from time to time as per prevalent local rules will be recovered for materials, which the contractor may be allowed to remove from quarries situated on land which is in charge of the BHEL, authorities.

13. PLANT AND EQUIPMENT:

The contractor, shall at his own expanses, supply all tools, plant and equipment (herein-after referred to as T & P) required for the execution of the contract, as specified in the tender documents.

14. ASSIGNMENT OR TRANSFER OF CONTRACT:

The contract shall not, without the prior written approval of the Accepting Officer, assign or transfer the contract or any part thereof, or any share, or interest therein to any other person. No sum of money which may become payable under the contract shall be payable to any person other than the contractor unless the prior written approval of the Accepting Officer to the assignment or transfer of such money is given.

a) SUB-CONTRACT:

The contractor shall not sub-let any portion of the contract without the prior written approval of the Accepting Officer

15. COMPLIANCE TO REGULATION AND BYE-LAWS :

The contractor shall conform to the provisions of any statute relating to the work and regulations and bye-law of any local authority and water and of any water and lighting Companies or Under takings with those systems the works is proposed to be connected. He shall before making any variation from the drawings or the specification that may be necessitated for such connection give the Senior Engineer /civil /E/C notice, specifying the variation proposed to be made and the reason therefore and shall not vary out any such variation until he has received instructions from the Senior Engineer/ Civil /E/C in respect thereof. The contractor shall be bound to give all notices required by statute regulations or bye-laws as aforesaid and to pay all fees and taxes payable to any authority in respect thereof.

CHAPTER-III

PERFORMANCE OF THE CONTRACT

16. SECURITY DEPOSIT

Upon acceptance of the tender, the successful tenderer shall remit the security deposit with Bharat Heavy Electricals Ltd within the time as specified in the Letter of Intent.

The rate of Security Deposit will be as below:

Up to Rs.10 Lakhs	10%
Above Rs. 10 Lakhs up to Rs.50lakhs	Rs .1 Lakhs + 7.5% of the amount exceeding Rs. 10 Lakhs
Above Rs.50 Lakhs	Rs. 4 Lakhs + 5% of the amount exceeding Rs. 50 Lakhs

The contractor should submit the Security Deposit before the start of the work.

- i) Cash (as permissible under the income Tax Act).
- ii) Pay order, demand draft in favour of BHEL.
- iii) Local cheques of scheduled banks, subject to realization.
- iv) Securities available from Post Offices such as National Saving Certificates, Kisan Vikas Patras etc.,
(Certificate should be held in the name of contractor furnishing the security and duly pledged in favour of BHEL and discharged on the back)
- v) Bank Guarantee from scheduled Banks/Public financial Institutions as defined in the companies Act subject to a maximum of 50% of the total security deposit value. The balance 50% has to be remitted either by cash or in the other form of security. The Bank Guarantee format should have the approval of BHEL.
- vi) Fixed Deposit Receipt issued by scheduled Banks/Public Financial Institutions as defined in the Companies Act. The FDR should be in the name of the contractor, A/C BHEL, duly discharged on the back.
- vii) Security Deposit can also be recovered at the rate of 10% from the running bills. However in such cases at least 50% of the Security Deposit should be collected before start of the work and balance 50% may be recovered from the running bills.
- viii) EMD of the successful tenderer shall be converted and adjusted against the Security Deposit.
- ix) The Security Deposit shall not carry any interest.

NOTE: Accepting of Security Deposit against Sl. No. (iv) and (vi) above will be subject to hypothecation or endorsement on the documents in favour on BHEL. However, BHEL will not be liable or responsible in any manner for the collection of interest or renewal of the documents or in any other matter connected therewith.

For extra items of work and deviated quantities, security deposit will be recovered at 10% of the value of deviated amount. The security deposit will be released as stipulated under clause 16(IV) of GCC.

17. ORDERS UNDER THE CONTRACT:

All orders, notices etc. to be given under the contract shall be in writing, type script of printed and if sent by registered post to the address given in the tender of the contractor , shall be deemed to have been served on the date when in the ordinary course they would have been delivered to him.

The contractor shall carry out without delay all orders given to him.

18. ADMISSION TO SITE:

The contractor shall not enter on (other than inspection purposes) or take possession of the site unless permitted to do so by the Senior Engineer/Civil/E/C. The portion of the site to be occupied by the Contractor will be clearly defined and marked on the site plan, and the contractor will on no account be allowed to extend his operations beyond these areas.

The Contractor shall provide, if necessary, or required at the site, temporary access thereto and shall alter, modify and maintain the same as required from time to time. He shall take out and clear away the access route when no longer required restoring the area to its original conditions.

The Senior Engineer/Civil/E/C shall have power to execute other works (whether or not connected with the work in the contract agreement) in the site contemporaneously with the execution of the original work and contractor shall give reasonable facilities for this purpose.

BHEL, reserves the right of taking over, at any time, and portion of the site which they may require and the contractor shall at his own expense clear such portion forthwith. No photographs of the site or of the work or any part thereof shall be taken, published or otherwise circulated, without the prior approval of the Senior Engineer/Civil/E/C.

No such approval shall however exempt the contractor from complying with any statutory provisions in regard to the taking and publication of such photographs.

BHEL officials connected with the contract shall have the right of entry to the site at all times.

Senior Engineer/Civil/E/C shall have the power to exclude from the site any person whose admission thereto may, in his opinion, be undesirable for any reason whatsoever.

19. CONTRACTOR'S SUPERVISION:

The Contractor shall either himself supervise the execution of the Contract or shall appoint a competent Agent approved by the senior Engineer/Civil/E/C to act in his stead.

The contractor shall employ on Engineer/Agent having at least a 'Degree of Bachelor of Civil Engineering' from a recognised University/on any work with a Contract value exceeding rupees two lakhs and having at least a 'Diploma in Civil Engineering' from a recognised college on work with a contract value exceeding Rs. 50,000/- but not exceeding rupees two lakhs.

The employment of an Engineer/Agent as aforesaid, the Senior Engineer/Civil/E/C capable possession of a recognised technical qualification and is in opinion of the Senior Engineer/Civil/E/C capable of receiving instructions of the Engineer-in-charge and of executing the work to the satisfaction of the Engineer-in-charge.

If the contractor fails to appoint a suitable Engineer/Agent as aforesaid, the Senior Engineer/Civil/E/C shall have full powers to suspend the execution of work and stop payment of any advances that may have become due until such date as a suitable Engineer/Agent is appointed and the contractor shall be held responsible for the delay caused to the work and no extension of time on this account shall be given to him as stipulated in condition (9) above.

Orders given to the contractors Agent/Engineer shall be considered to have the same force as if they had been given to the contractor himself.

The contractor or his agent shall be in attendance at the site during all working hours and shall superintended the execution of work with such additional assistance in each trade as the Senior Engineer/Civil/E/C may consider necessary.

The contractor or his accredited agent shall attend, when required and without making any claim for doing so, either the Office of the Engineer-in-charge or the work-site to receive instructions.

The Senior Engineer/Civil/E/C shall have full powers, and without assigning any reason, to require the contractor immediately to cease to employ in connection with this contract any agent, servant or employee whose continued employment is, in his opinion, undesirable.

The contractor shall not be allowed any compensation on this account.

20. LABOUR:

The contractor shall employ labour in sufficient numbers either directly or through sub-contractors to maintain the required date of progress and of quality to ensure workmanship of the degree specified in the contract and to the satisfaction of the Engineer-in-charge. The contractor shall not employ in connection with the works any person who has not completed his fifteen years of age.

The contractor shall furnish to the Engineer-in-charge at the intervals specified by him, a distribution return of the number and description by trades of the work people employed on the works. The contractor shall also submit on the 4th and 19th of every month to the Engineer-in charge a true statement showing in respect of the second half of the preceding month and the first half of the current month (i) the accident that occurred during the said fortnight showing the circumstances under which they happened and the extent of damage and injury caused by them and (ii) the number of female workers who have been allowed maternity benefit as provided in the maternity benefit Act, 1961 or Rules made there under and the amount paid to them.

The contractor shall pay to labour employed by him either directly or through sub-contractors wages not less than fair wages as defined in the contractor's labour regulations.

The contractor shall in respect of labour employed by him either directly or through sub-contractors comply with or cause to be complied with contractors Labour Regulations in regard to all matters provided therein.

The contractor shall comply with the provisions of the payment of Wages Act, 1936, Minimum Wages Act, 1948, Employers Liability Act 1938, Workman's Compensation Act, 1923, industrial Disputes Act, 1947, Maternity Benefit Act, 1961 and Mines Act 1952 or any other law relating thereto and rules and there under from time to time.

The contractor shall be liable to pay his contribution and the employees' contribution to the State Insurance Scheme in respect of all labour employed by him for the execution of the contract, in accordance with the provision "The Employees" State Insurance Act, 1948" as amended from time to time. In case the contractor fails to submit full details of his account of labour employed and the contribution payable, the Engineer-in-charge shall recover from the running bills of contractor an account of contribution as assessed by him. The amount so recovered shall be adjusted against the actual contribution payable for employees' State Insurance.

The Engineer-in-charge shall on a report having been made by an inspecting Officer as defined in the contractors labour regulations have the power to deduct from the moneys due to the Contractor any sum required or estimated to be required for making good the loss suffered by a workers by reason of non-fulfillment of the conditions of the contract for the benefit of workers, non-payment of wages or of deductions made from his or their wages which are not justified by the terms of the contract or non-observance of the contractors labour Regulations.

The contractor shall indemnify the BHEL against any payments to be made under for observances of the Regulations aforesaid without prejudice to his right to claim indemnify from this sub-contractors.

In the event o the Contractor committing a default or breach of any of the provisions of the aforesaid Contractors Labour Regulations, as amended from time to time or furnishing any information or submitting or filling any form/Resister/Slip under the provisions of these regulations which is materially incorrect then on the report of the Inspecting Officers as defined in the Contractors Labour Regulation, the contractor shall without prejudice to any other liability pay to the BHEL a sum not exceeding to Rs.50/- as liquidated damages for every default breach or furnishing, making, submitting, filling materially incorrect statement as may be fixed by the Engineer-in-charge and in the event of the contractors default continuing in this respect, the liquidated damages may be enhanced to Rs. 50/- per day for each day of default subject to a maximum percent of the estimated cost of woks put to tender.

The Engineer-in-charge shall deduct such amount from bills or security deposit of the contractors and credit the same to the Welfare fund constituted under Regulations. The decision of the Engineer-in-charge in this respect shall be final and binding.

MODEL RULES FOR LABOUR WELFARE:

The contractor shall at his own expense comply with or cause to be complied with model Rules for Labour Welfare as appended to these conditions as rules framed by Government from time to time for the protection of health and for making sanitary arrangements for workers employed directly or indirectly on the works. In case the contractor fails to make arrangements as aforesaid, the Engineer-in-charge shall be entitled to do so and recover the cost thereof from the Contractor.

SAFETY CODE:

The contractor shall at his own expense arrange for the safety provisions as appended to these conditions or as required by the Engineer-in-charge, in respect of all labour directly or indirectly employed for performance of the works and shall provide all facilities in connection therewith. In case the contractor fails to make arrangements and provide necessary facilities as aforesaid, the Engineer-in-charge shall be entitled to do so and recover the cost thereof from the contractor.

Failure to comply with model Rules for Labour Welfare, Safety Code, or of the provisions relating to report on accidents and to grant of maternity benefits to female workers shall make the Contractor liable to pay to the BHEL as liquidated damages an amount not exceeding Rs 50/- for each default or materially incorrect statement. The decision of the Engineer-in-charge in such matters based on reports from the Inspecting Officers as defined in the contractors Labour Regulation as appended to these conditions shall be final and binding and deductions for recovery of such liquidated damages may be made from any amount payable to the Contractor.

21. WATER :

The contractor shall allow in his tender and provide at his cost all water required for the work or his employees on the work, together with all pipes and fittings or other means that may be necessary or required to ensure a proper and ample supply of water for all purpose connected with the work.

In the event of a provision existing in the Tender documents for supply of water on payment by Bharat Heavy Electricals Limited, water will be supplied from the BHEL supply System, or other sources at any points fixed by the Senior Engineer/Civil on the site of work. The contractor shall make necessary arrangement for lifting, pumping, carrying or conveying the water as required at his own cost. The levy of water charges to be borne by the Contractor in such case shall be specifically mentioned in the Tender documents.

22. TEMPORARY WORKSHOPS, STORES ETC :

The Contractor shall, during the progress of the work provide, erect and maintain at his own expenses all necessary temporary workshops, store, offices etc., required for the proper and efficient execution of the work. The planning, setting and erection of these bldgs. shall have the approval of the Engineer-in-charge and the Contractor shall at all times them tidy and in a clean and sanitary condition to the entire satisfaction of the Engineer-in-charge.

On completion of the work all such temporary buildings shall be cleared away and the site restored and left in a clean and tidy condition to the entire satisfaction of the Engineer-in-charge.

23. STORES AND MATERIALS ON SITE :

All stores and materials required for the work are to be deposited by the Contractor only in places to be indicated by the Engineer-in-charge.

Where in accordance with the contract stipulations certain Stores and Materials (for incorporation in the work) are to be issued to the Contractor by the BHEL as detailed under Schedule 'E' such times will be so issued only to the extent required for the actual completion of the work as stipulated in the Contract. The decision of the Senior Engineer/Civil/E/C regarding the quantities to be issued as above shall be final and binding on the Contractor. For any excess quantities consumed on the work their cost will be recovered from the Contractor at punitive rates which will be 100% (hundred percent) more than the issue rates of the BHEL.

In regard to the materials and stores which may be issued to the contractor by BHEL the Contractor shall give the Engineer-in-charge reasonable notice in writing of his requirements of such stores and materials and on the approval of his demand being notified to him, he shall make immediate arrangements for drawing the same. Such stores and materials shall be transported by Contractor at his own expenses direct from the place of issue to the site of the work, unless prior written approval is obtained from the Engineer-in-charge to take them to a store or workshop elsewhere.

The Contractor shall have to build a weather-proof shed for the storage of cement required for 15 days consumption of the work.

BHEL officers connected with the Contract shall have the power at any time to inspect and examine any stores or materials indented to be used in or on the work, whether on the site or at any place where the same are lying and the contractor shall give necessary facilities for such inspection and examination.

The Engineer-in-charge shall be entitled to have tests made of any stores or materials supplied by the Contractor who shall provide at his own expense all facilities which the Engineer-in-charge may require for this purpose. If at the discretion of the Engineer-in-charge an independent expert is employed to make any such tests his charges shall be borne by the contractor only if the test discloses that the said stores or materials are not in accordance with the provisions of the contract.

Should the Senior Engineer/Civil/E/C consider at any time during the construction or re-construction, on prior to the expiry of the 'MAINTENANCE PERIOD', that the stores or materials provided by the Contractor are unsound or of a quality inferior to that contract for, or otherwise not in-accordance with the Contract, (in respect whereof the decision of the Senior Engineer/Civil/E/C shall be final and conclusive) the contractor shall on demand, in writing from the Sr. E/C. E/C specifying the stores or materials complained of, notwithstanding that the same may have been inadvertently passed, certified and paid for, forthwith remove the stores or materials so specified and provide other proper and suitable store or materials at his own expense; to the entire satisfaction of the Sr. E/C. E/C and in the event of his failing to do so within a period to be specified by the Sr. E/C. E/C in his demand aforesaid, the Sr. E/C.E/C may replace within others the stores or materials complained of at the risk and expense in all respects of the Contractor. The liability of the contractor under this condition shall not extend beyond the maintenance period aforesaid except as regards stores or materials, which the Sr. E/C.E/C shall have previously given notice of to the contractor to replace. (Maintenance period for any work under this organization will be six months from the date of actual completion of the particular work and handing over to BHEL).

All stores and materials brought to the site shall become and remains the property of BHEL and shall not be removed from the site without the prior written approval if the Senior Engineer/Civil/E/C. However, when the work is finally completed the Contractor shall at his own expense forthwith remove from the site all surplus stores and materials originally supplied by him and upon such removal; the same shall rest in and become the property of contractor. All BHEL stores and materials issued to Contractor for incorporation or fixing in the work and which, making due allowance for reasonable wear and tear/or waste, have not on completion of the work been so incorporated or fixed, shall be returned by the Contractor at his own expense to the place of issue.

Credit for surplus and/or materials returned by the contractor to BHEL will be given to him at a price based on the prevailing market rate but not exceeding that at which the said stores and materials were originally issued to him but due consideration shall be given to the allowance claimed by BHEL in respect of any depreciation or damages suffered by the stores and/or materials whilst in the custody of the contractor regarding which the decision of Sr. E/C/E/C shall be final and conclusive.

If, in the opinion of the Sr. E/C/E/C (which shall be final and conclusive) any stores supplied by BHEL have either during currency of the work or after completion of the work whilst under the custody of the contractor, become damaged to such an extent that they cannot be usefully utilized, either in the same work or in other works, the Sr. E/C.E/C shall not accept the stores and in the extent of his rejecting, the Contractor shall be charged for the said stores at a rate fixed by the Accepting Officer. The Contractor shall not be entitled to any claim what-so-ever on this account.

23a. DEFECTS LIABILITY PERIOD:

the contractor shall be responsible to make good and remedy at his own expenses within such period as may be stipulated by the Engineer-in-charge, any defect which may develop or may be noticed before the expiry of the maintenance period of six months hereto from the certified date of completion and intimation of which has been sent to the contractor within seven days of the expiry of the said period by a letter sent by hand delivery or by registered post.

24. TOOLS AND PLANT ON SITE :

All tools, plant and equipment brought to the site shall become the property of BHEL and shall not be removed from the site without the prior written approval of the Senior Engineer/Civil/E/C. When the work is finally completed or the Contractor is determined for reasons other than the defaults of the contract, he shall forthwith remove from the site all tools, plants, equipment etc., (other than those as may have been provided by BHEL) and upon such removal, the same shall revert in, and become the property of the contractor.

25. STATEMENT OF HIRE CHARGES :

Monthly detailed statement of the hire charges incurred in respect of BHEL tools, plants, equipment etc., shall be given to the contractor by the Engineer-in-charge.

26. PRECAUTIONS AGAINST RISKS :

The contractor shall be responsible for providing at his own expense, for all precautions to prevent loss or damage from any and all risks and to minimize the amount of any such loss or damage and for the necessary steps to be taken for the said purpose until the works have been handed over complete in all respect to the Engineer-in-charge.

The contractor shall provide all watchmen necessary, for the protection of the site, the work, the materials, the tools, plant, equipment and anything else lying on the site during the progress of the work. He shall solely be responsible for and shall take all reasonable and proper steps for protecting, securing, lighting and watching all places on or about the work and the site which may be dangerous to any person whom so ever.

27. NOTICES AND FEES :

The contractor shall give all notices required by any statutory provision or by the regulations and/ or bye-laws of any local authority and / or of any Public Service, Company or Authority affected by the work or with whose system the same area or will be connected. The contractor shall pay and indemnify BHEL against any fees and charges, demandable by law under such Acts, Regulations and/ or bye-laws in respect of the work and shall make and supply all drawings and plans required in connection with any such notice.

28. SETTING OUT OF THE WORKS AND PROTECTIVE AND MAINTAINING SIGNALS AND WORKS :

The engineer-in-charge shall supply dimensioned drawing, levels and other information necessary to enable the contractor to set out the work. The contractor shall at his own expense set out accurately according to the drawing and figured dimension thereon, all the work comprised in the contract and any extras or additions thereto and shall be solely responsible for their being so set out the executed.

All bench marks, pegs, signals, on the surface, alignment stones, milestones and all similar marks weather put in by BHEL Authority for the purpose of checking the contractors work or in the nature of permanent survey marks will during the tender of the contract, be under the care of the contractor who shall, at his own expense, take all proper and reasonable precautions and care to preserve and maintain them in their true position. In event of these marks being disturbed or obliterated by accident or due to any other cause whatsoever, the same may, if deemed necessary to be replaced by the Sr.E/C/. E/C at contractors expense and the cost thereof deducted from any money then or thereafter becoming due to the contractor.

Where requested by the contractor, the level marks center line and chainage pegs corresponding to those shown on the drawing will be pointed out to the contractor on the ground but all bench marks or chainage pegs additional to those shown on the drawing will be set out by BHEL authorities.

29. SITE DRAINAGE :

All water that may accumulate on the site during the process of the work, or in trenches and excavations shall be removed to the entire satisfaction of the Engineer-in-charge and at Contractors expense.

30. EXCAVATIONS, RELICS ETC :

Material of any kind obtained from excavation on the site shall remain the property of BHEL and shall be disposed off as the Engineer-in-charge directs.

All gold, silver, oil and other materials of any description and all precious stones, coins, treasured, relics, antiquities and other similar items which may be found in or upon the site shall be the property of Bharat Heavy Electricals Limited and Contractor shall duly preserve the same to the satisfaction of the BHEL and shall from time to time deliver the same to such person or person as the Bharat Heavy Electricals Limited, may appoint to receive the same.

31. FOUNDATIONS :

The contractor shall not lay any foundations until the excavations for the same have been examined and approved in writing by the Engineer-in-charge.

32. COVERING-IN WORK :

The contractor shall give reasonable notice in writing to the Engineer-in-charge whenever any work is to be permanently covered up or concealed, whether by earth or other means so that it can finally be inspected or measured, if necessary. In default of so doing, the contractor shall, if required by the Engineer-in-charge uncover such work at his own expense.

33. APPROVAL OF WORKS BY STAGES :

All work embracing more than one process shall be subject to examination and approval at each stage thereof and the contractor shall give due notice in writing to the Engineer-in-charge when each stage is ready. In default of such notice being received, the Engineer-in-charge shall be entitled to approve the quality and extent thereof at any time he may choose and in the event of any dispute, the decision of the Senior Engineer/Civil thereon shall be final and conclusive.

34. EXECUTION OF THE WORK :

The work shall be executed in a workman-like manner and to the satisfaction in all respects of the Engineer-in-charge.

The Engineer-in-charge will communicate or confirm his instructions to the Contractor in respect to the execution of the work in a "work Site Order Book" maintained at his office and contractor shall visit this office daily and shall confirm receipt of such instructions by signing the relevant entries in this book. Such entries will rank as order or notices in writing within the intent and meaning of these conditions.

35. DAY WORK :

No day-work shall be performed without the prior written instructions of the Accepting Officer.

The Contractor shall give to the Engineer-in-charge reasonable notice of the start of any work ordered to be executed by day-work and shall deliver to the Senior Engineer/Civil-in-charge/E/C within two days of end of each pay-week return in duplicate giving full detailed accounts of labour and materials for that pay week. One copy of each of these returns, if found correct, will be certified by the Engineer-in-charge and returned to the contractor and must be produced at the time of adjustment of accounts.

An invoice in duplicate signed by the Contractor or his agent shall be sent with each delivery of materials for day-work and the contractor will be furnished with a receipt signed by the Engineer-in-charge specifying the description, quantities weight or measurement (as the case may be) of the articles approved, reference will be made in this receipt in the return aforesaid and the receipt itself is to be produced in support of the Contractors bill.

In the case of Lump-sum contracts, the rates to be changed and the percentage addition for profit and establishment charges, etc, will be agreed upon between the Accepting Officer and the Contractor prior to the execution of the work.

36. INSPECTION OF THE WORK :

BHEL Offers concerned with the Contractor shall have power at any time to inspect and examine any part of the work and the contractor shall give such facilities as may be required to given for such inspection and examination.

Should E/C/E/C consider at any time during the expiry of maintenance period, that any work has been executed with unsound, imperfect or unskilled workmanship or of quality inferior to that contracted for or not otherwise in accordance with contract [in respect whereof the decision of the sir. E/C. shall be final and conclusive] the contractor shall, on demand in writing from the Sr. E/C.E/C specifying the fault notwithstanding that the same may have been inadvertently passed, certified and paid for, forthwith rectify or remove and reconstruct the work of specified, in whole or in part as the case may be require at his own expense to the entire satisfaction of the Sr. E/C. E/C in his demand aforesaid, the Sr. E/C. may carry out the work by other means at the risk and expense in all respect of the contractor. However, the liability of the contractor under this condition shall not extend beyond the maintenance period except as regard workmanship which the Sr. E/C .E/C shall have previously given notice of to contractor to rectify.

37. RESPONSIBILITY FOR BUILDING :

In the event of any building ,or part of any building being handed over to the Contractor for the execution of work thereto under the provisions of the Contract, he shall give a written receipt for all fixtures, glass etc., and he shall be required make good at his own expense all damages resulting any cause whatsoever while in his charge and on completion of the work to deliver up the said building or part thereof a clean state complete in every particular to the entire satisfaction of the Engineer-in-charge.

38. INSURANCE OF WORKS AGAINST DAMAGE AND LOSS DUE TO FIRE, TEMPEST, FLOODS, EARTHQUAKE, RIOT AND AGAINST DAMAGE BY AIR-CRAFT.

The contractor shall, within one month after the date of acceptance of the contract, insure the work against loss and damage by fire, tempest, floods, earthquake, riots and against damage by air-craft with an insurance office approved by the Accepting Officer. Such insurance shall be effected in the name of BHEL and shall be for the full value of the contract sum. The Contractor shall lodge with the BHEL policies and receipt of the premiums for such insurance and shall maintain such policies in force until the entire completion of the work as certified by the Senior Engineer/Civil/E/C.

If the contractor fails to comply with the terms of this condition that the Accepting Officer may insure the work and may deduct the amount of premiums from any money become payable to the contractor or may at his discretion refuse payment of any advances to the Contractor until the contractor shall complied with the terms of the condition.

Such insurance whether effected by the Accepting Officer or the Contractor shall not be a limit or bar to the liability and obligation of the contractor to complete the entire work in all respects as certified by the Senior Engineer/Civil/E/C.

In case of such a loss or damage as aforesaid, the money payable under any such insurance shall be received and may be retained by the BHEL until the work is finally completed and shall then be credited to the contractor in the final statement of accounts in the event of his contract not having been previously cancelled under these conditions.

39. DAMAGE AND LOSS TO PRIVATE PROPERTY & INJURY TO WORKMAN :

The contractor shall at his own expense reinstate and make good to the satisfaction of the Sr. E/C/E/C and pay compensation for any injury, loss or damage occasioned to any property or rights whatever including property and rights of BHEL, (or Agents, servants or employees of BHEL) the injury loss or damage arising out of or in any way in-connection with the execution of purported execution of the contract and further the contractor shall indemnify BHEL against all claims enforceable against BHEL (or any agent, servant or employee of BHEL or which would b so enforceable against BHEL) where a private person , in respect of any such injury (including injury resulting in death loss or damage to any person) whosoever or property, including all claims which may arise under the workman's Compensation Act or otherwise.

40. COMPLETION:

The works shall be competed to the entire satisfaction of the Engineer-in-charge and in accordance with the Contractors forecast of Time and Progress where operative, and all unused stores and materials, tools plant, equipment, temporary buildings, and things shall be removed and the site and cleared of rubbish and all waste materials and delivered up clean and tidy to the satisfaction of the Engineer-in-charge at the Contractors expense on/or before the Scheduled date of completion.

The BHEL shall have power to take over from the Contractor from time to time such sections of the work as have been competed to the satisfaction of the Engineer-in-charge.

The Senior Engineer /Civil/E/C shall certify to the Contractor the date on which the work is completed and the state thereof.

The Senior Engineer/Civil/E/C shall also certify, to the Contractor the state of the work at the end of the maintenance period, where applicable.

41. COMPENSATION FOR DELAY:

If the contractor fails to maintain the required progress in terms of condition 7 or to complete the work and clear the site on or before the contracted or extended the period of completion, he shall, without prejudice to any other right or remedy of the BHEL on account of such breach, pay as agreed compensation an amount calculated as stipulated below or such smaller amount as may be fixed by the BHEL on the contract value of the work for every week that the progress remains below that specified in condition 7 or that the work remains incomplete.

This will also apply to items or a group of items for which separate period of completion has been specified.

For this purpose the term 'contract value' shall be the value at contract rates of the work as ordered.

- | | | |
|----|---|--------------------------|
| a) | completion period (as originally stipulated)
not exceeding 6 months. | @ 1 percent per week |
| b) | Completion period (as originally stipulated)
Exceeding 6 months and not exceeding 2 years..... | @ 1 / 2 percent per week |
| c) | Completion period (as originally stipulated)
exceeding 2 years | @ 1 / 4 percent per week |

Provided always that the total amount of compensation for delay to be paid under condition shall not exceed the under noted percentage of the contract value or of the contract value of the item of group of items of work for which a separate period of completion is given :

- | | | |
|----|---|--------------------------|
| b) | completion period (as originally stipulated)
not exceeding 6 months. | @ 10 percent per week |
| b) | Completion period (as originally stipulated)
Exceeding 6 months and not exceeding 2 years..... | @ 7 1/2 percent per week |
| c) | Completion period (as originally stipulated)
Exceeding 2 years | @ 5 percent per week |

The amount of compensation may be adjusted or set off against any sum payable to the Contractor under this or any other contract with the BHEL.

42. LAWS GOVERNING THE CONTRACT :

This contract shall be governed by the Indian Laws for the time being in force.

43. CANCELLATION OF CONTRACT FOR CORRUPT ACTS :

The Accepting Officer, whose decision shall be final and conclusive, shall, without prejudice to any other right or remedy which shall have accrued or shall accrue thereafter to Bharat Heavy Electricals Limited, cancel the contract in any of the following cases and the contractor shall be liable to make payment to BHEL for any loss or damage resulting from any such cancellation to the same extent as provided in the case of cancellation for default.

If the contract shall:

- | | |
|----|---|
| a) | Offer or give or agree to give to any person in BHEL, service any gift or consideration of any kind as an inducement or reward for doing or forbearing to do or for having done or forborne to do any act in relation to the obtaining or execution of this or any other contract for BHEL service, |
| OR | |
| b) | Enter into a contract with BHEL in connection with which commission has been paid or agreed to be paid by him or with his knowledge, unless the particulars of any such commission and the terms of payment thereof have previously been disclosed in writing to the Accepting Officer, |
| OR | |
| c) | Obtain a contract with BHEL as a result of RING tendering or by non-bonafide methods of competitive tendering without first disclosing the fact in writing to the Accepting Officer. |

44. CANCELLATION OF CONTRACT FOR INSOLVENCY, ASSIGNMENT OR TRANSFER OR SUB LETTING OF CONTRACT :

The Accepting Officer, without prejudice to any other right or remedy which shall have accrued or shall accrue thereafter to BHEL shall cancel the contract in any of the following cases:-

If the contractor:

- a) Being an individual, or if a firm any partner thereof, shall at any time be adjusted bankrupt or have a receiving order or orders for administration of his Estate made against him or shall take any proceeding, for liquidation or composition under Bankruptcy Act for the time being in force or make any conveyance or assignment of his effects of composition or arrangements for the benefit of his creditor or purport to do so, or if any application be made under any Bankruptcy Act for the time being in force for the sequestration of his estate or if a trust deed be granted by him on behalf of his creditor;

OR

- b) Being a company, shall pass a resolution or the court shall make an order for the liquidation of its affairs, or a Receiver or a Manager or behalf of the debenture holders shall be appointed or circumstances shall arise which entitle the court or debenture holders to appoint a Receiver or Manager;

OR

- c) Assigns, transfers, sub-let or attempt to assign transfer or sub-let any portion of the work without the prior return approval of the Accepting Officer.

Whenever the Accepting Officer exercise his authority to cancel the contract under this condition he may complete the work by any means at the contractor risk and expense provided always that in the event of the cost of completion (as certified by Sr. E/C/E/C which is the final and conclusive) being less than the contract cost, the advantage shall accrue to the BHEL and that if the cost of completion exceeds the moneys due to the contractor under the contract, the contractor shall either pay the excess amount ordered by Sr. E/C/E/C or the same shall be recovered from the contractor by other means.

In case of BHEL completes the work under the provisions of this condition of cost of such completion to be taken into account in determining the excess cost to be charged to the contractor under this condition shall consist of this cost of material purchased and /or labour provided by the BHEL with an addition of such percentage to cover superintendence and establishment charges as may be decided by the Sr. Manager (P) Sr. E/C/E/C whose decision shall be final and conclusive.

45. CANCELLATION OF CONTRACT IN PART OR IN FULL FOR CONTRACTORS DEFAULT :

If the contractor;

- a) Makes default in commencing the work within reasonable time form date of handing over of the site and continuous in that state after a reasonable notice from senior/Engineer /Civil E/C;

OR

- b) In the opinion of the Sr. E/C/E/C at any time, whether before or after the date or extended date for completion, make default in proceeding with the work, with due diligence and continues in that state after a reasonable notice from Sr.E/C/E/C.
- c) Fails of comply with any of terms and conditions of the contract or after reasonable notice in writing with orders properly issued there under :
- d) Fails to complete the work, work order and items of work with individual dates for completion and clear the site on or before the date of completion, or fails to achieve the progress as set out under clause 7 of these General Conditions of Contract.

The Accepting Officer may, without prejudice to any other rights or remedies which shall have accrued or shall accrue thereafter to BHEL cancel the contract as a whole or in part thereof or only such work order or items of work in default from the contract. Whenever the Accepting Officer exercises his authority to cancel the contract as a whole or in part under this condition he may complete the work at the contractor risk and cost, provided always that in the events of the cost of completion (has certified by Sr. E/C/E/C which is final and conclusive) being less than the contract cost, the advantage shall accrue to the BHEL if the cost of the excess amount ordered by Sr. M.P./Sr. E/C/E/C or the same shall be received from the contractor by other means.

In case of BHEL completes the work or any part thereof under the provisions of this condition the cost of such completion to be taken into account in determining the excess cost to be charged to the contractor under this condition shall consist of the cost of the material purchased and /or labour provided by the BHEL with an addition of such percentage to cover superintendence and establishment charges as may be decided by the Sr. M.P. /Sr. E/C/E/C. whose decision shall be final and conclusive.

46. TERMINATION OF CONTRACT OF DEATH :

Without prejudice to any of the rights or remedies under this contract, if the contractor dies, Accepting Officer shall have the opinion of terminating the contract without compensation to the contractor.

47. SPECIAL POWER OF DETERMINATION:

If at any time after the Acceptance of the tender, BHEL shall for any reason whatsoever not required the whole or any part of the work, to be carried out, the Sr. M.P./Sr. E/C/E/C shall give notice in writing of the fact to the contractor who shall have no claim to any payment of compensation or otherwise howsoever on account of any profit or advantage which he might have derived from the execution of the work in full but which he did not derive in consequence of the force closing of the work.

He shall be paid at Contact rate, for the full amount of the work executed including such additional works, e.g. clearing of site, etc., as may be rendered necessary by the said fore-closing. He shall also be allowed reasonable payment (as decided by the Accepting Officer) for any expenses sustained on account of labour and materials collected but which could not be utilised on the work, as verified the Sr. E/C Neither shall the contractor has any claim for compensation on account of any alterations having been made in the original specifications drawings, designs and instructions, involving any curtailment of the work as originally contemplated.

48. FAIR WAGE :

- a) The Contractor shall pay not less than the 'Fair Wage' to labourers engaged by him on the work. 'Fair Wage' means wage whether for time or piece work notified at the time of inviting tenders for the work and where such wages have not been notified, the wages prescribed by the Sr. Manager/Projects/Sr.E/C/E/C for the stations at which the work is done.
- b) The contractor shall, notwithstanding the provision of any contract to the contrary, cause to be paid a 'Fair Wage' to labourers indirectly engaged on the work, including any labour engaged by his sub-contractors in connection with the said wok, as if the labourers had been directly employed by him.
- c) In respect of all labours directly or indirectly employed on the work for the performance of the contractors part of this Agreement, the contractor shall comply with or cause to be complied with the BHEL contractor's labour Regulations (appended hereto as Annexure 'A' to these conditions) in regard to payment of wages, wage period, deductions from wages, recovery of wages, not paid and deductions, unauthorisedly made, maintenance of wage book, wage slips, publication of scale of wages and other terms of employment, inspection and submission of periodical returns and all other matters of a like nature.

- d) The Senior Engineer /Civil/E/C concerned shall have the right to deduct from the moneys due to the Contractor any sum required or estimated to be required for making good the loss suffered by a worker or workers by reason of non-fulfillment of the condition of the contract for the benefit of the workers, non-payment of wages or of deductions made from this or their wages which are not justified by the terms of the contract or non-observance of the regulations.
- e) Vis-à-vis BHEL the Contractor shall be liable primarily for all payments to be made under the contract and for the observances of the Regulations aforesaid without prejudice to his right to claim indemnity from his sub-contractor's.
- f) The regulations aforesaid shall be deemed to be a part of this contract and any breach thereof shall be deemed to be a breach of this contract.

CHAPTER-IV

VALUATION AND PAYMENT**49. RECORDS AND MEASUREMENTS :**

All items having a financial value shall be entered in the BHEL Measurement Book so that a complete record is obtained of all works performed under the contract.

Building etc. priced in schedule 'A' as a unit lump-sum will be entered by number at the unit lump-sum.

Work carried out for agreed lump-sums will be described and similarly recorded.

Lump-sum omissions will be entered for deduction. Measurement shall be restricted to that required to ascertain the financial liability of BHEL under the contract.

Work which fails to be measured in detail shall be measured physically, without reference to any local custom that may obtain excepting where it may otherwise be directed in the tender documents. The measurements shall be taken jointly by any person duly authorised on the part of the BHEL and by the contractor. The Engineer-in-charge shall give reasonable notice in writing to the Contractor of appointment for measurement.

The contractor shall, without extra charge, provide assistance with appliances and other things necessary for measurement.

The Contractor shall bear all the cost of measurement of his work.

Measurement shall be entered in the BHEL Measurement book and signed and dated by both parties each day at the site on completion of measurement. If the contractor objects to any of the measurement recorded on behalf of the BHEL a note that effect will be made in the BHEL measurement book or against the item or items objected to; and such note shall be signed and dated by both the parties engaged in taking the measurement.

If, as a result of such objection, it becomes necessary to re-measure the work wholly or in part, the expense of such re-measurement shall be borne by the party requiring the measurement to be re-taken provided that a net error is found by this re-measurement to amount to less than 5% (five percent) of the value as recorded by the first measurement. But, where the net errors amount to 5% and over of the said value, then the cost is to be borne by the other party. If any case, of the net value of errors found exceeds Rs. 500/- the expense of re-measurement is to be borne by the other party.

If the Contractor's representative fails to attend when required, the Engineer-in-charge shall have power to proceed by himself to take measurements and in that case these measurements shall be accepted by the Contractor as final.

The contractor shall, once every month submit to the Senior Engineer/Civil/E/C with a copy to the Sr. M/P/details of his claims for the work done by him up to and including the previous months which are not covered by his contract Agreement in any of the following respects.

- a) Deviation from the items and Specifications provided in the contract documents.
- b) Extra items/New items of work.
- c) Quantities in excess of those provided in the contract schedule.
- d) Items in respect of which rates have not been settled. He should, in addition, furnish a clear certificate to the effect that the claims submitted by him as aforesaid cover all his claims and that no further claims shall be raised by him in respect of the work done upto and including the period under report.

50. VALUATION OF DEVIATIONS :

Rate for deviated items of work will be fixed as follows:

- I.** For any item of work required to be carried out after the contract has been awarded and which is not covered by Contractor's Schedule but is covered by K.P.W.D. schedule of rates the rate payable for such a fresh item will be derived from K.P.W.D. Schedule by the method of proportion as follows:
 - a) IN the same proportion to the rate in K.P.W.D. Schedule of Rates as the tendered rate for the nearest analogous items of work in Contractor's Schedule bears to the rate for the particular analogous item or work in K.P.W.D. schedule of Rates.
 - b) If a single appropriate analogous item of work is not available in both Contractor's and K.P.W.D. Schedule then the method of proportion will be applied to the nearest analogous group of items available in both the Schedules referred i.e. in the same proportion as the total tendered cost of that particular group of items (the sum of the products of the tendered rates and the quantities for which orders are placed) bears to the total cost of the same items and quantities at the K.P.W.D. Schedule of Rates.
 - c) If even an appropriate analogous group of items is not available in Contractor's Schedule and K.P.W.D. Schedule, then the methods of proportion will be applied to all those items of the whole work, which are available in both the Schedules and for which orders have been placed on the Contractor, i.e., In the same proportion as the total cost of all these items of work (the sum of the products of the tendered rates and the quantities for which orders are placed) bears to the total cost of the same items and quantities at the K.P.W.D. Schedule of Rates.
- II.** If any work not covered by any of the foregoing is ordered on the Contractor, the basis of payment shall be decided by the Accepting Officer whose decision shall be final and conclusive and binding on the parties.

The selection of analogous item or analogue group of items referred to above shall be done by the Sr. E/C./E/C. Where the rates for deviated items or new items of work can be derived by the selection of different analogous items or analogous group of items, the lowest of all such derived rates shall be taken as the correct rate.

In the case of the contracts for which the Sr. E/C./E/C is the Accepting Officer, all disputes regarding the settlement of rates of deviated or new items of work shall go to the Sr. M/P. whose decision shall be final and conclusive.

51. REIMBURSEMENT/REFUND ON VARIATION IN PRICE, MATERIALS :

In after submission of the tender and/or during the progress of the works, the price of any materials (not being a material supplied from the BHEL, stores in accordance with the Conditions of the Contract) is increased or decreased by an Act of Legislature (Central or state) and /or any notification there under or on account of new duties or levies such as Octroi or on account of increase or decrease in such duties affecting the price of materials required for incorporation in the works or the price of any item to be incorporated in the works and made from materials of which the price has increased or decreased as aforesaid and the Contractor has thereupon to pay in respect of such material or item a price which is higher or lower than the price of that material or item as prevailing immediately before the passing of such Act or levying, increasing/decreasing of such duty, the BHEL., shall in case of increase in price or the duty reimburse the Contractor the increase in price or additional increased duty paid by the Contractor and in case of decrease I price, the BHEL shall be entitled to a refund of the reduction in duty. Provide however no reimbursement or refund shall be made if the increase /decrease is not more than plus 10% of the said price, the reimbursement or refund shall be made only on the excess over 10% provided always that any such increase shall not payable if, in the opinion of the Sr. M/P whose decision shall be final and conclusive the increase is attributable to the delay in the execution of the contract within the control of the Contract, or that any such increase has become operative after the contracted/or extended date completion of the work or items of work in question.

The Contractor shall, for the propose of this condition, keep such books of account and other document as are necessary to show the account of any increase claimed or any reduction available and shall allow inspection of the same by any duly authorised representative of the BHEL and further shall at the request of the Sr, E/C/E/C. furnish for verification such other information of the Sr. E/C/E/C may require.

The contractor shall within a reasonable time of his becoming aware of any alteration in the prices of any such materials, give notice thereof in writing to the Sr. E/C.E/C stating that the rate is submitted in pursuance to this condition together with all information relating thereto which he may be in a position to supply.

52. ADVANCES ON ACCOUNT :

No payment shall be made for work estimated to cost less than Rupees One Thousand till after the whole of the work shall have been completed and a certificate of completion given by the Competent authority.

In the case of work estimated to cost more than Rupees One Thousand the contractor may at intervals of not less than one month or as otherwise provided for in the Contract documents, counting from the date on which order to the commence work given by Sr. E/C.E/C submit claims on BHEL forms for payment of advance on account of work done and of materials delivered in connection with the Contract.

The Contractor shall be paid in respect of such claims to the extent approved and passed by the Sr. E/C.E/C subject a maximum of 90% o the value of the work actually executed in site provided the work has been executed to the satisfaction of the Engineer-in-charge. The certificate of the Sr. E/C. E/C regarding such approval and passing of the sums so payable shall be final and conclusive against the Contractor.

“After the full amount of Security Deposit is made up through the 10% deductions from ‘On Account’ bills, 100% of all subsequent bills may be made to the Contractor”.

The Contractor may also be paid during the progress of the work 75% of the value of any materials which are in the opinion of the Engineer-in-charge in accordance with contract, and are actually required for incorporation in the work and which have reasonably been brought to the site in-connection therewith and are adequate stored an/or protected against damage by weather or other causes, but which have not at the time of payment of the advance been incorporated in the work. Payment of such advances however shall be purely at the discretion of the Sr. M/P/Sr.E/C./E/C provided always that payments shall not be made under these periodical certificates in respect of perishable materials like lime, cement, timber, sand kankar etc.

Any sums/due from the Contractor on account of tools and plant, stores or any other items provided by BHEL shall be deducted from the respective advances.

The Senior Engineer/Civil/E/C shall from time to time certify the sums payable to the Contractor after retaining the reserves.

Any certificate relating to work done or materials delivered may be modified or corrected by any subsequent interim certificate or by the final certificate and no certificate of the Sr. E/C/E/C supporting an advance payment shall itself be conclusive evidence that any work or materials to which it relates are in accordance with the contract. All such intermediate payments shall be regarded as advances against the final payment only and shall not be considered as an admission of the due performance of the contract or any part thereof in respect or the accruing of any claim whatsoever. Such intermediate payments shall not conclude, determine or effect in any way the powers of the Sr. E/C/E/C as to the final settlement and adjustment of the account or otherwise, or in any way vary or affect the Contract.

53. FINAL BILL :

As soon as possible after the completion of the work to the satisfaction of the Engineer-in-charge, the contractor shall forward a certified final account on BHEL forms, in duplicate. It shall be accompanied by all abstracts, vouchers etc., in support thereof and shall be prepared in the manner prescribed by the Senior Engineer /Civil/E/C. No claim will be entertained after the receipt of the final bill.

The contractor shall be entitled to be paid the final sum less the value of payments already made on account, subject to certification of the final bill by the Sr. E/C/E/C any sums due from the contractor on account Tools and plant, Stores or any other items provided by BHEL not yet recovered from the contractor shall be deducted from the final sum aforesaid.

No charge shall be allowed to the contractor on account of the preparation of the final bill.

54. PAYMENT OF BILLS :

All payments to be made to the Contractor under this contract shall be by "Crossed Cheque" marked "A/C payee only" (within a reasonable time after the certification by the Sr. E/C/E/C at the.....
.....located in the station where either the work is executed or service rendered or at their branch nearest to the station where the Office of the Senior Engineer/Civil/E/C is located.)

55. RECOVERY FROM CONTRACTOR :

Whenever under the contract any sum of money shall be recoverable from or payable by the contractor the same may be deducted from any sum then due or which at any time thereafter may become due to the contractor under the contract or under any other contract with BHEL of from his Security Deposit or he shall pay the claim on demand.

56. POST TECHNICAL AUDIT OF WORK AND BILLS :

BHEL reserve the right to carry out a post-payment audit and technical examination of the work and final bill including all supporting vouchers, abstract etc., and to enforce recovery of any sums becoming due as a result thereof in the manner provided in the proceeding sub-paragraph's provided however that no such recovery shall be enforced after three years of passing the final bill.

57. REFUND OF SECURITY DEPOSIT :

50% of the Security Deposit mentioned in condition 16 above, may be refunded to the contractor in respect all contract on completion of work and after payment of final bill and the balance 50% on expiry of the maintenance period, (Described under clause 23) provided the contractor shall have rendered a "No Demand Certificate." In case of works where maintenance period is not involved 100% of the security deposit may be refunded after payment of final bill provided that the contractor shall have rendered a "No Demand Certificate."

58. ARBITRATION :

Except where otherwise provided for in the contract all question and disputes relating to the meaning of the specifications, design, drawings and instructions herein before mentioned and as to the quality of workmanship or materials used on the work or has been other questions, claim, right, matter or thing whatsoever in any way arising out of or relating to the contract, design, drawing, specification, estimate, instruction, orders or these conditions or otherwise concerning the works of the execution of failure to execute the same whether arising during the program of the work or after the completion or abandonment thereof shall be referred to the sole arbitration of the Managing Director/Chief Engineer of BHEL and if the Managing Director/Chief Engineer is unable or unwilling to Act, to a sole arbitration of some other person appointed by the Managing Director/General Manager/Chief Engineer, willing to Act s such arbitrator. The cases referred to arbitration shall be other than those for which the decision of the Sr. M/P./D.C.E/Sr.E/C. is expressed in the contract to be final and conclusive. There will be no objection if the arbitrator so appointed is an employee of BHEL and that he had deal with the matters to which the contracts relates and that in the course of his duties such he had expressed views of on all or any of the matters in dispute or difference. The arbitrator to whom to matter is originally referred being transferred by vacating his office or being unable to act for any reason, such Managing Director/ General Manager/Chief Engineer as aforesaid at the time of such transfer, vacation of office or inability to act, shall account another person to act as arbitrator in accordance with the terms of the contract, such person shall be entitled to proceed with the reference from the state at which it was left by his predecessor.

Subject as aforesaid the provision of the Arbitration Act, 1940 or any statutory modification or re-enactment thereof and the rules made there under and for the time being in force shall apply to the arbitration proceeding under this clause.

It is a term of contract that the party involving arbitration shall specify the dispute or disputes to be referred to arbitration under this clause together with the amount or amounts claimed in respect of each such dispute.

The arbitrator (s) may from time to time with consent of the parties enlarge the time, for making and publishing the awards.

The work under the contract shall, if reasonable possible, continue during the arbitration proceedings and no payment due to payable to the contractor shall be withheld on account of such proceedings.

The Arbitrator shall be deemed to have entered on the reference on the date he issue notice to both the parties fixing the date of the first hearing.

The Arbitrator shall give a separate award in respect of each dispute or difference referred to him.

The venue of arbitration shall be such place as may be fixed by the arbitration in his sole discretion.

The award of the arbitrator shall be final, conclusive and binding all parties to this contract.

ANNEXURE- 'A'

BHEL CONTRACTOR'S LABOUR REGULATIONS.

(See condition 20)

1. DEFINITION:

In these regulations, unless otherwise expressed or indicated, the following words and expressions shall have the meaning hereby assigned to them.

- a) "Labour" means workers employed by a contractor directly or indirectly through a sub-contractor, or by an agent on his behalf on a payment not exceeding Rs. 500/- per month.
- b) "Fair Wage" means wages, which shall include wages for weekly day of rest and other allowances, whether for time or piece work, after taking in to consideration prevailing market rates for similar employment in the neighborhood but shall not be less than the minimum rates of wages fixed under the Minimum wages Act.
- c) "Contractor" for the purpose of these Regulations shall include on agent or sub-contractor employing labour on the wok taken on contractor.
- d) "Inspecting Officer" means any Labour Enforcement Officer or Assistant Labour Commissioner of the Chief Labour Commissioner's organisation.
- e) "Form" means a form appended to these Regulations.

2. NOTICE OF COMMENCEMENT:

The contractor shall, within seven days of commencement of the work, furnish in writing to the Inspecting Officer of the area concerned the following information, with copy to the Engineer- in charge.

- a) Name and situation of the work.
 - b) Contractor's name and address.
 - c) Particulars of the Department for which the work is undertaken.
 - d) Name and address of the sub-contractors as and when they are pointed.
 - e) Commencement and probable duration of the work.
 - f) Number of workers employed and likely to be employed.
 - g) 'Fair Wages' for different categories of workers.
3. I) Number of hours which shall constitute a normal working day. The number of hours which shall constitute a normal working day for an adult shall be NINE hours. The working day of an adult worker shall be so arranged that of intervals, if any for rest it shall not spread over more than 12 hours on any day, when an adult worker is made to work for more than NINE hours on any day or for more than 48 hours in any week he shall in respect of overtime work, be paid wages at double the ordinary rate of wages.

II) Weekly day of rest: Every worker shall be given a weekly day of rest, which shall

be fixed and notified at least 10 days in advance. A worker shall not be required or allowed to work on the weekly rest day unless he has or will have a substitution rest day, on one of the five days immediately before or after the rest day, provided that no substitution shall be made which will result in the worker working for more than 10 days consecutively without a rest day for a whole day.

Where in accordance with the foregoing provisions a worker works on the rest day and has been given a substituted rest day he shall be paid wages for the work done on the weekly rest day at the overtime rate of wages.

NOTE: The expression 'Ordinary rate of wages' means the fair wage the worker is entitled to.

4. DISPLAY OF NOTICE REGARDING WAGES, WEEKLY DAY OFF REST ETC.

The Contractor shall before he commences his work on contract display and correctly maintain and continue to display and correctly maintain in a clean legible condition in conspicuous places on the works, notice in English and in the local Indian languages, spoken by majority of workers, giving the rate of fair wages, the hours of work for which such wages are payable, the weekly rest days workers are entitled to and name and address of the Inspecting Officer. The Contractor shall send a copy of each of such notice to the Inspecting Officers and the Engineer's in charge.

5. FIXATION OF WAGE PEIODS:

The contractor shall fix wage periods in respect of which wages shall be payable. No wage period shall normally exceed one work.

6. PAYMENT OF WAGES:

- i) Wages due to every worker shall be paid to him direct. All wages shall be paid in current coins or currency or in both.
- ii) Wages of every worker employed on the contractor shall be paid where the wages period is one week, within three days from the end of the wage period, and in any other case before the expiry of the 7th day or 10th day from the end of the wage period according as the number of workers does not exceed 1,000 in exceeds 1000.
- iii) When employment of any worker is terminated by or on behalf of the contractor, the wages earned by him shall be paid before expiry of the day succeeding the one on which his employment is terminated.
- iv) Payment of wages shall be made at the work site on a working day except when the work is completed before expiry of the wage period, in which case final payment shall be made at the work site within 48 hours of the wage period, in which case final payment shall be made at the work site within 48 hours of the last working day and during normal working time.

Note:

The term "working day" means a day on which the work, on which labour is employed, is in progress.

7. REGISTER OF WORKMEN:

A register of workmen shall be maintained in the form appended to these regulations and kept at the work site or as near to it as possible, and the relevant particulars of every work men shall be entered therein within 3 days of his employment.

8. EMPLOYMENT CARD:

The contractor shall issue an employment card in the form appended to these regulations to each worker on the day of work or entry into his employment. If a worker has already any such card with him issued by the previous employer the contractor shall merely endorse that employment card with relevant entries. On termination of employment the employment card shall again be endorsed by the contractor and returned to the worker.

9. REGISTER OF WAGES ETC:

- i) A register of wages- cum-muster roll in the form appended to these regulations shall be maintained and kept at the work site or as near to it as possible.
- ii) A wage slip in the form appended to these regulations shall be issued to every worker employed by the contractor at least a day prior to disbursement of wages.

10. FINES AND DEDUCTIONS WHICH MAY BE MADE FROM WAGES:

- i) Wages of worker shall be paid to him without any deductions of any kind except the following:
 - a) Fines.
 - b) Deductions for absence from duty, i.e. from the place or the places where by the terms office employment is required to work. The amount of deduction shall be in proportion to the period for which he was absent.
 - c) Deduction for damage to or loss of goods expressly entrusted to the employed person for custody, or for less of money which he is required to account for, where such damage or loss is directly attributable to his neglect or default ;
 - d) Deduction for recovery of advances or for adjustment of over payment of wages. Advances granted shall be entered in a register ; and
 - e) Any other deduction which the BHEL may from time to time allow.
- ii) No fines shall be imposed on a worker save in respect of such acts and omissions on his part as have been approved by the chief Labour Commissioner.
- iii) No fines shall be imposed on a worker and no deductions for damage for loss shall be made from his wages until the worker has been given an opportunity of showing – cause against such fines or deductions.
- iv) The total amount of fines which may be imposed in any one wage period on a worker shall not exceed an amount equal to three Paise in rupee of the wages payable to him in respect of that wage period.
- v) No fine imposed on a worker shall be recovered from him in installments, or after expiry of sixty days from the date on which it was imposed. Every fine shall be deemed to have been imposed on the day of the act or omission in respect which it was imposed.
- vi) The contractor shall maintain both in English and the local Indian language a list, approved by the Chief labour Commissioner, clearly stating the acts and omissions for which penalty or fine may be imposed on a workman and display it in good condition a conspicuous place on the work site.
- vii) The contractor shall maintain a register of deductions for damage or loss in the forms appended to these regulations which should be kept at the place of work.
 - a) Full particulars of the labourers who met with the accident.
 - b) Sex.
 - c) Age.
 - d) Rates of wages.
 - e) Nature of accident and cause of accident.
 - f) Time and date of accident.
 - g) Date and time when admitted in hospital.
 - h) Date of discharge from the hospital.
 - i) Period of treatment and result of treatment.
 - j) Percentage of loss of earning capacity and disability as assessed by Medical officer.
 - k) Claim required to be paid under Workmen Compensation Act.

- l) Date of payment of compensation.
- m) Amount paid with details of the person to whom the same was paid.
- n) Authority by whom the compensation was assessed.
- o) Remarks.

11. REGISTER OF ACCIDENTS:

The contractor shall maintain a register of accidents in such form as may be convenient at the work place but the same shall include the following particulars :-

12. PRESERVATION OF REGISTERS:

The register of workmen and the Register of wages-Cum-Muster Roll required to be maintained under these Regulations shall be preserved for 3 years after the date on which the last entry is made therein.

13. ENFORCEMENT:

The Inspecting Officer shall either on his own motion or on a complaint received by him carry out investigations and send a report to the Engineer-in-charge specifying the amount representing / workers dues and amount of penalty to be imposed on the contractor for breach of these regulations, that have to be recovered from the contractor, indicating full details of the recoveries proposed and the reasons, there for. It shall be obligatory of the part of the Engineer-in-charge on receipt of such a report to deduct such amounts from payments due to the contractor.

14. DISPOSAL OF AMOUNTS RECOVERED FROM THE CONTRACTORS:

The engineer in charge shall arrange payment to workers concerned within 45 days from receipt of a report from the Inspecting Officer except in cases where the contractor had made an appeal under regulation, 16 of these regulations. In cases where there is an appeal, payment of worker dues would be arranged by the Engineer in charge, wherever such payments arise, within 30 days from the date of receipt of the decision of the Regional Labour Commissioner (RLC).

15. WELFARE FUND:

All moneys that are recovered by the Engineer-in-charge by way of workers due which could not be disbursed to workers within the time-limit prescribed above, due to reasons such as where about or workers not being known, death of a worker, etc., and also amounts recovered as penalty, shall be credited a fund to be kept under the custody or BHEL for such benefits and welfare of work man employed by the contractors.

16. APPEAL AGAINST DECISION OF INSPECTING OFFICER:

Any person aggrieved by a decision of the Inspecting Officer may appeal against such decision to the Regional Labour Commissioner concerned within 30 days from the date of decision, forwarding simultaneously a copy of his appeal to the Engineer-in-charge. The decision of the Regional Labour Commissioner Shall be final and binding upon the contractor and the work men.

17. REPRESENTATION OF PARTIES:

- i) A workmen shall be entitled to be represented in any investigation or enquiry under these Regulations by an officer of a registered trade union of which the said trade union is affiliated or where the work man is not a member of any registered trade union, by an officer of a registered trade union, connected with, or any other workmen employed in, the industry in which the worker is employed.

- ii) A contractor shall be entitled to be represented in any investigation of enquiry under these Regulation by an officer of an association of contractors of which he is member or by an officer of a Federation of associations of contractors to which the said association is affiliated or where the contractor is not a member of any association of employers, connected with, or by any other employer engaged in the industry in which the contractor is engaged.
- iii) No party shall be entitled to be represented by a legal practitioner in any investigation or enquiry under these Regulations.

18. INSPECTION OF BOOKS AND OTHER DOCUMENTS:

The contractor shall allow Inspection of the registers and other documents prescribed under these regulations by inspecting officers and the Engineer-in-charge or his authorized representative at any time and by the worker or his agent on receipt of due notice at convenient time.

19. INTERPRETATION ETC:

On any question as to the application, interpretation or effect of these Regulations, the decision of the Chief Labour Commissioner or Deputy Chief Labour Commissioner (Central) shall be final and binding.

20. AMENDMENTS:

Central Government may, some time to time, add to or amend the Contractors Labour Regulations and issue such directions as it may consider necessary for the proper implementation of the Contractors Labour Regulations for the purpose of removing any difficulty which may arise in the administration thereof, based on which the BHEL Contractors Labour Regulation here in contained shall be subject to revision.

BHEL SAFETY CODE (See condition 20)

- i) Suitable scaffolds shall be provided for workmen for all work that cannot safely be done from the ground, or from solid construction except such short period work as can be done safely from ladders. When a ladder is used one extra mazdoor shall be engaged for holding the ladder and if the ladder is used for carrying materials as well, suitable footholds and handholds shall be provided on the ladder and the ladder shall be given an inclination not steeper than $\frac{1}{4}$ to 1 (1/4 horizontal and 1 vertical).
- ii) Scaffolding or staging more than 3.25 meters above the ground or floor, swing or suspended from an overhead support or erected with stationery support, shall have a guard rail properly attached, bolted, braced and otherwise secured at least 1 meter high above the floor or platform of such scaffolding or staging and extending along with the entire length of the outside and ends thereof with only such openings as may be necessary for the delivery or materials, such scaffolding or staging shall be so fastened as to prevent it from swaying from the building or structure.
- iii) Working platform, gangways and stairways shall be so constructed that they do not sag unduly or unequally, and if height of a platform or gangway or stairway is more than 3.25 meters above ground level it shall be closely boarded, have adequate width and be suitably fenced, as described in 2 above.
- iv) Every opening in floor of a building or in a working platform shall be provided with suitable means to prevent fall of persons or materials by providing suitable fencing or failing with a minimum height of 1 meter.
- v) Safe means of access shall be provided to all working platform and other working places, every ladder shall be securely fixed. No portable single ladder shall be over 9 meters in length. Width between side rails in a rung ladder shall in no case be less than 30cm. For ladders up to and including 3 meters in length. Uniform step spacing shall not exceed 30 cm.

Adequate precautions shall be taken to prevent danger from electrical equipment. No materials on any of the sites shall be so stacked or placed as to cause danger or inconvenience to any person or the public. The contractor shall provide all necessary fencing and lights to protect public from accidents and shall be bound to bear expenses of defense of every suit action or other proceedings at law that may be brought by any person for injury sustaining owing to every suit action or other proceedings at law that may be brought by any person for injury sustaining owing to neglect of the above precautions, and pay any damages and costs which may be awarded in any such suit, action or proceedings to any such person or which may with the consent of the contractor be paid to compromise any claim by any such person.

6. EXCAVATION AND TRENCHING:

All trenches, 1.5 meters or more in depth, shall at all times be supplied with at least one ladder for each 30 m length or fraction thereof. Ladder shall to be extended from bottom of trench to at least, 1 meter above surface of the ground. Sides of a trench 1.5 meters or more in depth shall be stepped back to give suitable slope, or securely held by timber bracing, so as to avoid the danger of sides collapsing. Excavated materials shall not be placed within 1.5 meters of the edge of trench or half the depth of trench, whichever is more. Cutting shall be done from top to bottom. Under no circumstances shall undermining or undercutting be done.

7. DEMOLITION:

Before any demolition work is commenced and also during the process of the work.

- a) All roads and open areas adjacent to the work site shall either be enclosed or suitably protected;
 - b) No electric cable or apparatus which is liable to be source of danger over a cable or apparatus used by operator shall remain electrically charged.
 - c) All present steps shall be taken to prevent danger to persons employed, from risk or fire or explosion or No floor, roof or other part of a building shall be so overloaded with debris or materials as to render it unsafe.
- 8.** All necessary personal safety equipment as considered adequate by the Engineer-in-charge shall be available for use of persons employed on the site and maintained in a condition suitable for immediate use and the contractor shall take adequate steps to ensure proper use of equipment by those concerned.
- a) Workers employed on mixing asphaltic materials cement and lime mortars/concrete shall be provided with protective footwear and protective goggles.
 - b) Those engaged in handling any materials which is injurious to the eye shall be provided with protective goggles.
 - c) Those engaged in welding works shall be provided with welder's protective eye shields.
 - d) Store breaker shall be provided with protective goggles and protective clothing and seated at sufficiently safe intervals.
 - e) When workers are employed in sewer and manholes which are in use, the contractor shall ensure that manholes covers are opened and manholes are ventilated at least for an hour before workers are allowed to get in to them. Manholes so opened shall be cordoned off with suitable railing and provided with warning signals or boards to prevent accident to public.
 - f) The contractor shall not employ men below the age of 18 and women on the work of painting with products containing lead in any form. Wherever men above the age of 18 or employed on the work of lead painting the following precautions shall be taken.
 - i) No paint containing lead or lead products shall be used except in the form of paste or readymade paint.
 - ii) Suitable face masks shall be supplied by the contractor for use by workers when paint is applied in the form of spray or a surface having lead paint is dry rubbed and scrapped.
 - iii) Overalls shall be supplied by the Contractor to workmen and adequate facilities shall be provided to enable working painters to wash during and cessation of work.

9. When work is done near any where there is risk of drowning, all necessary equipment shall be provided and kept ready for use and all necessary steps taken for prompt rescue of any person in danger and adequate provision made for prompt first aid treatment of all injuries likely to be sustained during the course of the work.
10. Use of hoisting machine and tackles including their attachments, encourage and supports shall conform to the following:
 - a)
 - i) These shall be of good mechanical construction, sound material an adequate strength and free from defects and adequate strength, and free from defects.
 - ii) Every rope used in hoisting or lowering materials or as a means of suspension shall be durable quality and adequate strength, and free from defects.
 - b) Every crane driver or hoisting appliance operator shall be properly qualified and no person under the age of 21 years shall be in-charge of any hoisting machine including any scaffolding winch or give signals to operator.
 - c) In case of every hoisting machine and of every chain, ring, hook, shackle, swivel and pulley block used in hoisting, or lowering or as means of suspension safe working load shall be ascertained by adequate means. Every hoisting machine and all gear referred to above shall have the safe working load plainly marked thereon. In case of a hoisting machine having a variable safe working load, each safe working load, and the conditions under which it is applicable shall be clearly indicated. No part of any machine or any gear referred to above in this paragraph shall be loaded beyond the safe working load except for the purpose of testing.
 - d) In case of departmental machine, safe working load shall be notified by the Engineer-in-charge. As regards contractors machines the contractor shall notify safe working load of each machine to the Engineer-in-charge wherever he brings it to site of work and get it verified by the Engineer-in-charge.
11. Motors gearing, transmission, electric wiring and other dangerous parts of hoisting appliances shall be provided with efficient safeguards, hoisting appliances shall be provided with such means as will reduce to the minimum risk of accidental descent of load. Adequate precautions shall be taken to reduce to the minimum risk of any part of a suspended load becoming accidentally displaced. When workers are employed on electrical installations which are already energised, insulating mats, working apparel such as gloves, sleeves, and boots, as may be necessary shall be provided. Workers shall not wear any rings; watches carry keys or other materials which are good conductors of electrically.
12. All scaffolding, ladders and other safety devices mentioned or described herein shall be maintained in a safe condition and no scaffold, ladder or equipment shall be altered or removed while it is in use. Adequate washing facilities shall be provided at or near the places of work.
13. These safety provisions shall be brought to the notice of all concerned by display on a notice board at a prominent place at the work spot. Persons responsible for ensuring compliance with the safety code shall be named there on by the contractor.
14. To ensure effective enforcement of the rules and regulations relating to safety precautions, arrangements made by the contractor shall be open to inspection by the Engineer-in-charge or his representative and the inspection officers as defined in the contractor's Labour Regulations.
15. Notwithstanding the above conditions 1 to 14, the Contractor is not exempted from the operation of any other Act or Rule in force.

**FORM OF EMPLOYMENT CARD
(Regulation 8)**

- (i) Name and sex of the worker:.....
- (ii) Father's/Husband's Name:.....
- (iii) Address:.....
- (iv) Age or date of birth:.....
- (v) Identification marks:.....

Particulars of next of kin (wife/husband and children, if any, or/dependent next of kin in case of the worker has no wife/husband or child):

Name:.....
 Full address of dependents:.....
 (Specify village, Dist., and State):.....

Sl. No.	Name and address of Employer (specify whether a contractor or a sub-contractor).	Particulars of location of work site and description of work done	Total period for which the worker is employed (From : To:)	Actual Number of days worked	Leave taken (No. of days should be specified)	Nature of work done by the worker	Wage rate with particulars of office of unit in case piece	Total wages earned by the worker during the period shown under Col.5	Remarks	Signature of the employer
1	2	3	4	5	6	7	8	9	10	11

N.B: For the worker employed at one time one piece-work basis and at another on daily wages, relevant entries in respect of each type of employment should be made separately.

**FORM OF WAGE SLIP
(REGULATION 9)**

(i) Name of the contractor.....

(ii) Place.....

-
1. Name of the workers with father's/husband's Name :
 2. Nature of employment :
 3. Wage period :
 4. Rate of wages payable :
 5. Total attendance/unit of Work done :
 6. Dates on which overtime worked. :
 7. Overtime wages. :
 8. Gross Wages, payable :
 9. Total deductions (indicating nature of deduction).
 10. Net Wages Payable :

CONTRACTOR'S SIGNATURE/
THUMB IMPRESSION.

EMPLOYEES SIGNATURE/
THUMB IMPRESSION.

**FORM OF REGISTER OF
DEDUCTIONS FOR DAMAGE OR LOSS CAUSED TO THE BHEL BY
THE NEGLECT OR DEFAULT OF THE EMPLOYED PERSONS.
(Regulation No. 10 (vii).**

Sl.No.	Name	Father's/ Husband's Name.	Sex	Dept.	Damage or loss caused with date	Whether worker showed cause against deduction if so, enter date.	Date and amount of deduction imposed.	Number of in statement if any	Date on which total amount realised	Remarks.
1	2	3	4	5	6	7	8	9	10	11

FORM OF REGISTER OF FINES (REGULATIONS No. 10 (VII))

Sl.No.	Name	Father's/ Husband's Name.	Sex.	Dept.	Nature and date of the offence for which fine imposed	Whether workman showed cause against fine or not, enter date.	Date of wages.	Date and amount of fine imposed.	Date on which fine released.	Remarks.
1	2	3	4	5	6	7	8	9	10	11