



## ANEXURE – III

### Item 2: Drawing for Low Cycle Fatigue (LCF) Test M12 Sample:

The sample should meet the following requirements:

- 1) Surface finish: less than 200 micron (Figure 2)
- 2) Dimensional accuracy: as per the drawing (Figure 2)
- 3) Circular run-out: as per the drawing (Figure 2)
- 4) Perpendicularity: as per the drawing (Figure 2)
- 5) There should no hole on the both end faces

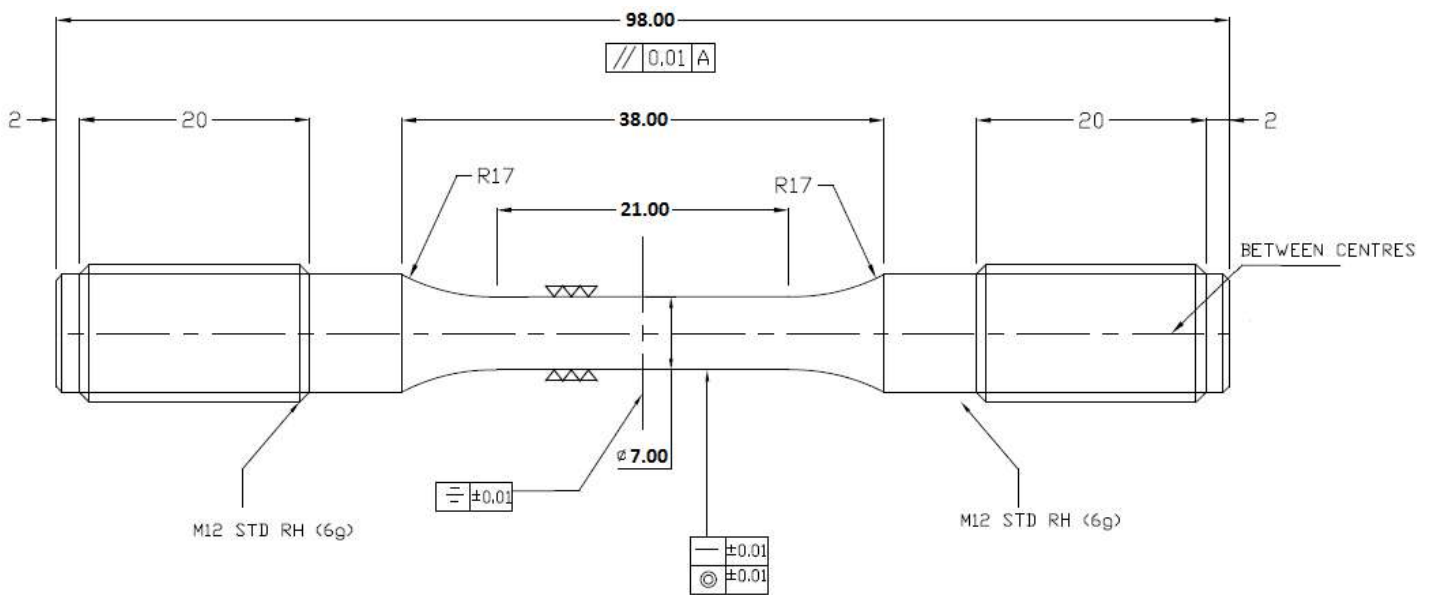

NOTE:

1. ALL DIAMETERS ARE TO BE CONCENTRIC WITH IN THE TOLERANCE  $\pm 0.005$
2. GROUND SURFACE SHOULD BE PERELELL TO EACH OTHER WITH IN  $\pm 0.01$
3. BOTH END SURFACES SHOULD BE SOLID, i.e., NO HOLE SHOULD BE THERE ON THE END SURFACES.

UNLESS OTHERWISE SPECIFIED:  
DIMENSIONS ARE IN MM  
TOLERANCE ---  $\pm 0.1$



**Figure 2: Low Cycle Fatigue testing M12 sample drawing**

I have understood the requirements for preparation / fabrication of this sample.

REMARKS (If any):	SIGNATURE (with Name, Date, Phone No. & Seal)
-------------------	--