

Specification - Compliance**GeM Bid No: GEM/YYYY/B/NNNNNNN, Date: DD-MM-YYYY****Material Description: BLOOM SKID ROLLER CONVEYOR GEARED MOTOR - SP2000250201**

PR Item No.	Description	Requirement	Qty. (NO)
10	RC geared motor-Bloom skid (Planetary)	As per specification below	5

Sl. No.	Specification	BHEL's requirement	Bidder's Response
1	Motor Specification		
1.1	Make	Bidder to specify	
1.2	Model / Part Number	Bidder to specify	
1.3	Rated Power	7.5 kW	
1.4	Rated Torque	Bidder to specify	
1.5	Maximum Torque	1.6 times rated torque	
1.6	Rated Voltage	415 V (Δ)	
1.7	Rated Frequency	50 Hz	
1.8	Rated Speed	1450 RPM	
1.9	Rated Current	Bidder to specify	
1.10	Efficiency	Bidder to specify	
1.11	Power Factor	Bidder to specify	
1.12	Frame Size	132 M	
1.13	Mounting Position	IM B5 (Flange)	
1.14	Degree of Protection	IP 55	
1.15	Insulation Class	F	
1.16	Duty of Rating	S5	
1.17	Cyclic Duration Factor	10%	
1.18	Starts per Hour	60	
1.19	Starting Method	Variable Frequency Drive	
1.20	Direction of Rotation	Bi-Directional	
1.21	Method of Cooling	IC 411 (TEFC)	
1.22	Locaation of Terminal Box	Left (when viewed from Non drive end)	
1.23	Confirming Standard	IS 325	
2	Gearbox Specification		
2.1	Construction	Gears and pinions of planetary type made out of alloy steel in generating process, further hardened and ground to high precision and accuracy.	
2.2	Rated Torque	1055 Nm	
2.3	Maximum Torque	1687 Nm	
2.4	Rated Speed	68 RPM	
2.5	Gear Ratio	21.32	
2.6	Load Classification	AGMA Class III	
2.7	Service Factor	Shall be not less than 2.0	
2.8	Mounting Position	IM B3 (Foot)	
2.9	Lubrication Nipple	Shall be provided	
3	Dimensional Details		
3.1	Dimensions as per the drawing given below. All Dimensions are in mm.	A = 368	
3.2		B = 384	
3.3		$\emptyset D = 63.5$ j6	
3.4		E = 435	
3.5		F = 473	
3.6		H = 197	
3.7		I = 203	
3.8		K = 890	
3.9		L = 121	
3.10		$\emptyset S = 20$	
3.11		T = 70.5 +0.2	
3.12		U = 18	

Specification - Compliance

GeM Bid No: **GEM/YYYY/B/NNNNNNN**, Date: **DD-MM-YYYY**

Material Description: **BLOOM SKID ROLLER CONVEYOR GEARED MOTOR - SP2000250201**

PR Item No.	Description	Requirement	Qty. (NO)
10	RC geared motor-Bloom skid (Planetary)	As per specification below	5

Sl. No.	Specification	BHEL's requirement	Bidder's Response
---------	---------------	--------------------	-------------------

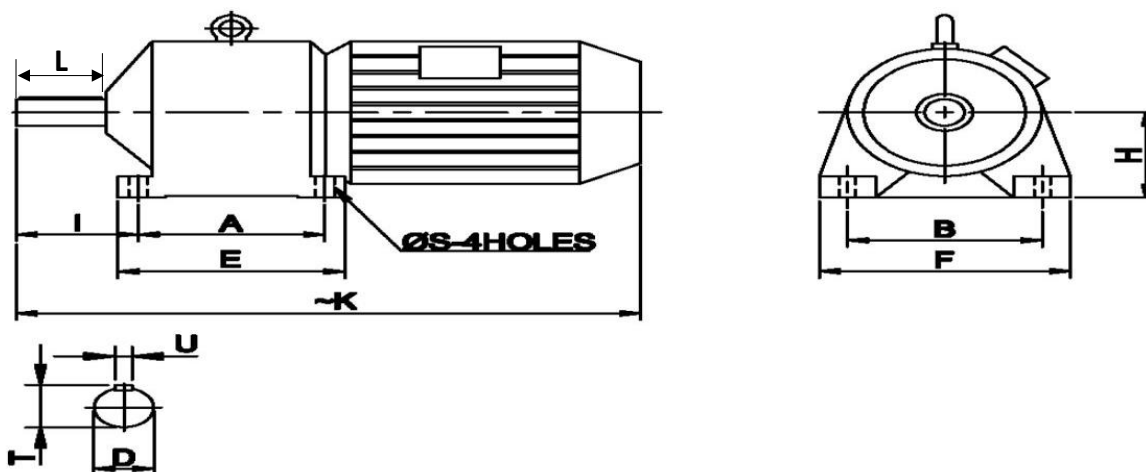

4	QUALIFYING CONDITIONS AND DOCUMENTS TO BE SUBMITTED		
4.1	Only those Bidders who have supplied similar or higher capacity/ size equipment that is working satisfactorily for at least two year after commissioning should quote.	Bidder to confirm. Shall be provided with supporting documents	
4.2	Motor Data Sheet	Bidder to attach along with offer	
4.3	Motor GA Drawing	Bidder to attach along with offer	
4.4	Gearbox Data Sheet	Bidder to attach along with offer	
4.5	Gearbox GA Drawing	Bidder to attach along with offer	
4.6	Routine Test Reports	To be provide during the supply of goods	
4.7	Operation and Maintenance manuals	To be provide during the supply of goods	
4.8	Detailed Engineering drawing of gear box	To be provide during the supply of goods	

Vendor Name & Address

Signature & Office Seal of the vendor

Vendor code (BHEL Trichy code)
(optional if available)

**RAMESH KUMAR
KORRA**

Digitally signed by RAMESH
KUMAR KORRA
Date: 2024.11.20 09:55:21 +05'30'

Specification - Compliance**GeM Bid No: GEM/YYYY/B/NNNNNNN, Date: DD-MM-YYYY****Material Description: COLD SAW ROLLER CONVEYOR GEARED MOTOR - SP2000250265**

PR Item No.	Description	Requirement	Qty. (NO)
100	RC geared motor-Cold saw (Planetary)	As per specification below	25

Sl. No.	Specification	BHEL's requirement	Bidder's Response
1	Motor Specification		
1.1	Make	Bidder to specify	
1.2	Model / Part Number	Bidder to specify	
1.3	Rated Power	5.5 kW	
1.4	Rated Torque	Bidder to specify	
1.5	Maximum Torque	1.6 times rated torque	
1.6	Rated Voltage	415 V (Δ)	
1.7	Rated Frequency	50 Hz	
1.8	Rated Speed	1450 RPM	
1.9	Rated Current	Bidder to specify	
1.10	Efficiency	Bidder to specify	
1.11	Power Factor	Bidder to specify	
1.12	Frame Size	132 S	
1.13	Mounting Position	IM B5 (Flange)	
1.14	Degree of Protection	IP 55	
1.15	Insulation Class	F	
1.16	Duty of Rating	S5	
1.17	Cyclic Duration Factor	30%	
1.18	Starts per Hour	180	
1.19	Starting Method	Variable Frequency Drive	
1.20	Direction of Rotation	Bi-Directional	
1.21	Method of Cooling	IC 411 (TEFC)	
1.22	Locaation of Terminal Box	Left (when viewed from Non drive end)	
1.23	Confirming Standard	IS 325	
2	Gearbox Specification		
2.1	Construction	Gears and pinions of planetary type made out of alloy steel in generating process, further hardened and ground to high precision and accuracy.	
2.2	Rated Torque	255 Nm	
2.3	Maximum Torque	408 Nm	
2.4	Rated Speed	206 RPM	
2.5	Gear Ratio	7.04	
2.6	Load Classification	AGMA Class III	
2.7	Service Factor	Shall be not less than 2.0	
2.8	Mounting Position	IM B3 or IM B8 (Foot)-must be suitable for both	
2.9	Lubrication Nipple	Shall be provided	
3	Dimensional Details		
3.1	Dimensions as per the drawing given below. All Dimensions are in mm.	A = 230	
3.2		B = 250	
3.3		$\varnothing D = 50$ (k6)	
3.4		E = 280	
3.5		F = 310	
3.6		H = 160	
3.7		I = 150	
3.8		K = 762	
3.9		L = 110	
3.10		$\varnothing S = 23$	
3.11		T = 53.5	
3.12		U = 14	

Specification - Compliance
GeM Bid No: **GEM/YYYY/B/NNNNNNN**, Date: **DD-MM-YYYY**
Material Description: **COLD SAW ROLLER CONVEYOR GEARED MOTOR - SP2000250265**

PR Item No.	Description	Requirement	Qty. (NO)
100	RC geared motor-Cold saw (Planetary)	As per specification below	25

Sl. No.	Specification	BHEL's requirement	Bidder's Response
---------	---------------	--------------------	-------------------

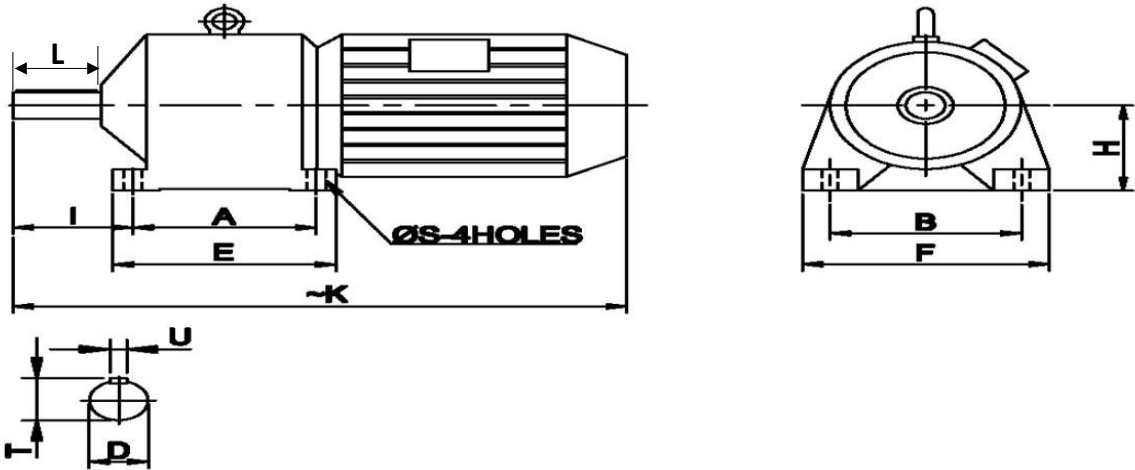

4	QUALIFYING CONDITIONS AND DOCUMENTS TO BE SUBMITTED		
4.1	Only those Bidders who have supplied similar or higher capacity/ size equipment that is working satisfactorily for at least two year after commissioning should quote.	Bidder to confirm. Shall be provided with supporting documents	
4.2	Motor Data Sheet	Bidder to attach along with offer	
4.3	Motor GA Drawing	Bidder to attach along with offer	
4.4	Gearbox Data Sheet	Bidder to attach along with offer	
4.5	Gearbox GA Drawing	Bidder to attach along with offer	
4.6	Routine Test Reports	To be provide during the supply of goods	
4.7	Operation and Maintenance manuals	To be provide during the supply of goods	
4.8	Detailed Engineering drawing of gear box	To be provide during the supply of goods	

Vendor Name & Address

Signature & Office Seal of the vendor

Vendor code (BHEL Trichy code)
(optional if available)

Specification - Compliance**GeM Bid No: GEM/YYYY/B/NNNNNNN, Date: DD-MM-YYYY****Material Description: COLD SAW ROLLER CONVEYOR GEARED MOTOR(HELICAL) - SP2000250272**

PR Item No.	Description	Requirement	Qty. (NO)
110	CS RC GEARED MOTOR (Helical)	As per specification below	25

Sl. No.	Specification	BHEL's requirement	Bidder's Response
1	Motor Specification		
1.1	Make	Bidder to specify	
1.2	Model / Part Number	Bidder to specify	
1.3	Rated Power	5.5 kW	
1.4	Rated Torque	Bidder to specify	
1.5	Maximum Torque	1.6 times rated torque	
1.6	Rated Voltage	415 V (Δ)	
1.7	Rated Frequency	50 Hz	
1.8	Rated Speed	1450 RPM	
1.9	Rated Current	Bidder to specify	
1.10	Efficiency	Bidder to specify	
1.11	Power Factor	Bidder to specify	
1.12	Frame Size	132 S	
1.13	Mounting Position	IM B5 (Flange)	
1.14	Degree of Protection	IP 55	
1.15	Insulation Class	F	
1.16	Duty of Rating	S5	
1.17	Cyclic Duration Factor	30%	
1.18	Starts per Hour	180	
1.19	Starting Method	Variable Frequency Drive	
1.20	Direction of Rotation	Bi-Directional	
1.21	Method of Cooling	IC 411 (TEFC)	
1.22	Locaation of Terminal Box	Left (when viewed from Non drive end)	
1.23	Confirming Standard	IS 325	
2	Gearbox Specification		
2.1	Construction	Gears and pinions of Helical type made out of alloy steel in generating process, further hardened and ground to high precision and accuracy.	
2.2	Rated Torque	255 Nm	
2.3	Maximum Torque	408 Nm	
2.4	Rated Speed	206 RPM	
2.5	Gear Ratio	7.04	
2.6	Load Classification	AGMA Class III	
2.7	Service Factor	Shall be not less than 2.0	
2.8	Mounting Position	IM B3 or IM B8 (Foot)-must be suitable for both	
2.9	Lubrication Nipple	Shall be provided	
3	Dimensional Details		
3.1	Dimensions as per the drawing given below. All Dimensions are in mm.	A = 230	
3.2		B = 250	
3.3		$\emptyset D = 50$ (k6)	
3.4		E = 280	
3.5		F = 310	
3.6		H = 160	
3.7		I = 150	
3.8		K = 762	
3.9		L = 110	
3.10		$\emptyset S = 23$	
3.11		T = 53.5	
3.12		U = 14	

Specification - Compliance
GeM Bid No: **GEM/YYYY/B/NNNNNNN**, Date: **DD-MM-YYYY**
Material Description: **COLD SAW ROLLER CONVEYOR GEARED MOTOR(HELICAL) - SP2000250272**

PR Item No.	Description	Requirement	Qty. (NO)
110	CS RC GEARED MOTOR (Helical)	As per specification below	25

Sl. No.	Specification	BHEL's requirement	Bidder's Response
---------	---------------	--------------------	-------------------

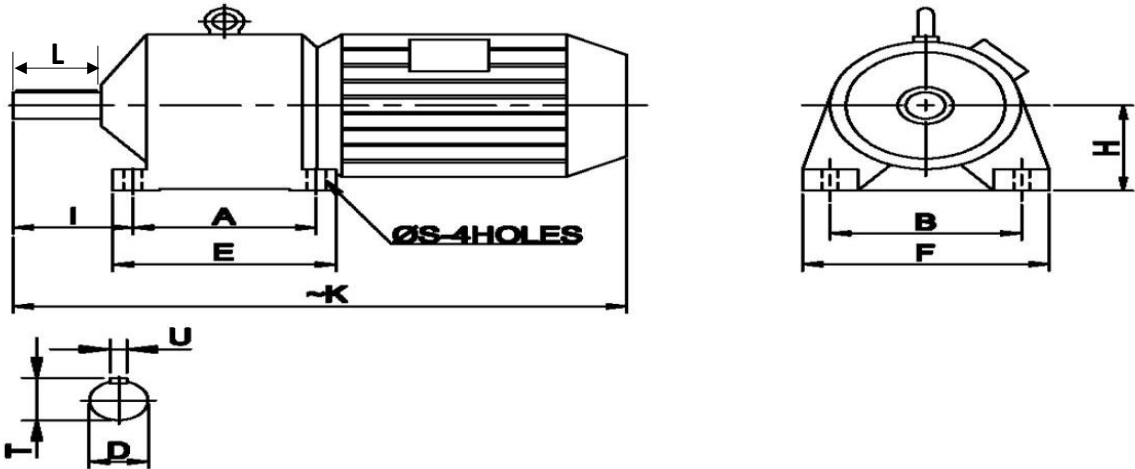

4	QUALIFYING CONDITIONS AND DOCUMENTS TO BE SUBMITTED		
4.1	Only those Bidders who have supplied similar or higher capacity/ size equipment that is working satisfactorily for at least two year after commissioning should quote.	Bidder to confirm. Shall be provided with supporting documents	
4.2	Motor Data Sheet	Bidder to attach along with offer	
4.3	Motor GA Drawing	Bidder to attach along with offer	
4.4	Gearbox Data Sheet	Bidder to attach along with offer	
4.5	Gearbox GA Drawing	Bidder to attach along with offer	
4.6	Routine Test Reports	To be provide during the supply of goods	
4.7	Operation and Maintenance manuals	To be provide during the supply of goods	
4.8	Detailed Engineering drawing of gear box	To be provide during the supply of goods	

Vendor Name & Address

Signature & Office Seal of the vendor

Vendor code (BHEL Trichy code)
(optional if available)

Specification - Compliance
GeM Bid No: GEM/YYYY/B/NNNNNNN, Date: DD-MM-YYYY
Material Description: RHF CHARGING ROLLER CONVEYOR GEARED MOTOR - SP2000250208

PR Item No.	Description	Requirement	Qty. (NO)
20	RC geared motor-RHF Charging RC (Planetary)	As per specification below	40

Sl. No.	Specification	BHEL's requirement	Bidder's Response
1	Motor Specification		
1.1	Make	Bidder to specify	
1.2	Model / Part Number	Bidder to specify	
1.3	Rated Power	3.7 kW	
1.4	Rated Torque	Bidder to specify	
1.5	Maximum Torque	1.6 times rated torque	
1.6	Rated Voltage	415 V (Δ)	
1.7	Rated Frequency	50 Hz	
1.8	Rated Speed	1450 RPM	
1.9	Rated Current	Bidder to specify	
1.10	Efficiency	Bidder to specify	
1.11	Power Factor	Bidder to specify	
1.12	Frame Size	112 M	
1.13	Mounting Position	IM B5 (Flange)	
1.14	Degree of Protection	IP 55	
1.15	Insulation Class	F	
1.16	Duty of Rating	S5	
1.17	Cyclic Duration Factor	40%	
1.18	Starts per Hour	120	
1.19	Starting Method	Variable Frequency Drive	
1.20	Direction of Rotation	Bi-Directional	
1.21	Method of Cooling	IC 411 (TEFC)	
1.22	Locaation of Terminal Box	Left (when viewed from Non drive end)	
1.23	Confirming Standard	IS 325	
2	Gearbox Specification		
2.1	Construction	Gears and pinions of planetary type made out of alloy steel in generating process, further hardened and ground to high precision and accuracy.	
2.2	Rated Torque	635 Nm	
2.3	Maximum Torque	1016 Nm	
2.4	Rated Speed	56 RPM	
2.5	Gear Ratio	25.89	
2.6	Load Classification	AGMA Class III	
2.7	Service Factor	Shall be not less than 2.0	
2.8	Mounting Position	IM B3 (Foot)	
2.9	Lubrication Nipple	Shall be provided	
3	Dimensional Details		
3.1	Dimensions as per the drawing given below. All Dimensions are in mm.	A = 298	
3.2		B = 318	
3.3		$\varnothing D = 44.45 \text{ j6}$	
3.4		E = 356	
3.5		F = 387	
3.6		H = 171	
3.7		I = 129	
3.8		K = 760	
3.9		L = 83	
3.10		$\varnothing S = 17$	
3.11		T = 48.69	
3.12		U = 9.52	

Specification - Compliance
GeM Bid No: **GEM/YYYY/B/NNNNNNN**, Date: **DD-MM-YYYY**
Material Description: **RHF CHARGING ROLLER CONVEYOR GEARED MOTOR - SP2000250208**

PR Item No.	Description	Requirement	Qty. (NO)
20	RC geared motor-RHF Charging RC (Planetary)	As per specification below	40

Sl. No.	Specification	BHEL's requirement	Bidder's Response
---------	---------------	--------------------	-------------------

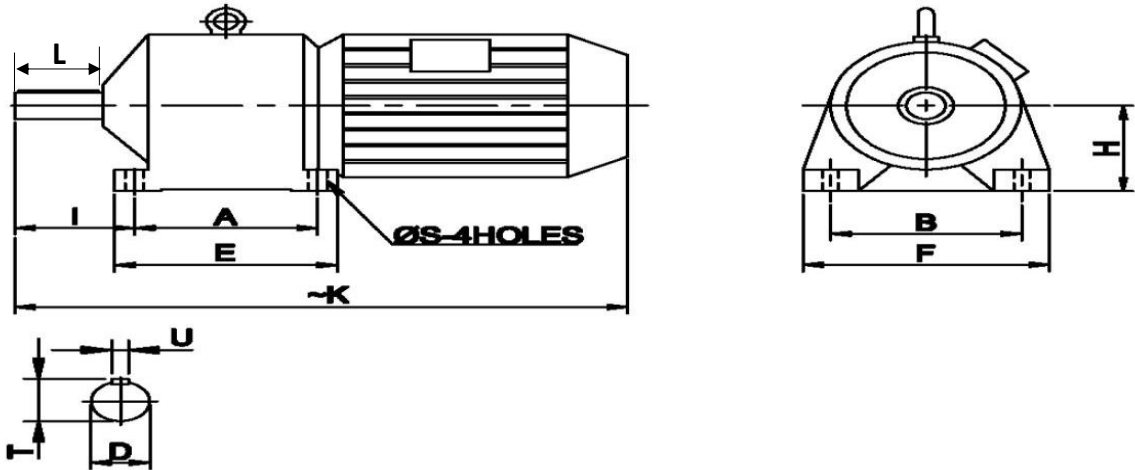

4	QUALIFYING CONDITIONS AND DOCUMENTS TO BE SUBMITTED		
4.1	Only those Bidders who have supplied similar or higher capacity/ size equipment that is working satisfactorily for at least two year after commissioning should quote.	Bidder to confirm. Shall be provided with supporting documents	
4.2	Motor Data Sheet	Bidder to attach along with offer	
4.3	Motor GA Drawing	Bidder to attach along with offer	
4.4	Gearbox Data Sheet	Bidder to attach along with offer	
4.5	Gearbox GA Drawing	Bidder to attach along with offer	
4.6	Routine Test Reports	To be provide during the supply of goods	
4.7	Operation and Maintenance manuals	To be provide during the supply of goods	
4.8	Detailed Engineering drawing of gear box	To be provide during the supply of goods	

Vendor Name & Address

Signature & Office Seal of the vendor

Vendor code (BHEL Trichy code)
(optional if available)

RAMESH KUMAR KORRA

Digitally signed by RAMESH KUMAR KORRA
Date: 2024.11.20 09:59:52 +05'30'

Specification - Compliance
GeM Bid No: GEM/YYYY/B/NNNNNNN, Date: DD-MM-YYYY
Material Description: RHF TO CPE ROLLER CONVEYOR GEARED MOTOR - SP2000250215

PR Item No.	Description	Requirement	Qty. (NO)
30	RC geared motor-RC to CPE (Planetary)	As per specification below	15

Sl. No.	Specification	BHEL's requirement	Bidder's Response
1	Motor Specification		
1.1	Make	Bidder to specify	
1.2	Model / Part Number	Bidder to specify	
1.3	Rated Power	5.5 kW	
1.4	Rated Torque	Bidder to specify	
1.5	Maximum Torque	1.6 times rated torque	
1.6	Rated Voltage	415 V (Δ)	
1.7	Rated Frequency	50 Hz	
1.8	Rated Speed	1450 RPM	
1.9	Rated Current	Bidder to specify	
1.10	Efficiency	Bidder to specify	
1.11	Power Factor	Bidder to specify	
1.12	Frame Size	132 S	
1.13	Mounting Position	IM B5 (Flange)	
1.14	Degree of Protection	IP 55	
1.15	Insulation Class	F	
1.16	Duty of Rating	S5	
1.17	Cyclic Duration Factor	30%	
1.18	Starts per Hour	180	
1.19	Starting Method	Variable Frequency Drive	
1.20	Direction of Rotation	Bi-Directional	
1.21	Method of Cooling	IC 411 (TEFC)	
1.22	Locaation of Terminal Box	Left (when viewed from Non drive end)	
1.23	Confirming Standard	IS 325	
2	Gearbox Specification		
2.1	Construction	Gears and pinions of planetary type made out of alloy steel in generating process, further hardened and ground to high precision and accuracy.	
2.2	Rated Torque	172 Nm	
2.3	Maximum Torque	275 Nm	
2.4	Rated Speed	306 RPM	
2.5	Gear Ratio	4.74	
2.6	Load Classification	AGMA Class III	
2.7	Service Factor	Shall be not less than 2.0	
2.8	Mounting Position	IM B3 (Foot)	
2.9	Lubrication Nipple	Shall be provided	
3	Dimensional Details		
3.1	Dimensions as per the drawing given below.	a=200	
3.2		b=205	
3.3		c=30	
3.4		e=240	
3.5		f=250	
3.6		n=256	
3.7		s=18	
3.8		g=267	
3.9		g1=207	
3.10		h=132	
3.11		i=142	
3.12		k=735	
3.13		k1=316	
3.14	All Dimensions are in mm.	k2=419	

Specification - Compliance

GeM Bid No: **GEM/YYYY/B/NNNNNNN**, Date: **DD-MM-YYYY**

Material Description: **RHF TO CPE ROLLER CONVEYOR GEARED MOTOR - SP2000250215**

PR Item No.	Description	Requirement	Qty. (NO)
30	RC geared motor-RC to CPE (Planetary)	As per specification below	15

Sl. No.	Specification	BHEL's requirement	Bidder's Response
3.15		o=220	
3.16		p=242	
3.17		p3=285	
3.18		p9=21	
3.19		A1=250	
3.20		d=40k6	
3.21		L=110	
3.22		L1=100	
3.23		m=5	
3.24		t=43	
3.25		u=12	
3.26		D=M16	

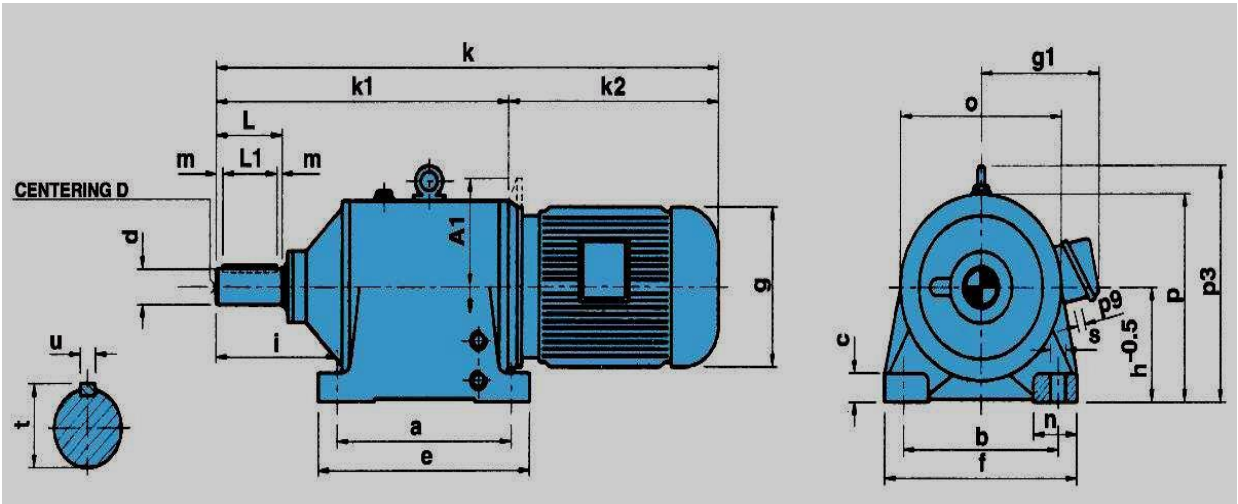

4	QUALIFYING CONDITIONS AND DOCUMENTS TO BE SUBMITTED		
4.1	Only those Bidders who have supplied similar or higher capacity/ size equipment that is working satisfactorily for at least two year after commissioning should quote.	Bidder to confirm. Shall be provided with supporting documents	
4.2	Motor Data Sheet	Bidder to attach along with offer	
4.3	Motor GA Drawing	Bidder to attach along with offer	
4.4	Gearbox Data Sheet	Bidder to attach along with offer	
4.5	Gearbox GA Drawing	Bidder to attach along with offer	
4.6	Routine Test Reports	To be provide during the supply of goods	
4.7	Operation and Maintenance manuals	To be provide during the supply of goods	
4.8	Detailed Engineering drawing of gear box	To be provide during the supply of goods	

Vendor Name & Address

Signature & Office Seal of the vendor

Vendor code (BHEL Trichy code)
(optional if available)

Specification - Compliance**GeM Bid No: GEM/YYYY/B/NNNNNNN, Date: DD-MM-YYYY****Material Description: CPE ALIGNING ROLLER CONVEYOR GEARED MOTOR - SP2000250222**

PR Item No.	Description	Requirement	Qty. (NO)
40	RC geared motor-Manipulator Aligning RC (Planetary)	As per specification below	10

Sl. No.	Specification	BHEL's requirement	Bidder's Response
1	Motor Specification		
1.1	Make	Bidder to specify	
1.2	Model / Part Number	Bidder to specify	
1.3	Rated Power	1.1 kW	
1.4	Rated Torque	Bidder to specify	
1.5	Maximum Torque	1.6 times rated torque	
1.6	Rated Voltage	415 V (Δ)	
1.7	Rated Frequency	50 Hz	
1.8	Rated Speed	1450 RPM	
1.9	Rated Current	Bidder to specify	
1.10	Efficiency	Bidder to specify	
1.11	Power Factor	Bidder to specify	
1.12	Frame Size	90 S	
1.13	Mounting Position	IM B5 (Flange)	
1.14	Degree of Protection	IP 55	
1.15	Insulation Class	F	
1.16	Duty of Rating	S5	
1.17	Cyclic Duration Factor	10%	
1.18	Starts per Hour	180	
1.19	Starting Method	Variable Frequency Drive	
1.20	Direction of Rotation	Bi-Directional	
1.21	Method of Cooling	IC 411 (TEFC)	
1.22	Locaaton of Terminal Box	Left (when viewed from Non drive end)	
1.23	Confirming Standard	IS 325	
2	Gearbox Specification		
2.1	Construction	Gears and pinions of planetary type made out of alloy steel in generating process, further hardened and ground to high precision and accuracy.	
2.2	Rated Torque	86 Nm	
2.3	Maximum Torque	138 Nm	
2.4	Rated Speed	126 RPM	
2.5	Gear Ratio	11.51	
2.6	Load Classification	AGMA Class III	
2.7	Service Factor	Shall be not less than 2.0	
2.8	Mounting Position	IM B3 (Foot)	
2.9	Lubrication Nipple	Shall be provided	
3	Dimensional Details		
3.1	Dimensions as per the drawing given below. All Dimensions are in mm.	A = 168	
3.2		B = 138	
3.3		\emptyset D = 30 (k6)	
3.4		E = 200	
3.5		F = 195	
3.6		H = 115	
3.7		I = 65	
3.8		K = 550	
3.9		L = 55	
3.10		\emptyset S = 18	

Specification - Compliance

GeM Bid No: GEM/YYYY/B/NNNNNNN, Date: DD-MM-YYYY

Material Description: CPE ALIGNING ROLLER CONVEYOR GEARED MOTOR - SP2000250222

PR Item No.	Description	Requirement	Qty. (NO)
40	RC geared motor-Manipulator Aligning RC (Planetary)	As per specification below	10

Sl. No.	Specification	BHEL's requirement	Bidder's Response
---------	---------------	--------------------	-------------------

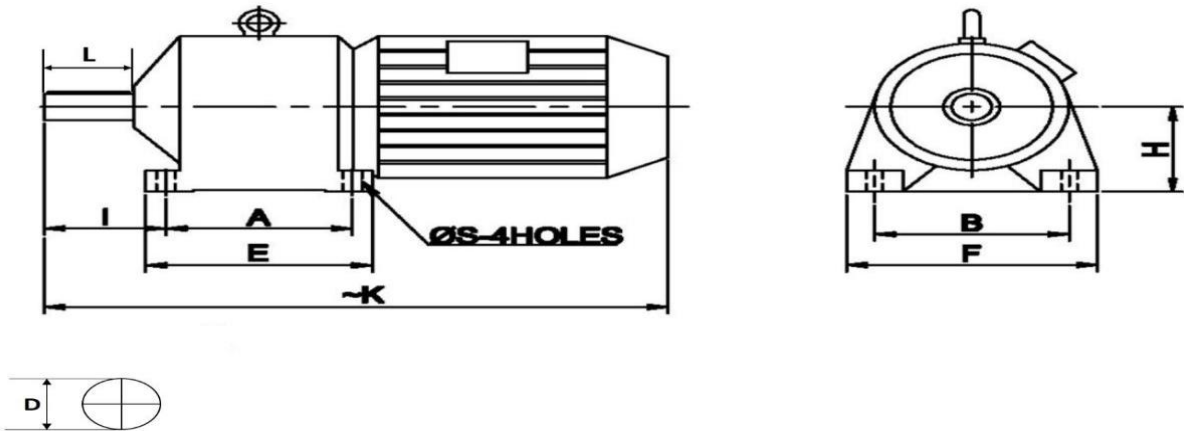

4	QUALIFYING CONDITIONS AND DOCUMENTS TO BE SUBMITTED		
4.1	Only those Bidders who have supplied similar or higher capacity/ size equipment that is working satisfactorily for at least two year after commissioning should quote.	Bidder to confirm. Shall be provided with supporting documents	
4.2	Motor Data Sheet	Bidder to attach along with offer	
4.3	Motor GA Drawing	Bidder to attach along with offer	
4.4	Gearbox Data Sheet	Bidder to attach along with offer	
4.5	Gearbox GA Drawing	Bidder to attach along with offer	
4.6	Routine Test Reports	To be provide during the supply of goods	
4.7	Operation and Maintenance manuals	To be provide during the supply of goods	
4.8	Detailed Engineering drawing of gear box	To be provide during the supply of goods	

Vendor Name & Address

Signature & Office Seal of the vendor

Vendor code (BHEL Trichy code)
(optional if available)

RAMESH KUMAR
KORRA

Digitally signed by RAMESH
KUMAR KORRA
Date: 2024.11.20 10:01:22 +05'30'

Specification - Compliance**GeM Bid No: GEM/YYYY/B/NNNNNNN, Date: DD-MM-YYYY****Material Description: CPE EMERGENCY ROLLER CONVEYOR GEARED MOTOR - SP2000250229**

PR Item No.	Description	Requirement	Qty. (NO)
50	RC geared motor-Manipulator Emergency RC (Planetary)	As per specification below	5

Sl. No.	Specification	BHEL's requirement	Bidder's Response
1	Motor Specification		
1.1	Make	Bidder to specify	
1.2	Model / Part Number	Bidder to specify	
1.3	Rated Power	5.5 kW	
1.4	Rated Torque	Bidder to specify	
1.5	Maximum Torque	1.6 times rated torque	
1.6	Rated Voltage	415 V (Δ)	
1.7	Rated Frequency	50 Hz	
1.8	Rated Speed	1450 RPM	
1.9	Rated Current	Bidder to specify	
1.10	Efficiency	Bidder to specify	
1.11	Energy Class	IE2	
1.12	Power Factor	Bidder to specify	
1.13	Frame Size	132 S	
1.14	Mounting Position	IM B5 (Flange)	
1.15	Degree of Protection	IP 55	
1.16	Insulation Class	F	
1.17	Duty of Rating	S3	
1.18	Starting Method	Variable Frequency Drive	
1.19	Direction of Rotation	Bi-Directional	
1.20	Method of Cooling	IC 411 (TEFC)	
1.21	Locaation of Terminal Box	Left (when viewed from Non drive end)	
1.22	Confirming Standard	IS 325	
2	Gearbox Specification		
2.1	Construction	Gears and pinions of planetary type made out of alloy steel in generating process, further hardened and ground to high precision and accuracy.	
2.2	Rated Torque	340 Nm	
2.3	Maximum Torque	542 Nm	
2.4	Rated Speed	155 RPM	
2.5	Gear Ratio	9.36	
2.6	Load Classification	AGMA Class III	
2.7	Service Factor	Shall be not less than 2.0	
2.8	Mounting Position	IM B3 (Foot)	
2.9	Lubrication Nipple	Shall be provided	
3	Dimensional Details		
3.1	Dimensions as per the drawing given below. All Dimensions are in mm.	A = 160	
3.2		B = 220	
3.3		$\varnothing D = 42$ (k6)	
3.4		E = 195	
3.5		F = 275	
3.6		H = 180	
3.7		I = 100	
3.8		K = 700	
3.9		L = 90	
3.10		$\varnothing S = 18$	
3.11		T = 46	
3.12		U = 12	

Specification - Compliance

GeM Bid No: **GEM/YYYY/B/NNNNNNN**, Date: **DD-MM-YYYY**

Material Description: **CPE EMERGENCY ROLLER CONVEYOR GEARED MOTOR - SP2000250229**

PR Item No.	Description	Requirement	Qty. (NO)
50	RC geared motor-Manipulator Emergency RC (Planetary)	As per specification below	5

Sl. No.	Specification	BHEL's requirement	Bidder's Response
---------	---------------	--------------------	-------------------

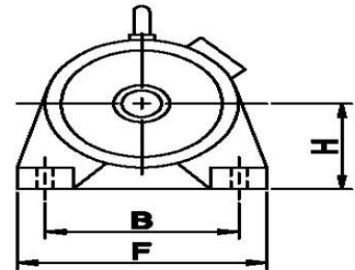
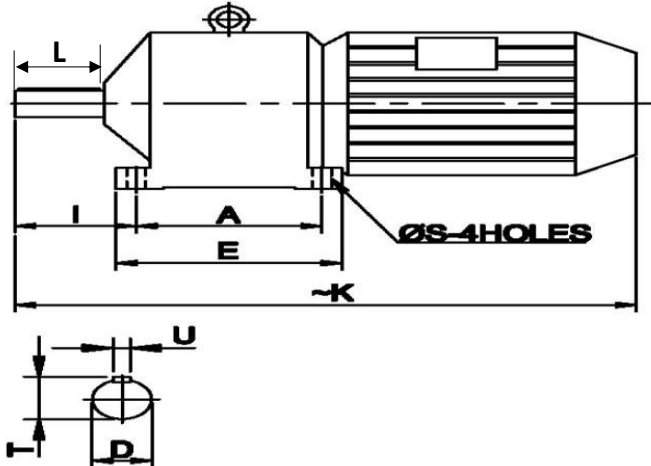

4	QUALIFYING CONDITIONS AND DOCUMENTS TO BE SUBMITTED		
4.1	Only those Bidders who have supplied similar or higher capacity/ size equipment that is working satisfactorily for at least two year after commissioning should quote.	Bidder to confirm. Shall be provided with supporting documents	
4.2	Motor Data Sheet	Bidder to attach along with offer	
4.3	Motor GA Drawing	Bidder to attach along with offer	
4.4	Gearbox Data Sheet	Bidder to attach along with offer	
4.5	Gearbox GA Drawing	Bidder to attach along with offer	
4.6	Routine Test Reports	To be provide during the supply of goods	
4.7	Operation and Maintenance manuals	To be provide during the supply of goods	
4.8	Detailed Engineering drawing of gear box	To be provide during the supply of goods	

Vendor Name & Address

Signature & Office Seal of the vendor

Vendor code (BHEL Trichy code)
(optional if available)

**RAMESH
KUMAR KORRA**

Digitally signed by RAMESH
KUMAR KORRA
Date: 2024.11.20 10:01:54
+05'30'

Specification - Compliance**GeM Bid No: GEM/YYYY/B/NNNNNNN, Date: DD-MM-YYYY****Material Description: MANDREL BAR EXTRACTOR ROLLER CONVEYOR GEARED MOTOR - SP2000250236**

PR Item No.	Description	Requirement	Qty. (NO)
60	RC geared motor-RC to MBE (Planetary)	As per specification below	15

Sl. No.	Specification	BHEL's requirement	Bidder's Response
1	Motor Specification		
1.1	Make	Bidder to specify	
1.2	Model / Part Number	Bidder to specify	
1.3	Rated Power	7.5 kW	
1.4	Rated Torque	Bidder to specify	
1.5	Maximum Torque	1.6 times rated torque	
1.6	Rated Voltage	415 V (Δ)	
1.7	Rated Frequency	50 Hz	
1.8	Rated Speed	1450 RPM	
1.9	Rated Current	Bidder to specify	
1.10	Efficiency	Bidder to specify	
1.11	Power Factor	Bidder to specify	
1.12	Frame Size	132 M	
1.13	Mounting Position	IM B5 (Flange)	
1.14	Degree of Protection	IP 55	
1.15	Insulation Class	F	
1.16	Duty of Rating	S5	
1.17	Cyclic Duration Factor	30%	
1.18	Starts per Hour	180	
1.19	Starting Method	Variable Frequency Drive	
1.20	Direction of Rotation	Bi-Directional	
1.21	Method of Cooling	IC 411 (TEFC)	
1.22	Locaation of Terminal Box	Left (when viewed from Non drive end)	
1.23	Confirming Standard	IS 325	
2	Gearbox Specification		
2.1	Construction	Gears and pinions of planetary type made out of alloy steel in generating process, further hardened and ground to high precision and accuracy.	
2.2	Rated Torque	561 Nm	
2.3	Maximum Torque	897 Nm	
2.4	Rated Speed	128 RPM	
2.5	Gear Ratio	11.33	
2.6	Load Classification	AGMA Class III	
2.7	Service Factor	Shall be not less than 2.0	
2.8	Mounting Position	IM B3 (Foot)	
2.9	Lubrication Nipple	Shall be provided	
3	Dimensional Details		
3.1	Dimensions as per the drawing given below. All Dimensions are in mm.	A = 298	
3.2		B = 318	
3.3		$\varnothing D = 44.45 \text{ j6}$	
3.4		E = 356	
3.5		F = 387	
3.6		H = 171	
3.7		I = 129	
3.8		K = 881	
3.9		L = 83	
3.10		$\varnothing S = 17$	
3.11		T = 48.69	
3.12		U = 14	

Specification - Compliance

GeM Bid No: GEM/YYYY/B/NNNNNNN, Date: DD-MM-YYYY

Material Description: MANDREL BAR EXTRACTOR ROLLER CONVEYOR GEARED MOTOR - SP2000250236

PR Item No.	Description	Requirement	Qty. (NO)
60	RC geared motor-RC to MBE (Planetary)	As per specification below	15

Sl. No.	Specification	BHEL's requirement	Bidder's Response
---------	---------------	--------------------	-------------------

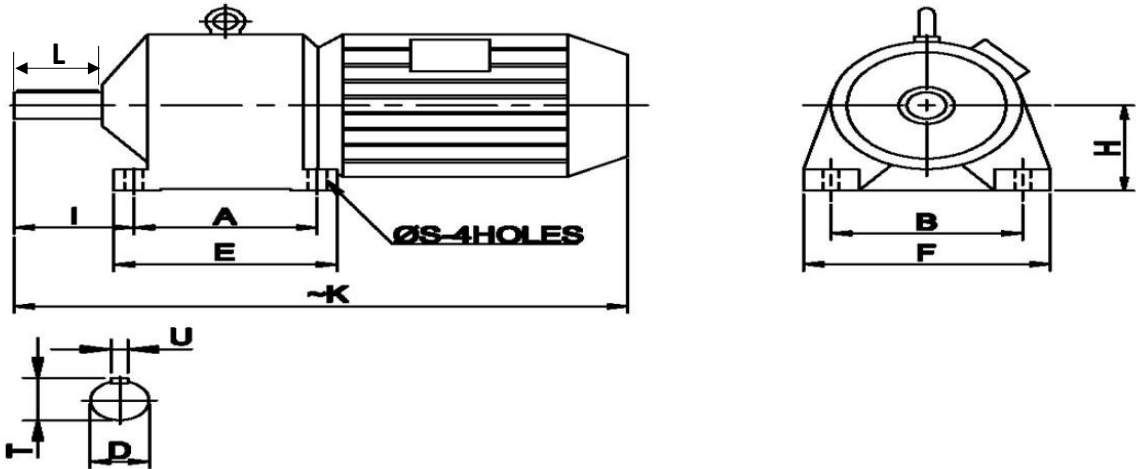

4	QUALIFYING CONDITIONS AND DOCUMENTS TO BE SUBMITTED		
4.1	Only those Bidders who have supplied similar or higher capacity/ size equipment that is working satisfactorily for at least two year after commissioning should quote.	Bidder to confirm. Shall be provided with supporting documents	
4.2	Motor Data Sheet	Bidder to attach along with offer	
4.3	Motor GA Drawing	Bidder to attach along with offer	
4.4	Gearbox Data Sheet	Bidder to attach along with offer	
4.5	Gearbox GA Drawing	Bidder to attach along with offer	
4.6	Routine Test Reports	To be provide during the supply of goods	
4.7	Operation and Maintenance manuals	To be provide during the supply of goods	
4.8	Detailed Engineering drawing of gear box	To be provide during the supply of goods	

Vendor Name & Address

Signature & Office Seal of the vendor

Vendor code (BHEL Trichy code)
(optional if available)

RAMESH KUMAR
KORRA

Digitally signed by RAMESH
KUMAR KORRA
Date: 2024.11.20 10:02:24 +05'30'

Specification - Compliance**GeM Bid No: GEM/YYYY/B/NNNNNNN, Date: DD-MM-YYYY****Material Description: MANDREL BAR CIRCULATION ROLLER CONVEYOR GEARED MOTOR - SP2000250243**

PR Item No.	Description	Requirement	Qty. (NO)
70	RC geared motor-MBC area (Planetary)	As per specification below	25

Sl. No.	Specification	BHEL's requirement	Bidder's Response
1	Motor Specification		
1.1	Make	Bidder to specify	
1.2	Model / Part Number	Bidder to specify	
1.3	Rated Power	5.5 kW	
1.4	Rated Torque	Bidder to specify	
1.5	Maximum Torque	1.6 times rated torque	
1.6	Rated Voltage	415 V (Δ)	
1.7	Rated Frequency	50 Hz	
1.8	Rated Speed	1450 RPM	
1.9	Rated Current	Bidder to specify	
1.10	Efficiency	Bidder to specify	
1.11	Energy Class	IE2	
1.12	Power Factor	Bidder to specify	
1.13	Frame Size	132 S	
1.14	Mounting Position	IM B5 (Flange)	
1.15	Degree of Protection	IP 55	
1.16	Insulation Class	F	
1.17	Duty of Rating	S1	
1.18	Starting Method	Variable Frequency Drive	
1.19	Direction of Rotation	Bi-Directional	
1.20	Method of Cooling	IC 411 (TEFC)	
1.21	Location of Terminal Box	Left (when viewed from Non drive end)	
1.22	Confirming Standard	IS 12615	
2	Gearbox Specification		
2.1	Construction	Gears and pinions of planetary type made out of alloy steel in generating process, further hardened and ground to high precision and accuracy.	
2.2	Rated Torque	220 Nm	
2.3	Maximum Torque	350 Nm	
2.4	Rated Speed	240 RPM	
2.5	Gear Ratio	6.04	
2.6	Load Classification	AGMA Class III	
2.7	Service Factor	Shall be not less than 2.0	
2.8	Mounting Position	IM B3 (Foot)	
2.9	Lubrication Nipple	Shall be provided	
3	Dimensional Details		
3.1	Dimensions as per the drawing given below. All Dimensions are in mm.	A = 298	
3.2		B = 318	
3.3		$\varnothing D = 44.45 \text{ j6}$	
3.4		E = 356	
3.5		F = 387	
3.6		H = 171	
3.7		I = 129	
3.8		K = 823	
3.9		L = 83	
3.10		$\varnothing S = 17$	
3.11		T = 48.69	
3.12		U = 14	

Specification - Compliance

GeM Bid No: **GEM/YYYY/B/NNNNNNN**, Date: **DD-MM-YYYY**

Material Description: **MANDREL BAR CIRCULATION ROLLER CONVEYOR GEARED MOTOR - SP2000250243**

PR Item No.	Description	Requirement	Qty. (NO)
70	RC geared motor-MBC area (Planetary)	As per specification below	25

Sl. No.	Specification	BHEL's requirement	Bidder's Response
---------	---------------	--------------------	-------------------

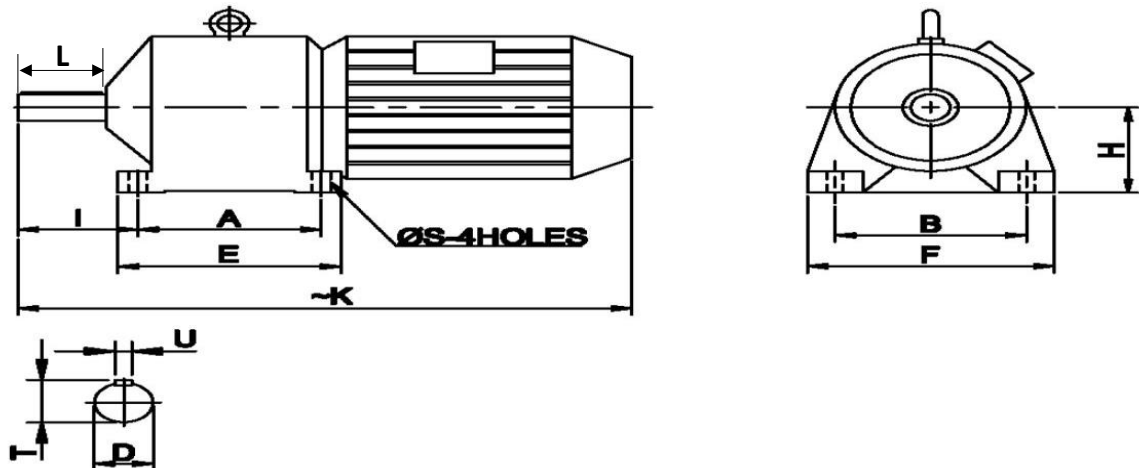

4	QUALIFYING CONDITIONS AND DOCUMENTS TO BE SUBMITTED		
4.1	Only those Bidders who have supplied similar or higher capacity/ size equipment that is working satisfactorily for at least two year after commissioning should quote.	Bidder to confirm. Shall be provided with supporting documents	
4.2	Motor Data Sheet	Bidder to attach along with offer	
4.3	Motor GA Drawing	Bidder to attach along with offer	
4.4	Gearbox Data Sheet	Bidder to attach along with offer	
4.5	Gearbox GA Drawing	Bidder to attach along with offer	
4.6	Routine Test Reports	To be provide during the supply of goods	
4.7	Operation and Maintenance manuals	To be provide during the supply of goods	
4.8	Detailed Engineering drawing of gear box	To be provide during the supply of goods	

Vendor Name & Address

Signature & Office Seal of the vendor

Vendor code (BHEL Trichy code)
(optional if available)

**RAMESH KUMAR
KORRA**

Digitally signed by RAMESH
KUMAR KORRA
Date: 2024.11.20 10:02:52 +05'30'

Specification - Compliance
GeM Bid No: GEM/YYYY/B/NNNNNNN, Date: DD-MM-YYYY
Material Description: HOT SAW/WALKING BEAM FURNACE ENTRY ROLLER CONVEYOR GEARED MOTOR - SP2000250251

PR Item No.	Description	Requirement	Qty. (NO)
80	RC geared motor-HS and WBF (Planetary)	As per specification below	25

Sl. No.	Specification	BHEL's requirement	Bidder's Response
1	Motor Specification		
1.1	Make	Bidder to specify	
1.2	Model / Part Number	Bidder to specify	
1.3	Rated Power	5.5 kW	
1.4	Rated Torque	Bidder to specify	
1.5	Maximum Torque	1.6 times rated torque	
1.6	Rated Voltage	415 V (Δ)	
1.7	Rated Frequency	50 Hz	
1.8	Rated Speed	1450 RPM	
1.9	Rated Current	Bidder to specify	
1.10	Efficiency	Bidder to specify	
1.11	Power Factor	Bidder to specify	
1.12	Frame Size	132 S	
1.13	Mounting Position	IM B5 (Flange)	
1.14	Degree of Protection	IP 55	
1.15	Insulation Class	F	
1.16	Duty of Rating	S5	
1.17	Cyclic Duration Factor	30%	
1.18	Starts per Hour	180	
1.19	Starting Method	Variable Frequency Drive	
1.20	Direction of Rotation	Bi-Directional	
1.21	Method of Cooling	IC 411 (TEFC)	
1.22	Locaation of Terminal Box	Left (when viewed from Non drive end)	
1.23	Confirming Standard	IS 325	
2	Gearbox Specification		
2.1	Construction	Gears and pinions of planetary type made out of alloy steel in generating process, further hardened and ground to high precision and accuracy.	
2.2	Rated Torque	310 Nm	
2.3	Maximum Torque	495 Nm	
2.4	Rated Speed	170 RPM	
2.5	Gear Ratio	8.53	
2.6	Load Classification	AGMA Class III	
2.7	Service Factor	Shall be not less than 2.0	
2.8	Mounting Position	IM B3 (Foot)	
2.9	Lubrication Nipple	Shall be provided	
3	Dimensional Details		
3.1	Dimensions as per the drawing given below. All Dimensions are in mm.	A = 298	
3.2		B = 318	
3.3		$\varnothing D = 44.45$ j6	
3.4		E = 356	
3.5		F = 387	
3.6		H = 171	
3.7		I = 129	
3.8		K = 823	
3.9		L = 83	
3.10		$\varnothing S = 17$	
3.11		T = 48.69	
3.12		U = 14	

Specification - Compliance

GeM Bid No: GEM/YYYY/B/NNNNNNN, Date: DD-MM-YYYY

Material Description: HOT SAW/WALKING BEAM FURNACE ENTRY ROLLER CONVEYOR GEARED MOTOR - SP2000250251

PR Item No.	Description	Requirement	Qty. (NO)
80	RC geared motor-HS and WBF (Planetary)	As per specification below	25

Sl. No.	Specification	BHEL's requirement	Bidder's Response
---------	---------------	--------------------	-------------------

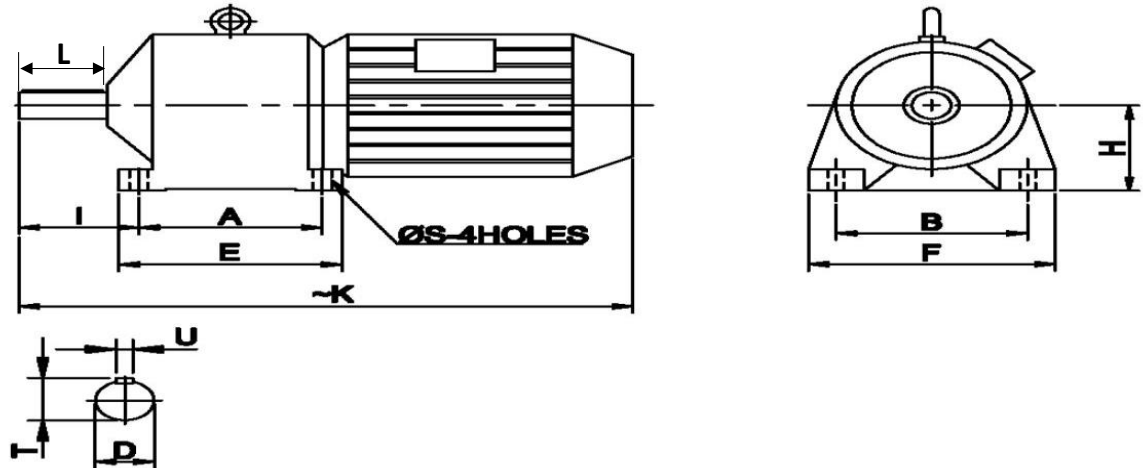

4	QUALIFYING CONDITIONS AND DOCUMENTS TO BE SUBMITTED		
4.1	Only those Bidders who have supplied similar or higher capacity/ size equipment that is working satisfactorily for at least two year after commissioning should quote.	Bidder to confirm. Shall be provided with supporting documents	
4.2	Motor Data Sheet	Bidder to attach along with offer	
4.3	Motor GA Drawing	Bidder to attach along with offer	
4.4	Gearbox Data Sheet	Bidder to attach along with offer	
4.5	Gearbox GA Drawing	Bidder to attach along with offer	
4.6	Routine Test Reports	To be provide during the supply of goods	
4.7	Operation and Maintenance manuals	To be provide during the supply of goods	
4.8	Detailed Engineering drawing of gear box	To be provide during the supply of goods	

Vendor Name & Address

Signature & Office Seal of the vendor

Vendor code (BHEL Trichy code)
(optional if available)

**RAMESH KUMAR
KORRA**

Digitally signed by RAMESH
KUMAR KORRA
Date: 2024.11.20 10:03:20 +05'30'

Specification - Compliance**GeM Bid No: GEM/YYYY/B/NNNNNNN, Date: DD-MM-YYYY****Material Description: WALKING BEAM FURNACE CRT & DRT GEARED MOTOR - SP2000250258**

PR Item No.	Description	Requirement	Qty. (NO)
90	RC geared motor-CRT,DRT (Planetary)	As per specification below	25

Sl. No.	Specification	BHEL's requirement	Bidder's Response
1	Motor Specification		
1.1	Make	Bidder to specify	
1.2	Model / Part Number	Bidder to specify	
1.3	Rated Power	5.5 kW	
1.4	Rated Torque	Bidder to specify	
1.5	Maximum Torque	1.6 times rated torque	
1.6	Rated Voltage	415 V (Δ)	
1.7	Rated Frequency	50 Hz	
1.8	Rated Speed	1450 RPM	
1.9	Rated Current	Bidder to specify	
1.10	Efficiency	Bidder to specify	
1.11	Energy Class	IE2	
1.12	Power Factor	Bidder to specify	
1.13	Frame Size	132 S	
1.14	Mounting Position	IM B5 (Flange)	
1.15	Degree of Protection	IP 55	
1.16	Insulation Class	F	
1.17	Duty of Rating	S1	
1.18	Starting Method	Variable Frequency Drive	
1.19	Direction of Rotation	Bi-Directional	
1.20	Method of Cooling	IC 411 (TEFC)	
1.21	Locaaton of Terminal Box	Left (when viewed from Non drive end)	
1.22	Confirming Standard	IS 12615	
2	Gearbox Specification		
2.1	Construction	Gears and pinions of planetary type made out of alloy steel in generating process, further hardened and ground to high precision and accuracy.	
2.2	Rated Torque	202 Nm	
2.3	Maximum Torque	324 Nm	
2.4	Rated Speed	260 RPM	
2.5	Gear Ratio	5.58	
2.6	Load Classification	AGMA Class III	
2.7	Service Factor	Shall be not less than 2.0	
2.8	Mounting Position	IM B3 (Foot)	
2.9	Lubrication Nipple	Shall be provided	
3	Dimensional Details		
3.1	Dimensions as per the drawing given below. All Dimensions are in mm.	A = 260	
3.2		B = 215	
3.3		\varnothing D = 50	
3.4		E = 320	
3.5		F = 290	
3.6		H = 160 (-0.5)	
3.7		I = 110	
3.8		K = 900	
3.9		L = 100	
3.10		\varnothing S = 20	
3.11		T = 54 (-0.29)	
3.12		U = 9 (h9)	

Specification - Compliance
GeM Bid No: **GEM/YYYY/B/NNNNNNN**, Date: **DD-MM-YYYY**
Material Description: WALKING BEAM FURNACE CRT & DRT GEARED MOTOR - SP2000250258

PR Item No.	Description	Requirement	Qty. (NO)
90	RC geared motor-CRT,DRT (Planetary)	As per specification below	25

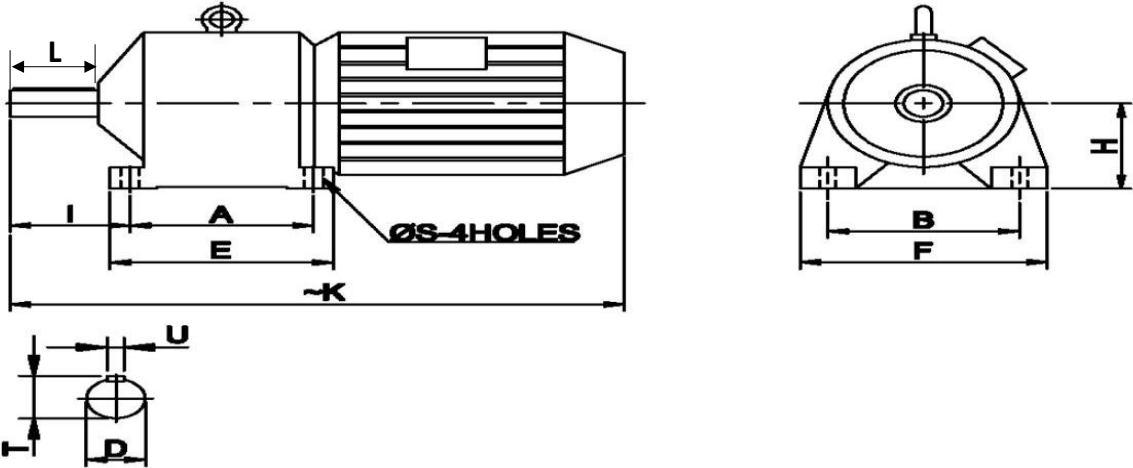
Sl. No.	Specification	BHEL's requirement	Bidder's Response
			

4	QUALIFYING CONDITIONS AND DOCUMENTS TO BE SUBMITTED		
4.1	Only those Bidders who have supplied similar or higher capacity/ size equipment that is working satisfactorily for at least two year after commissioning should quote.	Bidder to confirm. Shall be provided with supporting documents	
4.2	Motor Data Sheet	Bidder to attach along with offer	
4.3	Motor GA Drawing	Bidder to attach along with offer	
4.4	Gearbox Data Sheet	Bidder to attach along with offer	
4.5	Gearbox GA Drawing	Bidder to attach along with offer	
4.6	Routine Test Reports	To be provide during the supply of goods	
4.7	Operation and Maintenance manuals	To be provide during the supply of goods	
4.8	Detailed Engineering drawing of gear box	To be provide during the supply of goods	

Vendor Name & Address

Signature & Office Seal of the vendor

Vendor code (BHEL Trichy code)
(optional if available)