



भारत हेवी इलेक्ट्रिकल्स लिमिटेड
BHARAT HEAVY ELECTRICALS LIMITED

कॉर्पोरेट प्रशासन- न्यू बिल्डिंग कैम्पस / CORPORATE ADMIN. - NEW BUILDING CAMPUS
प्लॉट सं. -25, सैक्टर-16 ए, फ़िल्म सिटी / PLOT No.-25, SECTOR-16A, FILM CITY
नोएडा-201301 (उ. प्र.) / NOIDA- 201301 (U.P.)



TENDER DOCUMENT

FOR

**Works of Internal Branding of Entrance Lobby and Associated Interior Works in BHEL-
New Building, Plot No. - 25, Sector- 16A, Film City, Noida.**

निविदा संख्या/ NIT No.- AA:NBP:Lobby/23-24/01 Dated: 23.12.2023

CONTENTS

1- एकल निविदा आमंत्रित करने की सूचना / Notice Inviting Single Tender

जमा करने के अंतिम तिथि	: 26.12.2023 9:30 बजे।
LAST DATE FOR SUBMISSION	: 26.12.2023 AT 9.30 Hrs.

Mohit
23/12/23



एकल निविदा आमंत्रित करने की सूचना
NOTICE FOR INVITING TENDER

Sealed tender is invited in Single Part Bid system for the following work: -

Name of Work : Works of Internal Branding of Entrance Lobby and Associated Interior Works in BHEL- New Building, Plot No. - 25, Sector- 16A, Film City, Noida.

NIT No. : AA: NBP:Lobby/23-24/01 **Dated:** 23.12.2023

Period of Completion : 05 Days

Earnest Money Deposit : NOT APPLICABLE

DATE OF SUBMISSION & OPENING OF TENDER

Last date for submission of sealed tender : 26.12.2023 at 09:30 Hrs.

Date of opening the tender : 26.12.2023 at 10:00 Hrs.

Venue for Submission/ Opening of Tender : BHEL House, Sirifort, New Delhi - 110049

Tender documents shall be available on BHEL website www.bhel.com & Central Public Procurement Portal website www.eprocure.gov.in. In case of any clarification the bidder can contact the undersigned on phone no. +91-9871841566 or at e-mail: mohitarora@bhel.in.

For & On behalf of "BHEL"

Manager (NBP)

**NOTICE INVITING TENDER**

To,

M/s. Expression 360 Services India Pvt. Ltd.,
Ground Floor, Sarojini House,
6, Bhagwan Das Road,
Mandi House, New Delhi – 110001

Contact Person: Sh. Raj Kumar Singh - 99535 58299
connect@expression360.in

Subject: WORKS OF INTERNAL BRANDING OF ENTRANCE LOBBY AND ASSOCIATED INTERIOR WORKS IN BHEL- NEW BUILDING, PLOT NO. - 25, SECTOR- 16A, FILM CITY, NOIDA.

We are pleased to invite your most competitive offer in sealed cover with Tender No. for **Works of Internal Branding of Entrance Lobby and Associated Interior Works in BHEL- New Building**, Plot No-25, Sector-16A, Film city, Noida. The rates quoted shall be inclusive of all taxes, cartage, Packing & Forwarding, Insurance, Loading, Unloading, scaffolding etc. and in following format with terms & condition. The quotation must be put in the tender box at BHEL House, Sirifort, New Delhi - 110049 on or before the Due Date.

S. No.	Important instructions:
	<ol style="list-style-type: none">1. Bidder must go through all these Annexures before submitting the bid. All information as sought in the tender shall be furnished in totality.2. Offer should be submitted in Single Part as described in Instructions for Tenderer.3. The prices must be quoted in the enclosed Price bid format ONLY.4. The offers shall remain valid for a period of 10 days from the date of Bid opening.5. If any, information/ documents submitted by the tenderer are found false/ fake at any stage, the bid of the tenderer is liable to be summarily rejected.

Mohd
23/12/2023

A. INSTRUCTIONS FOR TENDERER:

1. This is Conventional Tender. The Bidder must respond by submitting their offer only in Hard Copy (Paper Bid) through Courier / Speed post/ By Hand only. Tender must be submitted in Single part only i.e. all the tender documents, supporting documents etc., to be submitted in a single envelope.
2. The offer shall be submitted as per the instructions of tender document. Only one set of tender documents duly signed by authorized representative of tenderer and signed & stamped on each page shall be submitted as detailed further. Tenderer should note specifically that all pages of tender document, including the NIT page for this particular tender shall be submitted by them (after signing/stamping on each page) as a part of their offer. In case of any clarification, bidder may contact this office.
3. There should be no deviation in the bid. Bid with deviation shall not be considered for evaluation and preparation of comparative statement, and shall be summarily rejected.
4. Tender documents are also available on BHEL web site (www.bhel.com) & on CPP Portal (<http://eprocure.gov.in/cppp/>) which can be downloaded and used as tender document for submitting the bid.
5. Bid should be free from correction, overwriting, using corrective fluid, etc. any interlineation, cutting, erasure or overwriting shall be valid only if they are attested under full signature (s) of person (s) signing the bid, else bid shall be liable for rejection.
6. BHEL reserves the right to accept or reject the offer without assigning any reason thereof. Also BHEL shall not entertain any correspondence from bidder in this matter.
7. In case any typing error/other clerical errors is noticed by the tenderer, in the tender documents, the same must be pointed out and got clarified before submission of offer, else, BHEL's interpretation shall prevail & shall be binding on the tenderer.
8. Tenderer is requested to go through the scope of work, visit the site/location etc. and get fully acquainted with the work place and prevailing working conditions to get all their doubts clarified regarding the above work before submitting the offer. Any queries regarding this tender may be clarified from (a) Sh. Mohit Arora, Manager (NBP), mobile no.- 9871841566, e-mail: mohitarora@bhel.in (b) Sh. Rajan Yadav, SDGM (NBP), mobile no. – 9810506306, email – admry@bhel.in
9. The tenderer or their authorized representative may attend the opening of bid, if they desire to do so.

B. DOCUMENTS TO BE SUBMITTED ALONG WITH TENDER ENQUIRY

1. Complete tender document in all respects duly signed & stamped on each and every page as a token of acceptance of all the terms and conditions of tender.
2. Declaration certificate as per Annexure-B must be signed and stamped.
3. Deviation / No deviation certificate as per Annexure-C must be signed and stamped.
4. Bidder's details as per Annexure-D must be signed and stamped.

C. SPECIAL CONDITIONS:

1. The subject work shall be carried out up to the satisfaction of BHEL's Engineer-in-charge. The work will be carried out as per BOQ enclosed and relevant IS codes for all the works. In case of any doubt regarding the specification and its quality of work, BHEL's Engineer in Charge clarification and decision will be final and binding on the contractor.
2. All materials to be provided by the Contractor shall be of the best kind in conformity with the Specifications laid down in the contract or as per relevant Indian standard and the Contractor shall, if requested by the BHEL Engineer in charge, furnish proof to the satisfaction of BHEL Engineer in charge that the materials so comply.



Mohit
23/12/23

3. The BHEL's Engineer in charge shall have full powers for removal of any or all of the materials brought to site by the Contractor which are not in accordance with the Contract specifications or do not conform in character or quality to samples approved by BHEL. In case of default on the part of the Contractor in removing rejected materials, the BHEL's Engineer in charge shall be at liberty to have them removed by other means. The BHEL's Engineer in charge shall have full powers to procure material, in accordance with the Contract specifications, to substitute rejected materials. In the event of the Contractor refusing to comply; BHEL reserves the right to substitute such rejected materials. All costs incurred by BHEL in removal / substitution of the rejected materials, shall be recovered from the dues of the Contractor.
4. Defect Liability period shall be 12 months from the date of actual completion of work and full security deposit will be retained till the completion of Defect Liability period. In case of any defects observed in the executed works under the defect liability period, the contractor will repair the defects to the satisfaction of BHEL without any extra charges. If contractor fails to remove the defects, the rectification work will be carried out by any outside agency and payment for the rectification work will be recovered from the dues of the contractor. Security deposit shall only be released after completion of defect liability period.
5. The warranty of individual equipment offered by the respective manufacturers shall be passed on to BHEL as it is, if it is more than the warranty period mentioned elsewhere. Supplier / Contractor to submit Original Warranty Certificates to BHEL from the Manufacturer.
6. After completion of the work in the building the contractor will remove all unwanted material/ rubbish from the site with no extra claim.
7. CARE OF BUILDINGS & STRUCTURES shall be taken by the contractor to avoid damage to the existing buildings / structures during execution of work. He shall be responsible for repairing all the damages and restoring the same to their original finish at his cost. He shall also remove at his costs all unwanted and waste materials arising out of his work from the site.
8. The entire work shall be carried out within 05 days from placement of order, failing which penalty shall be levied on the contractor.
9. BHEL looks forward to get excellent services from the successful bidder.
10. Water and Electricity shall be provided by BHEL free of cost for the work. The bidders should quote their prices accordingly.

D. GENERAL TERMS & CONDITIONS: -

1. Tender received late /in open condition/ not meeting the tender condition / incomplete in any respect is likely to be rejected.
2. BHEL will not be responsible for the postal delay under any circumstances for non-receipt of Tender by due date & time.
3. The Tender is required to quote for the complete scope of works. Tender for part scope of the works or incomplete in any respect is liable to be rejected.
4. Rates quoted by the bidder will be firm during the contract period. No price variation and escalation, due to any reason whatsoever, will be allowed.
5. The rates quoted by the bidder are deemed to be inclusive of all and any other incidental works required to complete the job and inclusive of all the taxes and duties except Goods and Service Tax which will be payable extra at applicable rate as per Price bid Format.
6. The rate should be indicated both in words and figures. All entries in the Tender must be written in ink or typewritten. Over-writing should be avoided. Corrections, if any, should be attested with signature by the bidder.
7. **EMD:** EMD is not applicable.

Mshub
23/12/23

8. **Security Deposit:** Security Deposit means the security provided by the Contractor towards fulfilment of any obligations in terms of the provisions of the contract. The total amount of Security Deposit will be 5% of the contract value.
Collection of Security: 100 % Security Deposit, shall be collected before release of payment after completion of work. If the value of work done at any time exceeds the contract value, the amount of Security Deposit shall be correspondingly enhanced and the additional Security Deposit shall be immediately deposited by the Contractor or recovered from payment/s due to the Contractor. Security Deposit shall be released to the Contractor upon fulfilment of contractual obligations as per terms of the contract. The Security Deposit shall not carry any interest.
9. **OFFER VALIDITY:** Validity of offer will be **10 days** from the date of opening of Tender.
10. **EVALUTION CRITERIA:** Evaluation of bid will be on total cost to 'BHEL' (i.e. at Total Package Price mentioned in Price Bid Including GST (₹)). The Percentage above or below (+/-) shall be used to arrive at rate for each item of Price Bid. The order will be placed subjected to the reasonability of rates. Order shall not be split.
11. **CORRECTION OF ARITHMETIC ERRORS:** Provided that the bid is substantially responsive, BHEL shall correct arithmetical errors on the following basis:
- If there is an error in a total corresponding to the addition or subtraction of subtotals, the subtotals shall prevail and the total shall be corrected.
 - If there is a discrepancy between words and figures, the amount in words shall prevail, unless the amount expressed in words is related to an arithmetic error, in which case the amount in figures shall prevail subject to (a) and (b) above.
 - If bidder does not accept the correction of errors, the bid is liable to be disqualified.
12. **L. D. Clause:** The successful tenderer has to complete the entire job within 05 days' time period from the date of placement of work order, failing which, the penalty will be imposed @ ½ % (i.e. 0.5 %) of contract value per day of delay. However, the total penalty due to delay will be up to maximum 10% of total contract value.
13. **CONTRACT PERIOD:** The entire works shall be completed within 05 days' time period from the date of work order. No extension of time will be permitted under the contract.
14. **Quantities:** Quantities may vary to ±5% to meet the design requirements. Payment shall however be made as per the actual measurement of the work executed.
15. **Price Variation Compensation:** No escalation in prices shall be permitted under the contract. The price shall remain firm during the currency of the contract.
16. **Extra Items:** No extra items shall be permitted under the contract. The bidder should quote their prices accordingly.
17. **Substituted Items:** Substituted items shall be permitted for execution on mutually agreed rates, with prior approval of BHEL.
18. **Insurance:** The successful bidder shall insure all the perils under the contract. Contractor should take Contractors All Risk (CAR) Insurance Policy for the currency of the contract. BHEL shall not be



liable to pay any compensation on account of the same.

19. **Safe execution of work:** The successful bidder shall take all precautions while executing the work, so that BHEL property is not damaged in any manner. In case of any damage to BHEL property due to the contractor / or the workforce deployed by him, the successful bidder shall repair and restore the same to its original position. In case, the successful bidder fails to repair and restore such damage, then the same shall be recovered from his dues.
20. **SUBLETTING:** The Contractor shall not sublet, transfer or assign full work to any other person/company/organization.
21. **Workforce:** All the workforce deployed at site under the contract should be covered by PF and ESI or BOCW.

22. **TAXES AND DUTIES:**

- To enable BHEL to avail GST input tax credit, contractor shall submit GST compliant Tax invoice containing all the particulars as stipulated under invoice Rules of GST Law. Payment shall be made to the contractor only after submission of GST complaint Tax invoice. The successful bidder shall raise GST compliant invoice affixing GSTIN of BHEL's unit availing the services.
- BHEL reserves the right to protect its interest against any loss on account of availability of GST credit.
- GSTIN of BHEL will be provided to the contractor along with the work order.
- Any new/ change in statutory levy as and when made applicable by the Government shall become applicable against documentary evidence.
- Payment to the contractor will be subjected to TDS as per rules in force from time to time. The Tax Deduction at Source (TDS) shall be done as per the provisions of Income Tax Act & GST, as amended from time to time and a certificate to this effect shall be provided to the contractor by BHEL.
- Invoice submitted should be in the format as specified under GST Laws viz. all details as mentioned in Invoice Rules like GSTIN registration number, invoice number, quantity, rate, value, taxes with nomenclature – CGST, SGST, IGST mentioned separately, HSN (Harmonized System of Nomenclature) Code/ SAC (Services Accounting Code) Code etc.
- The Contractor has to give an undertaking that GST as mentioned in the invoice has been/ will be paid and also file returns as per respective extant rule.
- Applicable GST shall also be recoverable from the contractor in case of LD recovery / penalty on account of breach of terms of the contract.

23. **PAYMENT TERMS:**

- Full and final payments shall be made to the contractor on satisfactory completion of entire job.
- No advance payment or the payment for mobilization of work will be made to the contractor.
- The contractor shall not be entitled to any interest with respect to any money which may be due to him from BHEL.
- All payment will be subject to deduction of taxes at source as per rules.
- Any tax incurred on purchase of materials by the contractor in respect of this contract shall be treated as included in the charges and BHEL will not entertain any additional claim whatsoever in this respect.

Mohit
23/12/23

- f) Bills raised by the Contractors shall be certified by the official in-charge of BHEL and the payments will be made against bill excluding GST portion, within 21 days by NEFT/RTGS from the date of receipt of bill complete in all respect.
24. All necessary precautions with respect to safety at site and environmental aspects and their impacts shall have to be taken by the contractor for activities performed by his workers.
25. In case of any dispute, the decision taken by BHEL Management will be final and binding on the contractor.
26. No party shall be permitted to tender for work in BHEL in which any of their near relatives is an employee connected with the award and execution of the contract. They shall also intimate the names of persons who are working with them in any capacity or subsequently employed by them and who are near relatives of any employee of the BHEL. Any violation of this condition which comes to the Notice of the BHEL after the work is awarded will entitle the BHEL to treat the contractors as having committed a breach of contract and to exercise all the rights and remedies available to the BHEL on account thereof.
27. The bidder along with its associate/ collaborators/ sub-contractors/ sub-vendors/ consultants/ Service providers shall strictly adhere to BHEL Fraud Prevention Policy displayed on BHEL website <http://www.bhel.com> and shall immediately bring to the notice of BHEL Management about any fraud or suspected fraud as soon as it comes to their notice.
28. **TERMINATION OF CONTRACT:** BHEL may terminate the contract by giving not less than 05 day's written notice of termination to the successful tenderer. If the successful tenderer does not remedy a failure in performance of their obligation under the contract, within 05 days after being notified.
29. **POST TECHNICAL AUDIT OF WORK AND BILLS:** BHEL reserves the right to carry out a post payment audit and technical examination of the work and final bill including all supporting vouchers, abstracts etc. and to enforce recovery of any sums becoming due as a result thereof in the manner provided into the proceeding sub-paragraph provided however, that no such recovery shall be enforced after three years of passing the final bill.
30. **ARBITRATION / CONCILIATION:**
In the event of any dispute arising between the parties hereafter referred as BHEL and Contractor in respect of or connected with this contract, General & Special terms & conditions of tender, then the same shall be referred to Arbitration and Arbitrator will be nominated by the Head of Administration of BHEL Corp. Office, New Delhi, whose decision shall be final and binding on both the parties. However, any differences or doubt pertaining to meaning/ interpretation of any phrase word used in terms or in the schedule of services, their nature and manner of rendering of such services shall be the excepted matter and be referred to the Head of Administration of BHEL Corp. Office, New Delhi, whose decision shall be the final and binding. The provisions of Arbitration and Conciliation Act, 1996 or any statutory modification and re-enactment thereof will apply to such arbitration provided however, in all matters the venue of proceedings will be Delhi and only Delhi or appropriate Courts will have jurisdiction over the same.
31. **BREACH OF CONTRACT AND TERMINATION:**
Following cases shall be considered as terms of breach of contract Contractor's poor progress of the work vis-à-vis execution timeline as stipulated in the Contract, backlog attributable to contractor

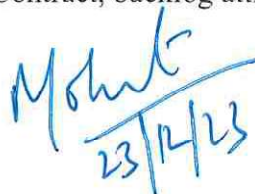

Mohit
23/12/23



including unexecuted portion of work does not appear to be executable within balance available period considering its performance of execution.

- i. Withdrawal from or abandonment of the work by contractor before completion of the work as per contract.
- ii. Non-completion of Work by the Contractor within scheduled completion period as per Contract or as extended from time to time, for the reasons attributable to the contractor.
- iii. Termination of Contract on account of any other reason (s) attributable to Contractor. If at any time the Contractor defaults in proceeding with the work with due diligence and continues to do so or commit any default in complying any of the tender terms and conditions even after the notice in writing is given, BHEL may, without prejudice to any other right to remedy which shall have accrued or shall accrue thereafter to BHEL, to terminate the contract by giving 15 days' notice in writing. The notice will be deemed to have been served as and when sent to the address given in the tender.
- iv. Assignment, transfer, subletting of Contract without BHEL's written permission resulting in termination of Contract or part thereof by BHEL. The Contractor is solely responsible to BHEL for the work awarded to him.

32. RECOVERY IN CASE OF BREACH OF CONTRACT

In case of breach of contract, 10% of the contract value shall be recovered from the contractor. The recovery shall be made from Security Deposit (if any)/ Retention Money (if any)/ available bills. In case 10% amount is not recovered from these instruments the balance amount shall be recovered from the bills available under any other contract with BHEL unit(s)/Division(s). Further, levy of liquidated damages, debarment, termination, de-scoping, short-closure etc., shall be applied as per provisions of contract.

For & on behalf of "BHEL"

(Mohit Arora)

Manager (NBP)

ANNEXURE: A
Price Bid Format

Name of Work: Works of Internal Branding of Entrance Lobby and Associated Interior Works in BHEL- New Building Campus, Plot No. - 25, Sector- 16A, Film City, Noida.

SN	Location	Item Description	Unit	Qty.	Unit rate (in Rs., excl. GST)	Amount (in Rs., excl. GST)
1	Information Desk	Providing, Cutting, Fixing of Hybrid Teak wooden Louvers with melamine polish finish, panel length 2400 mm, thickness 19 mm approx., louver size 40 mm x 15 mm approx., on Aluminium & 12 mm BWR ply frame (including supply of the frame), as approved by BHEL.	SQM	32	8,800.00	281,600
2		Providing and fixing of 12 mm thick Non-Bendable Corian sheet (back wall) pasted on 12mm thick BWR ply, fixed on Aluminium frame, consisting of three layers extruded by 3 inch, 6 inch and 9 inch, thickness of back wall ranging from 1 inch to 14.5 inch approx., as approved by BHEL.	SQM	17.5	8,750.00	153,125
3		Providing and fixing of 12 mm thick Non-Bendable Corian sheet (ceiling) pasted on 12mm thick BWR ply, fixed on GI frame, as approved by BHEL.	SQM	15.5	8,750.00	135,625
4		Providing and fixing of 10 mm thick cast acrylic sheet (back wall) fixed on 12 mm thick BWR ply, fixed on Aluminium frame, thickness of back wall 75 mm approx., as approved by BHEL.	SQM	5	9,500.00	47,500
5		Providing and fixing of 10 mm thick cast acrylic sheet (sidewall) fixed on 12 mm thick BWR ply, fixed on Aluminium frame, extruded by 75 mm approx. from louvers, thickness of sidewall 110 mm approx., as approved by BHEL.	SQM	15.5	9,500.00	147,250
6		Providing & Fixing of the BHEL Logo signage letters made in 304 Grade brushed finished stainless steel sheet with laser cutting for accurate shaping and 50-75mm depth of the letter with the same stainless steel sheet. Signage would be edge light using of 3000k Samsung/GOQ LED's with water proof power supply IP67 Grade and installation of Reception backside wall using of SS studs with paper stencil for proper alignment, design as approved by BHEL.	Nos.	1	65,000.00	65,000

7		Supply & fixing of Decorative range Ring Shape Suspended luminaire of 600mm. Dia. made of extruded aluminium with Fully Covered Opal optical diffuser, LED Used shall be SMD type. Fixture should have minimum efficacy at System level (Not Chip Level) >100lumens/watt and a minimum system lumen output of 4000 lumens and maximum system wattage of 40W. Luminaire should have Life of 50,000hrs @ L70 Lumen maintenance, CCTof 4000K / 6500K, CRI >80, PF >0.95, THD<10% and an operating Voltage Range of 160 - 270 Internal Surge Protection 2.5KV. Product dimension : Ø600mm, H-60mm ,[Make: Phillips / Trilux / Osram or equivalent]	Each	2	30,000.00	60,000
8		Supply & fixing of Information Signage made in 4-6mm thick cast acrylic sheet with laser cutting for accurate shaping, fixed with 3M Grey back dual sided tape on blue color acrylic sheet, as approved by BHEL.	Each	1	35,000.00	35,000
9		Supply & fixing of Directory Text Signage made in 4-6mm thick cast acrylic sheet with laser cutting for accurate shaping, fixed with 3M Grey back dual sided tape on blue color acrylic sheet, as approved by BHEL.	Each	9	4,500.00	40,500
10		Supply of Information Desk of size 4m x 1m x 0.6 m made with 18mm thick BWR plywood, top & front finishing with Corian sheet of 6 mm thick, 5 lockable shelf. Edge lighting effect, as approved by BHEL.	Nos.	1	2,00,000.00	2,00,000
11		Supply and fixing of Strip light with LED modules fixed in U shaped Aluminium profile 20 mm x 50 mm x 20 mm approx. with Acrylic sheet diffuser (Make: Samsung / Phillips / Osram / Bajaj or equivalent)	RMT	30	2,863.00	85,890
12		Wiring for light point/fan point/exhaust fan point/call bell point with 1.5 sqmm FRLS PVC insulated copper conductor single core cable in surface / recessed steel conduit, with modular switch, modular plate, suitable G.I. box and earthing the point with 1.5 sqmm FRLS PVC insulated copper conductor single core cable etc. as required.	Points	20	1500.00	30,000
		Group C				
13	Left of Reception Wall	Providing, Cutting, Fixing of Hybrid Teak wooden Louvers with melamine polish finish, panel length 2400 mm, thickness 19 mm approx., louver size 40 mm x 15 mm approx. on Aluminium & 12 mm BWR ply frame (including supply of the frame), extruded by 60 mm approx. from the Corian sheet, total thickness of the wall 120 mm approx., as approved by BHEL	SQM	7	8,800.00	61,600
14		Providing and fixing of 12 mm thick non-Bendable Corian sheet pasted on 12 mm thick BWR ply, fixed on Aluminium frame, as approved by BHEL.	SQM	20	8,750.00	175,000



15		Providing and fixing of 10 mm thick cast Acrylic sheet fixed on 12 mm thick BWR ply, as approved by BHEL.	SQM	5	9,500.00	47,500
16		Supply and fixing of Strip light with LED modules fixed in U shaped Aluminium profile 20 mm x 50 mm x 20 mm approx. with Acrylic sheet diffuser (Make: Samsung / Phillips / Osram / Bajaj or equivalent)	RMT	30	2,863.00	85,890
17		Providing & Fixing of the Edge lit clip-on signage made in Aluminium profile with silver powder coated. 25mm face thickness frame and HP latex machine print on translight media and front covering with 2mm clear acrylic sheet with power supply ISI marked IP67 Grade, as approved by BHEL	SQM	2.5	8,000.00	20,000
18		Supply Installation Testing & Commissioning of 75" 4K UHD(3840 X 2160) resolution Professional Display (Commercial / Industrial Grade) Android / Google / TaiChi LED display with built in 2.4 Ghz Wi-Fi, 1.1 Ghz Built in Quad core processor, 2 GB DDR3 RAM, 16 GB Memory, built in Double Core Mali 600 MHz GPU, with HDR 10, Dolby Audio, Built in Wi-Fi and Chromecast, Built in web browser, HDMI CEC, HDMI ARC, Built-in Bluetooth Ver.4, 20W built in speakers, HDMI 2.0 X 3, AV X 1, USB 2.0 X 1, RJ45 X 1, Headphone Out x 1, SPDIF Out x 1 [Make: Samsung / LG / Panasonic / Sansui or equivalent].	NO	1	1,29,084.75	1,29,084.75
19		Wiring for light point/fan point/exhaust fan point/call bell point with 1.5 sqmm FRLS PVC insulated copper conductor single core cable in surface / recessed steel conduit, with modular switch, modular plate, suitable G.I. box and earthing the point with 1.5 sqmm FRLS PVC insulated copper conductor single core cable etc. as required.	Points	10	1500.00	15,000
		Group C				
20		Providing, Cutting, Fixing of Hybrid Teak wooden Louvers with melamine polish finish, panel length 2400 mm, thickness 19 mm approx., louver size 40 mm x 15 mm approx., on Aluminium & 12 mm BWR ply frame (including supply of the frame), as approved by BHEL	SQM	7	8,800.00	61,600
21	Timeline Wall (Right of Reception Wall)	Providing and fixing of 1mm thick Laminate pasted on 12mm+12mm BWR Ply, fixed on GI frame, thickness of wall 75 mm approx., as approved by BHEL.	SQM	20.5	3,500.00	71,750
22		Providing, fixing, melamine polishing of Showcase (Wooden Boxing) made with 19mm thick rubber wood board etc. all complete, as approved by BHEL.	SQM	3	3,500.00	10,500
23		Providing & Fixing of the Edge lit clip-on signage made in Aluminium profile with silver powder coated. 25mm face thickness frame and HP latex machine print on translight media and front covering with	SQM	2.5	8,000.00	20,000

Mohit
23/12/23

		2mm clear acrylic sheet with power supply ISI marked IP67 Grade, as approved by BHEL.				
24		Timeline Signage boxes made of 18 mm BWR ply of size 0.4 m x 0.4 m (8 Boxes) with veneer finish and letters made with 12mm rubber wood will be pasted with melamine polish finish.	No.	1	50,000.00	50,000
25		Nonlit Acrylic Box made in 3mm thick astariglas acrylic sheet with laser cutting for accurate shape and 50mm depth of the box with the same acrylic sheet & installation on site, design as approved by BHEL.	SQFT	46	1,100.00	50,600
26		Supply and fixing of Strip light with LED modules fixed in U shaped Aluminium profile 20 mm x 50 mm x 20 mm approx. with Acrylic sheet diffuser (Make: Samsung / Phillips / Osram / Bajaj or equivalent)	RMT	30	2,863.00	85,890
27		Wiring for light point/fan point/exhaust fan point/call bell point with 1.5 sqmm FRLS PVC insulated copper conductor single core cable in surface / recessed steel conduit, with modular switch, modular plate, suitable G.I. box and earthing the point with 1.5 sqmm FRLS PVC insulated copper conductor single core cable etc. as required.	Points	25	1500.00	37,500
		Group C				
28	Front Facia	Providing, Cutting, Fixing of Hybrid Teak wooden Louvers with melamine polish finish, panel length 2400 mm, thickness 19 mm approx., louver size 40 mm x 15 mm approx., on 12 mm BWR ply frame (including supply of the frame), as approved by BHEL.	SQM	5	8,800.00	44,000
29		Providing & Fixing of High resolution one way vision on 300 gsm flex, as approved by BHEL.	SQFT	224	224.25	50232
30	Side Walls (Left & Right)	Providing, Cutting, Fixing of Hybrid Teak wooden Louvers with melamine polish finish, panel length 2400 mm, thickness 19 mm approx., louver size 40 mm x 15 mm approx., on GI & 12 mm BWR ply frame (including supply of the frame), as approved by BHEL.	SQM	30	8,800.00	264,000
31		Supply and fixing of Natural Vertical Garden Wall Panel fixed on MS frame, MS frame shall have 2 Coats of Primer and 2 Coats of Duco paint, as approved by BHEL.	SQFT	270	800.00	216000
32	Centre Pillars (2 Nos.)	Providing, Cutting, Fixing of Hybrid Teak wooden Louvers with melamine polish finish, panel length 2400 mm, thickness 19 mm approx., louver size 40 mm x 15 mm approx., on GI & 12 mm BWR ply frame (including supply of the frame), as approved by BHEL.	SQM	90	8,800.00	792,000
33		Providing and fixing of 12 mm thick Non-Bendable Corian sheet pasted on existing 12mm thick BWR ply, as approved by BHEL.	SQM	10	8,500.00	85,000



34		Supply Installation Testing & Commissioning of 65" 4K UHD(3840 X 2160) resolution Professional Display (Commercial / Industrial Grade) Android / Google / TaiChi LED display with built in 2.4 Ghz Wi-Fi, 1.1 Ghz Built in Quad core processor, 2 GB DDR3 RAM, 16 GB Memory, built in Double Core Mali 600 MHz GPU, with HDR 10, Dolby Audio, Built in Wi-Fi and Chromecast, Built in web browser, HDMI CEC, HDMI ARC, Built-in Bluetooth Ver.4, 20W built in speakers, HDMI 2.0 X 3, AV X 1, USB 2.0 X 1, RJ45 X 1, Headphone Out x 1, SPDIF Out x 1 [Make: Samsung / LG / Panasonic / Sansui or equivalent]	NO	8	70,508.47	5,64,067.76
35		Supply and fixing of ultra slim manual push pull TV wall Mount [Make: Lumi or equivalent]	Nos.	8	6,500.00	52,000
36		Wiring for circuit / sub main wiring along with earth wire with the following sizes of FRLS PVC insulated, copper conductor single core cable in surface/ recessed steel conduit as required. 2x2.5 + 1x2.5	Metre	100	323.91	32391
37	Pillar Right of Centre Pillars (1 No.), Pillar Left of Centre Pillars (1 No.)	Providing, Cutting, Fixing of Hybrid Teak wooden Louvers with melamine polish finish, panel length 2400 mm, thickness 19 mm approx., louver size 40 mm x 15 mm approx., on GI & 12 mm BWR ply frame (including supply of the frame), as approved by BHEL	SQM	35	8,800.00	308,000
38		Supply and fixing of Natural Vertical Garden Wall Panel fixed on MS frame, MS frame shall have 2 Coats of Primer and 2 Coats of Duco paint, as approved by BHEL.	SQFT	288	800.00	230400
39	Pillar Right of corner Pillars (1 No.), Pillar Left of corner Pillars (1 No.)	Supply and fixing of Natural Vertical Garden Wall Panel fixed on MS frame, MS frame shall have 2 Coats of Primer and 2 Coats of Duco paint, as approved by BHEL.	SQFT	108	800.00	86400

Mahul
23/12/23



40	General	Supply & fixing of Aluminium Scaffolding of following specifications : Platform Height - 6.1 m, Tower Height - 7.1 m, Working Height - 8.1 m, Platform Dimensions - 1.32 x 1.8 m. The scaffolding to have staircase system for working platform and maintaining it in a serviceable condition for the required duration as approved and removing it thereafter. The scaffolding shall have castor wheels so as to take it wherever required for carrying out work at different locations with essential safety features for the workmen etc., complete as approved by BHEL.	NO	4	12,937.50	51,750
Total Amount excl. GST (in Rs.) - A						49,79,645.51
Percentage (To be quoted) Above (+) / Below (-) / at par with S. No. A above - B						
Total Quoted Amount after applying percentage (S. No. B) excluding GST in Rs. - C						
Applicable GST in %. on C						
GST Amount as per %age above						
Total Amount inclusive of GST in Rs.						
Gross Total Price in Words incl. GST: Rupees						

Note:

1. Bidders have to quote only a single overall percentage, (+) above, (-) below or at par with the tender rates at S. No. B of Price Bid format.
2. The same quoted percentage will be applied on every item of the Price Bid.
3. Any deviation by means of changing the estimated rate of an individual item or modification of quantity to be supplied will be treated as non-acceptance of tender terms and bid will be rejected.

Mahesh
23/12/23



ANNEXURE: B

DECLARATION

I / We, do hereby declare that I/We have not been suspended / delisted / blacklisted by any other Govt. Ministry / Department/Public Sector Undertaking/ Autonomous Body/Financial institution/Court. We also certify that either our firm or any of the partners are not involved in any scam or disciplinary proceedings settled or pending adjudication.

(Signature & seal of the Bidder)

Place:

Date:

Mohit
23/12/23



ANNEXURE: C

NO DEVIATION CERTIFICATE

Notwithstanding anything mentioned in our bid, we hereby accept all the terms and conditions of the above tender and there is no deviation in the terms & conditions of tender. We confirm that the offer submitted by is confirming to all the terms and conditions mentioned in the tender document. We hereby undertake and confirm that we have understood the scope of services properly and shall carry out the job as mentioned in this tender.

(Signature & seal of the Bidder)

Mohit
23/12/23

**ANNEXURE: D****BIDDER'S DETAILS**

Name of the Contractor /Party/ Firm	
Name of Representative	
Postal Address	
Phone/ Landline Nos.	
Mobile Nos.	
PAN No.	
GSTIN No.	
PF Registration No.	
ESI Registration No.	
Fax No.	
E-Mail Address	
Web Site Address (If Any)	
Bank details for payment through NEFT/RTGS and for release of EMD*	Name of Bank: Branch: Account No.: IFSC No.: MICR No.:

Note: Submit a cancelled cheque for verification of above bank details.

(Signature & seal of the Bidder)

Mohit
23/12/23

**ANNEXURE: E****MAKE IN INDIA FORMAT****(To be filled by the Participating Bidders)****BHARAT HEAVY ELECTRICALS LIMITED**

For this Procurement / Works, Government of India Public Procurement (Preference to Make in India), Order 2017 with its amendments and subsequent Orders issued by the respective nodal ministries shall be applicable even if issued after issue of this NIT but before finalization of contract/WO against this NIT.

As per the Provisions of this order, please submit a self-certification complying with the conditions below on company letterhead duly signed by competent authority.

I, hereby declare on behalf of M/s. that we are participating in the Enquiry No. floated by BHEL, Noida (UP), India and shall comply with following:

1. Public Procurement (Preference to Make in India), Order 2017 with its amendments and subsequent Orders issued by the respective nodal ministries shall be applicable even if issued after issue of this NIT but before finalization of contract/WO against this NIT.

(a) A supplier will be treated as "Class-I Local Suppliers", if the items quoted by bidder have local content equal to or more than 50%.

(b) 'Local Content' means the amount of value added in India, which shall be total value of item quoted (excluding net domestic indirect taxes) minus the value of imported content in the item (including all custom duties) as a proportion of the total value, in percent.

2. I hereby declare that our firm qualifies as "Class-I Local Suppliers".

a. The Local Content in the items quoted under this Enquiry is Percent.

b. Details of location(s) in India where this value addition shall be done, is/are as follows:

(a)

(b)

(c)

(.....)

M. Shankar
23/12/23

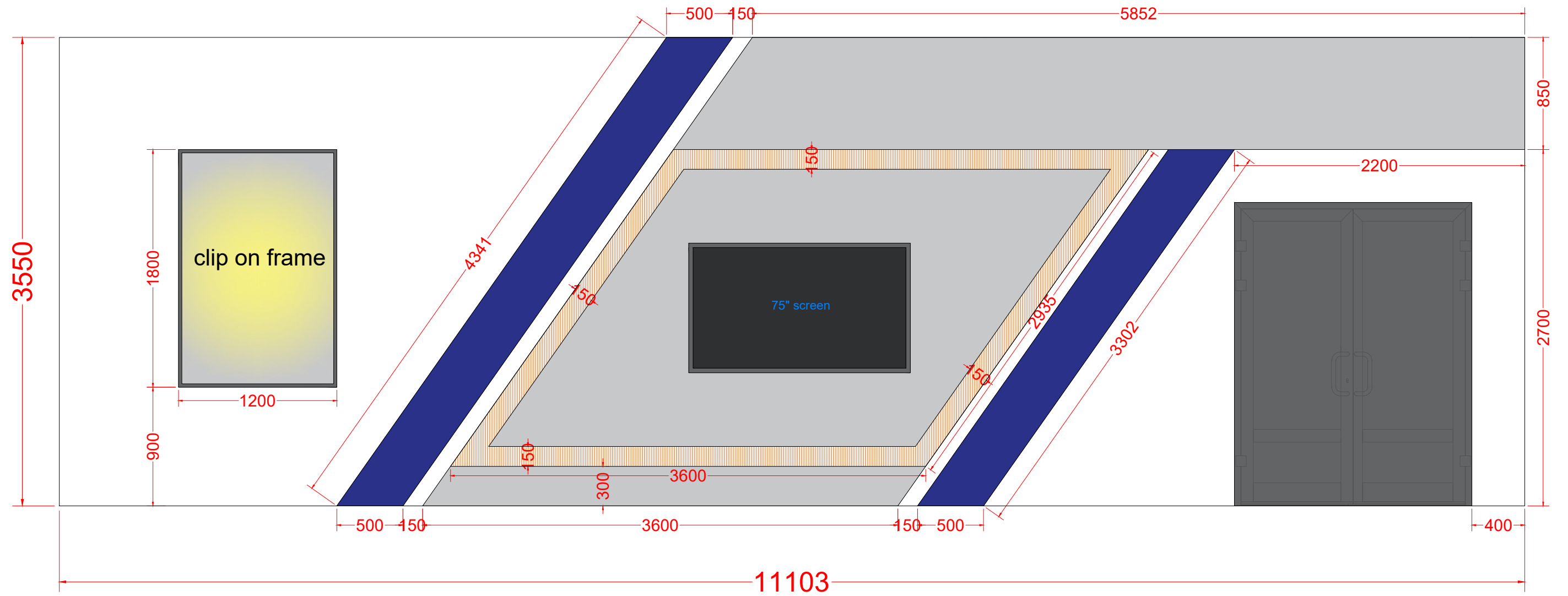

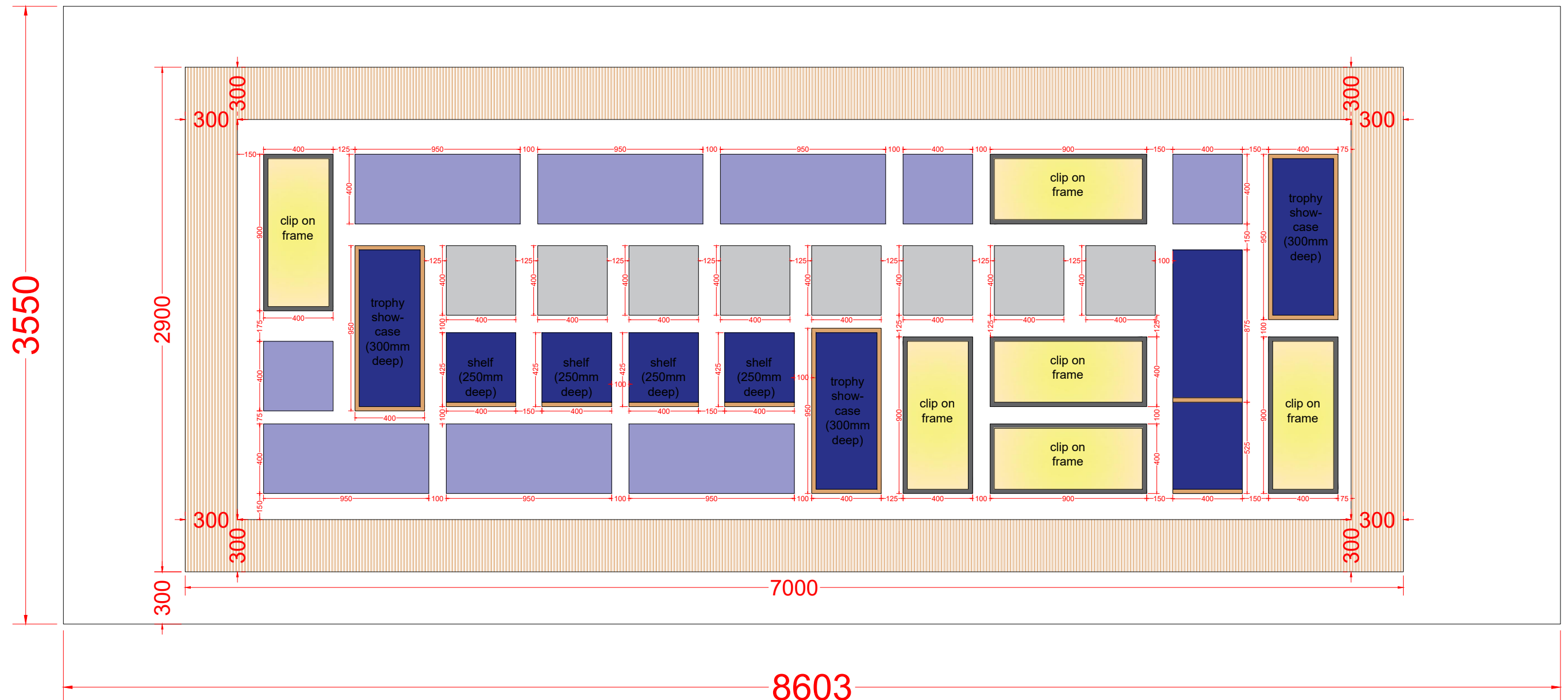

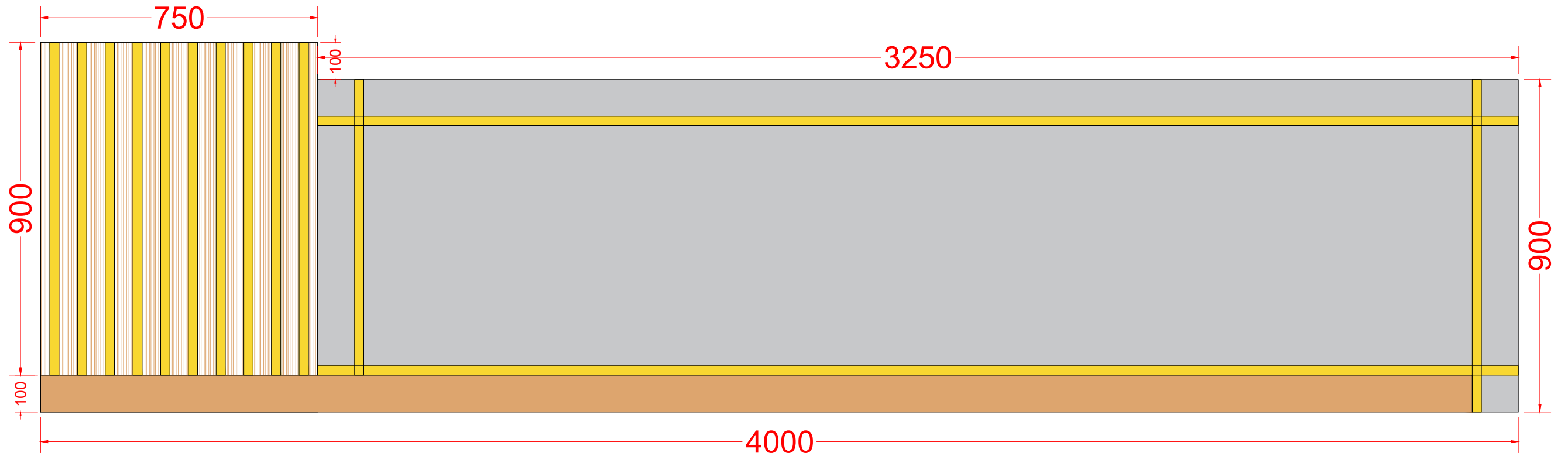

FRONT ELEVATION

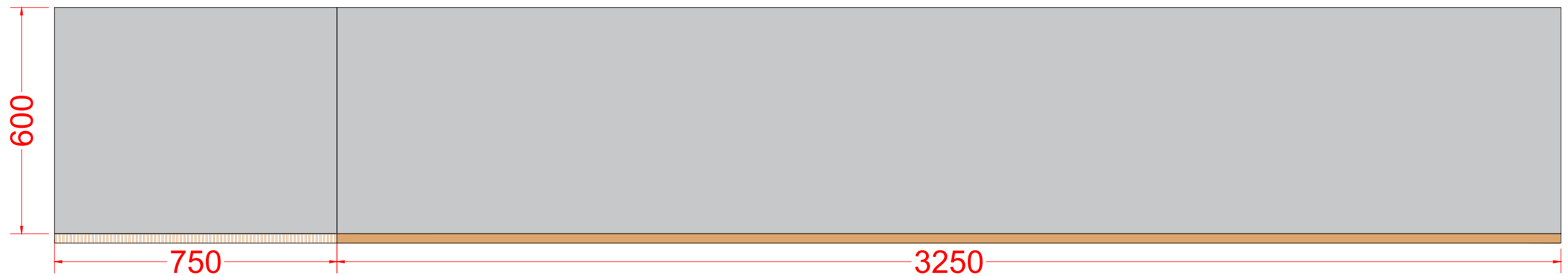

PLAN

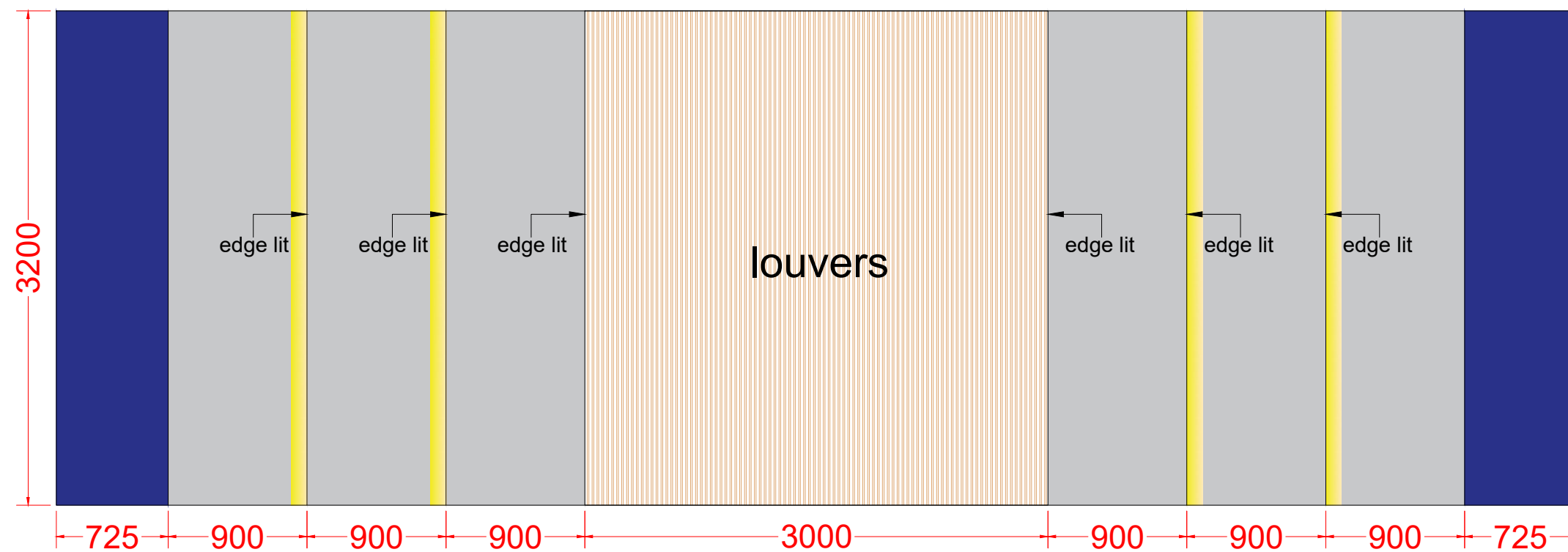

RECEPTION BACK WALL

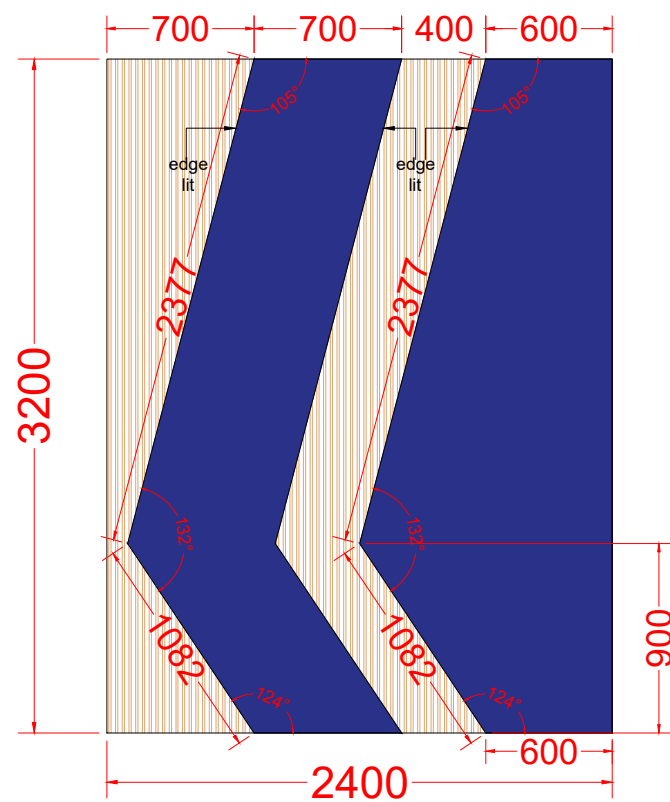

RECEPTION LEFT SIDE WALL

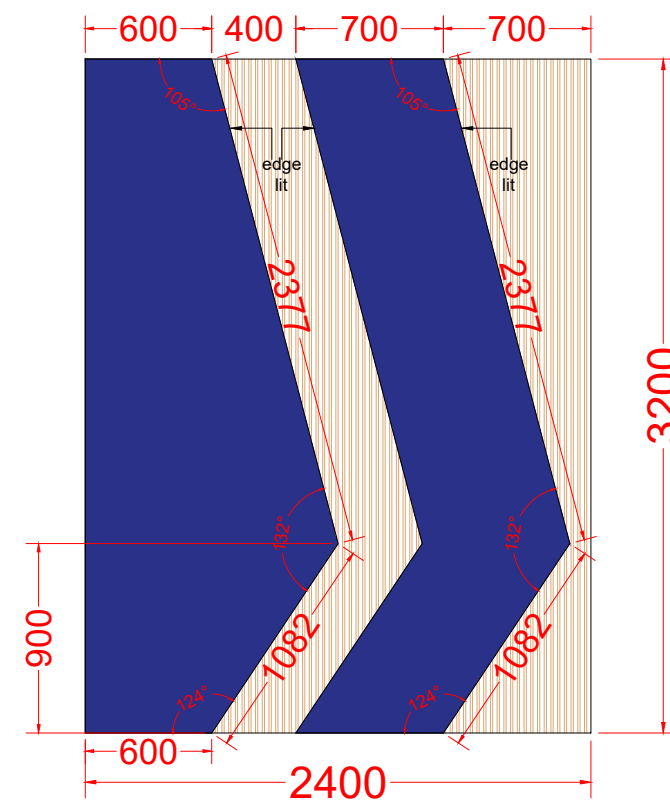

RECEPTION RIGHT SIDE WALL

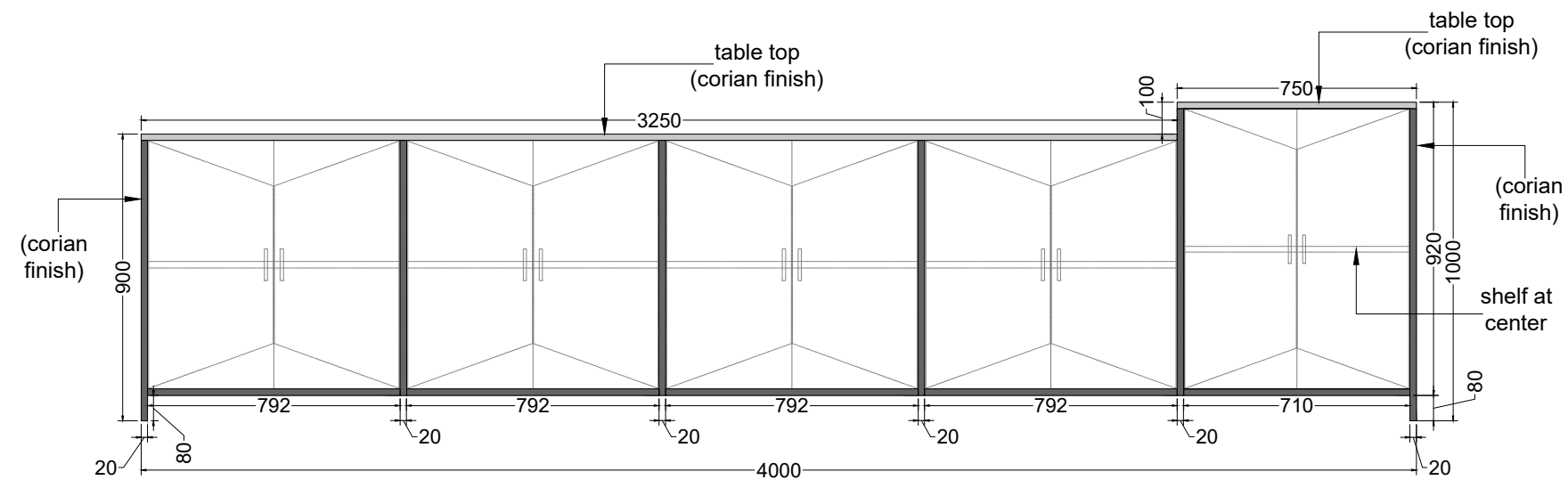

BACK ELEVATION

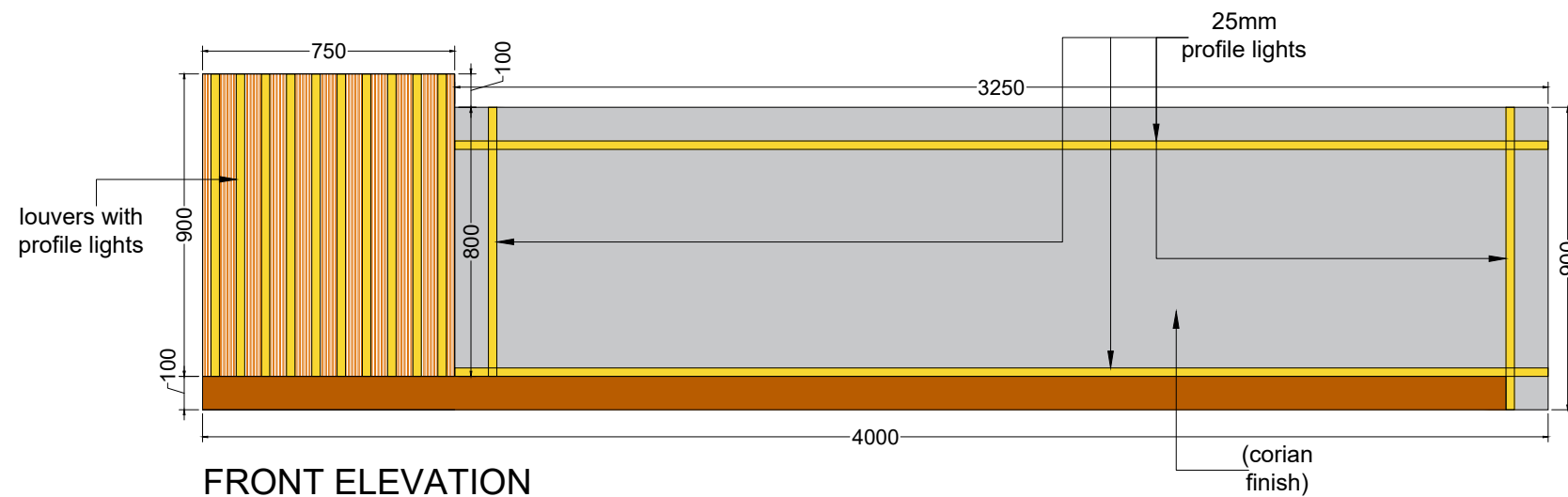

FRONT ELEVATION

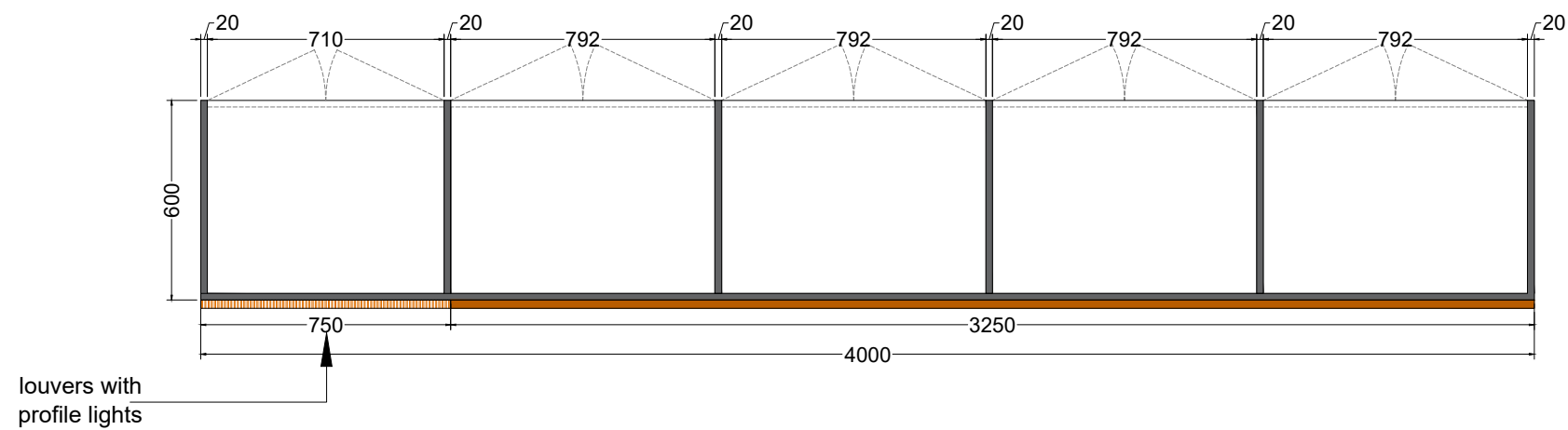

SECTIONAL PLAN

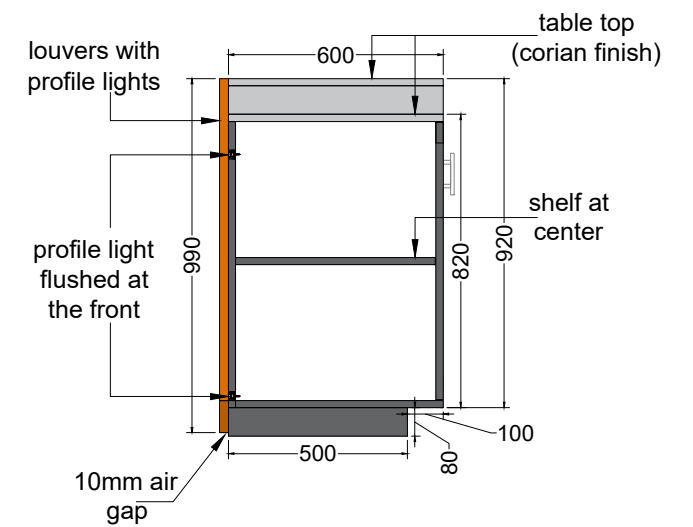

SECTIONAL SIDE ELEVATION