

TCN – 01 Dated 30-10-2006

SUB: Issuance of TCN-01

Job : DESIGN, MANUFACTURING, SUPPLY & ERECTION OF ONE NUMBER OF COVERED STORAGE SHED (PRE-FABRICATED STEEL SHED) INCLUDING CIVIL & ELECTRICAL WORKS, FOR 1X20 MW, HALDIA , PHAE-II , WEST BENGAL.

Ref: Tender no. PSER:SCT:HLD-C699:06 dtd. 28/09/2006

Please refer Volume-II, section-I , SCOPE OF WORK (Electrical portion, point no. C) of tender document (Page 2 to 7 of 35). The scope is revised now. Revised/amended description of electrical portion shall be as follows (this will supercede original scope given in tender).

C) All External & Internal Electrification works including:

I. Internal Electrical works for 1 no. store shed as per enclosed drawing:

SL N O	DESCRIPTION OF ITEM	QNT Y	UNI T
1	Supply, termination, testing & commissioning of 3.5 core 50 sqmm PVC, Armoured Aluminium cable of 1.1 KV grade. As per IS-1554	100	RM
1. a	Supply, Laying above ground on wall/surface with clamps etc., chase cutting on wall/floor, mending good damages, testing & commissioning of 3.5 core 50 sqmm PVC, Aluminium cable of 1.1 KV grade.	20	RM
1. b	Supply, Laying below ground in excavated trench average depth 800 mm with 8 nos. of brick on top of the cable per meter including filling the space between brick & cable and also the trench with shifted soil levelling and restoring the surface duly rammed & compacted.	80	RM
2	Supply, termination, testing & commissioning of 4 core 16 sqmm PVC, Armoured Copper cable of 1.1 KV grade. As per IS-1554	70	RM
2. a	Supply, Laying above ground on wall/surface with clamps etc., chase cutting on wall/floor, mending good damages, testing & commissioning of 3.5 core 50 sqmm PVC, Aluminium cable of 1.1 KV grade.	20	RM
2. b	Supply, Laying below ground in excavated trench average depth 800 mm with 8 nos. of brick on top of the cable per meter including filling the space between brick & cable and also the trench with shifted soil levelling and restoring the surface duly rammed & compacted.	50	RM
3	End termination with double compression gland and lugs (supply of lugs and glands included in bidders		

	scope).		
	i) Gland suitable for 3.5CX50sqmm	2	nos.
	ii) Gland suitable for 4CX16sqmm	4	nos.
	iii) 50sqmm ring type Lugs (Al)	8	nos.
	iv) 25sqmm ring type Lugs (Al)	4	nos.
	v) 16sqmm ring type Lugs (Cu)	8	nos.
	vi) 10sqmm ring type Lugs (Cu)	8	nos.
	vii) 6sqmm ring Lugs(Cu)	10	nos.
	viii) 4sqmm ring Lugs(Cu)	8	nos.
	ix) 2.5sqmm flat lugs(Cu)	20	nos.
4	Supply & fixing of Iron Clad Main Switches TPN/DP on angle iron frame on wall - 250A TPN	1	no.
5	End termination with following lugs (supply of lugs included in bidders scope).		
	i) 10sqmm ring type Lugs (Cu)	8	nos.
	ii) 6sqmm ring Lugs(Cu)	10	nos.
	iii) 4sqmm ring Lugs(Cu)	8	nos.
	iv) 2.5sqmm flat lugs(Cu)	20	nos.
6	SETC (Supply, Erection, Testing & Commissioning) & fixing of sheet metal (16SWG) iron clad DB with earthing attachments consisting of 1no. 4 pole 200A MCCB, 4 nos. Al bars (25mm x 5mm x 100mm) with holes suitable for 50 sqmm and 4 nos. Al bars (25mm x 5mm x 100mm) with adequate nos. of holes drilled for connection of incoming & outgoing ckts, bars are fixed on porcelain insulators. DB erection on angle Iron frame on wall with adequate nos of holes to be drilled for connection of incoming & outgoing ckts, including required hardwares for connection, fitted with DANGER board all complete.DB shall be spray painted with synthetic enamel of minimum thickness 80 microns or Electrostatic or powder painted.	1	no.
7	SETC (Supply, Erection, Testing & Commissioning) & fixing of sheet metal (16SWG) iron clad DB with earthing attachments consisting of 1no. 4 pole 100A MCCB, 2 nos. 50A MCCB, 1 no. 40A MCCB, 1 no. 20A MCCB, 1 no. 16A MCCB, 4 nos. Al bars (25mm x 5mm x 100mm) with holes suitable for 16 sqmm and 1 no. Al bar (25mm x 5mm x 150mm) for Neutral. DB erection on angle Iron frame on wall with adequate nos of holes to be drilled for connection of incoming & outgoing ckts, including required hardwares for connection, fitted with DANGER board all complete.DB shall be spray painted	1	no.

	with synthetic enamel of minimum thickness 80 microns or Electrostatic or powder painted.		
8	SETC (Supply, Erection, Testing & Commissioning) & fixing of sheet metal (16SWG) iron clad DB with earthing attachments consisting of 1no. 4 pole 100A MCCB, 2 nos. 50A MCCB, 1 no. 20A MCCB, 1 no. 16A MCCB and 4 nos. Al bars (25mm x 5mm x 100mm) with holes suitable for 16 sqmm . DB erection on angle Iron frame on wall with adequate nos of holes to be drilled for connection of incoming & outgoing ckts, including required hardware for connection, fitted with DANGER board all complete. DB shall be spray painted with synthetic enamel of minimum thickness 80 microns or Electrostatic or powder painted.	1	nos.
9	Supply and fixing of 8"X10" wooden Switch board with matching bakelite cover with 5 nos. switch cut out and interconnection.	2	nos.
10	Supply and fixing of 4"X6" wooden Switch board with matching bakelite cover with 1 no. switch cut out and interconnection.	5	nos.
11	Supply and fixing of 4"X6" wooden Junction box with matching bakelite cover and interconnection.	21	nos.
12	Supply and fixing 5A piano key type switch. ANCHOR/NORTH-EAST	15	nos.
13	Supply and fixing 15A piano key type switch. ANCHOR/NORTH-EAST	8	nos.
14	Supplying & installation of 3 KW starter(HAVEL/SIEMENS/EE) for 3KW resistive load	6	nos.
15	Supply & fixing of Ceiling Rose on circular boxes.	30	nos.
16	SETC of Indoor type luminaries 1x150 W medium bay industrial type, Model BJMBI-150SV of BAJAJ or equivalent of PHILIPS/CROMPTON.	20	nos.
17	Supply, Fixing from roof truss with suitable clamp arrangement, flexible wire for connection between ceiling rose & fitting and commissioning of type HPSV luminaries medium bay industrial type, Model BJMBI-150SV of BAJAJ or equivalent of PHILIPS/CROMPTON.	20	nos.
18	Supply, fixing of Outdoor luminaries type 1x70 W HPSV lamps in cast aluminium body with acrylic cover along with lamps, control gear, etc. Including all fixing/supporting accessories complete. Model:- BJMSC-70SV of BAJAJ or equivalent of PHILIPS/CROMPTON	11	nos.
19	Supply, Fixing on wall with 40 mm dia swan neck GI pipe with suitable clamps etc. & commissioning of outdoor luminaries suitable for 1x70 W HPSV lamps in cast aluminium body with acrylic cover along with lamps. Including all fixing/supporting accessories complete and flexible wire for connection between	11	nos.

	ceiling rose & fitting.		
20	Supplying, installation, testing & commissioning of 1.5 Ton A/C with ON-OFF starter(HAVEL/SIEMENS/EE) with all accessories in one store. A/C MAKE: LG/SAMSUNG/CARRIER/VOLTAS	1	nos.
21	Supply, drawing through conduit, termination, testing & commissioning of 1 core 2.5 sqmm PVC insulated, stranded Copper wire of 1.1 KV grade.	700	RM
22	Supply, drawing through conduit, termination, testing & commissioning of 1 core 4 sqmm PVC insulated, stranded Copper wire of 1.1 KV grade.	550	RM
23	Supply, drawing through conduit, termination, testing & commissioning of 1 core 6 sqmm PVC insulated, stranded Copper wire of 1.1 KV grade.	70	RM
24	Supply, termination, testing & commissioning of 2.5 sqmm flexible wire of 1.1 KV grade.	130	RM
25	Supply and fixing of 1" dia rigid PVC conduit with all bends tees circular box clamps, saddles etc. along with the accessories in surface/recess in beam/roof slab/wall including chase cutting the wall/above false ceiling and making good the same as required	400	RM
26	Supply and fixing of 1/2" dia rigid PVC conduit with all bends tees circular box clamps, saddles etc.along with the accessories in surface/recess in beam/roof slab/wall including chase cutting the wall/above false ceiling and making good the same as required	300	RM
27	Supply and fixing of 1/2" dia flexible PVC conduit with all bends tees circular box clamps, saddles etc. along with the accessories in surface/recess in beam/roof slab/wall including chase cutting the wall/above false ceiling and making good the same as required	130	RM
28	Supply and fixing of 1" dia flexible PVC conduit with all bends tees circular box clamps, saddles etc. along with the accessories in surface/recess in beam/roof slab/wall including chase cutting the wall/above false ceiling and making good the same as required	30	RM
29	Supply of 1/2" PVC conduit glands	8	nos.
30	Supply of 1" PVC conduit glands	10	nos.
31	SETC & Installation of earth electrode 40 mm dia. 3 metre long GI pipe directly driven into earth including earth excavation if required.	2	nos.
32	SETC & installation of 16 SWG GI wire for earthing. Including Supply & termination with Lugs as required.	400	RM
33	SETC & installation of 8 SWG GI wire for earthing. Including Supply & termination with Lugs as required.	25	RM

LIST OF APPROVED MAKES OTHER THAN THOSE SPECIFICALLY MENTIONED ABOVE:

1. SINGLE CORE STRANDED Cu WIRE PVC INSULATED - FINOLEX/EVERSHINE KDK/ANCHOR
2. MCB/MCCB WITH BOX - SIEMENS/STANDARD/MDS/HAVEL/GE
3. RIGID PVC CONDUIT - PLAZA/PLICA/PIONEER MARKED AS PER IS-9537
4. FLEXIBLE PVC CONDUIT - PLAZA/PLICA/PIONEER
5. PVC CONDUIT GLAND - PLAZA/PLICA/PIONEER
6. IRON CLAD TPN/DP MAIN SWITCH - SURYA/FLORA/STANDARD/L&T
7. DISTRIBUTION FUSE BOARD - STANDARD/HAVEL/ASIATIC ELECTRIC
8. ELECTRONIC REGULATOR - RIDER/ANCHOR OR ISI APPROVED
9. POWER CABLE - NICCO/INCAB/GLOSTER/CRYSTAL/FINOLEX.
10. LUGS -DOWEL/UML
11. GLAND - COMMET/SUNIL&CO.

- Two nos. revised drawings of shed is enclosed with This TCN-01, which will form a part of tender document. Bidders should submit signed copy of this drawing.
- These clarifications (TCN-01) will form a part of the tender document and should be submitted (duly signed) along with bid as specified. Quoted price of bidders will be presumed on the basis of original tender & these clarifications (TCN-01).
- Based on clarifications furnished above, all the bidders are requested to submit their offer without any deviation, within stipulated time i.e. by **02-11-2006 (Receipt date), 15:00 Hrs.** No further queries/clarifications from bidders against this tender , shall be entertained.
- All the clauses of original tender document, which are not mentioned/covered in above clarifications (TCN-01), will remain unchanged. All other queries raised by bidders shall not be taken into consideration.

(Manager/SCT)

Enclosure : [2 no. drawings](#)

B. Wall 10"
TH.
up to 1/2
height
above
Plinth Level.

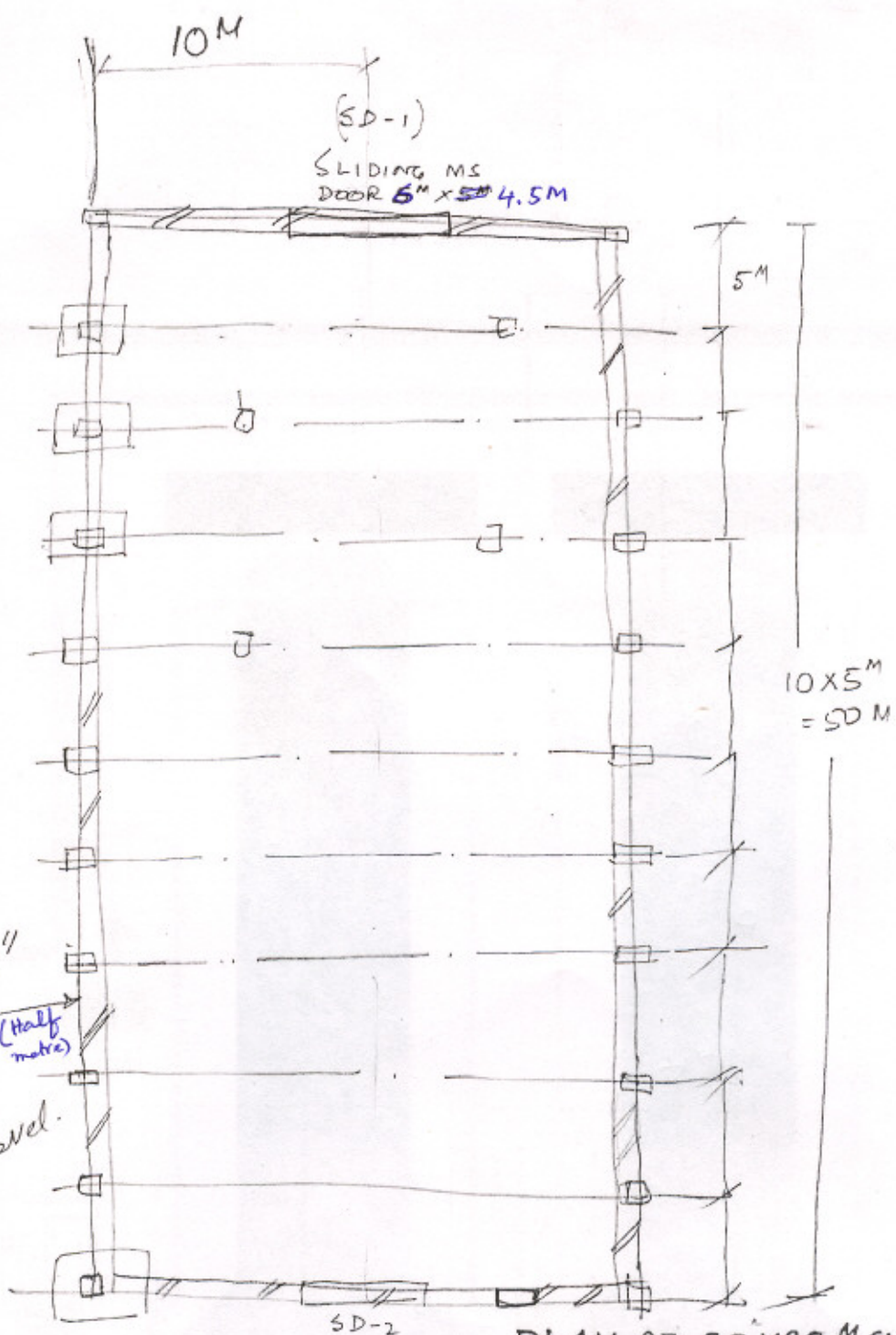

PLAN OF 50 X 20 M SIZE SHEDS.

Plinth Level 1.50m above ground level.

1.50m Plinth Level.

Roof Slope (1:3:3) i.e. 20% slope.
Roof Slope (1:3:6)

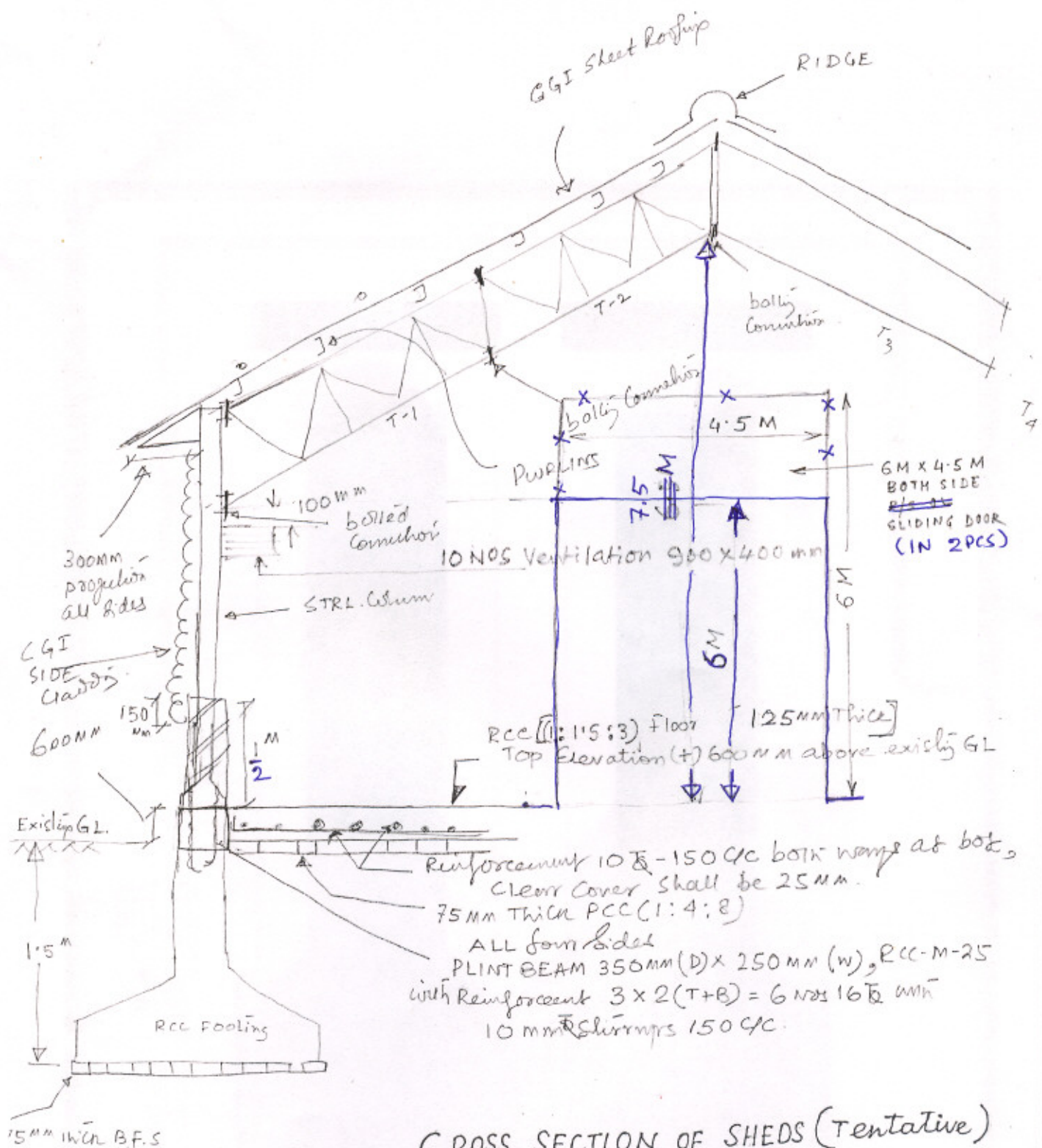

CROSS SECTION OF SHEDS (Tentative)