

DRG. NO. 34391300002

The information on this document is the Property of BHARAT HEAVY ELECTRICALS LIMITED it must not be used directly or indirectly in any way detrimental to the interest of the company.

TOOL LIST	
ITEM	TOOL DESCRIPTION
2	1454024 CRIMPING DIE

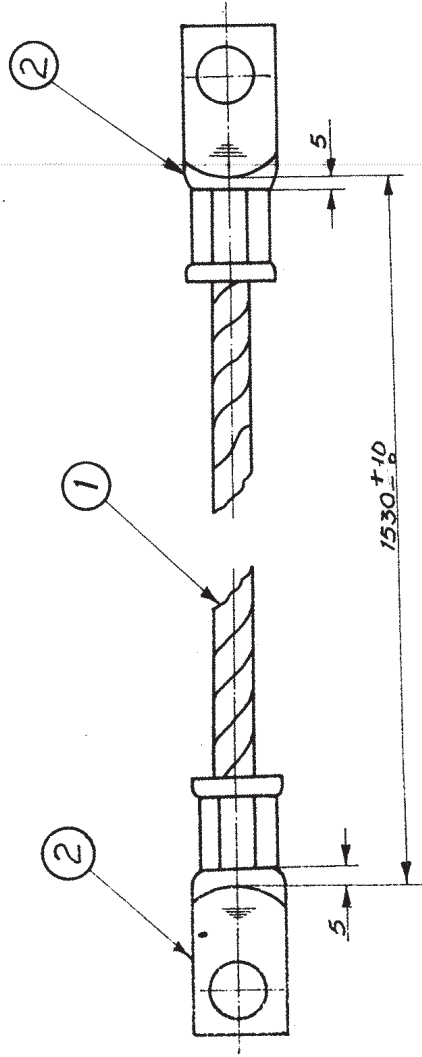

002	002	TERMINAL	C450048	003	C	KG	0.020
001	001	TINNED BARE COPPER CABLE FLEXIBLE 25/0.2/196/10-4 BARE Ø 7.5 X 5889			BP120440404895	KG	0.400
VAR 00	ITEM NO.	DESCRIPTION	DRAWING NO.		4A12004	C	
59	7578 7325 27 29	5889	77	29 31 34	MATL CODE	45 55 56 58	UNIT WT.
				2 33	MATL SPCN.	54 C	QTY
							66 71 75

ADDITIONAL INFORMATION		TYPE OF PRODUCT	
SIMILAR COMPT. DRG. D4775675		OR TM-4906AZ, 165/M RLY. MOTOR	
STATUS OF DRAWING		NAME OF CUSTOMER/PROJECT BG DE Loco.	
DISTRIBUTION OF PRINTS		BHARAT HEAVY ELECTRICALS LTD. BHOPAL	
T/N X - 1		NAME O.P. VERMA	
T/M. - 1		CHD K D G	
C/M. - 4		APPD K D G	
REV DATE ALTERED		SIGN DATE	
1 20-5-87 CHECKED		25-01-84 NO. OF VAR	
IN BOM: CABLE SIZE WAS 7.5 CABLE		16-1-87	
STANDARDS 163/1-4572 BARE Ø 7.5.		16-1-87 00	
DATE 16-4-94		REF. TO ASSY. DRG.	
16-4-94		34391300001	
DIMN 1530 ± 10 WAS 1530.		ITEM NO. 01	
M/C REF TM 4906AZ WAS NOT ON -		NO. OF ITEMS 02	
DATE 23-2-93		REV 22-23-94	
BOM UPDATED.		DRAWING NO. 34391300002	
INVENTORY NO.		SHEET NO. 01 NO. OF SHEETS 01	
SIGN & DATE		REV D4	
D4775675 KEY 1		SIZE	



INVENTORY NO. SIGN. & DATE REF. DRG. NO. THE INFORMATION ON THIS DOCUMENT IS THE PROPERTY OF BHARAT HEAVY ELECTRICALS LIMITED. IT MUST NOT BE USED DIRECTLY OR INDIRECTLY IN ANY WAY DETRIMENTAL TO THE INTEREST OF THE COMPANY.

FIRST ANGLE PROJECTION

REV.	DATE	ALTERED	CHECKED	APPROVED	17.11.22 WAS NOT ON
14	5.7.11		m	for	
13	6.12.08				

REV. DATE  
APPROVED  
CHECKED  
APPROVED  
R.B.V.  
ORIGINAL MISSING DRG.  
REDAWN IT. 009&010 ADDED

(ALL DIMENSIONS ARE IN mm)  
785902/2022/HEP-TXM20500  
ADDITIONAL INFORMATION  
STATUS OF DRAWING  
DISTRIBUTION TME-1 TAM-3 TNX-3  
OF PRINTS TXM-3 CIM-3

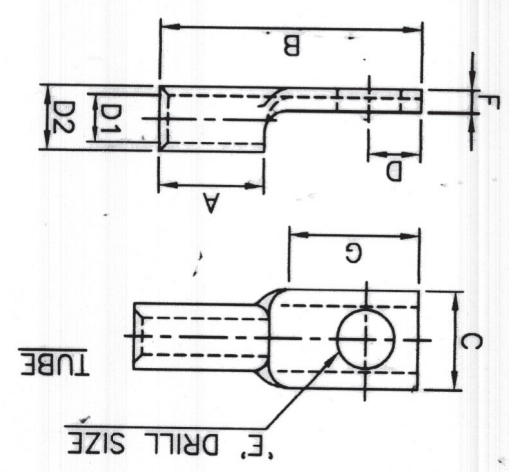

NOTES:-

1. MATERIAL COPPER TUBING TO BP12082 HIGH CONDUCTIVITY
2. TERMINALS TO BE TINNED ALL OVER. PLATING THICKNESS .013MM.
3. THE TERMINALS ARE TO BE BRIGHT ANNEALED AT 300°C FOR 45 MINUTES AND WATER QUENCHED AFTERWARDS. THE HARDNESS OF THE TERMINALS AFTER ANNEALING SHOULD NOT BE MORE THAN 60 HV.

IT.	CABLE		NO. & SIZE	AREA	A	B	C	D	E	F	G	D1	D2	CRIMPING LOAD KGS	REMARKS
1	91	14.0	29550	14.0	35.0	13.0	7.0	8.5	2.0	17	6.35	8.6	2540.2	ST.NO. 460024 E4700384(9)TG10931AZ	
2	163	18.0	52800	18.0	40.0	17.0	7.0	10.8	3.0	19	7.95	11.3	4369.00	ST. NO. 460025	
3	163	18.0	52800	18.0	40.0	17.0	7.0	8.8	3.0	19	7.95	11.3	4369.00	E4700384(10) TG10931AZ/M Tu10931AZ	
4	91	14.0	29550	14.0	35.0	13.0	6.0	7.5	2.0	17	6.35	8.5	2540.0	TM 4701 AY, AG IT.02 AZ (MG DEMU)	
5	248	18.0	43.0	18.0	43.0	19.0	10.0	10.5	3.0	23	10	13.1	-		
6	196	18.0	40.0	18.0	40.0	17.0	7.0	8.8	3.0	19	7.8	11.0	4370.00	24413033001(006) E4700059(6) ST.NO. 460154	
7	126	14.0	-	14.0	35.0	13.0	7.0	8.5	2.0	17	6.6	8.8	2540.0	24413033001(003) E4700059(3) ST.NO. 460155	
8	163	18.0	52800	18.0	40.0	17.0	7.0	6.8	3	19	7.95	11.3	4369	F 4626085 ST. NO. 90453299	
9	360	24.0	-	24.0	58.0	25.0	13.0	10.2	5.2	28	12.6	17.8	4369	DOWEL'S MAKE CUS/159 TA-7003	
10	360	24.0	-	24.0	58.0	25.0	13.0	13.0	5.2	28	12.6	17.8	4369	DOWEL'S MAKE CUS/160 TA-7003	
11	276	22.0	58.0	20.0	13.0	13.0	3.0	3.2	25	10.0	13.2	2540	0E2901/EX2904		

DEPT. TIME		UNTO. DIMS. CR.	DIM. & M/F	AA0230208	SCALE	1:1	WEIGHT(KG)	-	REF. TO ASSY.DRG.	SEE TABLE	ITEM NO.	16.05.66	NO. OF	23	24	NO. OF	010	REV	14
CODE 405		TITLE		TERMINAL (CRIMPED)		DRAWING NO.		C450048		SHT. NO. 01		NO. OF SHT. 01		SIGNATURE		DATE		75	
BHARAT HEAVY ELECTRICALS LTD. BHOPAL		APPD.		R.K.P.		SD/-		16.05.66		VAR.		NO. OF		75		DATE		75	
DRN.		D.N.M.		SD/-		16.05.66		NAME		SIGN		DATE		75		DATE		75	