

TECHNICAL DATA FOR UNIVERSAL JOINT SHAFT

LIMITING TORQUE = 40000 NM

ALTERNATING FATIGUE TORQUE = 18000 NM

MAXIMUM OPERATING SPEED $N_{max} = 180$ RPM

MAXIMUM OPERATING ANGLE = 20°

MAXIMUM LENGTH COMPENSATION $L_A = 100$ MM

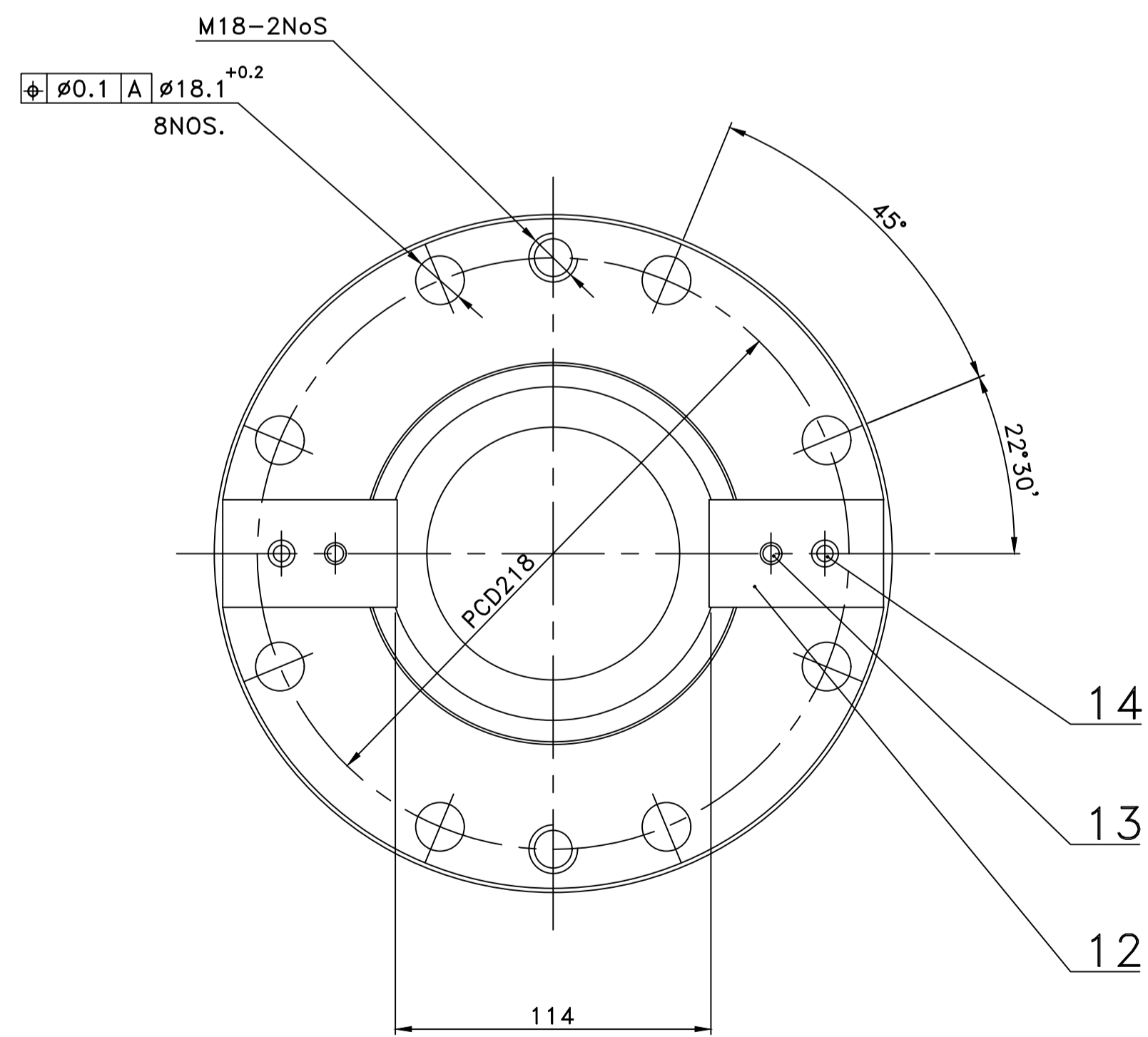

ITEM NO	DESCRIPTION	DRAWING NO	MATL CODE	UNIT WT
14	HEX SKT SH HD CAP SCREW M8X25			02
13	SPRING DOWEL SLEEVE 8X28			02
12	KEY			02
11	GREASE NIPPLE			02
10	PRESSURE RELIEF VALVE			02
09	SLIP STUB SHAFT			02
08	SPLINED SLEEVE			02
07	TUBE			02
06	PACKING SET			02
05	END CAP			02
04	DUST CAP			02
03	JOURNAL CROSS AND BEARING			02
02	WELD YOKE			02
01	FLANGE YOKE			02

CAUTION: THE INFORMATION ON THIS DOCUMENT IS THE PROPERTY OF BHARAT HEAVY ELECTRICALS LIMITED. IT MUST NOT BE USED, DIRECTLY OR INDIRECTLY IN ANY WAY DETRIMENTAL TO THE INTEREST OF THE COMPANY.

REV	DATE	ALTERED	CHKD	APPD	REV	DATE	ALTERED	CHKD	APPD
02	16.03.21	SSS	J.Sundaram	J.Sundaram	01	01.08.13	J.Sundaram	J.Sundaram	J.Sundaram

EQPT: REELER

DEPT	SSTP	GRADE OF UNTOL DIM	SCALE	WEIGHT (Kg)	REF TO ASSY DWG NO	ITEM
456		IS:2102	1:2	-	GKN 0587 55 01 02 007	02

TITLE: REE - UNIVERSAL JOINT SHAFT 1450L. (TOP&BOTTOM ROLL DRIVE)

DRAWING NO: 1-7-1136-08-01620

BOM and technical data changed
NEW BORDER INSERTED

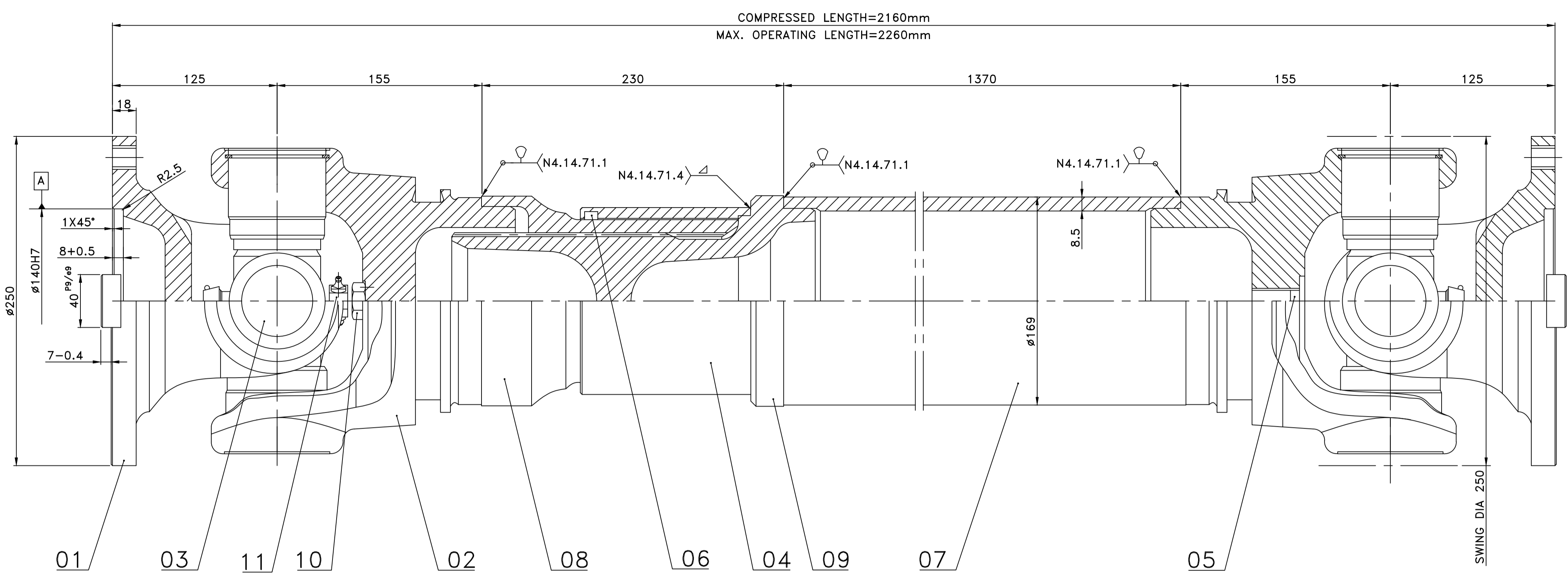

TECHNICAL DATA FOR UNIVERSAL JOINT SHAFT

- LIMITING TORQUE = 40000 NM
- ALTERNATING FATIGUE TORQUE = 18000 NM
- MAXIMUM OPERATING SPEED N max = 180 RPM
- MAXIMUM OPERATING ANGLE = 20°
- MAXIMUM LENGTH COMPENSATION LA = 100MM

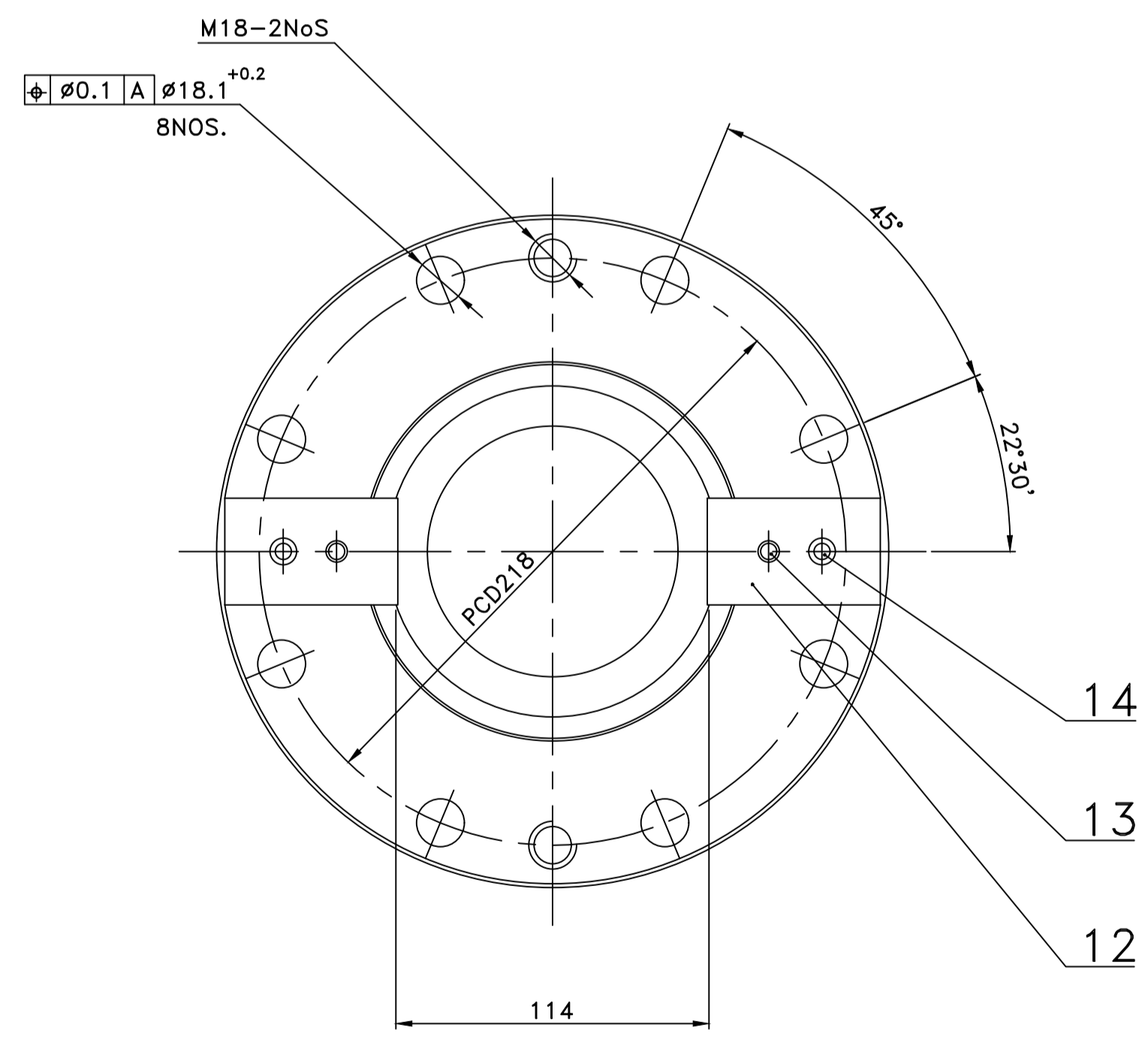

ITEM NO	DESCRIPTION	DRAWING NO	MATL CODE	UNIT WT
14	HEX SKT SH HD CAP SCREW M8X25	1 000 00 80 03 068		02
13	SPRING DOWEL SLEEVE 8X28	1 000 00 82 05 074		02
12	KEY	1 190 55 37 00 000		02
11	GREASE NIPPLE	1 000 00 86 01 117		02
10	PRESSURE RELIEF VALVE	1 000 00 81 01 075		02
09	SLIP STUB SHAFT	2 587 55 11 00 000		02
08	SPLINED SLEEVE	2 587 55 80 00 000		02
07	TUBE	1 000 00 01 02 501		02
06	PACKING SET	1 390 60 23 00 000		02
05	END CAP	1 000 00 86 09 001		02
04	DUST CAP	1 390 60 13 00 000		02
03	JOURNAL CROSS AND BEARING	7 587 55 06 00 000		02
02	WELD YOKE	2 287 55 42 00 000		02
01	FLANGE YOKE	2 587 55 22 00 000		02

REV	DATE	ALTERED	CHECKED	APPROVED	REV	DATE	ALTERED	CHECKED	APPROVED
02	16.03.21	S.S. Sundaram	S.S. Sundaram	S.S. Sundaram	01	01.08.13	S.S. Sundaram	S.S. Sundaram	S.S. Sundaram

CAUTION: THE INFORMATION ON THIS DOCUMENT IS THE PROPERTY OF BHARAT HEAVY ELECTRICALS LIMITED. IT MUST NOT BE USED DIRECTLY OR INDIRECTLY IN ANY WAY DERIVATIVE OF THE INTEREST OF THE COMPANY.

DEPT: SSTRP GRADE OF UNTOL DIM: IS:2102 SCALE: 1:2 WEIGHT (Kg): - REF TO ASSY DWG NO: GKN 0587 55 01 02 007 REF TO OLD DWG NO: GKN 0587 55 01 02 007

Bharat Heavy Electricals Ltd
SEAMLESS STEEL TUBE PLANT
TIRUCHIRAPALLI - 620014

NAME: K.RAMAKRISHNAN SIGNATURE: K.Ramakrishnan DATE: 10.5.2000
CHD: A.AROCKIAM SIGNATURE: A.Arockiam DATE: 10.5.2000
APPD: S.S.SUNDARAM SIGNATURE: S.S.Sundaram DATE: 10.5.2000

TITLE: REE - UNIVERSAL JOINT SHAFT 2260L. (TOP&BOTTOM ROLL DRIVE) DRAWING NO: 1-7-1136-08-01621

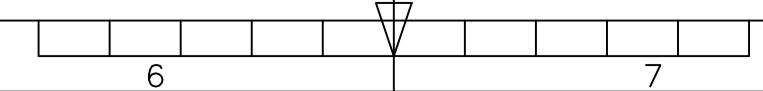

ITEM	DESCRIPTION
1	FLANGE YOKE
2	CROSS AND BEARING
3	YOKE SHAFT
4	TUBE SLEEVE
5	WELD YOKE
6	TUBE

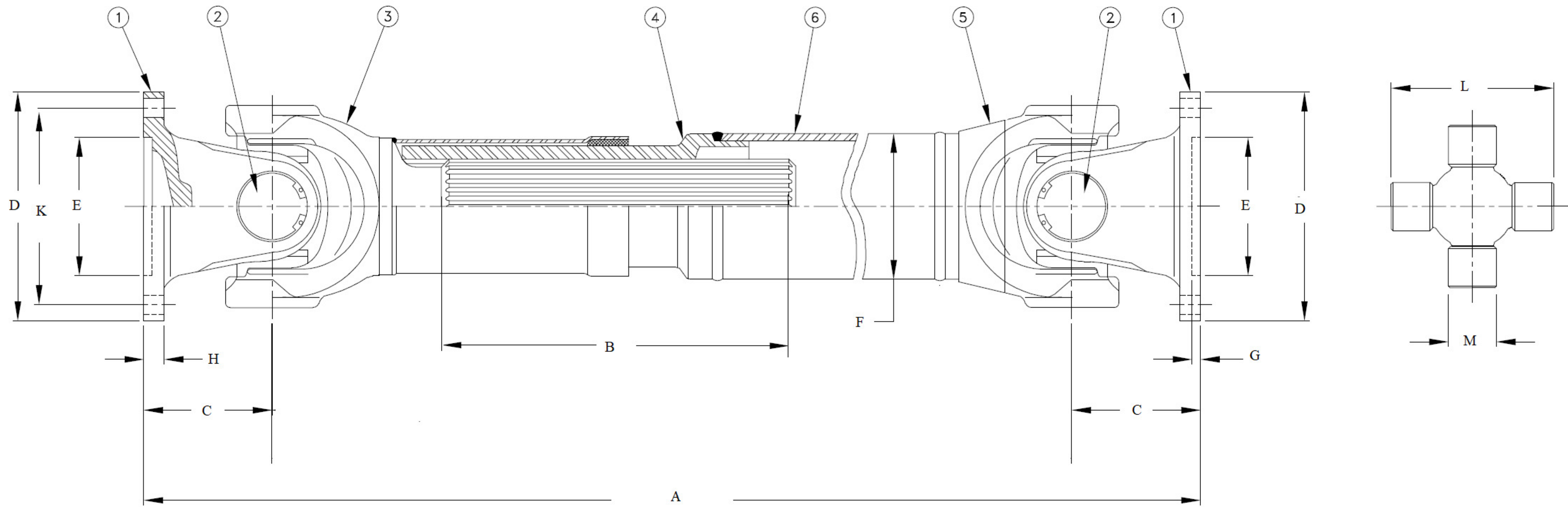

Part No	Technical Parameters	
	Bearing torque	28KNm
	Reversing Fatigue torque	14KNm
	Deflection Angle	30 Deg
A	Compressed length	2350mm
B	Adjustable length	450mm
C	Length From flange face to bearing	95mm
D	Flange Dia	180mm
E	Spigot Dia	110mm
F	Pipe Dia	140mm
G	Spigot depth	3mm
H	Flange Thickness	15mm
	Hole dia	16mm
	No of bolts	10
K	PCD	155.5mm
L	Length Across bearing cap	
M	OD of bearing cap	

BHEL REFERENCE
DRAWING

HMM/SSTP-1