



An ISO 9001
Company

Bharat Heavy Electricals Limited

(High Pressure Boiler Plant)

Tiruchirappalli – 620014, TAMIL NADU, INDIA

MATERIALS MANAGEMENT

ADDITIONAL VENDORS FOR BEARING SHELLS WITH TURCITE COATING	Phone: +91 431 257 77 45 Fax : +91 431 252 07 19 Email : muruga@bheltry.co.in Web : www.bhel.com
---	---

Reference Number: MM/PSS/B_SHELL	Date:21.12.2007	Due date for submission of quotation: 21.01.2008
You are requested to quote the Enquiry number date and due date in all your correspondences. This is only a request for quotation and not an order		

BHEL/Trichy is looking for additional vendors for supply of Bearing shells with turcite coating as per the details & drawing attached.

The annual procurement value for all the 6 varieties of bearing shells indicated in the drawing will be about 20 lakhs.

Manufactureres / stockists / Authorised dealers with minimum 2 years experience may apply for registration to following address, latest by 201.08:

M.Murugiah
SDGM/MM/Mfg, Bldg 24, BHEL, Trichy-14.(620014)

Phone: 0431-2577745

Fax: 0431-2520719.

Mail: muruga@bheltry.co.in.

CAUTION: The information on this document is the property of BHARAT HEAVY ELECTRICALS LTD. It must not be used directly or indirectly in any way detrimental to the interest of the company.

REV	DATE	ALTERED	REMARKS
01	29/2/2003	CHECKED	
- MATERIAL FOR INSIDE COATING ALTD. - BACKING STEEL MATL SPECN. ADDED - NOTES 01 TO 03 ADDED - DIMENSIONS A & H DELETED - TOLERANCE ON DIMENSION 'L' ($L \pm 0$) ADDED. - TOLERANCE ON DIMENSION 'S' ADDED ($S \pm 0.1$)			

- NOTES:
- OUTER SURFACES, INCLUDING THE EDGES SHALL BE ELECTRO GALVANISED TO A THICKNESS OF 15μ (MICRONS).
 - TURCITE COATING THICKNESS SHALL NOT BE MORE THAN 0.4 mm.
 - INDICATED DIMENSIONS ARE INCLUSIVE OF COATINGS.
- INSIDE SURFACE TO BE COATED WITH
 TURCITE (BRAND NAME).

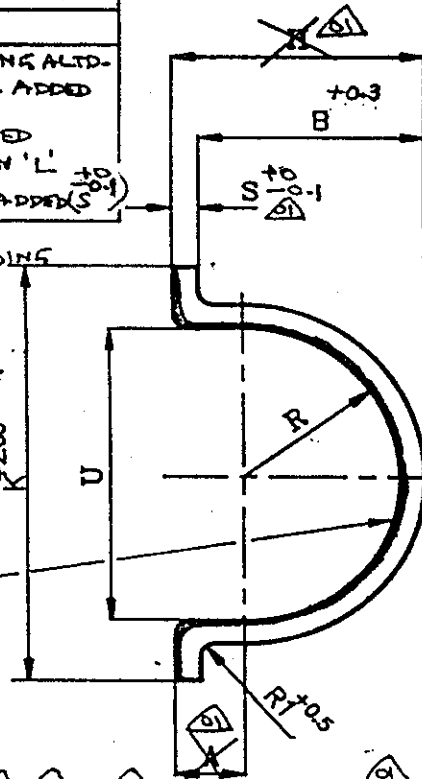

REV	DATE	ALTERED	REMARKS
02	5/9/5	CHECKED	
STEEL MATL ALTD FROM 'IS 2062 FE 410 WA' TO 'IS 1079-EDD', AS PER BHEL (D) MM'S EMAIL DT 5/9/5.			

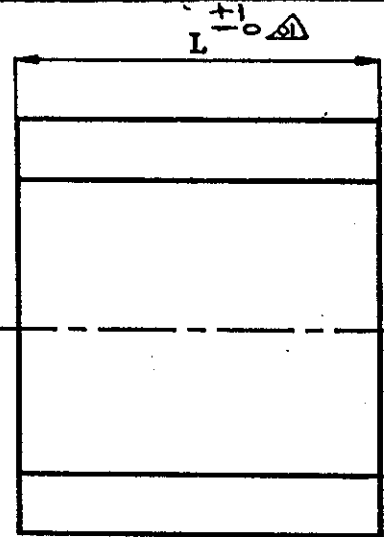

VAR.NO:	B	K	L	A	H	R	R1	S	U	MATL SPECN.	MATL CODE	WT.
01	8.6 ^{+0.3}	20 ⁺²	18	2.6	9.6	6 ^{+0.05}	1 ^{+0.5}	1	12 ^{+0.1}	INSIDE SURFACE COATING: TURCITE		0.005
02	8.6 ^{+0.3}	20 ⁺²	25	2.6	9.6	6 ^{+0.05}	1 ^{+0.5}	1	12 ^{+0.1}	TH OR GLYCOCUR (BRAND NAME)		0.007
03	14.1 ^{+0.3}	30 ⁺²	30	4.1	15.6	10 ^{+0.06}	1 ^{+0.5}	1.5	20 ^{+0.12}	BACKING STEEL MATERIAL: IS 1079-EDD		0.020
04	20.1 ^{+0.3}	42 ⁺²	35	5.1	22.1	15 ^{+0.07}	2 ^{+0.5}	2	30 ^{+0.14}			0.040
05	20.1 ^{+0.3}	42 ⁺²	60	5.1	22.1	15 ^{+0.07}	2 ^{+0.5}	2	30 ^{+0.14}			0.060
06	25.6 ^{+0.3}	53 ⁺²	60	5.6	27.6	20 ^{+0.08}	2 ^{+0.5}	2	40 ^{+0.16}			0.080

VAR NO.	DESCRIPTION	MATL CODE	A	UNIT WT
		MATL SPECN	C	QTY



BHARAT HEAVY ELECTRICALS LTD.

PIPING CENTRE
MADRAS 600 017

NAME	SIGN	DATE	NO. OF VAR
DRN: M.C. SEKARAN		18-05-93	
CHD: C. KALIDAS		27-05-93	
APPD: S. JAYAKUMAR		12-06-93	

DEPT	GRADE OF UNTOLO DIM	SCALE	WEIGHT (KG)	REF. TO ASSY./OLD DRG.	ITEM NO.	NO. OF ITEMS
CODE	C / M / F			USEGA DRG No: 57000-4-5700/4		

TITLE	CARD CODE	DRAWING NO.	REV
BEARING SHELL	U 01	4-80-999-993/9	

AC