

Plan of MS Base frame (size 20' x 10' x 8.5')

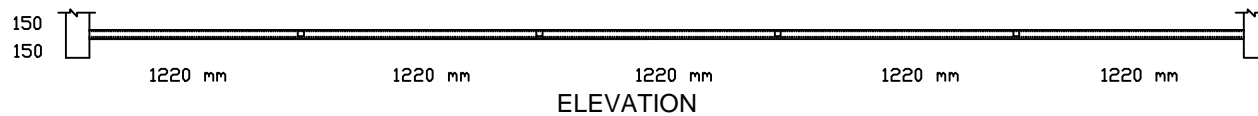

ELEVATION

Material of MS Base frame (150mm x 65mm x 2.5mm thick) & RHS (Rolled Hollow Section) --- 80mm x 40mm x 2.5mm thick

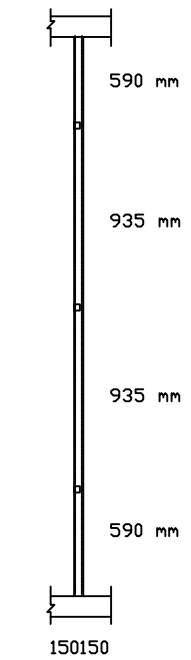

SIDE VIEW

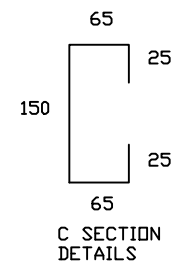

Drawing Title - MS Base frame Size - 20' x 10' x 8.5'

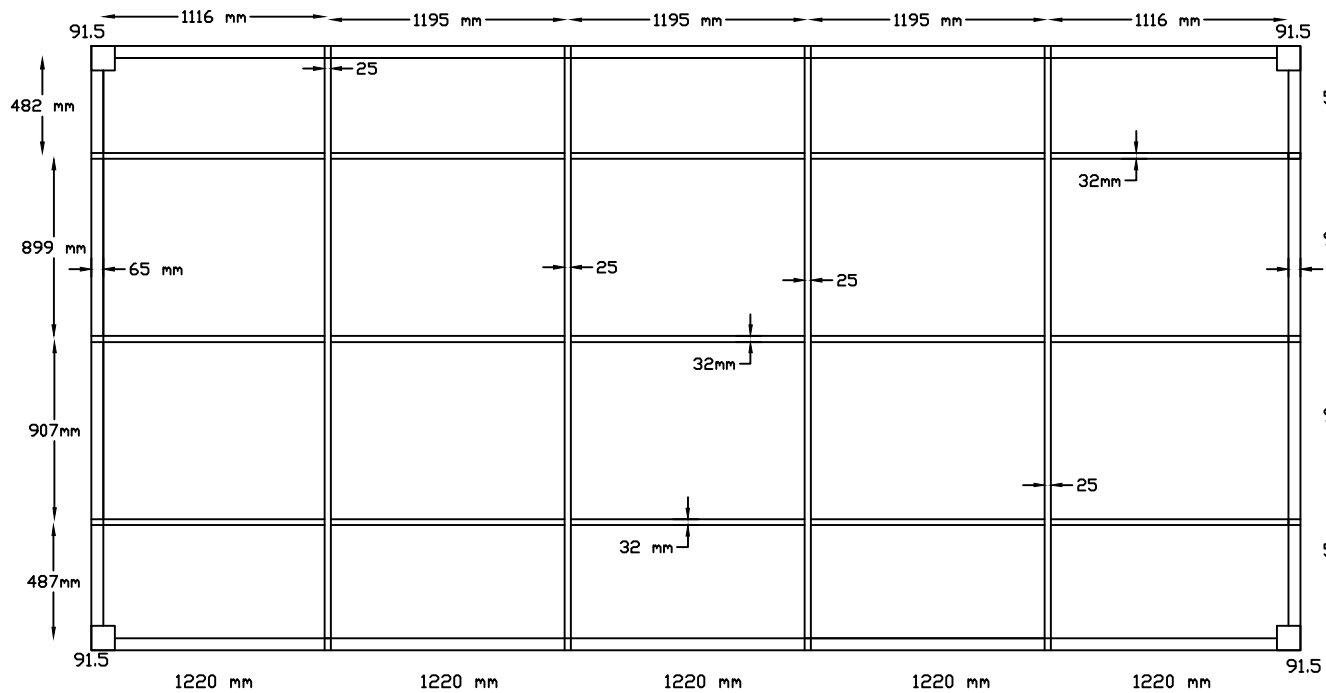

Plan of MS Top frame (size 20' x 10' x 8.5')

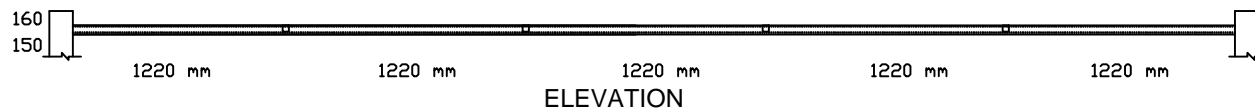

ELEVATION

Material of MS Top frame (150mm x 65mm x 2.5mm thick) & RHS (Rolled Hollow Section) --- 50mm x 25mm x 2.5mm thick  
SHS (Square Hollow section) --- 32mm x 32mm x 2.0mm thick

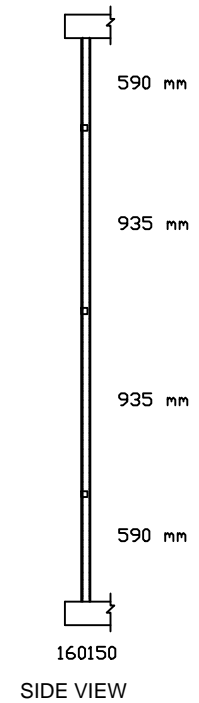

SIDE VIEW

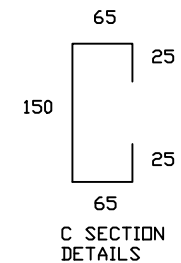

C SECTION  
DETAILS

**Drawing Title - MS Top frame Size - 20' x 10' x 8.5'**

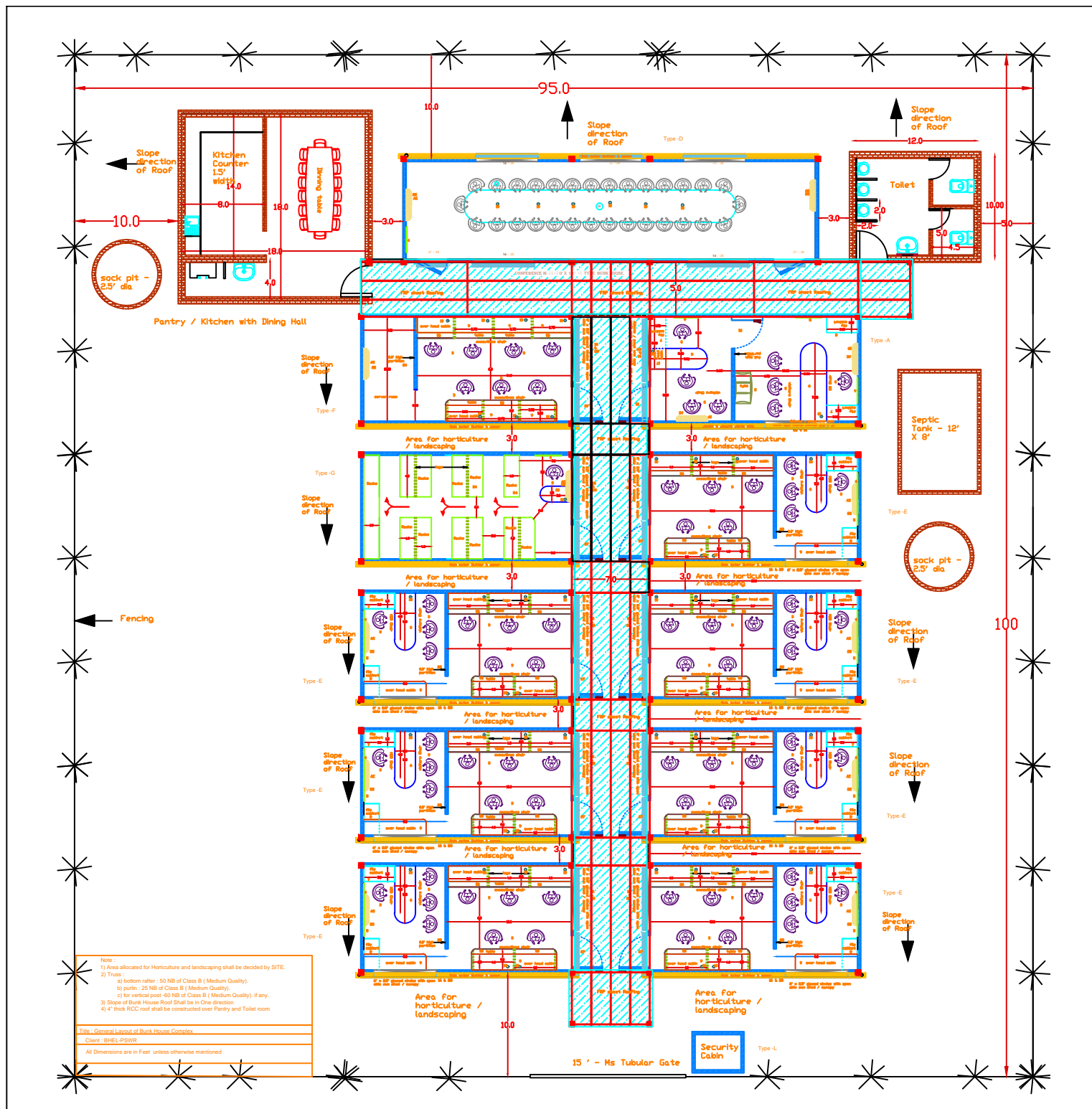

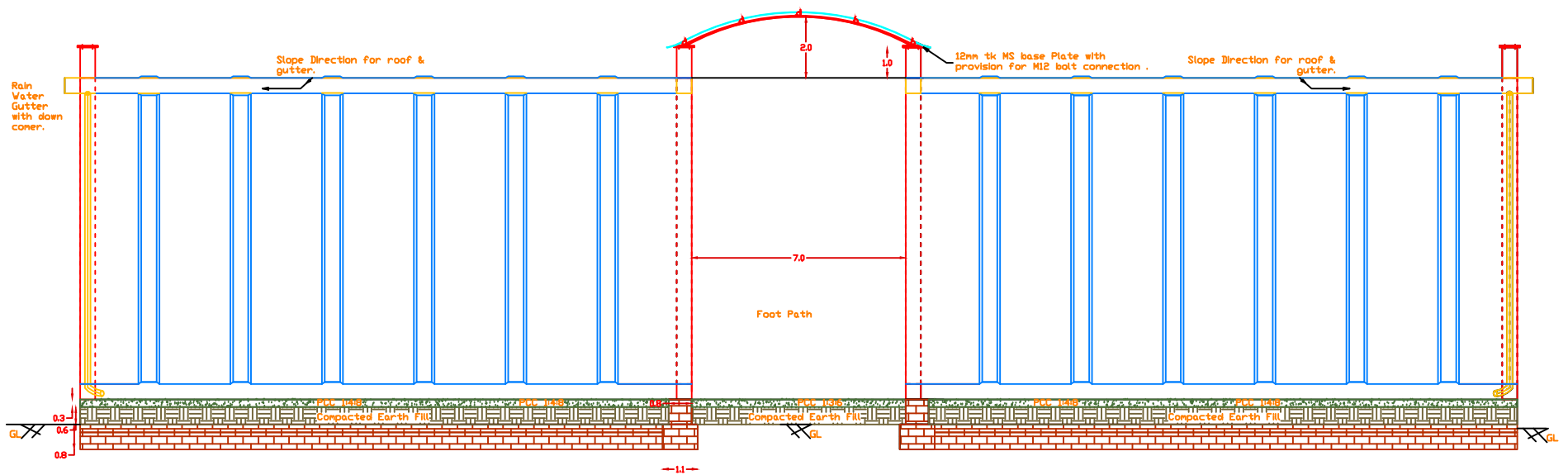

Front Elevation

Title : Front Elevation of General Layout of  
Bunk House Complex

Client : BHEL-PSWR

All Dimensions are in Feet  
unless otherwise mentioned

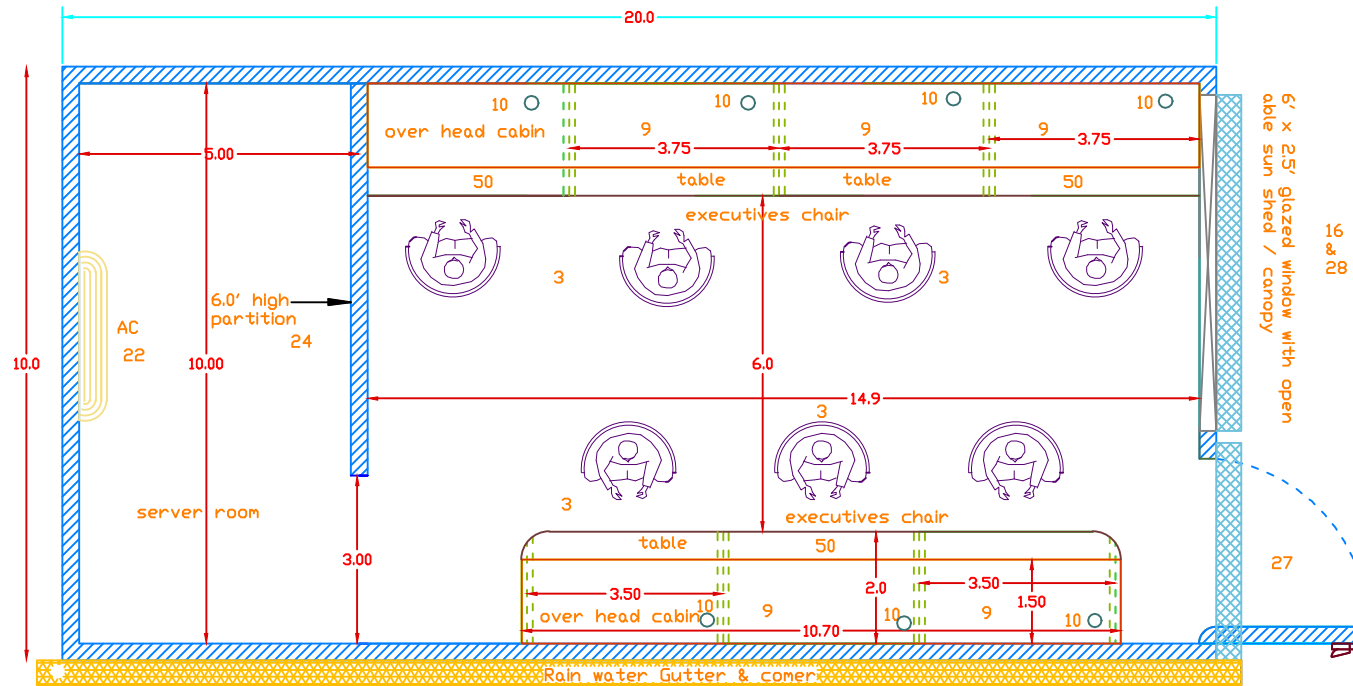

COMPUTER / SERVER ROOM - 20' X 10' - F TYPE BUNK HOUSE.

Code No.	Materials Lists / Specifications	Qty
3	EX. chair serena model 19002 A Godreg make Model No.	7
16	PVC Sliding Glazed window Size:1829x750mm	1
22	Split A.C.	1
24	Half Partition - 6' height	1
9	Over Head Cabinet Size:450x600mm .	3
27	Door Size:900x1970mm	1
50	Running Table of Size : 2' width x length as per drawing	2
28	Canopy (Foldable) at door / Window size as per Drawing	
10	Opening for cable	7

Note :

- 1) All dimensions in the Drawing are in Feet & Inches unless otherwise mentioned.
- 2) Clear Height between finished floor level to bottom of ceiling is 8.00'.
- 3) Condenser unit for split AC shall be located outside of Bunk house .
- 4) Position of cable opening as per the switch board location.
- 5) Rain water Gutter shall be placed as per drawing in one side only along the roof slope and same connected with rain water down comer with L bow at the end.

Title: Computer / Server cabin
Type : F
Size : 20' x 10'
Clint : BHEL - PSWR



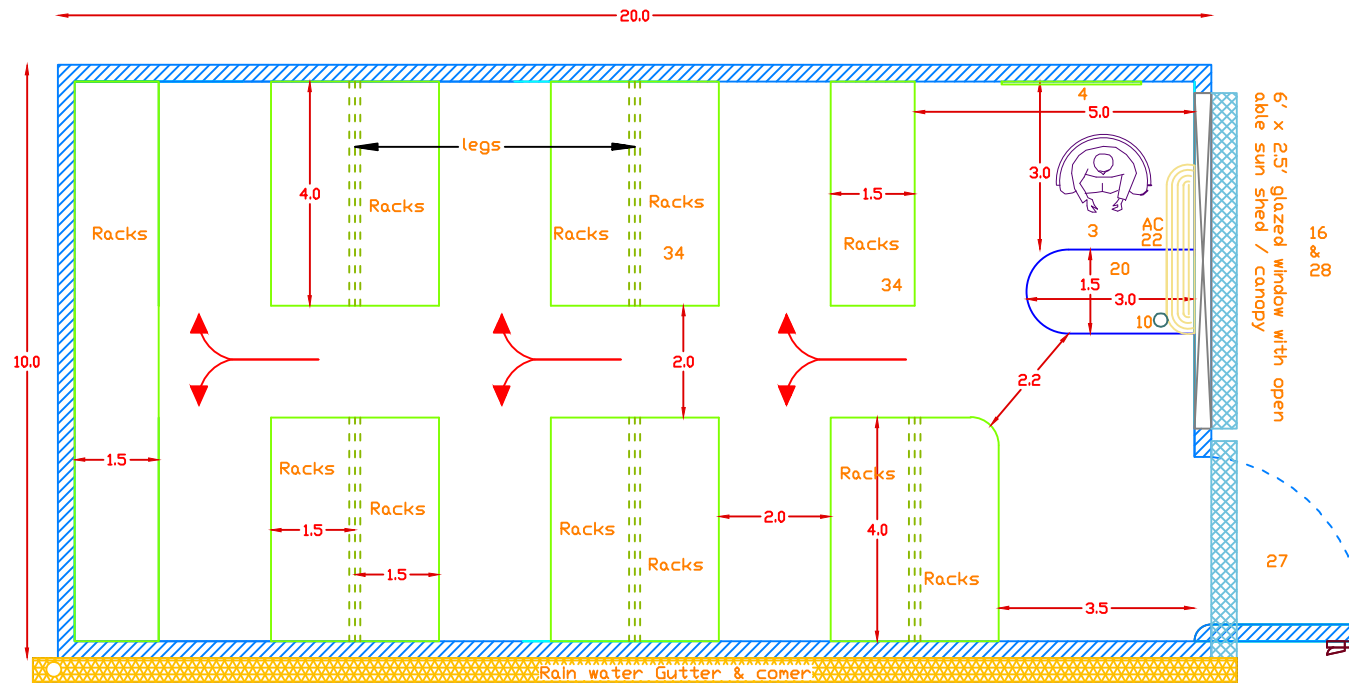

DOCUMENTATION ROOM - 20' X 10' - TYPE BUNK HOUSE.

Code No	Materials Lists / Specifications	Qty
4	White board Size:750x1000mm	1
3	EX. chair serena model 19002 A - Godreg make Model No.	1
16	PVC Sliding Glazed window Size:1829x750mm	1
20	P A Table Size: 3' X 1.5'X2.5' Ht.	1
22	Split A.C.	1
27	Door Size:900x1970mm	1
34	Racks of Size:900 / 450 mm width up to Ceiling as per drawing	
28	Canopy (Foldable) at door / Window size as per Drawing	
10	Opening for cable	1

Note :

- 1) All dimensions in the Drawing are in Feet & Inches unless otherwise mentioned.
- 2) Clear Height between finished floor level to bottom of ceiling is 8.00'.
- 3) Condenser unit for split AC shall be located outside of Bunk house .
- 4) Intermediate rack at every 1.5' height.
- 5) All racks are back to back type.

Title: Documentation cabin

Type : G

Size : 20' x 10' "

Clint : BHEL - PSWR





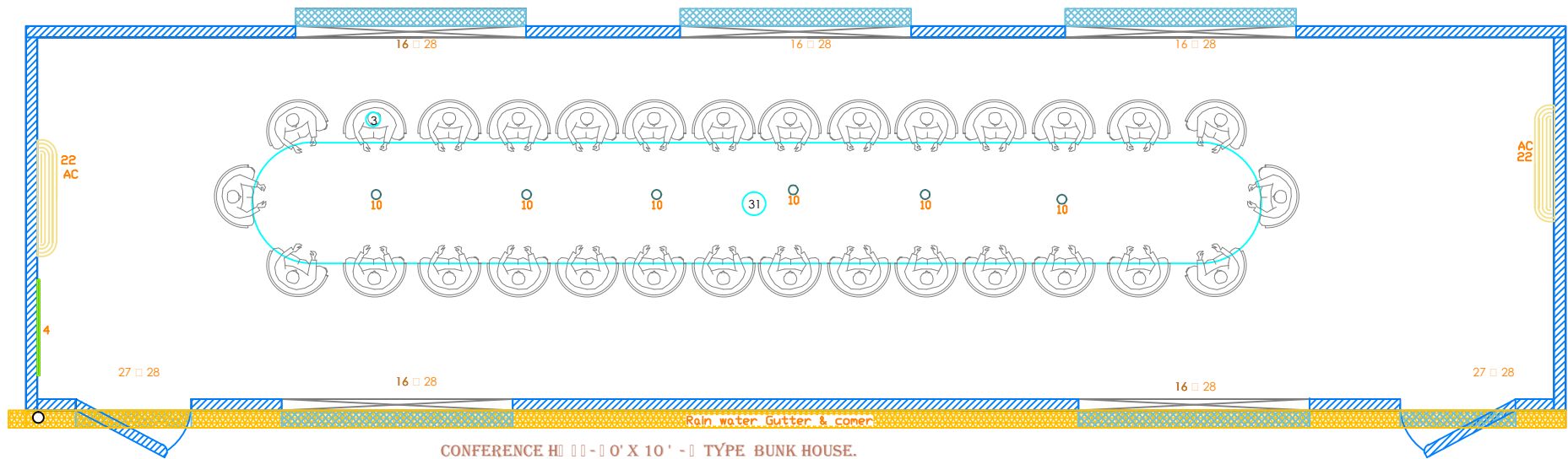

Note :

1) All dimensions in the Drawing are in Feet & Inches unless otherwise mentioned.

2) Clear Height between finished floor level to bottom of ceiling is 8.00'.

3) Condenser unit for split AC shall be located outside of Bunk house.

4) Position of cable opening as per the switch board location.

4	White board Size:750x1000mm	1	22	Split A.C.	2	Title : Conference Hall
16	PVC Sliding Glazed window Size:1829x750mm	5	28	Canopy (Foldable) at door / Window size as per Drawing	7	Type : D
3	EX. chair serena model 19002 A Godreg make Model No.	1	27	Door Size:900x1970mm	2	Size : 40' X 10'
	Visitor chair regency model PCH 7003D Godreg make Model No.	29	31	Conference Table Size:8840x1060x600 height	1	Client : BHEL-PSVR
10	opening for cable as per drawing	6				

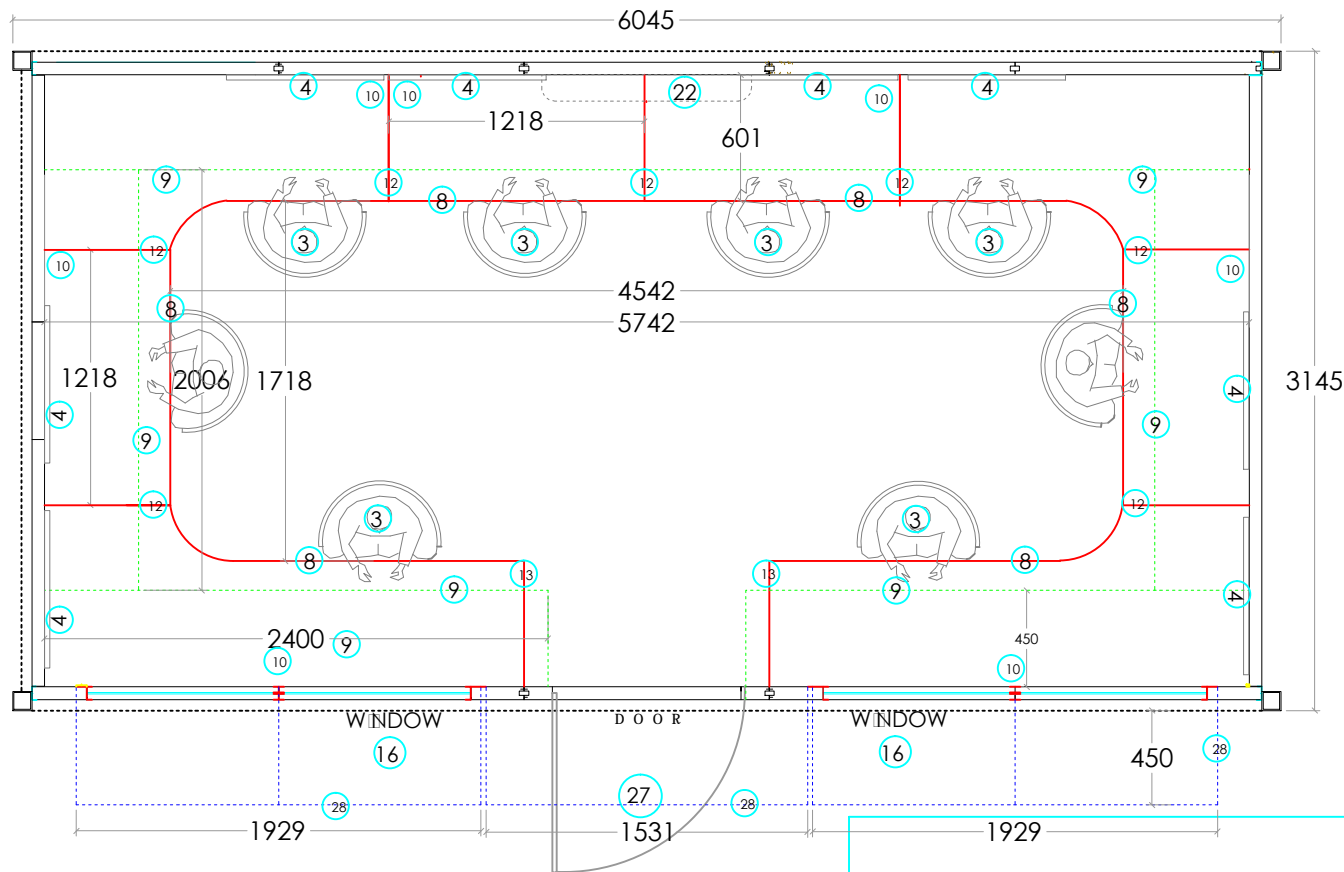

3	Visitor/Staff chair regency model PCH 7003D Godre make.	8
4	White board Size:750x1000mm	8
8	Running Table Size:as per Drawing.	2
9	Over Head Cabinete Size:As per Drawing.	
10	Opening for cable	8
12	Table partition wall 450mm height from top table surface	7
13	Partition wall up to bottom of Over head cabinate	2
16	PVC Sliding Glazed window Size:1829x750mm	2
22	Split A.C.	1
27	Door Size:900x1970mm	1
28	Canopy (Foldable) at door / Window size as per Drawing	

Note:  
1) All Notes shall be followed as per other drawings

Field Cabin /Staff Size: 20'x10'----

Type: C

BHEL PSWR

