



Bharat Heavy Electricals Limited

Power Sector - Southern Region 690, Anna Salai, Nandanam, Chennai - 600 035.

Phone: 044 - 24342458 Fax: 044 - 24328516

Email : boopathy.co.in; ram@bhelssr.co.in

PURCHASE ENQUIRY – TWO PART BID

ENQUIRY No : EC 19091

DATE : 20 01 2010

DUE DATE : 15 02 2010

Please submit your lowest quotation / offer for the item mentioned below. **Please always Super scribe the Enquiry No and Due Date on the cover as well as in the letter / quotation. Please note that this is only ENQUIRY and not an Order.**

Address of Vendor :			<u>Material to be delivered at :</u>	
			<u>1-set to</u>	
			Site Incharge	
			MRPL – Phase III	
			Karnataka	
			<u>1-set to</u>	
			BHEL site office , 2 x 800MW , sri	
			Damodaram Sanjeevaiah Thermal Power	
			Plant,Krishnapattinam,Nellore Dist A.P	
			<u>1set to</u>	
			Site Incharge	
			Shri SINGAJI TPP 2X600MW,Malwa M.P	
SINo	Description	Unit	Quantity	Specification
1	Bunk House - 1set consists of : 40 Feet x 10 Feet -5nos 20 Feet x 8 Feet -1no 10 Feet x 5 Feet -1no Including Portico 4Ft X 8Ft - 1no and covered passage 3 ½ Ft w & 3 ½ Ft L -1no	Set	3	Specification as per annex -1 & REF DRG NO :Nov09/BHEL/PLAN001

ABOVE ITEMS ARE TO BE OFFERED FOR INSPECTION WITHIN **11 WEEKS** FROM THE DATE OF RECEIPT OF PURCHASE ORDER. AND SHALL BE DELIVERED with in **10 DAYS** TO RESPECTIVE BHEL SITES AFTER INSPECTION / DELIVERY CLEARANCE BY BHEL.

Note :

- (1) The Technical Specification along with Qualification requirements, Commercial Terms & Conditions applicable for this Enquiry and price Bid formats have been posted in our web site www.bhel.com. Your offer should be based on all the above documents.
- (2) Also, you are requested to fill in the Supplier Registration formats available www.bhel.com and send it along with your offer.

Tenders should reach us before 14.00 hours on the due date
Tenders will be opened at 14.30 hours on the due date
Tenders would be opened in presence of the tenderers who
have submitted their offers and who may like to be present

Yours faithfully,
For BHARAT HEAVY ELECTRICALS LIMITED

Addl. General Manager/ P&S



Bharat Heavy Electricals Limited

Power Sector - Southern Region 690, Anna Salai, Nandanam, Chennai - 600 035.

Phone: 044 - 24342458 Fax: 044 - 24328516

Email : boopathy.co.in; ram@bhelpssr.co.in

PURCHASE ENQUIRY – TWO PART BID

ENQUIRY No : EC 19091

DATE : 20 01 2010

DUE DATE : 15 02 2010

Note:

1. The offer has to be submitted in TWO PART BID.
Part-I Technical and Commercial (Unpriced Bid) in a sealed cover.
Part-II Price Bid in a separate sealed cover.
Both the above sealed covers should be put in a separate sealed cover .
All the covers should be super scribed with Tender no, Due date & Description of item .
2. The offer has to be submitted in TWO PART BID. (ref Clause 25 of Terms & Conditions)
3. Please quote the price "on FOR destination" BHEL site .
4. Rate quoted shall cover all basic price, tax, duty, insurance, freight , octroi etc on FOR Destination basis. However breakup details shall be furnished to enable us to claim CENVAT / MODVAT benefits ,Please note that amount towards taxes and duties which will be claimed by BHEL will be deducted from the offer for evaluation purpose
5. Any clarifications may be sought by Vendor should be with due written requests at least eight (8) days prior to Tender Due date.
6. Payment will be released as per **Clause 32 of Terms & Conditions**
7. Testing / inspection will be carried out by BHEL at suppliers work. as per the quality plan (Refer Clause.29 of Terms & Conditions). Vendor has to despatch the material after completion of inspection and Drgs shall be forwarded to BHEL for prior approval after getting despatch clearance from BHEL..
8. Test Certificate, Guarantee Certificate are to be furnished to BHEL without fail as per the quality plan & as called for in the enquiry .Please refer clause 40 of our Instructions to the venders / Bidders.
9. Please refer to the Instructions to Tenders regarding Terms and Conditions as applicable to this Enquiry, which is enclosed.
10. Please seek all the clarifications, if any, before quoting and submit a **NO DEVIATION certificate.**
11. The offer validity should be for 90 days from the date of opening of Techno- commercial bid.
12. Vendor is requested to submit one set of Enquiry copy duly signed and to be submitted along with your offer as token of acceptance of our terms and conditions.

Yours

faithfully

For BHARAT HEAVY ELECTRICALS LIMITED

ADDL. GENERAL MANAGER / P & S



Bharat Heavy Electricals Limited

Power Sector - Southern Region 690, Anna Salai, Nandanam, Chennai - 600 035.

Phone: 044 - 24342458 Fax: 044 -24328516

Email :boopathy.co.in; ram@bhelpssr.co.in

PURCHASE ENQUIRY – TWO PART BID

ENQUIRY No : EC 19091

DUE DATE : 15 02 2010

DATE : 20 01 2010

CERTIFICATE FOR NO DEVIATION

I, _____

Of

M/s _____

_____ hereby certify that there is no deviation from the Tender conditions either technical or commercial and I am agreeing to all the terms and conditions mentioned in the Tender Specification.

SIGNATURE OF THE TENDERER



Bharat Heavy Electricals Limited

Power Sector - Southern Region 690, Anna Salai, Nandanam, Chennai - 600 035.

Phone: 044 - 24342458 Fax: 044 -24328516

Email :boopathy.co.in; ram@bhelpssr.co.in

PURCHASE ENQUIRY – TWO PART BID

ENQUIRY No : EC 19091

DATE : 20 01 2010

DUE DATE : 15 02 2010

Price Format for MRPL Site

Sl No	Description of Item	M/s		
		Qty No/Set	Unit rate	Total Rs
1	Bunk Office complex - 1set consists of : 40 Feet x 10 Feet -5nos 20 Feet x 8 Feet -1no 10 Feet x 5 Feet -1no Complete as per technical specification	1		
2	Charges against Erection & handing over in full operation condition to BHEL site.			
3	Packing & Forwarding	LS		
4	ED (on sl 1+3)	0.0%		
5	Cess on ED (on sl 4)	0.0%		
6	CST/ST / VAT without C Form or any other concessional form(on sl 1+3+4+5)	0.00%		
7	Service Tax if applicable (on sl no2)	0.00%		
8	Freight Charges (for MRPL Karnataka site	LS a+b+c+d		
9	Tr. Insurance (for MRPL Karnataka site	LS A+		
10	Other charges if any	LS		
11	FOR Destination Price(1 to 10)			
12	MODVAT benefit pass onto BHEL(sl4+5)			

New #690,ANNA SALAI, PERIAR EVR BUILDING, NANDANAM, CHENNAI 600 035, INDIA

Ph:+91-(0) 44-24342458,24330015 Extn 281 Fax +91 - (0) 44-24328516

E.mail: ram@bhelpssr.co.in ,boopathy@bhelpssr.co.in

Regd. Office: BHEL HOUSE,Siri Fort,New Delhi - 110 049

**Bharat Heavy Electricals Limited**

Power Sector - Southern Region 690, Anna Salai, Nandanam, Chennai - 600 035.

Phone: 044 - 24342458 Fax: 044 -24328516

Email :boopathy.co.in; ram@bhelpssr.co.in

PURCHASE ENQUIRY – TWO PART BID

ENQUIRY No : EC 19091

DATE : 20 01 2010

DUE DATE : 15 02 2010

Price Format for Krishnapattinam Site

Sl No	Description of Item	M/s		
		Qty No/Set	Unit rate	Total Rs
1	Bunk Office complex - 1set consists of : 40 Feet x 10 Feet -5nos 20 Feet x 8 Feet -1no 10 Feet x 5 Feet -1no Complete as per technical specification	1		
2	Charges against Erection & handing over in full operation condition to BHEL site.			
3	Packing & Forwarding	LS		
4	ED (on sl 1+3)	0.0%		
5	Cess on ED (on sl 4)	0.0%		
6	CST/ST / VAT without C Form or any other concessional form(on sl 1+3+4+5)	0.00%		
7	Service Tax if applicable (on sl no2)	0.00%		
8	Freight Charges (for Krishnapattinam A.P site)	LS		
9	Tr. Insurance (for Krishnapattinam A.P site)	LS		
10	Other charges if any	LS		
11	FOR Destination Price(1 to 10)			
12	MODVAT benefit pass onto BHEL(sl4+5)			



Bharat Heavy Electricals Limited

Power Sector - Southern Region 690, Anna Salai, Nandanam, Chennai - 600 035.

Phone: 044 - 24342458 Fax: 044 -24328516

Email :boopathy.co.in; ram@bhelpssr.co.in

PURCHASE ENQUIRY – TWO PART BID

ENQUIRY No : EC 19091

DATE : 20 01 2010

DUE DATE : 15 02 2010

Price Format for Malwa Site

Sl No	Description of Item	M/s		
		Qty No/Set	Unit rate	Total Rs
1	Bunk Office complex - 1set consists of : 40 Feet x 10 Feet -5nos 20 Feet x 8 Feet -1no 10 Feet x 5 Feet -1no Complete as per technical specification	1		
2	Charges against Erection & handing over in full operation condition to BHEL site.			
3	Packing & Forwarding	LS		
4	ED (on sl 1+3)	0.0%		
5	Cess on ED (on sl 4)	0.0%		
6	CST/ST / VAT without C Form or any other concessional form(on sl 1+3+4+5)	0.00%		
7	Service Tax if applicable (on sl no2)	0.00%		
8	Freight Charges (for Malwa M.P site)	LS		
9	Tr. Insurance (for Malwa M.P site)	LS		
10	Other charges if any	LS		
11	FOR Destination Price(1 to 10)			
12	MODVAT benefit pass onto BHEL(sl4+5)			

New #690,ANNA SALAI, PERIAR EVR BUILDING, NANDANAM, CHENNAI 600 035, INDIA

Ph:+91-(0) 44-24342458,24330015 Extn 281 Fax +91 - (0) 44-24328516

E.mail: ram@bhelpssr.co.in ,boopathy@bhelpssr.co.in

Regd. Office: BHEL HOUSE,Siri Fort,New Delhi - 110 049



Bharat Heavy Electricals Limited

Power Sector - Southern Region 690, Anna Salai, Nandanam, Chennai - 600 035.

Phone: 044 - 24342458 Fax: 044 -24328516

Email :boopathy.co.in; ram@bhelpssr.co.in

PURCHASE ENQUIRY – TWO PART BID

ENQUIRY No : EC 19091

DATE : 20 01 2010

DUE DATE : 15 02 2010

ANNEXURE -2

TECHNICAL SPECIFICATION

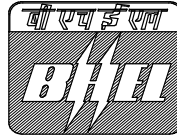

Bharat Heavy Electricals Limited

Project Management Department

Power Sector – Southern Region

690, Anna Salai, Nandanam

Chennai – 600 035

New #690,ANNA SALAI, PERIAR EVR BUILDING, NANDANAM, CHENNAI 600 035, INDIA

Ph:+91-(0) 44-24342458,24330015 Extn 281 Fax +91 - (0) 44-24328516

E.mail: ram@bhelpssr.co.in ,boopathy@bhelpssr.co.in

Regd. Office: BHEL HOUSE,Siri Fort,New Delhi - 110 049



Bharat Heavy Electricals Limited

Power Sector - Southern Region 690, Anna Salai, Nandanam, Chennai - 600 035.

Phone: 044 - 24342458 Fax: 044 - 24328516

Email : boopathy.co.in; ram@bhelpssr.co.in

PURCHASE ENQUIRY – TWO PART BID

ENQUIRY No : EC 19091

DATE : 20 01 2010

DUE DATE : 15 02 2010

TECHNICAL SPECIFICATION

1.00.00

SCOPE

This specification covers Design, Manufacturing, Supply, Receipt at Site, Erection & Handing over of Bunk house, including Electricals, A/Cs, internal plumbing, sanitary wares, Furniture all complete as per layout enclosed. This also includes guarantee for **one year** (01) of operations for the design performance, materials supplied & erected by him covered under the scope of the contract.

The bunk house 40 Ft. X 10 Ft - 5 Nos. and 1nos - 20 Ft. X 8 Ft - Common toilet & 1nos - 10Ft X 5Ft attached toilet to Site in-charge & Conference hall including Portico 4Ft X 8Ft and covered passage 3 ½ Ft w & 3 ½ Ft L to be assembled as per enclosed layout.

BHEL will provide leveled ground free from all shrubs & vegetation for placing bunk house. Construction Power supply, Water, rigidly fixing bunkhouses together after placing it on concrete blocks in level, testing & commissioning all electrical appliances and handing over to BHEL site is in the bidder scope.

2.00.00

DESIGN CONSIDERATIONS

2.01.00

SIZE

- Size of Bunkhouse – 20Ft length X 8Ft width X 8Ft height – 1nos, 10Ft length X 5Ft width X 8Ft height – 1nos and 40Ft length X 10Ft width X 8Ft height – 5nos,
- Clear Height shall be 8Ft.
- Sliding doors shall be provided wherever necessary and as per drawing.
- The bunk house 40 Ft. X 10 Ft.-5 Nos. and 20 Ft.X 8 Ft.-1Nos. & 10Ft X 5Ft-1Nos. - as toilets (common toilet & site in-charge/conference toilet) to be assembled as per enclosed layout using trough type steel channels of 50 mm made to suitable shape to arrest water seepage and the cabins to be leak proof with all Furniture, Electrical & Sanitary fittings, A/Cs and internal plumbing as per enclosed layout.
- All designs have to be carried out as per relevant IS code, standard specification and drawings as per the instruction of Engineer In-charge.**

2.02.00

BLOCKS

- Concrete blocks of size 450mm X 450mm X 600mm shall be provided to support the Bunkhouse at all four corners of each bunk and also, at the middle in the case length exceeds 20 ft.
- Grade of Concrete Block shall be confirming to M25 with min. Reinforcement Steel shall be confirmed to Fe-415. Reinforcement shall be provided as per the design (IS456).



Bharat Heavy Electricals Limited

Power Sector - Southern Region 690, Anna Salai, Nandanam, Chennai - 600 035.

Phone: 044 - 24342458 Fax: 044 -24328516

Email : boopathy.co.in; ram@bhelpssr.co.in

PURCHASE ENQUIRY – TWO PART BID

ENQUIRY No : EC 19091

DATE : 20 01 2010

DUE DATE : 15 02 2010

2.03.00 FLOORING

- The flooring shall be made of main structural member of 2 mm HRCA sheet bend to required shape made as grid and 19mm marine plywood on top with 1mm vinyl flooring.
- Toilet flooring & passage shall be of Ceramic tiles 300mm X 300mm antiskid.

2.04.00 WALL

- The walls shall be made of 60 mm thick puff insulated sandwich panel with 0.5 mm Galvalume sheet of approved colour on both sides and center portion poly urethane foam (PUF) for better thermal and acoustic insulation.
- All side cladding/ roof sheets shall be fitted in such a way that they can be removed at any point of time.
- Front Portico of size approx. 4Ft X 8Ft shall be provided with colour coated Galvalume sheet.
- A covered passage (approx 3 ½ Ft width & 3 ½ Ft length) of same material specification of bunks shall be provided for the entrance of common toilet.

2.05.00 ROOF

- The roof shall be of 25 mm thick puff insulated sandwich panel with 0.5 mm Galvalume sheet on both sides.
- Center portion shall be made of PUF for better thermal and acoustic insulation.

2.06.00 DOORS & WINDOWS

- All Internal & external doors shall be of sliding type with proper locking arrangements.
- Windows of size 1.20mX1.0m shall be provided as per the drawing with proper locking arrangement.
- Toilet doors shall be of swing doors with proper locking arrangement.

2.07.00 FALSE CEILING

- The False ceiling frame shall be made out of anti corrosive painted 19 mm square tubular section designed to fix to the roof and below the walls using M6 fasteners of suitable length.
- The False ceiling shall be done with polymeric section of minimum 6 mm thick with an air gap of minimum 4 mm.
- These panels are to be joined together by tongue and groove using self tapping screws.
- Cut-outs should be made where ever necessary for Fixing of electrical fittings.
- The above false ceiling shall be provided in addition to the puff insulated roof for better thermal and acoustic insulation



Bharat Heavy Electricals Limited

Power Sector - Southern Region 690, Anna Salai, Nandanam, Chennai - 600 035.

Phone: 044 - 24342458 Fax: 044 -24328516

Email : boopathy.co.in; ram@bhelpssr.co.in

PURCHASE ENQUIRY – TWO PART BID

ENQUIRY No : EC 19091

DATE : 20 01 2010

DUE DATE : 15 02 2010

2.08.00 PARTITIONS

- Partition frames be made up of anti corrosive painted 25 mm 16 SWG thickness square tubular section as per IS 4923 and double side paneling with polymeric section of minimum 6 mm thick with an air gap of minimum 4 mm these panels are joined together by tongue and groove using self tapping screws. Doors for the partitions should be polymeric sliding doors as per layout.
- Site in-charge room should be with full partition & door should have provision of vision panel.
- Sr. Manager Room should be with full partition with top 2Ft shall be of power coated MS Grill and Part cabin shall be with half partitioned.

2.09.00 ELECTRICAL

- The each bunk shall be made with basic lighting with tube lights, 5 Amps points, & required AC points (15Amps) with necessary internal wiring, switches, MCB and DB's.
- Each table should be provided with 2nos 5amps points.
- In conference hall 4nos 5amps points shall be provided.
- In pantry 2nos of 15amps points & 1nos 5amps point shall be provided.
- AC provision: 1) Conference hall - 2nos - 1.5Ton; 2) Project manager/Site in-charge room - 1nos - 1Ton; 3) Reception & visitor lounge - 1nos - 1.5Ton; 4) Balance all bunks should be with 2nos 1.5Ton.
- Each bunk shall be provided with 2nos wall/ceiling mounted fans & 1nos each room. Exhaust fans shall be provided to 1nos each toilet & 1nos. for pantry.

2.10.00 FURNITURE

- Straight table 4ft x 2ft made out of extruded polymeric panel (PVC) manufactured process as per IS 10151/1982. The panel thickness should be 25mm and width should be minimum 300mm and every 4ft 1No. leg should be provided with the same material : as per enclosed drawing .
- File rack shall be of same material as above as per drawing of width min300mm & of height 4Ft. Document section should have file rack of width 300mm, height 5Ft & length of 8Ft.
- Revolving chair: 75Nos, Executive chair Revolving type with high back: 6Nos & Executive table: 5Nos of approved make shall be provided.
- Conference table: To accommodate 16 chairs of approved make shall be provided.
- 2nos -2seator sofas & 1nos-1seator sofa and 1nos tea-table shall be provided as per drawing.

2.11.00 MISCELLANEOUS

- Structural steel Steps shall be provided for the entry and exit of the Bunkhouse.

New #690,ANNA SALAI, PERIAR EVR BUILDING, NANDANAM, CHENNAI 600 035, INDIA

Ph:+91-(0) 44-24342458,24330015 Extn 281 Fax +91 - (0) 44-24328516

E.mail: ram@bhelpssr.co.in ,boopathy@bhelpssr.co.in

Regd. Office: BHEL HOUSE,Siri Fort,New Delhi - 110 049



Bharat Heavy Electricals Limited

Power Sector - Southern Region 690, Anna Salai, Nandanam, Chennai - 600 035.

Phone: 044 - 24342458 Fax: 044 - 24328516

Email : boopathy.co.in; ram@bhelpssr.co.in

PURCHASE ENQUIRY – TWO PART BID

ENQUIRY No : EC 19091

DATE : 20 01 2010

DUE DATE : 15 02 2010

Riser shall not be more than 150mm. Thread shall not be less than 230mm.

3.00.00 BIDDER TO PROVIDE A SET OF DRAWINGS WITH TOTAL DETAILS & SHIPPING LIST OF FURNITURE, ELECTRICAL & PLUMBING ALONG WITH BID DOCUMENT.

4.00.00 GENERAL

All works shall be carried out in proper workmen like manner. Items of works covered by the following specification shall be carried out as per the best practices and according to the direction of the Engineer In-charge / BHEL, Site Engineer and to his satisfaction. Unless otherwise specified in this section or in the description of item, the cost of stage of works mentioned hereunder shall be deemed to have been included in the rates of items provided in the schedule.

Bidders may take note of the following points while sending their offers:

- Agency shall submit two sets of proposed drawings of bunkhouse along with furniture arrangements, Electrical, Plumbing & other fittings etc., to BHEL before commencement of work for approval. Five sets of final drawings, along with one soft copy in CD and one reproducible, shall be handed over to BHEL immediately after finalization of design.
- Bidder to take care of total aesthetics of the office by having all modular electrical & furniture features.
- Bidders are requested to visit Project Site to see the site condition, prevailing local laws etc. No claim shall be entertained to lack of knowledge of site condition.
- The materials and workmanship must be of good quality and accepted standards and specifications. The site engineer reserves the right to reject any material not up to the standard specification. All taxes levies and duties on construction materials will be on contractor's account. After completion of work, the building and areas around them should be cleared of all rubbish, debris etc. and handed over in fit condition for occupation.

5.00.00 DRAWINGS

Following drawings are enclosed strictly for the guidance of the Bidders:

- Structure Layout for BHEL Bunk House.



Bharat Heavy Electricals Limited

Power Sector - Southern Region 690, Anna Salai, Nandanam, Chennai - 600 035.

Phone: 044 - 24342458 Fax: 044 -24328516

Email : boopathy.co.in; ram@bhelpssr.co.in

PURCHASE ENQUIRY – TWO PART BID

ENQUIRY No : EC 19091

DATE : 20 01 2010

DUE DATE : 15 02 2010

GENERAL PURCHASE TERMS AND CONDITIONS FOR ITEM PROCURED IN INDIA

INSTRUCTIONS TO THE VENDORS/BIDDERS:

1. **PURCHASER :** Purchaser shall mean Bharat Heavy Electricals Ltd, a company registered under Indian Companies Act 1956 with registered office at BHEL House, Siri Fort New Delhi -1100049 or its authorized officers or other employees authorized to deal with the matters concerned and having Regional Service Centre at 690, Annasalai, Nandanam, Chennai-600035.
2. **BIDDER/VENDOR:** means to those enquiries have been sent for any purchase.
3. **SELLER:** seller means the successful bidder who is getting the purchase order from BHEL.
4. These purchase specifications as a whole, duly furnishing all the details required and other documents as required in the following pages shall be duly signed and sent in sealed covers duly subscribing the item of purchase proposed as given in the enquiry.
5. Tenders/bids/offers are invited in sealed covers for scope of supply as per the specifications detailed and enclosed to the Enquiry. The offers shall be addressed to Additional general Manager /Purchase & Stores, Bharat heavy Electricals Ltd, Power Sector- Southern Region, 690, Anna Salai, Nandanam, Chennai-600035, Tamilnadu **with the enquiry Number /date and also tender Due date duly superscribed on the cover without fail.**
6. The vendors shall closely peruse all the specifications before quoting. Should the vendor have any doubt about the meaning of any portion of the enquiry or find any discrepancies, or shall require clarifications, he shall at once contact the authority inviting bids for clarifications, before submission of bids.
7. The offers shall be submitted in total compliance of the Terms and Conditions and shall reach the Purchase department before 14.30 hrs on the due date. **OFFER SHALL NOT BE IN DUPLICATE. THE VALIDITY OF THE OFFER SHOULD BE FOR 90 DAYS UNLESS OTHERWISE SPECIFIED.**
8. The offers will be opened at 14.30 hrs on the due date in the presence of Bidders/or their Authorized Representatives who may like to be present.
9. The prices shall be quoted on "F.O.R Destination" basis only unless otherwise specified. The Price shall include all Duties/Taxes as applicable . It also includes Freight and Insurance up to destination.(Consignee). If the bidders prefers to quote only the basic price, then it should be followed by the duties and taxes in percentage as applicable and freight & insurance duly quantified in terms of money. Offers with incomplete information / prices are liable for rejection. **NO PRICE ELEMENTS SHALL BE INDICATED AS EXTRA.**
10. The rates quoted are to both in words and figures. In case discrepancy found between the rates quoted in words and figures, the least of the two will be treated as valid quoted rate.
11. **The prices quoted shall be as applicable to any other Government Organization and a certificate to this effect must be submitted by the vendor without fail. If the rates are covered under DGS&D rates, copy of documents regarding rate contract rate and registration number to be furnished without fail.**
12. The price will be kept firm until the execution of the order and will not be subjected to variation, unless otherwise agreed upon specifically.
13. Payment will be effected only after receipt of total quantity of materials as per PO at the destination within the delivery date stipulated unless otherwise specifically agreed in the purchase order.

New #690,ANNA SALAI, PERIAR EVR BUILDING, NANDANAM, CHENNAI 600 035, INDIA

Ph:+91-(0) 44-24342458,24330015 Extn 281 Fax +91 - (0) 44-24328516

E.mail: ram@bhelpssr.co.in ,boopathy@bhelpssr.co.in

Regd. Office: BHEL HOUSE,Siri Fort,New Delhi - 110 049



Bharat Heavy Electricals Limited

Power Sector - Southern Region 690, Anna Salai, Nandanam, Chennai - 600 035.

Phone: 044 - 24342458 Fax: 044 - 24328516

Email : boopathy.co.in; ram@bhelppsr.co.in

PURCHASE ENQUIRY – TWO PART BID

ENQUIRY No : EC 19091

DATE : 20 01 2010

DUE DATE : 15 02 2010

14. No revision of prices whatsoever will be entertained /accepted after tenders are opened.
15. In case of tender for supply from abroad involving payment of foreign exchange, the price quoted should be separately indicate the foreign components involved and the extent of payment acceptable in Indian currency. **The exchange rate variation is not admitted unless otherwise specifically agreed/mentioned in the enquiry.** The tender also should give the following details without fail.

F.O.B price

Ocean freight/ insurance

Air freight/insurance

Ext gross weight of consignment

Indian agency commission payable in Indian rupees as applicable

16. **"C" FORMS OR CONCESSIONAL SALES TAX DECLARATION FORMS WILL NOT BE ISSUED BY BHEL. THE BIDDER IS REQUESTED TO TAKE CARE OF THIS WHILE SUBMITTING THE OFFER.**

17. **"NO DEVIATION CERTIFICATE"** shall be incorporated in the offer conforming to the terms and conditions of the enquiry.

18. **"LATE TENDERS/BIDS"** : The offers received after tender opening due date will be liable for rejection and shall not be considered.

19. Products with ISI certificates are preferred.

20. Manufacturer's name, Trade mark or patent number if any, should be clearly specified. Illustrative leaflets giving technical particulars/parameters are to be enclosed to the offers along with list of customers / their purchase orders to whom similar product had been supplied, in the past three years.

21. SSI units must highlight the status indicating registration number in their offer without fail for priority payment.

22. **PURCHASE PREFERENCE** : Central Public Sector units registered under company's act 1956 and statutory CPSEs will be eligible for 10% purchase preference to tenders/NITs of Rs 5.00 crores(Rupees five Crores) and above. Joint venture companies where holding of Government and /or CPSE's is 51% or more and Joint ventures which are subsidiaries of CPSEs holding equity 51% or more will also be eligible for the above purchase preference. Please note the instructions operable on the day of enquiry will only be considered. The vendors are requested to refer to the ministry concerned. **Operation of this clause will be in line with the Government directives ,as applicable .**

23. In case the bidder is not interested in /not in a position to quote for this enquiry, the same should be communicated without fail before due date of the tender submission for consideration in subsequent enquiries.

24. In case of participation by the authorized distributors/dealers on behalf of the vendor, the copy of the legal arrangements/terms and conditions agreed between the parties (duly made in stamped paper) should be enclosed. Due intimation in advance shall be given on or before the due date for consideration of such offers. The total responsibility for performance of the work/purchase as per specifications will be with the authorized vendor.

25. **Unless otherwise mentioned, the offers are to be submitted in two parts.**

In such case :

- Two part bids will be submitted separately as (a) – Techno commercial bid and (b) – Price bid in separate sealed covers duly super scribing clearly the name of the bid, enquiry number, due date for submission on both the covers. These two covers should be put in one sealed cover super scribing enquiry number and due date of submission.
- All commercial terms and conditions like payment terms, terms of delivery, guarantee , warrantee etc shall form part of techno commercial bid. The price bid cover shall contain only the price with taxes and duties.

New #690,ANNA SALAI, PERIAR EVR BUILDING, NANDANAM, CHENNAI 600 035, INDIA

Ph:+91-(0) 44-24342458,24330015 Extn 281 Fax +91 - (0) 44-24328516

E.mail: ram@bhelppsr.co.in ,boopathy@bhelppsr.co.in

Regd. Office: BHEL HOUSE,Siri Fort,New Delhi - 110 049



Bharat Heavy Electricals Limited

Power Sector - Southern Region 690, Anna Salai, Nandanam, Chennai - 600 035.

Phone: 044 - 24342458 Fax: 044 - 24328516

Email : boopathy.co.in; ram@bhelpssr.co.in

PURCHASE ENQUIRY – TWO PART BID

ENQUIRY No : EC 19091

DATE : 20 01 2010

DUE DATE : 15 02 2010

- **Combined bids containing both techno commercial and price details together contained in one single cover will be rejected.**
- Techno/ commercial bid shall contain the total scope of work/purchase detailed in the specifications of the enquiry .
26. **QUATATIONS** : All documentation and correspondence regarding the Contract/Purchase **shall be in English language and international numerals only**. The rates quoted shall be in figures as well as in words. In case of difference between the words and figures, the least of the two will be treated as valid quoted rate. All entries shall be either be typed or to be written in ink. Erasers and over writing is not permitted and may render such bids be liable for rejection. All the cancellations and insertions shall be duly attested by the bidder. Wherever Sales tax is claimed, the Central or state Sales registration number should be given both in the offer as well as in the invoice/bill. Please refer the conditions in case of tender for supply from abroad involving payment of foreign exchange. (Clause no 15)
27. **SAMPLES**: sample should be submitted along with the offer, if asked for.
28. **INSPECTION & ACCEPTANCE OF GOODS**: It is subject to BHEL inspection at supplier's works before dispatch or on receipt at destination as the case may be, as per the agreed/approved Quality plan. Final / stage inspection will be carried out at the destination/ supplier's works by the authorized inspection official in line with agreed quality plan. Wherever preliminary or stage inspection is to be carried out at supplier's works, the same is subject to final acceptance after receipt of the material at the destination and the decision of the Purchaser shall be final. The property of goods shall not pass until final acceptance by the purchaser. In case of delay in inspection process for reasons attributable to the seller, the financial loss /liability sustained by the purchaser shall be borne by the supplier. Since delivery period includes the time for pre dispatch inspection by BHEL, the supplier shall intimate the readiness of material for inspection well in advance to expedite the inspection process and to enable the supplier effect delivery in time.
29. **QUALITY PLAN** : BHEL may give the quality plan of their own else may request the vendor to submit the quality plan along with the offer , as applicable, for approval by BHEL. (please refer specifications) The quality plan is expected to cover generally specification of the items, stage inspections to be carried out, guarantee/warranty /test certificates/inspection reports, sampling plan as per IS . BHEL will also identify the inspection agency including the customer, as applicable. The bidder/vendor shall furnish the details of the inspection facilities available with him in the quality plan, as applicable. The quality Plan will be finalized before proceeding with execution of PO. The vendor is requested to ensure completion of QP in all aspects before proceeding with PO. The vendor should provide calibrated instruments etc for carrying out the inspection as per the quality plan.
30. **REJECTION** : The seller shall intimate the purchaser in writing within 15 days after receipt of rejection advice regarding the disposal of rejected material **and action plan for replacement** . If no information is received within this time, the purchaser shall be at liberty to return the material at the cost of risk of the seller after recovering the cost if any, including inward freight and other incidental charges incurred. The purchaser will not be responsible for the rejected material thereafter and no claim will rest on them.

31. PACKING , MARKING & FORWARDING :

PACKING : the supplier shall arrange for secure protective packing of the goods suitable for tropical conditions to avoid loss, damage or atmosphere action during transit by road/train/air. The packing standard shall comply with relevant national standards, where available, carriers' conditions of packing or established trade practice. The seller shall be liable to replace the material or reimburse the value of the loss not withstanding whether insurance is arranged by him or not. The packing materials and cases **and packing charges are included in the quoted price** unless otherwise agreed.

MARKING: The following marking shall be made on each package in BLACK BOLD CAPITAL LETTER:

- BHEL CONSIGNOR DIMENSION
 - PSSR CONSIGNEE WEIGHT : GROSS & NET
 - The above marking should be stenciled or written in bold letters on the package.
- Should the packages be too small, suitable cards/metal tags giving these details may be tagged

New #690,ANNA SALAI, PERIAR EVR BUILDING, NANDANAM, CHENNAI 600 035, INDIA

Ph:+91-(0) 44-24342458,24330015 Extn 281 Fax +91 - (0) 44-24328516

E.mail: ram@bhelpssr.co.in ,boopathy@bhelpssr.co.in

Regd. Office: BHEL HOUSE,Siri Fort,New Delhi - 110 049



Bharat Heavy Electricals Limited

Power Sector - Southern Region 690, Anna Salai, Nandanam, Chennai - 600 035.

Phone: 044 - 24342458 Fax: 044 - 24328516

Email : boopathy.co.in; ram@bhelpssr.co.in

PURCHASE ENQUIRY – TWO PART BID

ENQUIRY No : EC 19091

DATE : 20 01 2010

DUE DATE : 15 02 2010

or nailed. Copy of the
without fail.

packing slip should be kept in each package

DESPATCH INTIMATION: immediately after dispatch, the Seller shall intimate AGM/Purchase BHEL PSSR Chennai the details of the items dispatched, quantity, order reference, LR/RR No and date by telegram/fax/e-mail.

32. **TERMS OF PAYMENT:** Payment shall be made as per the following terms unless otherwise specified..

➤ ~~Where only supply is involved, 100% payment will be made within 30 days of satisfactory receipt of materials and on submission of Performance Bank Guarantee valid till completion of Guarantee Period and against submission of Store receipt voucher (SRV)/FARV (fixed asset acceptance receipt voucher)/MRV (material receipt voucher). These vouchers are issued by the consignee only.~~

➤ Where installation and commissioning is involved, 90% payment will be released within 30 days of satisfactory receipt of materials and acknowledgement (as per SRV/FARV/MRV) and balance 10% will be paid after successful installation and commissioning and on submission of Bank Guarantee for the 10% value valid up to the guarantee period agreed between BHEL and the Vendor .

33. **SECURITY DEPOSIT :** Where required , Security deposit or Bank guarantee shall be submitted for a sum equal to 10% of the total value of the order on receipt of confirmed purchase order from BHEL .(please refer specifications for applicability)

34. **LIQUIDATED DAMAGES & RISK PURCHASE:** Seller is to understand that "Time is the essence of the contract". Hence the delivery of the goods as mutually agreed, specified in the purchase order should be adhered to within the time mentioned. Where the seller supplies/dispatches the materials beyond the delivery date, as specified in the order, the Purchaser will have no obligations to accept the goods.

The Purchaser reserves the right to levy liquidated damages @ ½ percent of the value of the goods delayed beyond the due date, for each week of delay or part thereof without prejudice to any other relief or compensation due to Purchaser under any other conditions of the order subject to a limit of 5%, unless the delivery extension is given. In case of delay in receipt of materials at the delivery point, for reasons not attributable to BHEL , the Purchaser will levy LD, if time extension and PO amendment is not issued. The vendor should request Purchaser for amendment to PO for time extension if reasons are **not** attributable to him before submission of invoice.

35. in addition to the above , in case the vendor shall fail to complete the supply of the any of the materials within the specified time (either partially or fully), it shall be lawful for BHEL PSSR Chennai ,to procure the same at the risk and cost of the supplier. In such event it will be obligatory on the part of the supplier to pay the additional expenditure incurred to BHEL PSSR for any loss due to such risk purchases.

36. **INSURANCE:** wherever delivery terms quoted for FOR Destination specifically agreed to and directed, the supplier shall insure at his cost the goods for all transit risks including 30 days storage risks from the date of delivery of goods at the final destination. In other cases, supplier must furnish of dispatch of each consignment immediately after dispatch. Failure to do this will make the supplier responsible for making good any loss which might have been recovered from the under -writers.

37. **SUBCONTRACTING:** This order or any part thereof shall not be subcontracted without the consent of the Purchaser. The total responsibility for the supply and performance of purchased items, as per guarantee rests with the seller, even if BHEL accepts the above arrangement..

38. **METRIC SYSTEM :** Seller shall indicate all the measurements only in Metric system.

39. **INDEMNITY:** Seller shall indemnify the Purchaser against any claim due to breach of patent, trademark, negligence, defective material, or injury to seller or his agent

40. GUARANTEE & WARANTEE :

New #690,ANNA SALAI, PERIAR EVR BUILDING, NANDANAM, CHENNAI 600 035, INDIA

Ph:+91-(0) 44-24342458,24330015 Extn 281 Fax +91 - (0) 44-24328516

E.mail: ram@bhelpssr.co.in ,boopathy@bhelpssr.co.in

Regd. Office: BHEL HOUSE,Siri Fort,New Delhi - 110 049



Bharat Heavy Electricals Limited

Power Sector - Southern Region 690, Anna Salai, Nandanam, Chennai - 600 035.

Phone: 044 - 24342458 Fax: 044 - 24328516

Email : boopathy.co.in; ram@bhelpssr.co.in

PURCHASE ENQUIRY – TWO PART BID

ENQUIRY No : EC 19091

DATE : 20 01 2010

DUE DATE : 15 02 2010

- The items purchased are to be guaranteed for satisfactory performance for a period of 12 (twelve) months from the date of commissioning or putting into use or for 18 (eighteen) months from the date of dispatch, whichever is earlier unless otherwise specified.
 - If any defect is noticed during the above period, the same shall be replaced free of cost on FOR Chennai/destination basis within a reasonable time. The time for replacement based on the component and urgency will be intimated by BHEL and the vendor should replace the items.
 - To this effect Guarantee / manufacturer's test certificate shall be furnished along with the original documents.
41. Three sets of Operation & maintenance manuals/ technical literature, drawings etc are to be supplied free of charges along with the items being procured.

42. DISPUTES, ARBITRATION & JURISDICTION ;

- All disputes between the Purchaser and the seller arising out of this transaction, other than those for which decision of the BHEL is final, shall after written notice by either part to the PO to other party by referred to sole arbitration of Executive Director or his nominee.
 - The Arbitrations shall be conducted in accordance with provisions of Arbitration and Conciliations Act 1996. The Purchase will be governed by the law for the time being in force in the Republic of India.
 - The civil court having ordinary original Jurisdiction at Chennai, Tamilnadu alone have exclusive jurisdiction in regard to all claims in respect of this transaction/ purchase. No other civil court have jurisdiction in case of dispute, of this contract.
43. **GENERAL :** All other conditions which might have been quoted by the Seller and are in contravention to the terms prescribed in the order and which have not been specifically accepted in writing by the Purchaser will not be applicable to this order. The Seller should intimate the Consignee in writing regarding the readiness of material, in cases where Purchaser has agreed to arrange collection with a copy to AGM/Pur/BHEL PSSR Chennai.
44. ANY REFERENCE MADE HEREIN (ENQUIRY/PURCHASE ORDER) TO ANY OF THE NATIONAL/INTERNATIONAL STANDARDS IMPLIES IT'S LATEST EDITION FOUND OTHERWISE.
45. THE VENDORS SHOULD SUBMIT GUARANTEE, SOUNDNESS & BONAFIDE CERTIFICATES WHILE SUPPLYING THE ITEMS. SUGGESTED FORMAT IS GIVEN UNDER 44.1, 44.2 & 44.3

PROFORMA (TYPICAL)- TO BE FURNISHED BY THE SELLER WHILE SENDING MATERIALS

44.1 GUARANTEE Certificate : Certified that the materials dispatched vide RR/LWB/PBW nodated conform to the quality as per specification of the Purchaser vide PO No Dated and guaranteed for 12 months from the date of putting the same to actual use /consumption /commissioning or 18 months from the date of dispatch whichever is earlier against all manufacturing defects, faulty materials, bad workmanship etc. if any defect is noticed during the above period, the defective materials shall be replaced or rectified free of cost on FOR/Chennai/destination basis within a reasonable time.

Date : signature with seal

44.2 SOUNDNESS CERTIFICATE : certified that the materials dispatched under RR/LWB/PWB Nodatedcovered by our invoice No Datedfor Rs.....against yourorder.....datedwere in a sound condition at the time of dispatch. The material supplied against this order conforms to the specification mentioned therein and if found defective at the time of inspection by you, the same will be replaced free of cost.

Date : signature with seal

New #690, ANNA SALAI, PERIAR EVR BUILDING, NANDANAM, CHENNAI 600 035, INDIA

Ph:+91-(0) 44-24342458,24330015 Extn 281 Fax +91 - (0) 44-24328516

E.mail: ram@bhelpssr.co.in , boopathy@bhelpssr.co.in

Regd. Office: BHEL HOUSE, Siri Fort, New Delhi - 110 049



Bharat Heavy Electricals Limited

Power Sector - Southern Region 690, Anna Salai, Nandanam, Chennai - 600 035.

Phone: 044 - 24342458 Fax: 044 -24328516

Email : boopathy.co.in; ram@bhelpssr.co.in

PURCHASE ENQUIRY – TWO PART BID

ENQUIRY No : EC 19091

DATE : 20 01 2010

DUE DATE : 15 02 2010

- 44.3 BONAFIDE CERTIFICATE :** I have personally examined and verified and do hereby certify that the goods in respect of which the payment is being claimed have actually dispatched by me /us under RR/LWB/Air consignment Note No.....Postal receipt Number..... Duly drawn in favour of the consignee which is genuine and mentioned in the bill and I hold myself personally responsible for the correctness of this statement.
I further certify that the above mentioned RR No...../LWB No...../Air consignment Note No...../ postal receipt No.....has been forwarded to the consignee mentioned in the Purchase order under Registered Post with acknowledgement due.

Date :

signature with seal

- 46.** The purchaser reserves the right to cancel or split-up the tender /offer and place order for individual items with different vendors with varying quantities in line with the enquiries.
- 47. FORCE MAJURE :** the following shall amount to force majeure – Acts of God, Acts of government, war, sabotage, riots, civil commotion, police action, revolution, flood, fire, cyclone, earthquake, epidemic and other similar causes over which the vendor is not having any control. If the vendor suffers delay in fulfilling the obligations due to force majeure, as defined above, BHEL will grant only delivery time extension, by a period of time equal to the period of delay provided that on the occurrence of any such contingency, the vendor shall immediately reports to BHEL in writing the causes of delay. The vendor is not eligible for any other compensation.



Bharat Heavy Electricals Limited

Power Sector - Southern Region 690, Anna Salai, Nandanam, Chennai - 600 035.

Phone: 044 - 24342458 Fax: 044 - 24328516

Email : boopathy.co.in; ram@bhelpssr.co.in

PURCHASE ENQUIRY – TWO PART BID

ENQUIRY No : EC 19091

DATE : 20 01 2010

DUE DATE : 15 02 2010

Annexure I

4. GENERAL TERMS AND CONDITIONS OF REVERSE AUCTION (RA)

Against this NIT for the subject work, tender may be processed through Reverse Auction mode i.e., ON LINE BIDDING ON INTERNET. The General Terms and conditions of the RA shall be as follows:

1. For the proposed reverse auction, technically and commercially acceptable bidders only shall be eligible to participate.
2. BHEL will engage the services of a service provider who will provide all necessary training and assistance before commencement of on line bidding on internet.
3. BHEL will inform to the vendor in writing, in case of reverse auction along with the details of Service Provider to enable them to contact & get trained.
4. "Business rules" like event date, time, Start price, bid decrement extensions etc., also will be communicated through service provider for compliance.
5. Vendors have to fax the Compliance form in the prescribed format (provided by Service provider) before start of Reverse auction.
6. BHEL will provide the calculation sheet (eg., EXCEL sheet) which will help to arrive at "Total Value Based on Rate Schedule".
7. Reverse auction will be conducted on scheduled date & time
8. At the end of Reverse Auction event, the lowest bidder value will be known on the network.
9. The lowest bidder has to Fax the duly signed Filled-in prescribed format as provided on case-to-case basis to BHEL through Service provider within 24 hours of Auction without fail.
10. During Reverse Auction, if no bid is received within the specified time, BHEL at its discretion, may decide to revise opening price/scrap the reverse auction process/proceed with conventional mode of tendering.
11. Sealed bid Reverse Auction : The opening bid (in the initial auction) of the bidders shall be same as the quoted in their Final Sealed price submitted to BHEL. The bidders shall confirm in writing to BHEL that their opening bid (in both cases) shall be same as that quoted in their final sealed price bids submitted to BHEL against this NIT along with Technical Bid (Part-I).
12. Bids-given by the bidders during the Reverse Auction process will be taken as an offer to execute the work. Bids once made by the bidder, can not be cancelled/withdrawn and bidders shall be bound to execute the work as mentioned above at the final bid price. Should be bidder (Lowest) back out and not execute the contract as per the rates quoted. BHEL shall take action as appropriate.
13. BHEL reserves the right to cancel Reverse Auction (RA) without assigning any reasons and resort to considering the sealed bids submitted by vendor for processing and finalizing the tender.
14. Any variation between the on-line bid value and the signed document will be considered as sabotaging the tender process and will invite disqualification of vendor to conduct business with BHEL as per prevailing procedure.
15. In case BHEL decides not to go for Reverse Auction procedure for the tender enquiry, the Price bids and price impacts. If any, already submitted and available with BHEL shall be opened as per BHEL's standard practice.

New #690, ANNA SALAI, PERIAR EVR BUILDING, NANDANAM, CHENNAI 600 035, INDIA

Ph:+91-(0) 44-24342458,24330015 Extn 281 Fax +91 - (0) 44-24328516

E.mail: ram@bhelpssr.co.in , boopathy@bhelpssr.co.in

Regd. Office: BHEL HOUSE, Siri Fort, New Delhi - 110 049



Bharat Heavy Electricals Limited

Power Sector - Southern Region 690, Anna Salai, Nandanam, Chennai - 600 035.

Phone: 044 - 24342458 Fax: 044 - 24328516

Email : boopathy.co.in; ram@bhelpssr.co.in

PURCHASE ENQUIRY - TWO PART BID

ENQUIRY No : EC 19091

DATE : 20 01 2010

DUE DATE : 15 02 2010

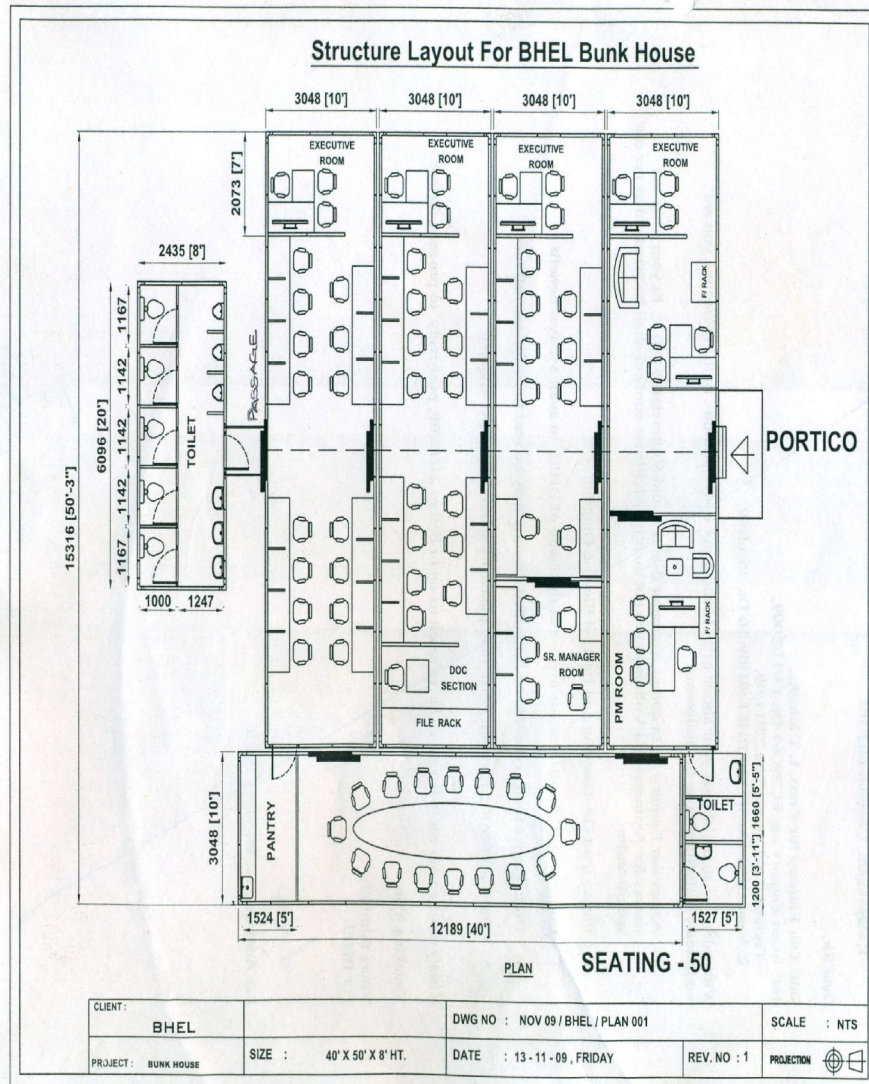

New #690, ANNA SALAI, PERIAR EVR BUILDING, NANDANAM, CHENNAI 600 035, INDIA

Ph: +91-(0) 44-24342458, 24330015 Extn 281 Fax +91 - (0) 44-24328516

E.mail: ram@bhelpssr.co.in , boopathy@bhelpssr.co.in

Regd. Office: BHEL HOUSE, Siri Fort, New Delhi - 110 049