



BHARAT HEAVY ELECTRICALS LTD.
 (A GOVT. OF INDIA UNDERTAKING)
 P.O BHEL Jhansi - 284129, INDIA
 Tel.:0510-277001/2412260 Fax: 2412120
 Email : mmx@bheljhs.co.in

PURCHASE ENQUIRY

ENQ NO/DT: E5420009 17/06/22
 REV NO/DT: 0 17/06/22

PAGE 1
 4

PLEASE SEND YOUR BEST QUOTATION AS PER TERMS & CONDITIONS AND REMARK MENTIONED UNDERNEATH.	
Enq Due on:	09-07-22 SATURDAY
Close at:	13:15 Open at:14:00
Matcat:	540031 Rose Courtney
Validity:	120 days from Technical bid opening date
IEM:	
TOP:	See Special Remarks
REQUIRED: TEST CERT/ SEE REMARKS	RA:RA not applicable
Est. Value:	Item wise
Bid Type:	TWO BID
Tot Item:	1
Delivery:	FOR Jhansi
E-Proc:	Yes

ITEM NO : 1 PSL QTY/UM: 25000.00 NO
 MATL CODE : JS7433131020 PO QTY /UM: 25000.00 NO
 DESTINATION: JS

DESCRIPTION	DELIVERY	QUANTITY (PSL UM)
ROSE COURTNEY 2BA (6MM) KLIPPON MAKE OR EQUIVALENT TERMINAL WITH WASHER LARGE SIZE-OBA:CAT.NO.-0085. AS PER ATTACHED DRAWING	AUG-22	25000.00

SPECIAL REMARKS:

- NOTE# OFFER SHALL BE CONSIDERED ONLY NIC MODE OTHERMODE WILL NOT CONSIDER. C
- 1- MANDATORY SHEET & PQR TO BE SUBMITTED ALONG WITH OFFER DULY FILLED WITH SIGNED AND SEALED.
 - 2- VENDOR TO SUBMIT OFFERS IN TWO BID. OFFERS RECEIVED IN SINGLE BID MAY NOT BE CONSIDERED. VENDOR ARE REQUESTED KINDLY FURNISH CLAUSE WISE COMMENTS ON ALL ENQUIRY CLAUSES. IF ANY VENDOR NOT COMMENTED IN THIS SITUATION IT WILL BE ASSUMED THAT ALL ENQUIRY CLAUSES ARE ACCEPTED TO THEM.
 - 3- VENDOR HAS TO CONFIRM TO SUPPLY ITEM AS PER DESCRIPTION OF ENQUIRY (COMPLETE DESCRIPTION OF ITEM) IN TECHNO COMMERCIAL BID.
 - 4- DELIVERY TERMS:
I- RATES ARE TO BE QUOTED F.O.R. BHEL JHANSI (INCLUSIVE OF FREIGHT& INSURANCE CHARGES).
 - 5- VALIDITY - QUOTED PRICES ARE VALID FOR 120 DAYS FROM DATE OF TENDER OPENING.
 - 6- LIQUIDATED DAMAGE/PENALTY -FAILURE TO SUPPLY BY THE TIME SPECIFIED IN THE ORDER WILL MAKE THE SUPPLIER LIABLE TO PAY UNCONDITIONAL PENALTY OF 0.5 % OF THE PRICE OF THE GOODS IN ARREAR (DELAYED AND NOT SUPPLIED)PER WEEK SUBJECT TO A MAXIMUM OF 10% OF THE ORDER VALUE. IN CASE OF NON ACCEPTANCE OF BHEL L/D CLAUSE THE SUITABLE LOADING UP TO 10% SHALL BE DONE ON SUPPLIERS QUOTED RATE TO ARRIVE THE L-1 STATUS.
 - 7- TERMS OF PAYMENT :
I- 100 % PAYMENT WITHIN 90 DAYS (45 DAYS FOR MSE / NSIC REGISTERED SUPPLIERS AS PER RELEVANT ACT IN FORCE) FROM THE DATE OF RECEIPT OF MATERIAL AND SUBMISSION OF CLEAR AND ADMISSIBLE BILL, SUBJECT TO ACCEPTANCE OF MATERIAL AT BHEL , ON DIRECT PRESENTATION OF THE DOCUMENTS.
II- PAYMENT TERMS MSMED ARE ALSO ACCEPTABLE PROVIDED VENDOR HAS TO SUBMIT MSMED LATEST CERTIFICATE.
III- ADVANCE OR PRIOR TO DISPATCH OR CAD PAYMENT TERMS WILL NOT BE ACCEPTED AND IF QUOTED OFFER WILL BE REJECTED.
 - 08- VENDOR HAS TO MENTION THEIR CONTACT NUMBER, NAME OF CONTACT PERSON



BHARAT HEAVY ELECTRICALS LTD.
(A GOVT. OF INDIA UNDERTAKING)
P.O BHEL Jhansi - 284129, INDIA
Tel.:0510-277001/2412260 Fax: 2412120
Email : mmx@bheljhs.co.in

PURCHASE ENQUIRY

ENQ NO/DT: E5420009 17/06/22
REV NO/DT: 0 17/06/22

PAGE 2
4

EMAIL ID AND FAX NUMBER, IN THEIR OFFER.

- 9- ALL THE TAXES AND DUTIES APPLICABLE ARE TO BE MENTIONED.
BIDDERS ARE ADVISED TO NOTE & STRICTLY FOLLOW THE TIME SCHEDULES AS NOTED AT PRECEDING PARA'S ABOVE TO AVOID INCONVENIENCE LATER AND POSSIBILITY OF NON ACCEPTANCE OF TENDER BY BHEL.
- 10- VENDOR TO CONFIRM ALL THE CLAUSE OF THE ENQUIRY IN THEIR TECHNICAL BID. COPY OF BLANK PRICE BID TO BE SUBMITTED WITH TECHNICAL BID.
- 13- VENDORS TO CONFIRM ALL THE GENERAL TERMS AND CONDITION OF THE ENQUIRY IN THE TECHNICAL BID.
- 14- THIRD PARTY INSPECTION NOT REQUIRED.
- 15- INSPECTION SHALL BE DONE AFTER RECEIPT OF MATERIAL AT OUR STORE.
- 16- TEST CERTIFICATE MUST BE SUBMITTED ALONG WITH CHALLAN.

In case the bidder has not submitted PAN No, TIN No. and E-mail ID, the bidder has to submit the same along with the copy of PAN No and TIN No. Else his offer will be liable to be rejected.

If you are not in a position to quote due to any reason, you must send regret letter titled enquiry no. etc, failing which you may not be considered for sending future enquiries.

ENCLOSERS:



BHARAT HEAVY ELECTRICALS LTD.
(A GOVT. OF INDIA UNDERTAKING)
P.O BHEL Jhansi - 284129, INDIA
Tel.:0510-277001/2412260 Fax: 2412120
Email : mmx@bheljhs.co.in

PURCHASE ENQUIRY

ENQ NO/DT: E5420009 17/06/22
REV NO/DT: 0 17/06/22

PAGE 3
4

FOR AND ON BEHALF OF
BHARAT HEAVY ELECTRICALS LTD

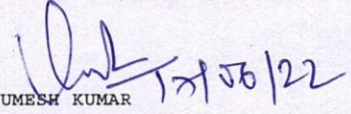
UMESH KUMAR
DY MANAGER (CRX)
Email:-umeshkr@bhel.in

***** END OF PURCHASE ENQUIRY*****

NOTE :

- * THE BIDDER IS INFORMED THAT THE GENERAL TERMS & CONDITIONS OF ENQUIRY (JHS 2055A Rev 03) WHICH ARE UPLOADED AT <https://www.bheljhs.co.in/apps/sip/index.php> AT (TERMS & CONDITION -> FOR ENQUIRY) LINK, ARE TO BE READ BY THE BIDDER BEFORE SUBMITTING QUOTE IN THE ENQUIRY. BHEL SHALL CONSTRUCE THE PARTICIPATION BY THE BIDDER IN ENQUIRY AS ACCEPTANCE TO THE GENERAL TERMS AND CONDITIONS OF ENQUIRY.
- * SUPPLIERS ARE REQUESTED TO INFORM US WITH VALID CERTIFICATE, IF THEY ARE REGISTERED UNDER MSMED ACT'2006. (APPLICABLE FOR INDIAN SUPPLIERS ONLY).
- * FOR SUPPLIERS SUPPLYING FROM OUTSIDE THE LOCAL AREA OF BHEL JHANSI, ENTRY TAX WILL BE APPLICABLE. SUPPLIERS SHOULD NECESSARILY INDICATE RATE OF ENTRY TAX SEPARATELY WHEREVER APPLICABLE. THEY SHOULD ALSO MENTION THE ENTRY TAX CHARGED SAPARATELY IN THE INVOICE.
- * FOR SUPPLIERS SUPPLYING FROM OUTSIDE UP, IN CASE THE OFFER IS SILENT ON ENTRY TAX, IT SHALL BE LOADED SUITABLY WITH THE APPLICABLE RATES
- * IN CASE IF THERE IS ANY DIFFERENCE BETWEEN THE 'SPECIAL REMARKS/ANNEXURES' OF THE ENQUIRY AND THE PREPRINTED TERMS & CONDITIONS (REF JSC140/M2053), THE REQUIREMENT GIVEN IN REMARKS WILL PREVAIL.
- * Reference Sl. No. 2(B) of General Terms and Conditions regarding option for offer submission through Email addressed to tenderbox.jhs@bhel.in , please note that the maximum mail size including attachments should not exceed 20 MB , otherwise the offer shall not be delivered due to size limitation and bidder sending mail attachments more than 20 MB will have no claim whatsoever on the subject tender . Also due to any technical snag , if offer has not reached tenderbox.jhs@bhel.in , it will be bidder's sole responsibility to ensure offer submission through alternate routes before the due date and time .BHEL will not entertain any such claim for non-receipt of offer on time .

The information on this document is the property of Bharat Heavy Electricals Limited. It must not be used directly or indirectly in any way detrimental to the interest of the company

First Angle Projection

All dimensions in 'mm'

REV 00	DATE 09/10/2021	ALTERED SV CHECKED SV APPROVED SSY1	ADDITIONAL INFORMATION 99999999999						
ZONE			STATUS OF DRAWING						
TRE			DISTRIBUTION OF PRINTS						
PPC			BAY 1&2	BAY 3, 4&5	BAY 6&7	BAY 8	BAY 9	LHM	Other
									0

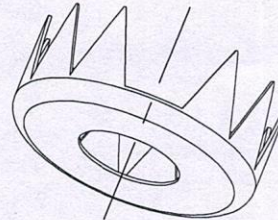
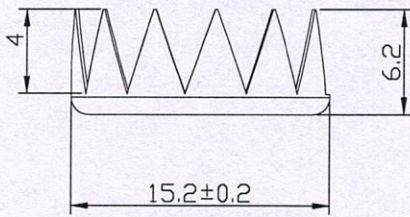
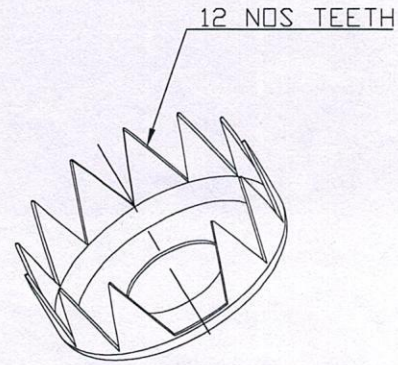
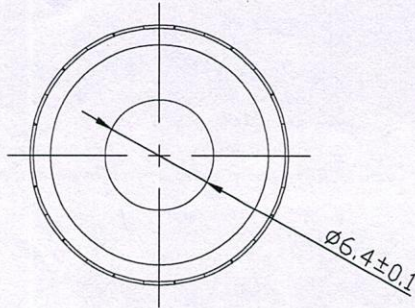

MINIMUM MATERIAL THICKNESS - 0.2±0.02

NOTE:-

MATERIAL OF TERMINAL SHALL BE BRASS FINISH 15 MICRON COATING OF TIN(E.T.) GRADE Sn 15C OF IS:1359.

REF. DRG. NO.

SIGN AND DATE

INVENTORY NO.

TYPE OF PRODUCT		OR					
NAME OF CUSTOMER/PROJECT				STD			
	BHARAT HEAVY ELECTRICALS LTD.		DRN	SV	06/10/2021	NO. OF VAR	
	JHANSI		CHD	SV	06/10/2021		
			APPD	SSY1	09/10/2021		
DEPT-TRE	UN. TOL. DIM. C/M/F		SCALE	WEIGHT [KG]	REF. TO ASSY. NO.	ITEM NO	NO. OF ITEM
CODE-406							
TITLE				DRAWING NO.		REV.	
ROSS COURTNEY TERMINAL				44998250020		00	
				SHT NO 1		NO OF SHT 1	



TECHNO-COMMERCIAL BID (Part-1)

QUOTATION NO.....DATE.....

SUPPLIER'S NAME:.....

SL	Particulars	Supplier's Confirmation
1-	Complete acceptance for supply of items as per Purchase / Tech. specification mentioned in the enquiry & annexure enclosed with enquiry.	<input type="checkbox"/> Accepted
2-	Guarantee / Warrantee / Conformance / Test Certificate (along with supply) as specified in enquiry will be provided.	<input type="checkbox"/> Yes
3-	Delivery Period 30 Days from date of PO issue.	<input type="checkbox"/> Accepted
4-	Taxes & Duties :- Extra as applicable (Indigenous bidders to indicate following)	<input type="checkbox"/> Accepted
	(a) IGST (mention NA if not applicable)%
	(b) CGST (mention NA if not applicable)%
	(c) SGST (mention NA if not applicable)%
5-	Price bid submitted as per attached price bid format only (Copy of blank price bid is to be submitted with techno commercial bid.)	<input type="checkbox"/> Yes
6-	Terms of Delivery on F.O.R BHEL Jhansi basis. As per clause-6(A) of GTC (Including freight & Insurance)	<input type="checkbox"/> Accepted
7-	Basic rate quoted is inclusive of Packing & forwarding	<input type="checkbox"/> Yes / No
8-	If answer to SL. No. 7 is 'No', Mention Packing & forwarding charges as % of basic rate or actual	Rs..... or.....%
9-	Quoted rate is firm basis and no PVC is applicable.	<input type="checkbox"/> Yes
10-	Offer should remain valid up to 120 days from the tender opening date	<input type="checkbox"/> Accepted
11-	Rev-3 of General Terms & Conditions of Enquiry (COPY ATTACHED WITH ENQUIRY) has been read by us and we confirm acceptance of all the General Terms & Conditions of Enquiry. Rev-3 of General Terms & Conditions of Enquiry is also uploaded at https://www.bheljhs.co.in	<input type="checkbox"/> Accepted
12-	Inspection - Material may be source inspected by BHEL / Customer / Third party. However, Final inspection for acceptance of quality and quantity shall be done at BHEL's works after receipt of material and results shall be binding on the suppliers	<input type="checkbox"/> Accepted



BHARAT HEAVY ELECTRICALS LIMITED, JHANSI-284120

(A Govt. of India Undertaking)

Material Management

Mandatory Sheet for Enquiry No: E5420009

22

13-	Payment Terms (Refer Clause-15 of GTC of Enquiry)-Indigenous 100% payment within 90 days (45 days for MSE / NSIC registered suppliers as per relevant act in force) from the date of receipt of material and submission of clear and admissible bill, subject to acceptance of material at BHEL, on direct presentation of the documents. (Note: Any other payment terms shall be loaded for deviation period @ (SBI Base Rate + 6%) per annum.	<input type="checkbox"/> Accepted
14-	Acceptance to LD / Penalty for delayed performance (Including Risk purchase) as per clause-8 (A to C) of GTC.	<input type="checkbox"/> Accepted

Date :

Name of Contact Person :

Cell No. :

Email :

Signature of Supplier with Stamp :



BHARAT HEAVY ELECTRICALS LIMITED, JHANSI-284120

(A Govt. of India Undertaking)

Material Management

Mandatory Sheet for Enquiry No: E5420009

21

Part-1

BLANK PRICE BID

Supplier Name & Address:

Enquiry Item No.	Quoted rate in figure (Rs/NO)	Quoted rate in words (Rs/NO)
Enq. # 1	Quoted/ Not Quoted	Quoted/ Not Quoted

Note: The price bid submitted in any other fashion or by adding any condition (e.g. minimum order quantity, rates applicable for specified quantity, discount for quantity, rate based on slabs, rate based on terms of payment etc.), offer shall be straight way REJECTED even if, offer has been found technically & commercial acceptable before opening of price bid.

Date :

Name of Contact Person :

Cell No. :

Email :

Signature of Supplier with Stamp :

Pre -Qualifying Requirement (PQR) E5420009

SL	DESCRIPTION	VENDOR'S CONFIRMATION
1	Vendor should have GSTIN Registered vendor. Attach copy of self-attested copy of GSTIN Certificate	GSTIN NO..... VENDOR TO FURNISH
2	Is vendor OEM or Dealer (PI tick as applicable) in case the vendor is dealer then, valid authorised Dealer certificate from OEM to be submitted	OEM..... Dealer..... Attached Authorised Dealer Certificate: YES / NO
3	Experience Bidder should have supplied similar item in last 2 years to any industry from date of enquiry. (Copy of purchase order/ to be furnished)	Qualifying for Experience Criteria: YES / NO Document Submitted VENDOR TO FURNISH
4	Vendor should have PAN card (Income tax dept.) Attach copy of self-attested copy of GSTIN Certificate	PAN NO..... VENDOR TO FURNISH
5	Vendor to be submitted self-Declaration A self-declaration is to be submitted that the party has not been delisted/ blacklisted/banned from any units of BHEL or any Govt.department/ Govt. undertaking and no case of fraud/ dishonesty etc. is pending in any court of law against the party/firm.	ACCEPTED VENDOR TO ACCEPTED

19

6	BHEL reserve the right to verify information submitted by vendor or call for sample DEMONSTRATION. In case the information is found to be false / incorrect, OR sample TRIAL / PERFORMANCE not satisfactory, the offer/ item shall be rejected.	ACCEPTED VENDOR TO ACCEPTED
---	---	---

Supplier Name:

Signature of Supplier with Stamp :