

THE INFORMATION ON THIS DOCUMENT IS THE PROPERTY OF BHARAT HEAVY ELECTRICALS LIMITED. IT MUST NOT BE USED DIRECTLY OR INDIRECTLY IN ANY WAY DETRIMENTAL TO THE INTEREST OF THE COMPANY.

REV.	DATE	ALTERED	S.D.B.	REV.	DATE	ALTERED	S.D.B.	ADDITIONAL INFORMATION
02	01.11.17	CHECKED	S.B. Sarvek Shukla	01	11.08.17	CHECKED	S.B. Sarvek Shukla	STATUS OF DRAWING
		APPD.	S.B. Sarvek Shukla			APPD.	S.B. Sarvek Shukla	DISTRIBUTION OF PRINTS
IN BOM SPEC. OF ITEM 001 CHANGED FORM TM97243 TO BP12077 FOR STANDARDIZATION. NOTE-2 DELETED.				DIMs. 478, 7.1, R3.55 & 37.5 WERE 403, 6.5, 3.25 & 37. IN BOM. 7.1X37.5X478 & WT.1.09 WERE 6.5X37X403 & WT 0.75.				TME - 1, TNX - 1, TXM - 3
REV.	DATE	ALTERED	S.D.B.	REV.	DATE	ALTERED	S.D.B.	
03	27.12.17	CHECKED	S.B. Sarvek Shukla	04	22.06.18	CHECKED	S.B. Sarvek Shukla	
		APPD.	S.K.Y.			APPD.	S.B. Sarvek Shukla	
NOTE-4 ADDED.				IN BOM MATL. SPEC. DIN 13599/13601/ 13605(Cu-ETP) WAS BP12077. NOTE-4 MODIFIED.				

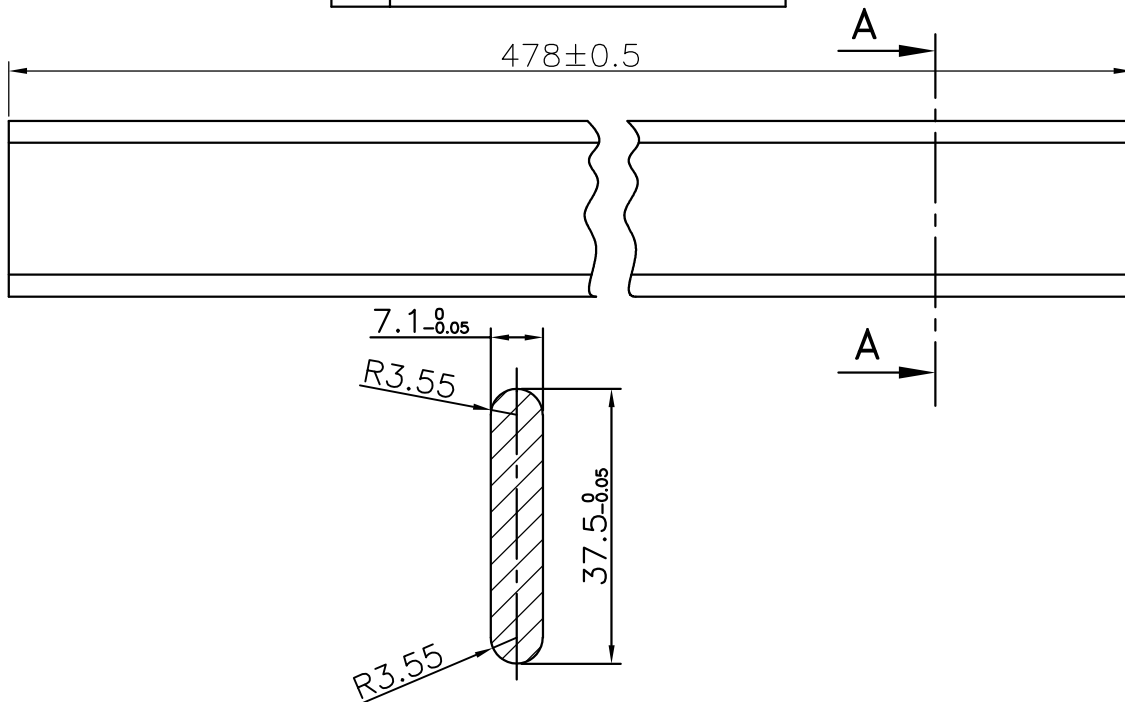

NOTES:-

SECTION-AA

1. REMOVE SHARP EDGES.
2. MATERIAL TO CONFIRM TO CATEGORY 'h' (HARD) OF SPEC. TM 97243
3. REQUIRED QTY. PER MACHINE-58 NOS.
4. ALTERNATIVELY MATERIAL AS PER SPEC NO. BP12077/ BP12080 WILL BE USED FOR IT.001. HOWEVER, MATERIAL TC SHALL ALSO INCLUDE PROPERTIES & REFERENCE OF DIN 13599/13601/13605 (CU-ETP).

001	SEE NOTES	001	ROTOR BAR 7.1TKX37.5X478LG		DIN 13599/13601/ 13605(Cu-ETP)	KG	1.09
59	64	65	ITEM NO.	DESCRIPTION	STD	MATL. CODE	57
VAR00	REMARKS					MATL. SPCN.	54
							UNIT
							58
							68
							QTY.
							71

SIGN. & DATE		REF. DRG. NO.		INVENTORY NO.		Bharat Heavy Electricals Ltd. Bhopal		DRN	NAME	SIGN	DATE	NO. OF VAR.
								CKD	S.BHARTI	Sarvek Shukla	15.12.15	01
								APPD	S.K.Y.		15.12.15	
DEPT. TME	UNTOL. DIMS. GR.			SCALE	WEIGHT(K.G.)	REF.TO ASSY.DRG.	ITEM NO.	NO.OF ITEM				
CODE 405				N.T.S.	1.09	2 445 45 09 001	002	001				
TITLE						DRAWING NO.			REV.			
ROTOR BAR						4 445 45 09 001			04			
(IM3301AZ)						SHT. NO. 01			NO. OF SHT. 01			