

THE INFORMATION ON THIS DOCUMENT IS THE PROPERTY OF BHARAT HEAVY ELECTRICALS LIMITED.  
IT MUST NOT BE USED DIRECTLY OR INDIRECTLY IN ANY WAY DETRIMENTAL TO THE INTERESTS OF THE COMPANY.

KN08

COLOUR : BLACK (B)

4- HOLES  $\varnothing 7$   
AT 36 P.C.D.

HOLE Ø12

4-HOLES 1/4" B.S.W.  
TAPPED AT 36 P.C.D.

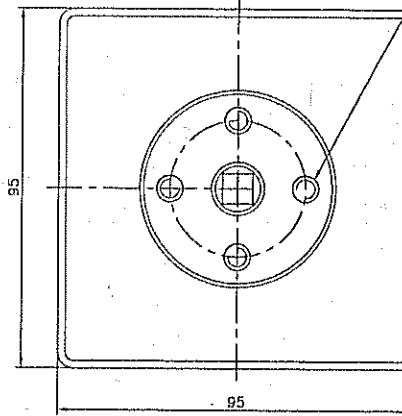

## PANEL DRILLING

NOTES:-

1. THESE SWITCHES ARE HAND OPERATED & DESIGNED FOR ON LOAD SWITCHING AND WOULD BE USED TO CUT-OUT THE TRACTION MOTORS FROM CIRCUIT IN CASE OF FAULT.
2. 6 POLE ROTARY SWITCH SUITABLE FOR 125V, 16 Amp. DC. MOUNTING TO BE FLUSH AT THE BACK OF PANEL. THE SWITCHING SEQUENCE SHALL BE AS FOLLOWS.

IT.001:

POSITION 1- ALL IN (12 'O' CLOCK)

POSITION 2- MOTOR 1 OUT (3 'O' CLOCK)

POSITION 3- MOTOR 1 & 3 OUT (6 'O' CLOCK)

POSITION 4- MOTOR 3 OUT (9 'O' CLOCK)

IL002;

POSITION 1- ALL IN (12 'O' CLOCK)

POSITION 2- MOTOR 2 OUT (3 'O' CLOCK)

POSITION 3-- MOTOR 2 & 4 OUT (6 'O' CLOCK)

POSITION 4- MOTOR 4 OUT (9 'O' CLOCK)

3. THE SWITCH SHALL BE OF HEAVY DUTY SUITABLE FOR TRACTION DUTY VIBRATIONS & AMBIENT OF 55 DEG. C. WITH RELATIVE HUMIDITY OF 95%. THE SWITCH SHALL BE PROVIDED WITH A KNOB TYPE OPERATING HANDLE.
4. INDICATING PLATE OF SIZE 95x95 mm. WITH FOLLOWING MARKING SHALL ALSO BE SUPPLIED ALONGWITH SWITCHES.

5. ROTARY SWITCHES SHALL COMPLY TO :  
BSEN 60947-3/1992  
IS 13947 (PART I AND PART III) 1993
6. SWITCHES SHOULD WITHSTAND HIGH VOLTAGE TEST OF 2.5kv FOR ONE MINUTE.
7. THIS SWITCH SHOULD BE KAYCEE TYPE RP169YR13/LM OR EQUIVALENT AS PER THIS DRG./SPEC.
8. THESE SWITCHES SHOULD HAVE APPROVAL OF ICF/RDSO & SUITABLE FOR TRACTION DUTY  
AS PER IEC 60077.
9. SUPPLIER NOT HAVING ICF APPROVAL SHOULD NOT QUOTE.

CONTACT	12'0" CLOCK POSITION	3'0" CLOCK POSITION	6'0" CLOCK POSITION	9'0" CLOCK POSITION
1 & A	○			
2 & B	○			
3 & C		○	○	○
4 & D	○			○
5 & E	○	○		
6 & F	○			

ALL  
IN

MOTOR 3 OUT

MOTOR 1 OUT

MOTOR 1 & 3 OUT

IT.001  
(SCALE-1:2)

ALL  
IN

MOTOR 4 OUT	MOTOR 2 OUT
MOTOR 2 & 4 OUT	

II.002  
(SCALE-1:2)

[illegible]

28 --- CARD TYPE-3		29 --- CARD TYPE-1		28 --- CARD TYPE-2	
ADDITIONAL INFORMATION		भारत का प्रज्ञा च मान्य/निर्देशक का नाम TYPE OF PRODUCT OR NAME OF CUSTOMER/PROJECT HMP DEMU M/S ICF CHENNAI			
STATUS OF DRAWING		श्री. एच. ए. रत्न भारत हेवी इलेक्ट्रिकल्स लिमिटेड बhopal BHARAT HEAVY ELECTRICALS LTD. BHOPAL			
DISTRIBUTION OF PRINTS		प्रमाण/NAME KANSARA संस्था/ORG. OPS प्रमाण/DATE AG			
OFFICE COPY - 1		संस्था/NO. OF SD/- 27.02.06			
SWM - 3		संस्था/NO. OF SD/- 28.02.06			
TCX (SWM) - 1		संस्था/NO. OF SD/- 28.02.06			
REV.	DATE	ALTERED BY	CHECKED BY	APPROVED BY	REMARKS
01	10.02.10	APPROVED BKT	APPROVED BKT	APPROVED BKT	APPROVED BKT
ZONE		SEQUENCE TABLE FOR ITEMS 001 & 002 ADDED.			
0051		MOTOR CUTOUT SWITCH			
6		7			
0051		2 589 00 3 0125			
6		7			
0051		2 589 00 3 0125			