

2-V-N363-07878/01
DRAWING ON

ALL DIMENSIONS ARE IN MILLIMETRES. FOR TOLERANCES OF UNTOLERANCED DIMENSIONS DURING MANUFACTURE REFER RELEVANT QCP / QP

✓/12.5/ 3.2/ 0.8/

ø120-H11	+0.220 0.000
ø56-H7	+0.030 0.000
ø165.1-h11	0.000 -0.250

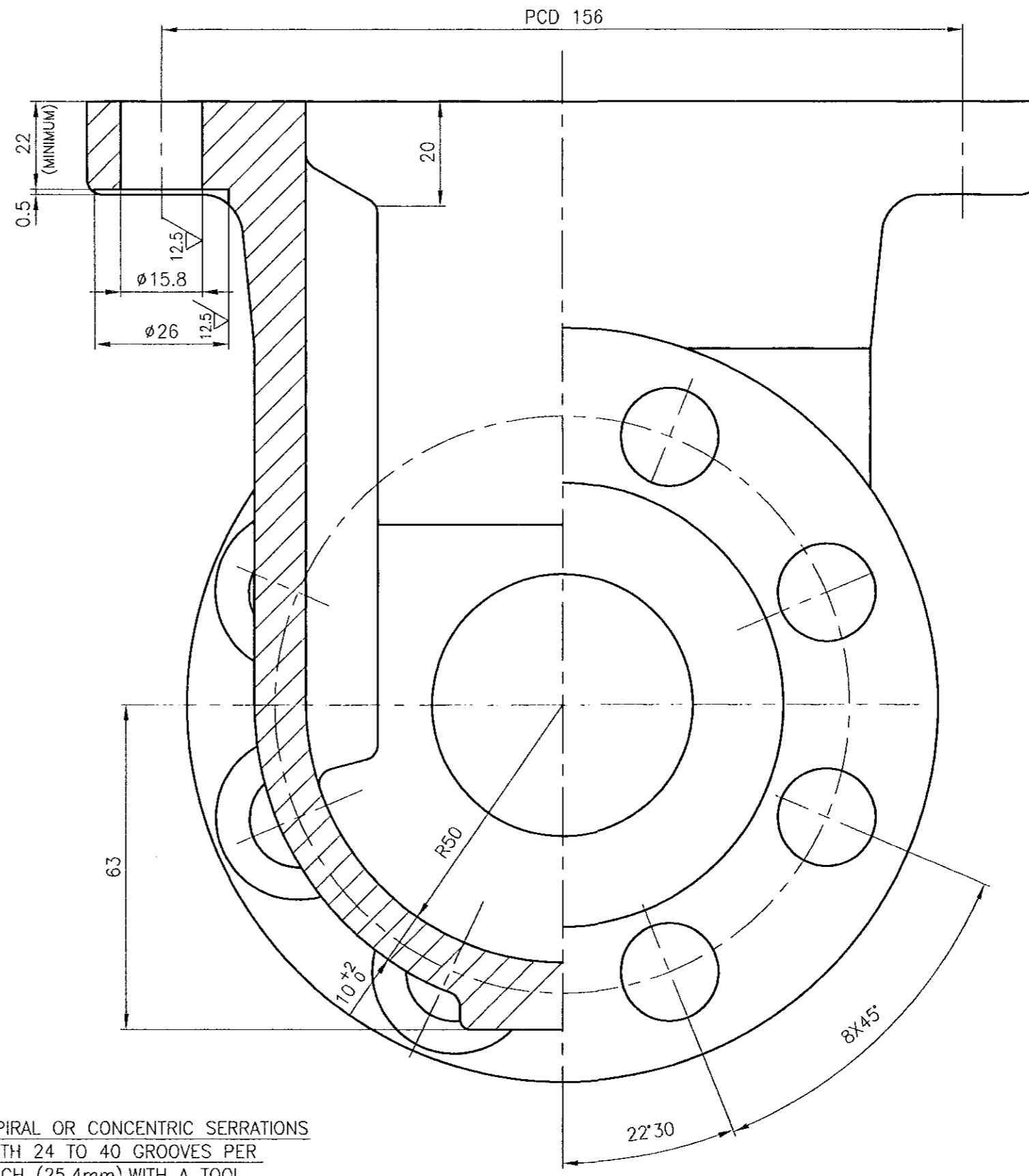
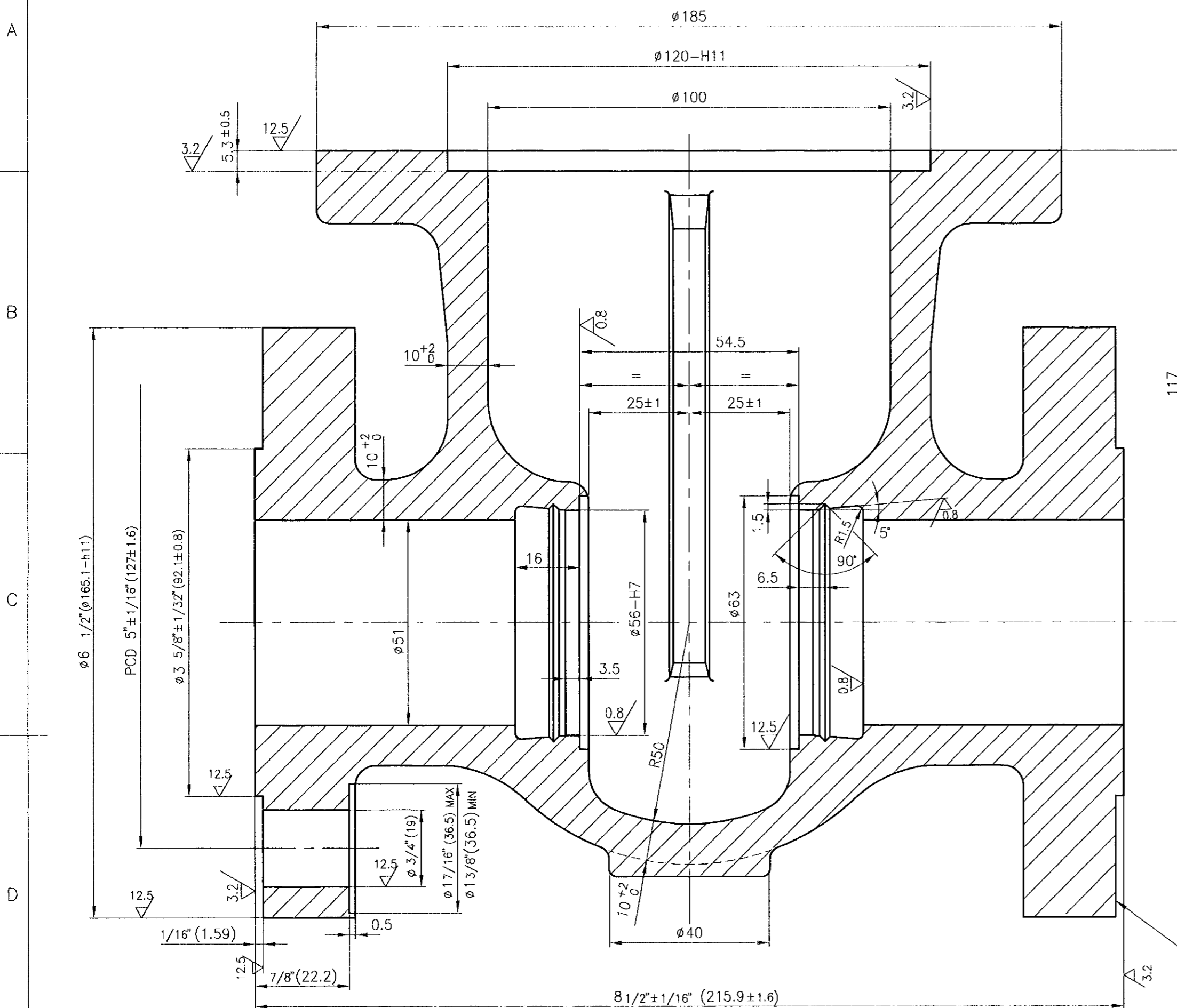

SPIRAL OR CONCENTRIC SERRATIONS
WITH 24 TO 40 GROOVES PER
INCH (25.4mm), WITH A TOOL
RADIUS OF 1.5mm APPROX.

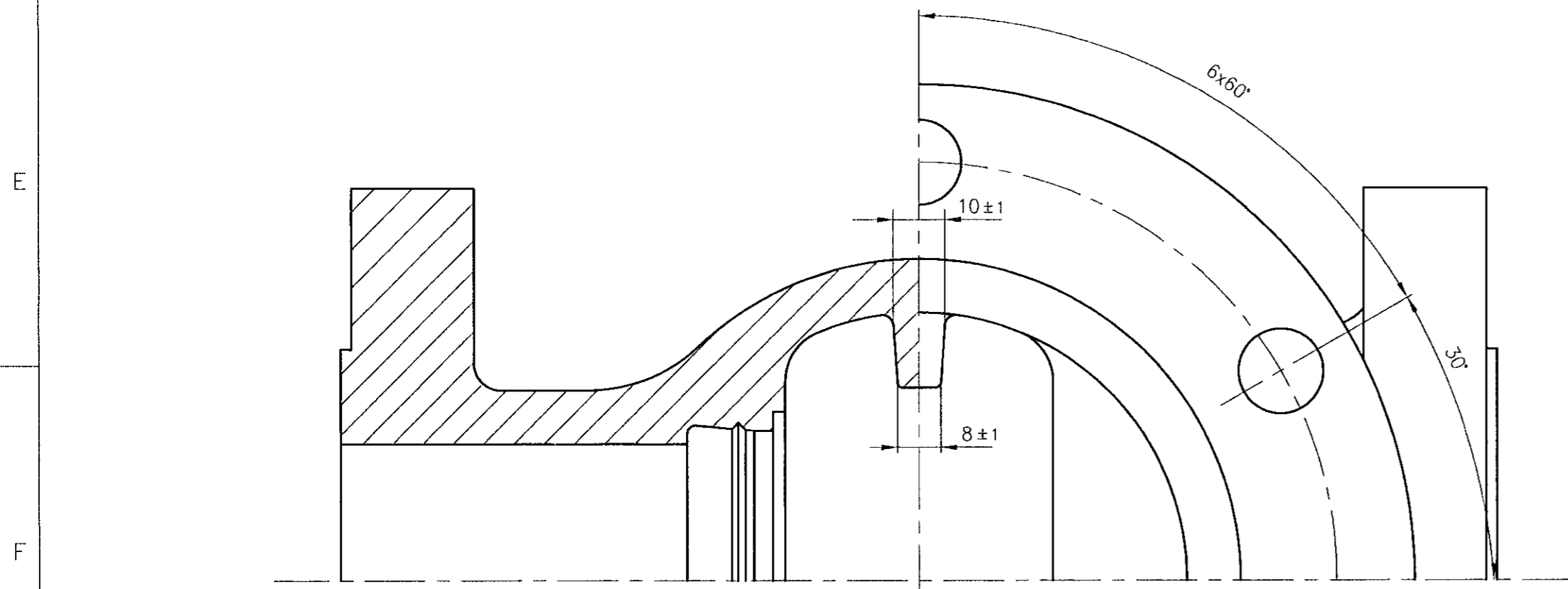

-	BODY CASTING DRG. No. 2VN36307878R/2	92 200 436	ASTM A351 CF8 ATTEST	SH	46	16.1	19.5	-	-
No OFF	DESCRIPTION	MATL CODE	MATL SPECN	HEAT TREATMENT	SCRAP SORT	NET WT (kg)	GROSS WT (kg)	DRAWING No	ITEM No

TYPE OF PRODUCT
OR NAME OF
CUSTOMER/PROJECT

CS

	BHARAT HEAVY ELECTRICALS LTD.		DRN	K.P.LEON	DATE	22.05.98	NO. OF VAR.
	UNIT: HIGH PRESSURE BOILER PLANT.		CHD	N.DHANAPAL	DATE	22.05.98	
	TIRUCHIRAPALLI - 620014.		APPD	K.S.RAMAN	DATE	22.05.98	

DEPT	VL	SCALE	WEIGHT (KG).	REFERENCE INFORMATION	NO. OF ITEMS
CODE	320	REF.TABLE	CAD: C207878 COMP.CODE:931068930000	REV	

TITLE	BODY (2"-C300)	CARD CODE	U 01	DRAWING NO.	2-V-N363-07878 01
-------	-------------------	--------------	------	-------------	-------------------

REV	DATE	ALTERED T.C.C. & APPD
01	15.9.98	CHD & APPD Hak
ZONE	ITEM-NO. DELETED.	
REFER DCN.CS:0921		

CAUTION: The information on this document is the property of BHARAT HEAVY ELECTRICALS LTD. It must not be used directly or indirectly in any way detrimental to the interest of the company.

QC