

THE INFORMATION ON THIS DOCUMENT IS THE PROPERTY OF BHARAT HEAVY ELECTRICALS LIMITED. IT MUST NOT BE USED DIRECTLY OR INDIRECTLY IN ANY WAY DETRIMENTAL TO THE INTEREST OF THE COMPANY.

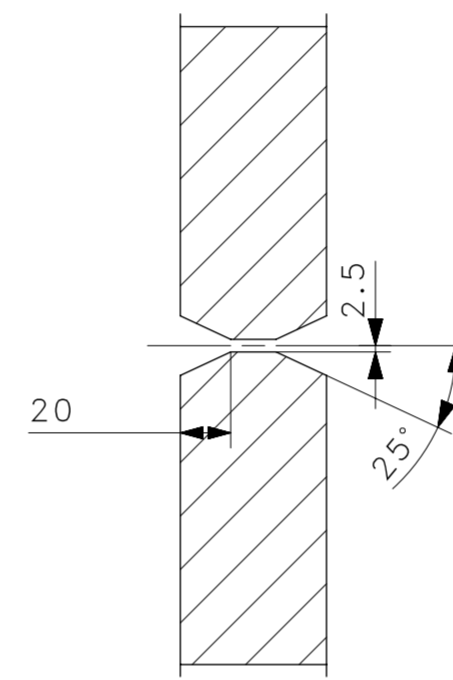

SECTION D-D ROTATED VIEW

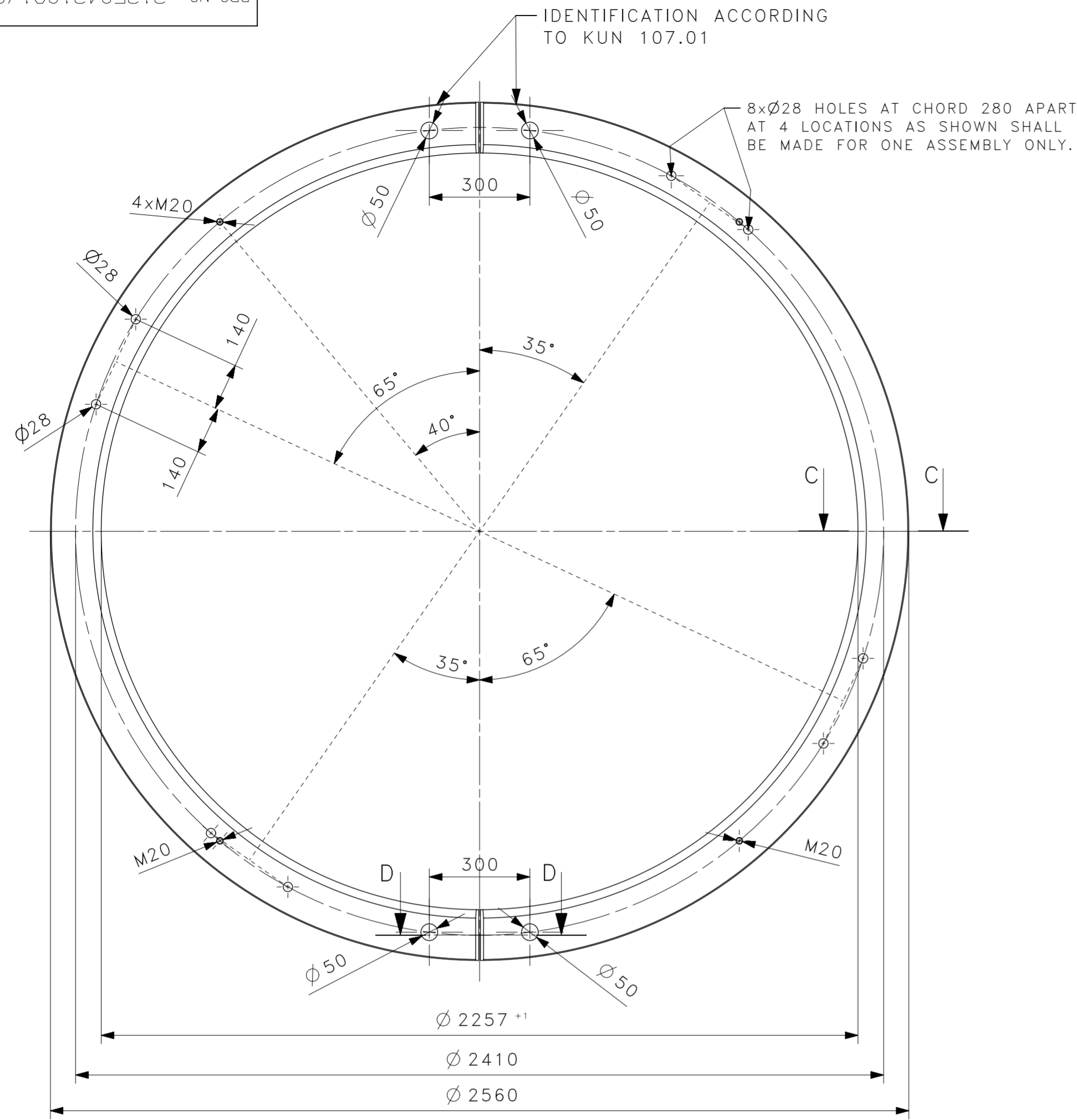
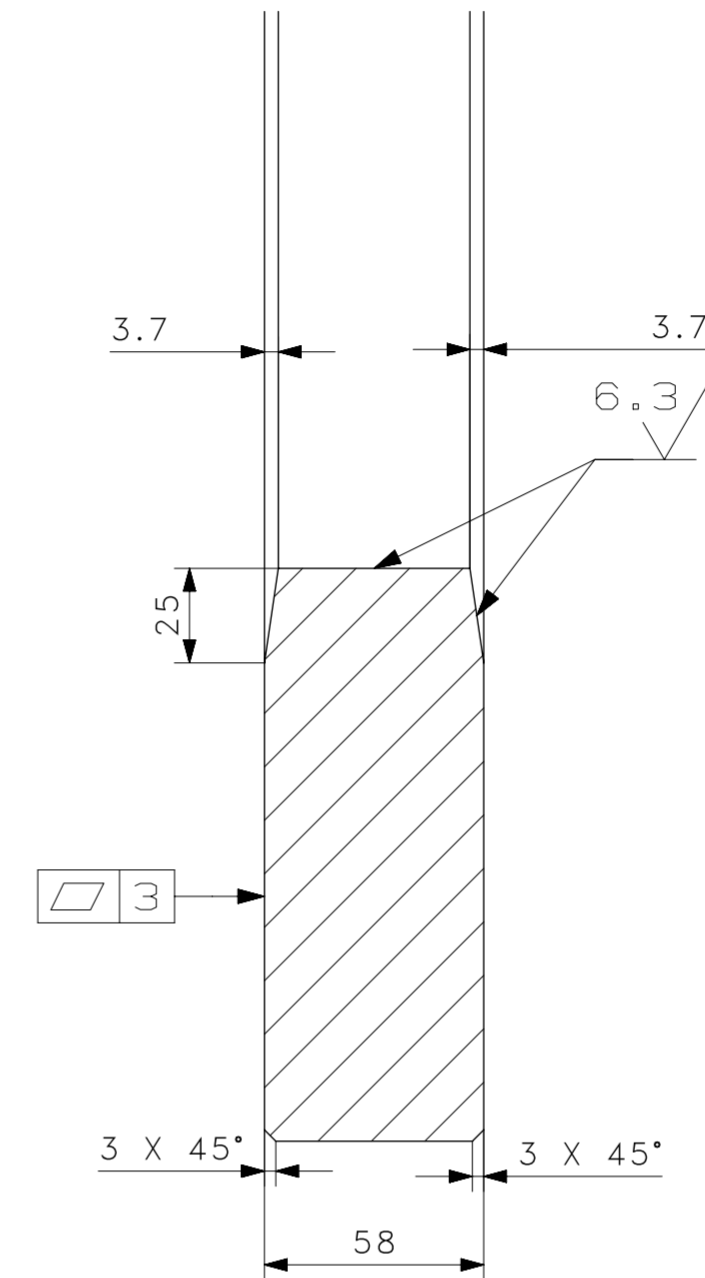

SECTION C-C ROTATED VIEW

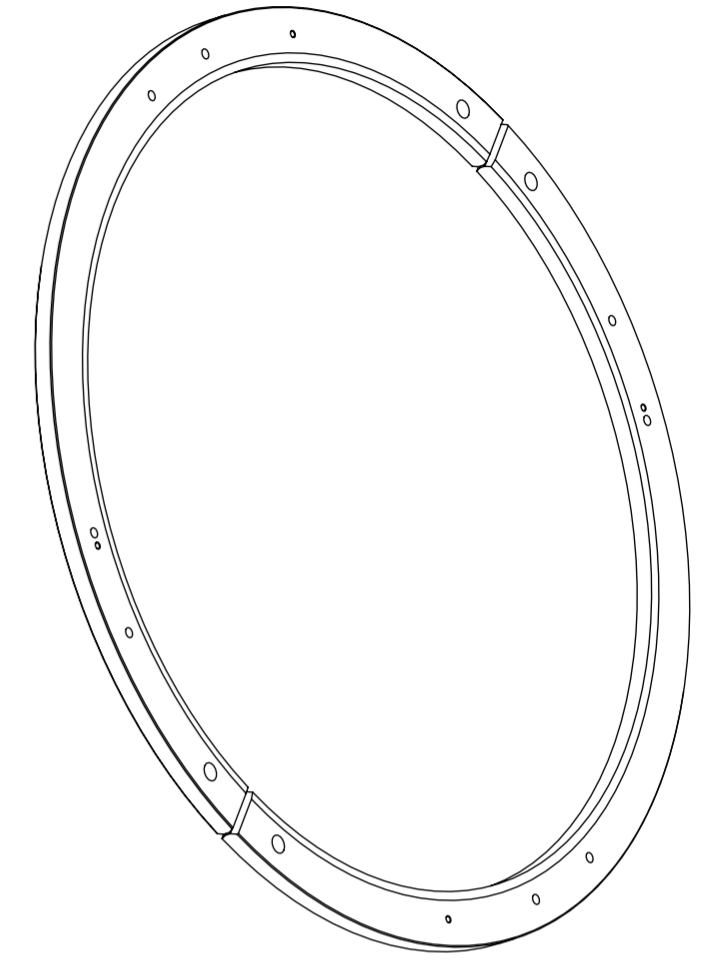

ITEM NO.	DESCRIPTION	DRAWING NO.	VAR. NO.	RAW MATERIAL SIZE OR CASTING DRG. NO. OR FORGING DRG. NO.	MATERIAL CODE	NET WT.	GROSS WT.
					MATERIAL SPECN.	QUANTITY	

THE FOLLOWING CONDITIONS APPLY EXCEPT OTHERWISE STATED...

- REF. TO HY0230261 FOR UNSPECIFIED TOLERANCES.
- CHAMFER M/CD SHARP EDGES 1.2 TO 1.0 AT 45°.
- INTERNAL M/CD CORNER RADI 1 TO 0.7.
- THE SURFACE ROUGHNESS WHEREVER NOT SHOWN SHALL BE TAKEN FROM THE SURFACE ROUGHNESS SHOWN OUT SIDE BACK SLASHES GIVEN AT THE TOP MOST RIGHT CORNER OF THE DRG.

TYPE OF PRODUCT OR NAME OF CUSTOMER/PROJECT: TARI 930-30P

DRN.	A. PRAMODH	SIGN.		DATE	11.12.2015	NO. OF VAR.	
CHD.	M ASIM				11.12.2015		N.A
APPD.	K C PANDA				11.12.2015		
DEPT.	EME	SCALE	NTS	WEIGHT (kg)	509.00	REF. TO ASSY DRG.	11350431152
CODE	425					ITEM NO.	10
TITLE						DRAWING NO.	21350431061
CORE BACK RING ASSY END						REV.	00
						SHEET NO.	01
						NO OF SHEETS	01

REV.	DATE	ALTERED	APPD.	REV.	DATE	ALTERED	APPD.	REV.	DATE	ALTERED	APPD.	REV.	DATE	ALTERED	APPD.
ZONE				ZONE				ZONE				ZONE			