



BHARAT HEAVY ELECTRICALS LIMITED

CORPORATE RESEARCH & DEVELOPMENT DIVISION

VIKASNAGAR, HYDERABAD - 500 093, INDIA

PHONES: 23774494 (EXCHANGE)

DIRECT: 23882104/23882204/

23778474/23776772

FAX : 91 40 23770698

RD:DP:MPX:F-04

ENQUIRY

To - Enquiry No: 570903201 Enq Date: 01-SEP-09 Due Date: 24-SEP-09 Delivery By: 31-DEC-09

-

-

Pin -

Email :

Attn. .

PLEASE SUBMIT YOUR QUOTATION IN SEALED COVER SUPERSCRIBED WITH ENQUIRY NO, ENQUIRY DATE AND DUE DATE SUBJECT TO OUR TERMS AND CONDITIONS ENCLOSED, FOR THE FOLLOWING MATERIALS SO AS TO REACH US ON OR BEFORE THE DUE DATE BY 12 NOON. THE TENDERS WILL BE OPENED AT 2 PM ON THE SAME DAY

PLEASE GIVE REFERENCE OF ENQ NUMBER , ENQ .DATE AND DUE DATE IN ALL YOUR CORRESPONDENCE FOR PROMPT ACTION. IN CASE IF YOU ARE NOT MAKING THE OFFER PLEASE POST A REGRET LETTER AND RETURN THE DOCUMENTS.

SL NO	DESCRIPTION / SPECIFICATION	UNIT	QTY
1	DUMpload TO BE MADE AS PER THE SPECIFICATIONS ATTACHED	NO	1

Please submit your offer in Two parts as per enclosed "General Terms and Conditions of enquiry & Contract for the purchase of Goods/ Services" in separate sealed covers as detailed below:

1) First cover shall contain a) Technical & Commercial bid, b) Compliance Statement, c) Un-priced Price bid, i.e. a copy of the Price bid with the price(s) columns left blank.

2) Second Cover containing Price bid.

If the Price bid is found to be different from the un-Priced Price bid in any way, the offer will be rejected.

3) Unsigned offers are liable for rejection.

.Note:

1) ALL OFFERS MUST INCLUDE NAME OF CONTACT PERSON, PHONE NO, FAX NO, EMAIL ID. UNSIGNED/INCOMPLETE OFFER(S) ARE LIABLE FOR REJECTION.

2) Taxes & Duties quoted will be taken for cost evaluation & order placement and no change will be entertained later except in the case of changes made by the Government.

3) Changes in Taxes and Duties because of the changes in Turnover etc. will be to the supplier's account.

4) In case any Taxes/duties exempted, a self declaration for the same may be attached to the offer.

5) GUARANTEE CERTIFICATE : REQUIRED

6) MANUFACTURER'S TEST CERTIFICATE : REQUIRED

7) ERECTION & COMMISSIONING : REQUIRED

REVERSE AUCTION:

BHEL RESERVES THE RIGHT TO PROCURE ABOVE ITEMS THROUGH REVERSE AUCTION.

AS WE ARE ENGAGED IN R&D ACTIVITY "C" FORM WILL NOT BE ISSUED

Yours faithfully

for

BHARAT HEAVY ELECTRICALS LTD

SRIDHAR S

Addnl Gen Manager

PLEASE FILL UP THE ENCLOSED VENDOR REGISTRATION FORM AND SEND IT ALONG WITH YOUR QUOTATION. OTHERWISE YOUR QUOTATION WILL NOT BE CONSIDERED. (IGNORE THIS IF YOU HAVE ALREADY SUBMITTED THIS FORM)

Email: sridhar@bhelrnd.co.in

SPECIFICATION FOR DUMPLoad
(300 KW RESISTIVE LOAD BANK)

1) Application of the loadbank: This loadbank should be designed for continuous operation to load a wind generator and a Diesel Generator.

2) Site Details:

- Ambient Temperature: Upto 50° C
- Would be installed in a well ventilated indoor room.

3) Power supply to the load bank:

- The load supply is 440 V AC, +/- 10%, 3 Phase, 3 Wire, 50 Hz Supply.
- 1 phase / 3 phase auxiliary AC supply is available.

4) Loadbank Details:

- **Load Panel:** The Resistive loadbank should vary from 0 to 300KW in fixed steps of 30KW. All the phases should be loaded equally at all times. Resistors should be firmly fixed electrically and mechanically to the loadbank.
- The cooling method for resistors should be forced air cooled. Blowers should be mounted on antivibration pads.

5) Switching Circuit: The load should be switched using suitably rated mechanical contactors/solid state contactors. Each 30KW load should be able to be switched ON/OFF remotely and locally.

6) Protection: One MCCB for the entire loadbank should be provided at the cable entry point of the 440V load supply. One MCCB should to be provided for each switchable load. Fan failure indication should be provided.

7) Potential free contacts: Two Terminal Blocks should be brought out for each switching device for remote operation for each of the 30 KW load. One potential free contact showing the status of the switching device should be brought to a terminal block. Potential free contact for fan failure should be provided.

8) Tolerance: Accuracy: $\pm 10\%$ for loadbank under all conditions assuming rated voltage.

9) Local Display: R, Y B indications for the Incoming Load Power Supply status on each panel is to be provided. Indication for the 30KW load which are switched ON/OFF should be provided. Digital display of current in the three phases and voltage of one phase is to be provided.

10) Additional Points: Chassis earthing points to be provided. All input / output and indications must be clearly labeled on the loadbank. The loadbank should have eye bolts on the top for lifting purposes and channel for fork lifting to be provided at the bottom. Castor wheels to be provided at the bottom.

SPECIFICATION FOR DUMPLoad
(300 KW RESISTIVE LOAD BANK)

11) Limiting Dimensions:

The loadbank should fit within the dimensions provided for the loadbank in the room layout and the door dimensions as shown in figure 1.

12) Acceptance Criteria:

- 1) IR test should be done between high potential point and chassis in the loadbank before and after HV test. HV test of 1KV for one minute between High potential points and chassis. IR should be greater than 10 Megaohm.
- 2) Continuous operation for 16 hours on the total loadbank at different loading levels. During testing, and the tolerance and load sharing should be within the specified limit at all times. No failures or damage to of any components should be observed. The temperature on the surface of the resistor filament should not cross more than 400 degrees centigrade during the test.

Note: If the supplier does not have the facility to do the continuous load test, the testing can be arranged at BHEL R&D. However, the transportation of the loadbank to BHEL R&D and testing cables and accessories required for testing should be borne by the supplier.

13) Erection and commission at Site: The supplier has to deliver, install and commission the 300KW loadbank at site.(At Tadipatri Wind Farm Farm Site, Ananthpur, AP.

14) Warranty: One year on site repair or replace warranty to be provided.

15) Documentation:

Along with offer:

- Dimensional Details should be provided. Weight of the loadbank to be indicated.
- Termination details of the main power cable to be provided.
- Single line diagram of the loadbank and Bill of Material of the loadbank should be submitted.

Along with delivery:

- General arrangement of the components in the loadbank to be provided.
- Detailed schematic drawing of the loadbank to be provided.
- O&M manual should be provided.
- Warranty certificate should be provided.

SPECIFICATION FOR DUMPLOAD
(300 KW RESISTIVE LOAD BANK)

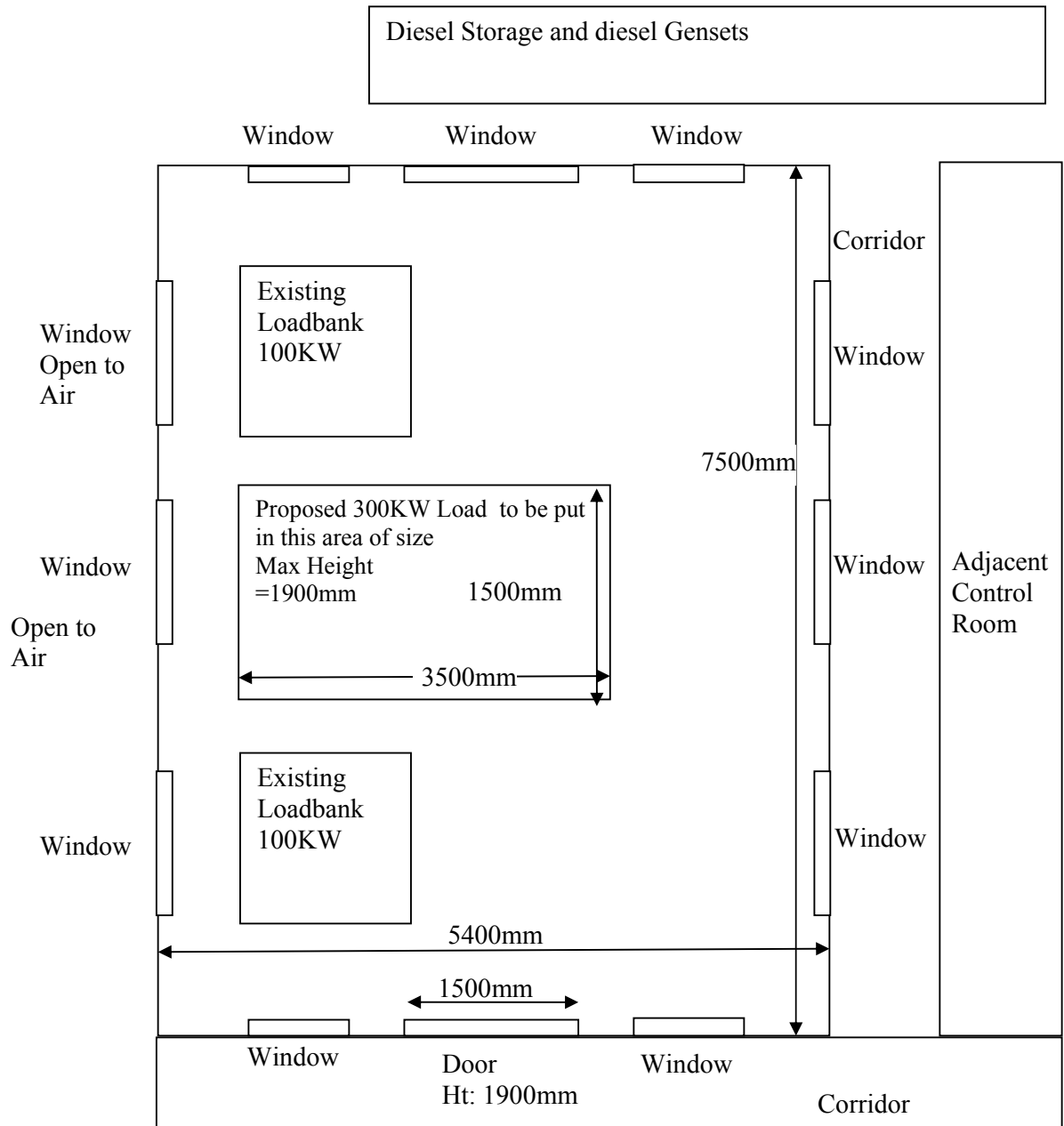

Figure1: Rough Sketch of Room Layout where loadbank is to be situated.



BHARAT HEAVY ELECTRICALS LIMITED

CORPORATE R&D DIVISION, VIKAS NAGAR, HYDERABAD – 500 093, AP, India

Ph: 0091-40 – 23778474, FAX: 0091-40 – 23770698

General Terms and Conditions of Enquiry & Contract for the Purchase of Goods/ Services

1. The quotation and any order resulting from this enquiry shall be governed by these General Terms and Conditions of enquiry and contract for the supply of goods and the supplier quoting against this enquiry shall, unless specifically stipulates any different terms or conditions, be deemed to have read and agreed to the same.
2. Sealed quotations in double cover with tenderer's distinctive seal, superscribing enquiry number, date and due date are to be submitted so as to reach on or before due date & time, addressed to **Additional General Manager(MM), Bharat Heavy Electricals Limited, Corporate Research & Development Division, Vikasnagar, Hyderabad, Andhra Pradesh, India – PIN-500 093, India.**

In the case of **Two-part bid**, each inner cover shall clearly be labeled as a) **Technical & Commercial Bid** containing technical data/ drawings/ catalogues/ quality plans along with commercial terms and conditions & copy of the price bid with the price columns left blank (unpriced price bid), b) **Price bid** containing prices quotes. Installation and/or Commissioning charges shall be spelt out in absolutely lucid terms, taking into account total charges, rather than quoting vaguely, such as charges per man-day or charges per engineer per day etc. **If the price bid was found later to be different from the unpriced price bid in any way, the offer will be rejected summarily.**

3. **Tender/ Technical bid Opening:** Unless specified otherwise, tenders/ technical bids will be opened on appointed date and time as mentioned in the enquiry or as communicated changed date/time, if any, in the presence of such of those tenderers who may be present.
4. **Delayed/ Late Tender:** Tenders, which have been posted by registered post through the postal department in time before opening date but received after tender opening, shall be treated as regular tenders. Other tenders received after tender opening time shall be treated as late tenders and normally they may be rejected.
5. The Quotation should be free from overwriting and erasures. Corrections and additions, if any, must be attested. Supplier should indicate in the quotation dimensions (Size), weight, rate etc., in the metric system unless the enquiry calls for different unit.
6. **Validity of Quotation:** All quotations shall be kept open for acceptance for a period of ninety days from the date of opening of Tenders/ Technical bid and this shall be deemed to be an express condition of all quotations. The rate shall be quoted in both figures and in words.
7. In the case of Two-part bid, the vendor should furnish technical clarifications, if any, within stipulated time mentioned, failing which, it will be construed that the vendor is not interested in the tender and BHEL shall not consider the offer for further evaluation.
8. **Revision of Pricebid:** In the event of any bidder, after finalizing the technical specifications and scope of supply, opting to revise and submit their latest price bid, then BHEL reserves the right to open their original / previous price bid also while evaluating revised bid.
9. **Pricebid Opening:** Unless specified otherwise in the enquiry, the Price bids of technically qualified vendors shall be opened with prior intimation in the presence of such of those tenderers who may be present.
10. **Conformity to Specifications:** The material should be of the best quality and shall be conforming to our specification given in our enquiry. Unless otherwise agreed upon by BHEL, no payment shall be due by BHEL in respect of any sample. Offers without details of specifications/ applicable catalogues will not be considered and are liable to be rejected.
11. **Terms of Delivery:** All suppliers shall quote the lowest prices on ex-works and FOB/FCA basis. Foreign suppliers will also indicate their Indian agent's name and address with percentage of agency commission out of the quoted price, if any. Name and Address of the supplier's Bankers address should also be given. Indian suppliers for the indigenously manufactured/ imported stock shall quote on Ex-works /Free-on-Rail/Road /FOR-destination basis, indicating packing & forwarding charges, if any, separately.
12. **Taxes and Duties:** Unless specified otherwise in the enquiry, BHEL do not provide "C" or "D" Form as it is engaged in R&D. All Indian suppliers shall clearly mention Sales Tax/ VAT, Excise Duty, and Service Tax etc, if any, payable in addition to the quoted price and indicate applicable rates/ percentage, item-wise. It will be paid

only if Registration Number under State(TIN)/ Central Sales Tax or Service Tax is specifically mentioned in the Bill/Invoice. Vendors without a Sales Tax/VAT registration and applicable Service Tax registration will not be considered.

13. **Insurance:** Insurance will be arranged by BHEL in case of Ex-Works as well as FOB basis supplies.
14. **Terms of Payment:** Full payment will be made within 30 days after receipt, inspection and acceptance of the material (and where involved, Erection and commissioning of the material/ equipment at BHEL/Destination) by Crossed cheque and no Bank commission charges are admissible. The Cheque will be sent by registered post and BHEL is in no way responsible if loss occurs due to delay by postal authorities and cheques falling into improper hands or through forgery or fraud. Suppliers having RBI-SEFT-enabled accounts can seek payment through Electronic Fund transfer. For foreign suppliers, the preferred payment term will be on Sight Draft basis and bank charges inside India will be to BHEL account and outside India will be to supplier's account.
15. Suppliers shall quote competitive price and best delivery for all the items mentioned in the enquiry. BHEL reserves the right to reject partial quotations and to place order on overall landed cost basis. Correct date of effecting supplies in the event of an order should be indicated in the offer. If the supplier's quoted terms are different from BHEL standard payment terms, interest @10.5% per annum (or as indicated in the enquiry) will be loaded to the quoted prices for difference of payment period.
16. **Packing:** The supplier shall be responsible for the goods being properly and adequately packed so as to prevent any loss, damage or deterioration during transit and indicate packing charges, if any, separately.
17. **Part/ Split Ordering:** BHEL reserves right to Order part of the item/ quantity of the enquiry and split the order among qualified vendors.
18. In case the goods enquired are on Rate Contract basis with any other unit of BHEL, such fact should be clearly indicated in the quotation giving full particulars of Rate Contract number, validity and price and also your willingness to comply with order if placed against such Rate Contract. A true copy of Rate contract signed by the supplier should be sent with the quotation.
19. **Inspection:** On receipt, the goods shall be subjected to inspection and also test, if necessary, and our decision regarding the acceptability of the goods shall be final and binding on the suppliers.
20. **Consequences of Failure To Deliver:** The time stipulated for delivery of goods shall be deemed to be the essence of the contract and delivery must be completed within the stipulated date/s. In the event of supplier's failure to supply the goods by the stipulated date/s, BHEL shall be entitled to levy a penalty of ½% per week for the delayed no of weeks or part thereof for the undelivered portion of PO subject to a maximum of 10% total order value.
21. **Withdrawal from the Contract:** In case the supplier withdraws the quotation after its acceptance by BHEL or fails to supply the goods as per the terms and conditions of contract, or at any time repudiated the contract wholly or in part, BHEL shall be at liberty to cancel the Purchase Order and to recover from the supplier the extra cost and other loss incidental to the breach of contract on the part of the supplier.
22. **Guarantee/ Warranty certificate and Manufacturer's Test report:** Invariably in all cases where it is so stipulated, the supplier should furnish Guarantee/ Warranty certificate valid for a period of 18 months from date of supply or 1 year from the date of receipt, acceptance and commissioning(or more, if provide by oem) whichever earlier and manufacturer's Test report along with the goods, failing which, BHEL shall have the right to reject the goods.
23. All ferrous/ non-ferrous items shall be colour coded as per bureau of Indian standards/ or IS standards/ BHEL Standards.
24. **Recovery of Dues:** BHEL shall recover any amount due from the supplier or any amount outstanding to the credit of the supplier with BHEL R&D unit or any other BHEL unit(s) and/or by legal action.
25. **Arbitration & Forum for Legal Proceedings:** All disputes arising in connection with indigenous/ foreign supplies shall be settled through arbitration held at Hyderabad, AP, India and arbitration shall be appointed by Arbitration Tribunal of the Federation of Andhra Pradesh Chambers of Commerce and Industry, Hyderabad, AP, India. The Courts at Secunderabad/ Hyderabad, AP, India shall have jurisdiction in respect of any suit or other legal proceeding arising from or relating to this contract

The rights and remedies of BHEL stated in these General terms and conditions shall be in addition and supplemental to its rights and remedies under law and custom or usage of trade or business and shall in no way be deemed to limit, curtail, supercede or derogate from its said rights and remedies.



BHARAT HEAVY ELECTRICALS LIMITED
CORPORATE R&D Division
Vikasnagar, Hyderabad – 500093, India.

Suppliers' compliance statement to basic conditions of enquiry

(In case Order to be placed on Indian supplier in Indian currency)

Condition	BHEL R& D's terms	Supplier's compliance (indicate Yes/No. if 'No', state terms desired)
1) Validity of offer	90 days from the tender opening date	
2) Delivery requirements	Free delivery at our stores or FOR destination (as indicated in the enquiry)	
3)Warranty	Unless specifically mentioned in the enquiry, all supplied items to be provided with warrantee for one year (or more, if provided by the OEM) from the date of acceptance/commissioning. In case of equipment involving erection and commissioning, warrantee shall be for 18 months from the date of dispatch or 12 months from the date of commissioning, whichever is earlier	
4) Terms of payment	Full payment will be made within thirty days after receipt, inspection and acceptance of the material at BHEL R&D (and where involved, erection and commissioning of the material/equipment at BHEL/destination), by Crossed Cheque and no Bank commission charges are admissible.	
5) Taxes & Duties	Unless specifically mentioned in the enquiry, we do not provide 'C' or 'D' form. Supplier to specify rates of taxes and duties element wise and related percentages.	
6) Penalty for late delivery	0.5% per week beyond the delivery date as mentioned in the Purchase order on undelivered portion subject to a maximum of 10% of the total order value	

* BHEL R&D reserves the right to reject any offer due to non-compliance with the above conditions and/or non-receipt of this form in duly filled condition

* Any other elements of cost in addition to the above may please be specified in detail

(Signature and Stamp/Seal of Vendor)



BHARAT HEAVY ELECTRICALS LTD.
Corp. R&D DIVISION
VIKAS NAGAR,
HYDERABAD-500 093 (INDIA)

VENDOR REGISTRATION FORM

[FORM TO BE SUBMITTED* BY THE BIDDER ALONG WITH TECHNICAL-BID]

Before filling please refer to instructions on page-4

1.0 VENDOR PROFILE:

1.1 & 1.2 Name and address of the vender:

Phone Nos.:

Fax No.:

Email:

1.4 Local representative of the vender in India/ Hyderabad:

Phone Nos.:

Fax No.:

Email:

Contact person:

Mobile No.:

2.0 & 2.1 Type of Organisation:

PROPRIETORSHIP	COMPANY	SISTER CONCERN	ANY OTHER (Please specify)
PARTNERSHIP	CORPORATION	Small Scale Industry	

3.0 Annual Turn Over:

Name and address of the Banker:

Sr.No.	Bank	Address

4.0 REGISTRATION PARTICULARS

4.1 IT Permanent Account No.(PAN):

4.2 & 4.3 State and central sales tax Registration No.:

4.4 ED/ Service Tax Registration No.:

PF Account No.:

Labour Licence No.:

ESI Account No.:

5.2 Contact person:

Mobile No. :

5.3 Total Number of employees:

Graduates (Engr./Scientists/Mgmt/Fin.)	Consultants	Workers		
		Sup./Skilled	Semiskilled	Unskilled

6.0 Wish to register for supplies/ services other than one bidding for :

<u>Sr.No.</u>	<u>Service/Supplies</u>	<u>Capacity</u>
<u>1</u>		
<u>2</u>		
<u>3</u>		
<u>4</u>		
<u>5</u>		
<u>6</u>		
<u>7</u>		

6.1 Reference list :

(Only recognized public and private sector companies, attach if printed copy available)

<u>Sr.No.</u>	<u>Customer</u>	<u>Volume / Year</u>
<u>1</u>		
<u>2</u>		
<u>3</u>		
<u>4</u>		
<u>5</u>		
<u>6</u>		
<u>7</u>		

7.0 & 8.0 Infrastructure / facilities :

<u>Sr.No.</u>	<u>Facility (with specifications)</u>	<u>Age/ Year procured</u>
<u>1</u>		
<u>2</u>		
<u>3</u>		
<u>4</u>		
<u>5</u>		
<u>6</u>		
<u>7</u>		
<u>8</u>		
<u>9</u>		
<u>10</u>		

9.0 Registration with other BHEL Unit/Units:

<u>Sr.No.</u>	<u>9.1.1 Unit</u>	<u>9.1.2 Registration No.</u>
<u>1</u>		
<u>2</u>		
<u>3</u>		
<u>4</u>		

Any Other information :

Declaration:

The information furnished above is true and authentic.

(CEO / Proprietor)

SEAL:

Date:

The competent authority reserves the right to accept or reject the registration. Registered vendors will be informed by mail / email, as convenient. Contact Sr.DGM (MM) for clarification/ additional information on registration.
A separate communication will be sent to you in case of non-registration, citing reasons thereof.

Instructions

1. Answer all items, use NA for items not applicable.
2. BHEL units do not require this registration.
3. Submit the form in duplicate.
4. Use additional sheets for want of space if required.
5. Attach copies of latest documents in respect of items 4.0 (Registration no.s)
6. Photographs of registered office and the chief executive/proprietor shall be furnished.
7. Use A4 sheets for this document and the enclosures.

* REGISTERED BIDDERS, HAVING BHEL (R&D) REGISTRATION NO./ HAVE SUBMITTED THIS FORMAT EARLIER, NEED NOT FURNISH THIS INFORMATION SECOND TIME (UNLESS DESIRE TO UPDATE IT).

AUTHORISATION LETTER FOR E-PAYMENT/ NEFT / RTGS

(PLEASE FILL UP THE FORM COMPLETELY IN CAPITAL LETTERS ONLY)

1	Type of Request (Tick One)	NEW / CHANGE
2	BHEL Vendor Code	
3	Company's Name	
4	Address	
5	City with Pin Code	
6	State	
7	PAN NUMBER	
8	Name of Contact Person	
9	Phone No with STD Code	
10	Fax No with STD Code	
11	Email Id	
12	Web Site (URL)	

BANK DETAILS FOR EFT / RTGS

1	Bank Name	
2	Branch	
3	Branch Code	
4	Address	
5	PHONE No.	
6	Account No.	
7	MICR/ IFSC Code	
8	Bank Swift Code	
9	NEFT/ RTGS enabled	Yes / No
10	Cancelled Cheque	Enclosed / Not Enclosed

1. I, as representative / owner of the above named company, hereby authorise BHEL R&D Hyderabad, to electronically make payments to the designated bank account. I hereby certify that the particulars given above are true, complete and correct.
2. If the transaction is delayed or not effected at all for reasons of incomplete or incorrect information, I would not hold BHEL / transferring Bank responsible.
3. This authority remains in full force until BHEL receives and acknowledge written notification requesting a change or cancellation

Date:

Authorised Signatory
Designation :

COMPANY SEAL



BHARAT HEAVY ELECTRICALS LIMITED
CORPORATE R&D Division
Vikasnagar, Hyderabad – 500093.

IMPORTED

Suppliers' compliance statement to basic conditions of enquiry

(In case Order to be placed on the Principal and foreign currency)

Condition	BHEL R& D's terms	Supplier's compliance (indicate Yes/No. if 'No', state terms desired)
01) Validity of offer	90 days from the tender opening date (or as per enquiry)	
02) Delivery requirements	FCA – Nearest International Airport (or as indicated in the enquiry)	
03) Warranty	Unless specifically mentioned in the enquiry, all supplied items to be provided with warrantee for one year (or more, if provided by the OEM) from the date of acceptance/ commissioning. In case of equipment involving erection and commissioning, warrantee shall be for 18 months from the date of dispatch or 12 months from the date of commissioning, whichever is earlier	
04) Terms of payment	Sight draft. All bank charges inside India will be to BHEL R&D account and out side India will be to suppliers account. Documents through State Bank of India, HAL Complex, Balanagar, Hyderabad, AP, India-500 042.	
05) Agency commission	Pl specify percentage charges, if any. Indian agency/agent commission will be in Indian Currency only.	
06) Erection/ Commission	As per enquiry	
07) Documentation	As per enquiry	
08) Insurance	BHEL will arrange Insurance based on intimation to our Insurance agency, United India Insurance Co., DO-2, Secunderabad, AP, India.	
09) Penalty for late delivery	0.5% per week beyond the delivery date as mentioned in the Purchase order on undelivered portion subject to a maximum of 10% of the total order value	

* BHEL R&D reserves the right to reject any offer due to non-compliance with the above conditions and/or non-receipt of this form in duly filled condition

* Any other elements of cost in addition to the above may please be specified in detail

(Signature and Stamp/ Seal of Vendor)



BHEL CORPORATE R & D
VIKAS NAGAR- HYDERABAD - 500 093
ANDHRA PRADESH – INDIA
SUPPLIER REGISTRATION FORM

(FOREIGN SUPPLIER)

ALL COLUMNS SHOULD BE PROPERLY FILLED IN THE SPACE PROVIDED FOR. WHEREVER IT IS NOT APPLICABLE PLEASE WRITE “NOT APPLICABLE”. INCOMPLETE OR INCORRECT FORMS MAY NOT BE CONSIDERED.

1.0 GENERAL INFORMATION:

1.1....NAME OF COMPANY

1.2....DETAILS OF HEAD OFFICE:

ADDRESS :
TELEPHONE :
FAX :
.EMAIL :
.WEB SITE :

1.3....DETAILS OF FACTORY/WORKS:

ADDRESS :
TELEPHONE :
FAX :
.EMAIL :
.WEB SITE :

1.4....DETAILS OF MARKETING AGENT

ADDRESS :
TELEPHONE :
.FAX :
.EMAIL :
.WEB SITE :

1.5 CHIEF EXECUTIVE

NOTE: PLEASE ATTACH SEPARATE SHEETS, IF SPACE FOUND IS INADEQUATE

AUTHORISED SIGNATORY



BHEL CORPORATE R & D
VIKAS NAGAR – HYDERABAD – 500 093
ANDHRA PRADESH – INDIA

SUPPLIER REGISTRATION FORM

(FOREIGN SUPPLIER)

- 1.6 CONTACT PERSON(S)
FOR PRODUCT OFFERED
NAME(S)
OFFICIAL CAPACITY
ADDRESS:
TELEPHONE
FAX
E-MAIL
- 1.7 YEAR OF ESTABLISHMENT
- 1.8 PRODUCTION CAPACITY PER ANNUM
- 1.9 PARTICULARS OF PRODUCT INCLUDING
SPECIFICATION AND RANGE OFFERED
FOR REGISTRATION
(ATTACH BROCHERS AND CATALOGUE)
- 1.10 NAME(S) OF BANKERS
- 1.11 BANKER’S CERTIFICATE
- 1.12 PORT OF LOADING
- 1.13 NEAREST AIRPORT
- 1.14 NAME OF THE INDIAN AGENT, IF ANY
WITH AUTHORISATION LETTER
- 1.15 ANY OTHER INFORMATION:

AUTHORISED SIGNATORY



BHEL CORPORATE R & D
VIKAS NAGAR – HYDERABAD – 500 093
ANDHRA PRADESH – INDIA

SUPPLIER REGISTRATION FORM

(FOREIGN SUPPLIER)

2.0 FINANCIAL INFORMATION

2.1...TOTAL CAPACITY

2.2...ANNUAL TURN OVER FOR LAST 3 YEARS

2.3...WHEHER CREDIT LICENSE ACCEPTABLE YES/NO

3.0 QUALITY MANAGEMENT SYSTEMS
ENCLOSED FORMAT PART-B

3.1 EXPERIENCE LIST FOR SAME/SIMILAR ITEMS
TO BE ENCLOSED

4.0.....FUTURE EXPANSION PLANS:
(GIVE DETAILS)

5.0 LIST OF ENCLOSURES:
INCLUDING BROUCHERS, CATALOGUES, TECHNICAL
LITERATURE etc...

6.0 ANY OTHER INFORMATION

SIGNATURE OF SUPPLIER
NAME
DESIGNATION
DATE
.....OFFICIAL SEAL

AUTHORISED SIGNATORY

BHEL R&D RD:DP:MPX:F-22		LOADING FACTORS			
NOTE : IN CASE OF DEVIATION TO BHEL TENDER SPECIFIED TERMS, LOADING FACTOR INDICATED IN FOLLOWING TABLE WILL BE APPLIED TO QUOTED PRICE WHILE EVALUATING THE LOWEST QUOTE ()					
A. FOR INDIGENOUS PURCHASES					
SLNO	SCOPE	COMMERCIAL TERMS	BHEL STANDARD TERM	AS OFFERED	LOADING FACTOR FOR NON COMPLIANCE TO BHEL STANDARD TERMS
A.1	SUPPLY OF EQUIPMENT	PAYMENT TERMS	100% PAYMENT, WITH IN 30 DAYS FROM THE DATE OF RECEIPT AND ACCEPTANCE OF MATERIAL	SAME	NIL
				PAYMENT AGAINST PROFORMA INVOICE / DESPATCH DOCUMENT OR CASH ON DELIVERY (COD) / CASH AGAINST PROOF OF DESPATCH	11% PER ANNUM INTEREST ON THE TOTAL PO VALUE FOR ONE MONTH
				ADVANCE PAYMENT WITH BANK GUARANTEE	11% PER ANNUM INTEREST ON THE TOTAL VALUE FOR OFFERED DELIVERY PERIOD (Rounded off to nearest month) + 1 MONTH
				PART ADVANCE PAYMENT WITH SUPPORTING BANK GUARANTEE AND BALANCE WITH IN 30 DAYS	11% PER ANNUM INTEREST ON ADVANCE FOR OFFERED DELIVERY PERIOD (Rounded off to nearest month) + 1 MONTH
				PART ADVANCE PAYMENT WITH SUPPORTING BANK GUARANTEE AND BALANCE ON RECEIPT OF MATERIAL	11% PER ANNUM INTEREST ON ADVANCE FOR OFFERED DELIVERY PERIOD (Rounded off to nearest month) + 1 MONTH AND 11% PER ANNUM INTEREST ON BALANCE AMOUNT FOR ONE MONTH
A.2	SUPPLY OF EQUIPMENT INCLUDING E&C	PAYMENT TERMS (THE SUPPLIER MUST SUBMITT A PERFORMANCE BANK GUARANTEE (PBG) FOR 10% OF THE BASIC VALUE OF THE ORDER VALID FOR WARRANTY PERIOD.)	90% PAYMENT, WITH IN 30 DAYS FROM THE DATE OF RECEIPTAND ACCEPTANCE OF MATERIAL . BALANCE 10% WITH IN 30 DAYS OF COMPLETION OF E&C AND ON SUBMISSION OF PERFORMANCE BANK GUARANTEE (PBG) FOR 10% OF BASIC PO VALUE.	SAME	NIL
				100% PAYMENT WITH IN 30DAYS AFTER COMPLETION OF SUPPLIES AND ERECTION AND COMMISIONING	NIL (PBG WILL NOT BE INSISTED FROM THE SUPPLIER)
				90% PAYMENT AGAINST PROFORMA INVOICE/ DESPATCH DOCUMENT OR CASH ON DELIVERY (COD) / CASH AGAINST DESPATCH AND BALANCE 10% WITH IN 30 DAYS OF E&C	11% PER ANNUM INTEREST ON 90% OF THE VALUE OF PO FOR ONE MONTH
				90% PAYMENT AGAINST PROFORMA / DESPATCH DOCUMENT OR CASH ON DESPATCH (COD) / CASH AGAINST DESPATCH AND BALANCE 10% AFTER COMPLETION OF E&C	11% PER ANNUM INTEREST ON TOTAL PO VALUE FOR ONE MONTH
				90% ADVANCE PAYMENT WITH BANK GUARANTEE AND BALANCE 10% WITH IN 30 DAYS OF E&C	11% PER ANNUM INTEREST ON 90% OF THE TOTAL VALUE FOR DELIVERY PERIOD(ROUNDED OF TO THE NEAREST MONTH) + 1 MONTH
				PART ADVANCE (x%) PAYMENT WITH SUPPORTING BANK GUARANTEE AND (90 - x) % PAYMENT ON RECEIPT OF MATERIAL AND 10% PAYMENT WITH IN 30 DAYS AFTER E&C	11% PER ANNUM INTEREST ON THE ADVANCE AMOUNT FOR THE DELIVERY PERIOD(ROUNDED OF TO THE NEAREST MONTH)+ 1 MONTH AND 11% PER ANNUM INTEREST ON (90-X)% PAYMENT FOR ONE MONTH
				PART ADVANCE (x%) PAYMENT WITH BANK GUARANTEE AND (90 - x) % PAYMENT ON RECEIPT OF MATERIAL AND 10% PAYMENT AFTER E&C	11% PER ANNUM INTEREST ON THE ADVANCE AMOUNT FOR THE DELIVERY PERIOD(ROUNDED OF TO THE NEAREST MONTH)+ 1 MONTH AND 11% PER ANNUM INTEREST ON BALANCE AMOUNT

SLNO	SCOPE	COMMERCIAL TERMS	BHEL STANDARD TERM	AS OFFERED	LOADING FACTOR FOR NON COMPLIANCE TO BHEL STANDARD TERMS
B. FOR FOREIGN PURCHASES (IMPORTED)					
B.1	SUPPLY OF EQUIPMENT	PAYMENT TERMS.	AGAINST SIGHT DRAFT ON PRESENTATION OF DESPATCH DOCUMENTS VIZ INVOICE, AWB ETC TO OUR BANKERS (ALL BANK CHARGES INSIDE INDIA TO BHEL ACCOUNT AND OUTSIDE INDIA WILL BE TO THE SUPPLIER'S ACCOUNT)	SAME	NIL
				100% PAYMENT AFTER RECEIPT AND ACCEPTANCE OF MATERIAL AT BHEL R&D BY WIRE TRANSFER. (DESPATCH DOCUMENTS WILL BE SENT TO BHEL R&D DIRECTLY ALONG WITH BANK DETAILS)	NIL
				LC PAYMENT	11% PER ANNUM INTEREST ON THE BASIC VALUE FOR ONE MONTH
				ADVANCE BY WIRE TRANSFER WITH BANK GUARANTEE	11% PER ANNUM INTEREST ON THE BASIC VALUE FOR DELIVERY PERIOD + 1 MONTH
				PART ADVANCE (x%) PAYMENT WITH SUPPORTING BANK GUARANTEE AND BALANCE PAYMENT AFTER RECEIPT OF MATL	11% PER ANNUM INTEREST ON THE ADVANCE AMOUNT FOR THE DELIVERY PERIOD+ 1 MONTH AND 11% PER ANNUM INTEREST ON BALANCE AMOUNT FOR ONE MONTH
B.2	SUPPLY OF EQUIPMENT INCLUDING E&C	PAYMENT TERMS (THE SUPPLIER MUST SUBMITT A PERFORMANCE BANK GUARANTEE (PBG) FOR 10% OF THE BASIC VALUE OF THE ORDER OF THE BASIC VALUE OF THE ORDER VALID FOR WARRANTY PERIOD.)	90% PAYMENT WILL BE MADE WITH IN 30 DAYS FROM THE DATE OF RECEIPT OF MATERIAL ON ACCEPTANCE AND BALANCE 10% WITH IN 30 DAYS OF COMPLETION OF E&C AND ON SUBMISSIONOF PERFORMANCE BANK GUARANTEE FOR 10% OF BASIC VALUE	SAME	NIL
				LC PAYMENT FOR 90% OF THE ORDER VALUE + 10% AFTER E&C WITH IN 30 DAYS	11% PER ANNUM INTEREST ON 90% OF BASIC VALUE FOR ONE MONTH
				90% OF BASIC VALUE AS ADVANCE BY WIRE TRANSFER WITH BANK GUARANTEE AND BALANCE 10% AFTER E&C BY WIRE TRANSFER WITH IN 30 DAYS	11% PER ANNUM INTEREST ON 90% OF THE BASIC VALUE FOR DELIVERY PERIOD + 1 MONTH
				x% OF TOTAL VALUE AS ADVANCE PAYMENT WITH BANK GUARANTEE AND BALANCE (I.E. 90-X)AFTER RECEIPT OF MATL BY WIRE TRANSFER AND 10% AFTER COMPLETION OF E&C	11% PER ANNUM INTEREST ON THE ADVANCE AMOUNT FOR THE DELIVERY PERIOD+ 1 MONTH AND 11% PER ANNUM INTEREST ON BALANCE AMOUNT OF 90% OF ORDER VALUE (I.E. 90-X%)
				C. PERFORMANCE BANK GUARANTEE, PBG (COMMON FOR INDIGENOUS AND IMPORTS)	
C.1		PERFORMANCE BANK GUARANTEE	PBG FOR 10% OF THE BASIC PO VALUE SHALL BE FURNISHED IN BHEL PRESCRIBED FORMAT.	IF NOT AGREED	10% OF THE BASIC MATERIAL COST
D. PENALTY (COMMON FOR INDEGENOUS & IMPORTS)					
D.1		LD CLAUSE	IN THE EVENT OF DELAY IN AGREED CONTRACTUAL DELIVERY, PENALTY OF 0.5% (HALF PERCENT) PER WEEK BUT LIMITED TO A MAX OF 10% VALUE OF UNDELIVERED PORTION OF BASIC MATERIAL COST WILL BE APPLICABLE	AGREED	NIL
				IF NOT AGREED	10% OF THE BASIC MATL COST
				IF AGREED FOR 5%	5% OF THE BASIC MATERIAL COST
				OTHER THAN THE ABOVE	10% MINUS THE AGREED MAX PERCENTAGE OF THE BASIC MATERIAL COST WILL BE LOADED.