

THE INFORMATION ON THIS DOCUMENT IS THE PROPERTY OF BHARAT HEAVY ELECTRICALS LIMITED.  
IT MUST NOT BE USED DIRECTLY OR INDIRECTLY IN ANY WAY DETRIMENTAL TO THE INTEREST OF THE COMPANY.

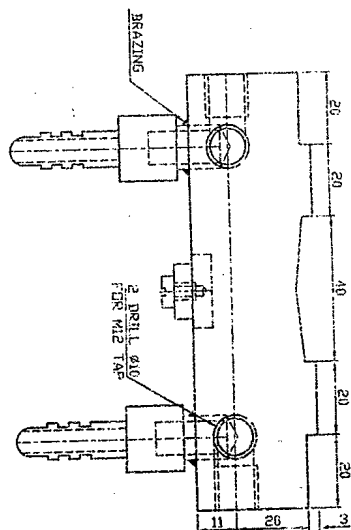

VIEW ON ARROW--A

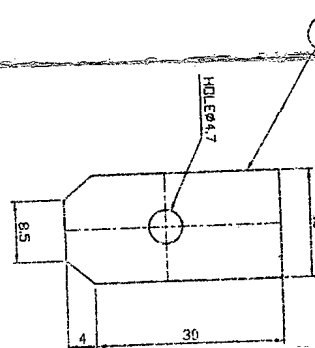
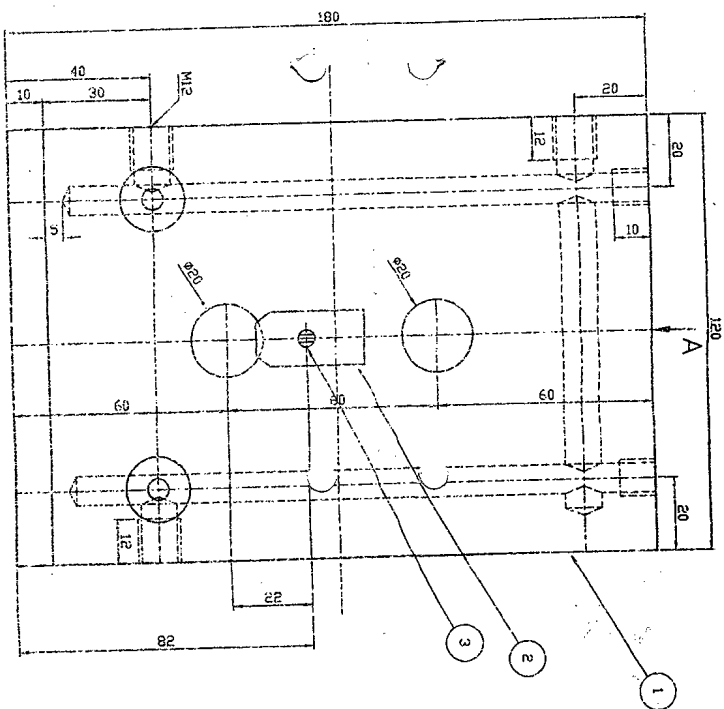

SCALE 2:1

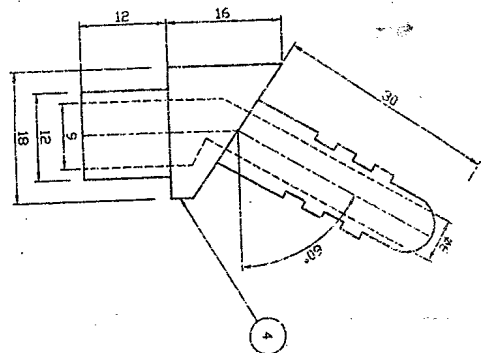

SCALE 2:1

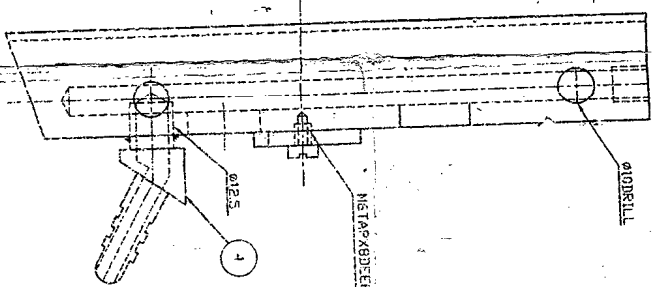
[illegible]

NOTES:-

1. ALL POINT TO BE PLUGED GRIND FLUSHED AND TESTED 2kg/cm<sup>2</sup> WATER PRESSURE.
2. ASSEMBLY TO BE TESTED AT 2kg/cm<sup>2</sup> WATER PRESSURE. NO WATER LEAKAGE IS PERMISSIBLE.
3. COPPER SHOE MATERIAL. HIGH THERMAL CONDUCT COPPER (Cu=88MMIN).

[illegible]

A: SIZE

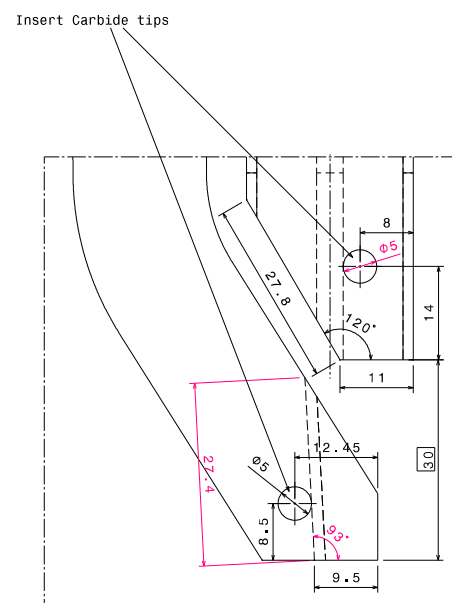
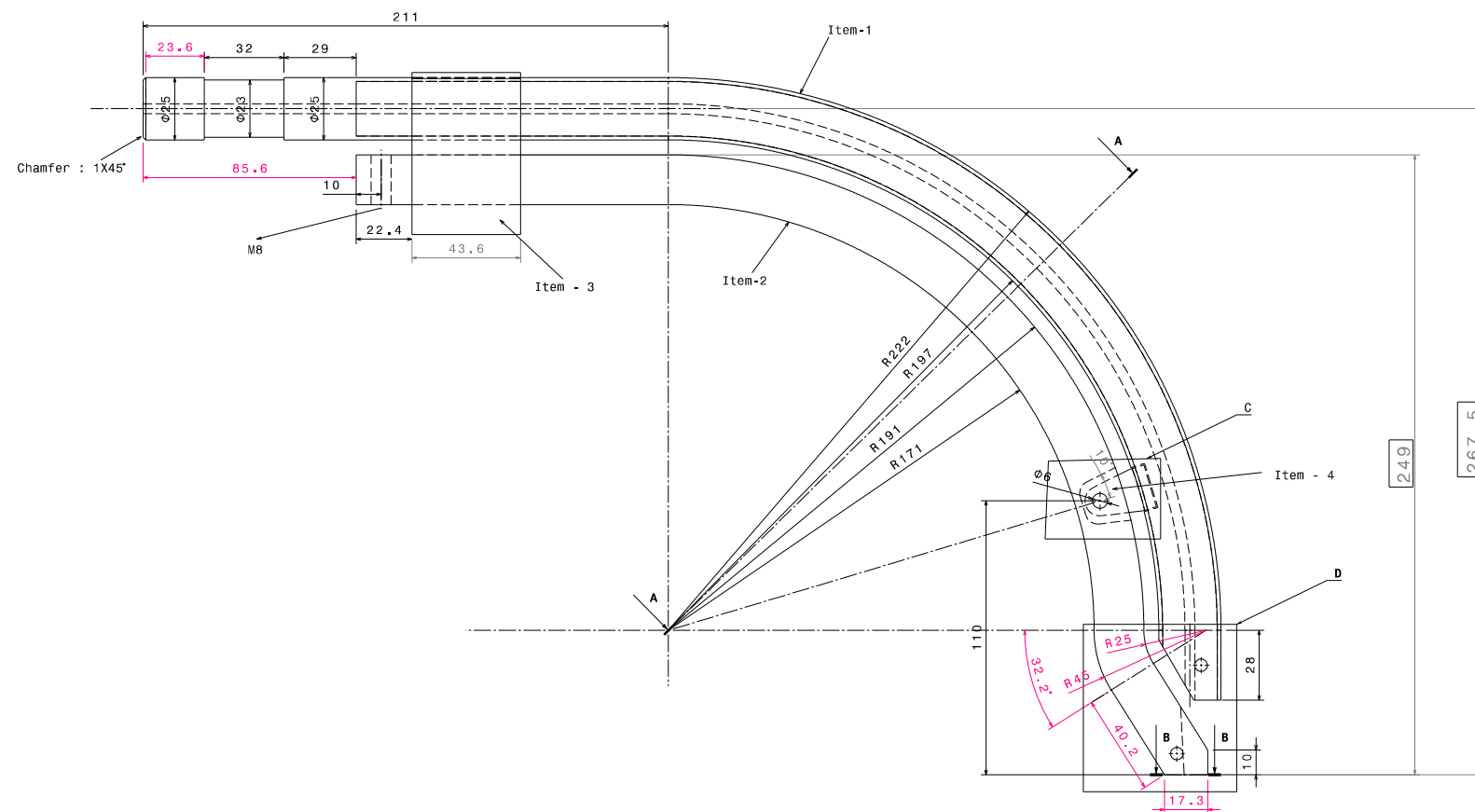

Detail D

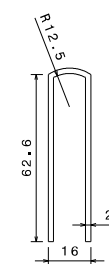

Item - 3

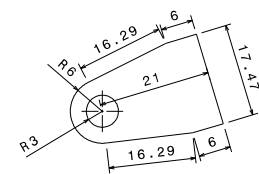

Item - 4

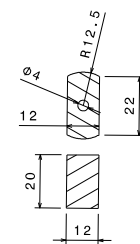

Section : A-A

Note: Hole Dia can be in between 4-5 mm so that hard steel ball of 4 mm dia should easily pass through out the nozzle.

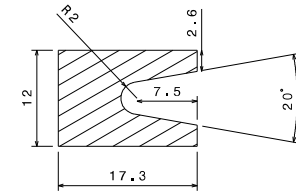

Section : B-B

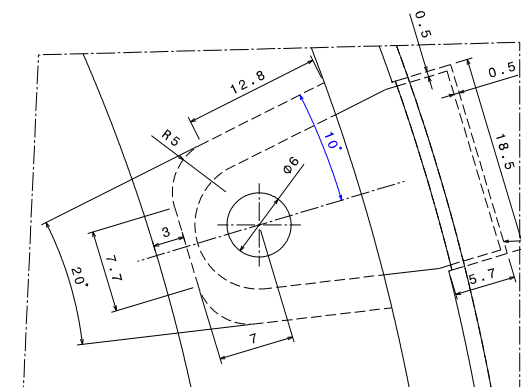

Detail C

Slot : 18.5X5.7X3

Note :  Represents reference dimension

Item No.	Material	BOM
Item-1	Hard copper -Ni-Plated	1
Item-2	MS - Nickel Plated	1
Item-3	MS-AA10108	1
Item-4	MS-AA10108	1
Item-5	Screw M8X40 with Bakelite knob	1

<div>First Angle Projection</div> <div>All dimensions are in MM</div> <div>DESIGNED BY Sunil Vishwakarma</div>	BHEL				
	DRAWING TITLE      ESW Nozzle-Lower				
	SIZE A0	DRAWING NUMBER WDT619435406			REV X
	SCALE	WEIGHT (kg)			SHEET    1 / 1

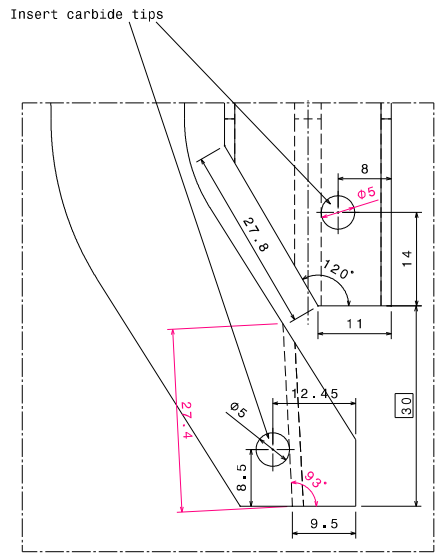
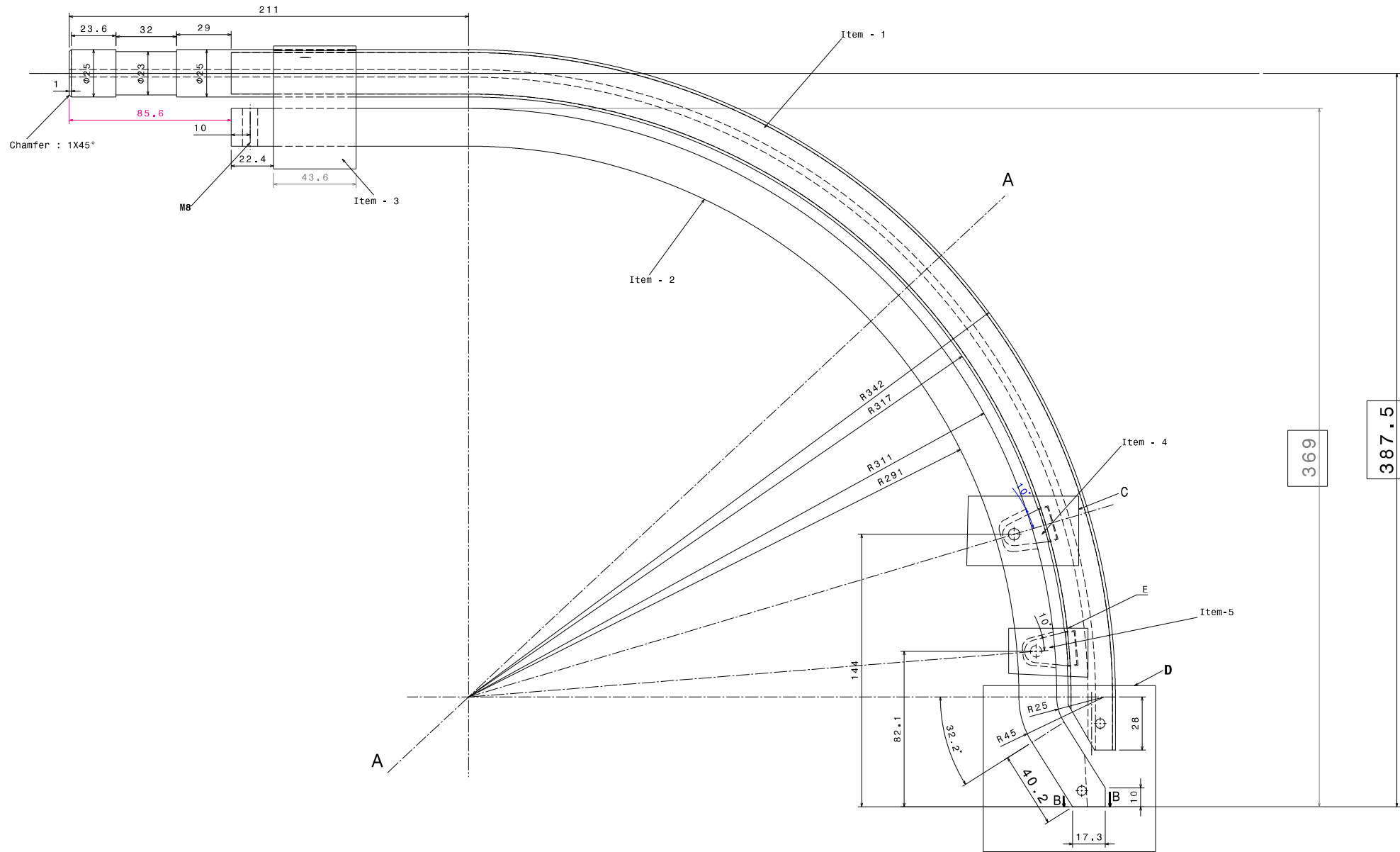

Detail D

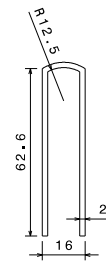

Item - 3

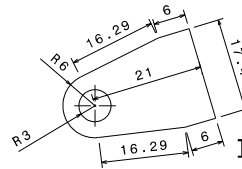

Item - 4

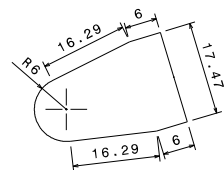

Item - 5

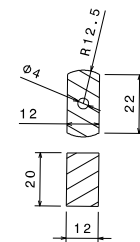

Section : A-A

Note: Hole Dia can be in between 4-5 mm so that hard steel ball of 4 mm dia should easily pass through out the nozzle.

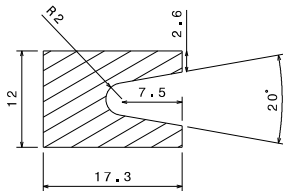

Section : B-B

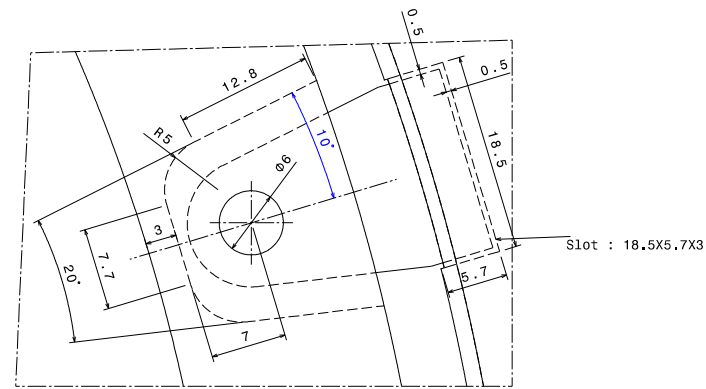

Detail C

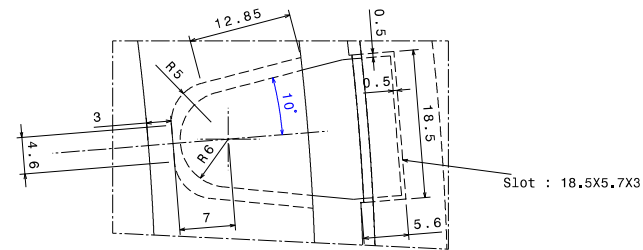

Detail E

Note : ☐ Represents reference dimension

Item No.	Material	BOM
Item-1	Hard copper -Ni-Plated	1
Item-2	MS - Nickel Plated	1
Item-3	MS-AA10108	1
Item-4	MS-AA10108	1
Item-5	MS-AA10108	1
Item-6	Screw M8X40 with Bakelite knob	1

First angle projection All dimensions are in mm	BHEL			
	DRAWING TITLE ESW Nozzle-Middle			
DESIGNED BY Sunil Vishwakarma	SIZE A0	DRAWING NUMBER WDT619435407	REV	
SCALE		WEIGHT(kg)	SHEET	