

3-V-0000-17424/06  
DRAWING NO.

SL. No.	DRAWING NUMBER	COMPONENT CODE	DIMENSIONS								t	ELECTRODE	Wt. (kg)	REMARKS
			ØD	PCD	ØD1	Ød x N	L	L1	L2	H				
01	3-V-N233-17424	93 105 592 0000	330.0	295.0	243.0	19x16	403.2	75.99	42.36	224.0	7	E9018-B3	88.38	6"-300CLASS-WC6
02	3-V-N248-17424	93 106 028 0000	330.0	295.0	243.0	19x16	403.2	75.99	42.36	224.0	7	E7018	88.38	6"-300CLASS-WCB
03	3-V-N249-17424	93 106 027 0000	330.0	295.0	243.0	19x16	403.2	75.99	42.36	224.0	7	E7018	88.38	6"-300CLASS-WCC
04	3-V-N250-17424	93 106 026 0000	330.0	295.0	243.0	19x16	403.2	75.99	42.36	224.0	7	E9018-B3	88.38	6"-300CLASS-WC9
05	3-V-N244-17424/01	93 106 029 0000	415.0	370.0	306.0	22.4x16	419.1	94.192	49.615	282.0	7	E7018	136.0	8"-300CLASS-WCB
06	3-V-N245-17424/01	93 106 030 0000	415.0	370.0	306.0	22.4x16	419.1	94.192	49.615	282.0	7	E7018	136.0	8"-300CLASS-WCC
07	3-V-N246-17424/01	93 106 031 0000	415.0	370.0	306.0	22.4x16	419.1	94.192	49.615	282.0	7	E9018-B3	136.0	8"-300CLASS-WC6
08	3-V-N247-17424/01	93 106 020 0000	415.0	370.0	306.0	22.4x16	419.1	94.192	49.615	282.0	7	E9018-B3	136.0	8"-300CLASS-WC9
09	3-V-K623-17424/01	93 106 021 0000	415.0	370.0	306.0	22.4x16	419.1	94.192	49.615	282.0	7	E9018-B3	136.0	8"-300CLASS-WC9
10	3-V-N343-17424/01	93 106 060 0000	415.0	370.0	306.0	22.4x16	419.1	94.192	49.615	282.0	7	E7018	136.0	8"-300CLASS-WCB(ST.SEAT)
11	3-V-N322-17424	93 106 713 0000	330.0	295.0	243.0	19x16	403.2	75.99	42.36	224.0	7	E7018	88.38	6"-300CLASS-WCB(ST.SEAT)
12	3-V-M480-17424	93 107 308 0000	330.0	295.0	243.0	19x16	403.2	75.99	42.36	224.0	7	E7018	88.38	6"-300CLASS-WCB(ST.SEAT) WITH TOA EMBOSS
13	3-V-N688-17424	93 108 356 0000	330.0	295.0	243.0	19x16	403.2	75.99	42.36	224.0	7	E347	88.38	6"-300CLASS-CF8M WITH CF8M SEATRING
14	3-V-U003-17424	93 109 828 0000	330.0	295.0	243.0	19x16	403.2	75.99	42.36	224.0	7	E7018	88.38	6"-300CLASS-WCB SEATRING WITH 250BHN(MIN.)
15	3-V-N189-17424	93 <del>110 646</del> 0000	415.0	370.0	306.0	22.4x16	419.1	94.192	49.615	282.0	7	E347	136.0	8"-300CLASS-CF8M

✓ / 0.8

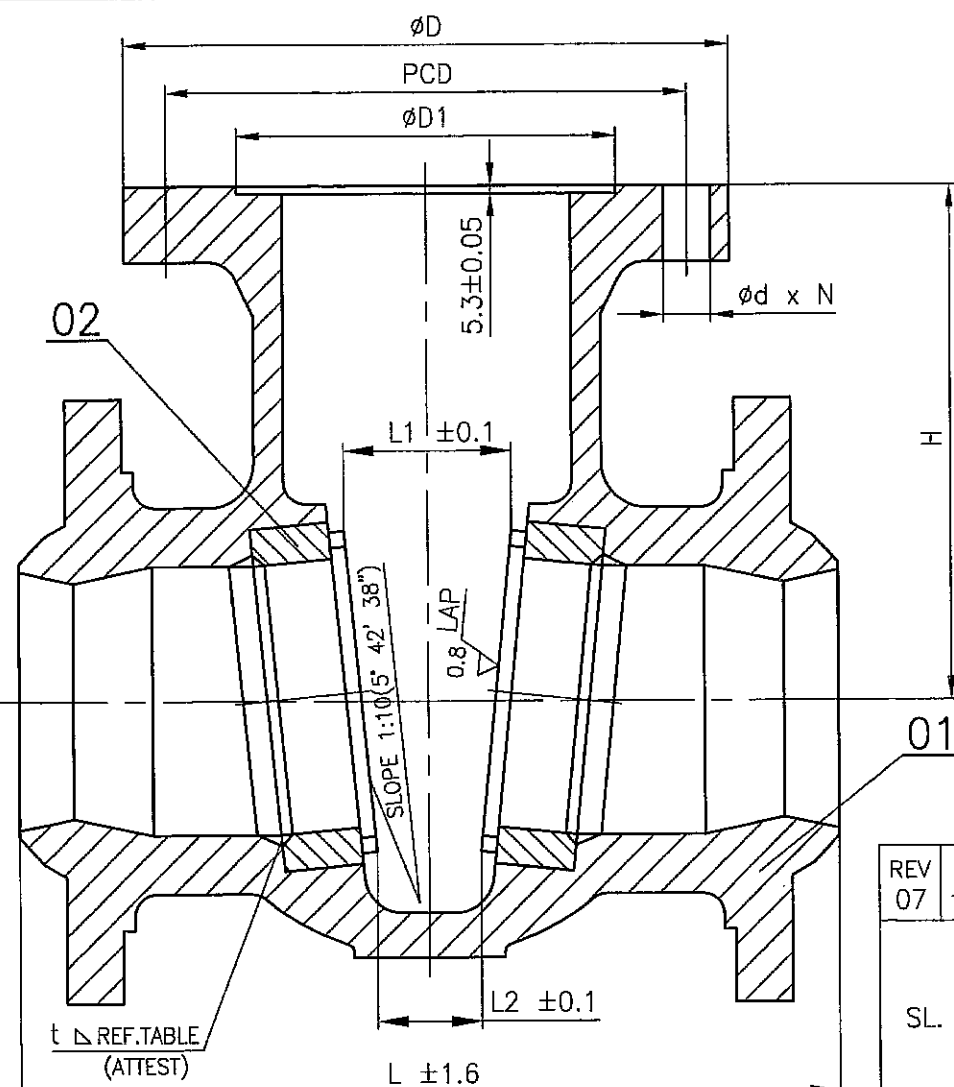

REV 07 DATE 18.06.02 ALTERED K.P.LEON CHD & APPD

SL. NUMBER 15 INCLUDED

DRAWING RETRACED WITH 07 REVISION ON 18.06.2002

NO OFF	DESCRIPTION	MATL CODE	MATL SPECN	HEAT TREATMENT	SCRAP SORT	NET WT (kg)	GROSS WT (kg)	DRAWING No.	ITEM No.
	TYPE OF PRODUCT OR NAME OF CUSTOMER/PROJECT	CS							
Bharat Heavy Electricals Ltd.		DRN	NAME K.P.LEON		SIGN	DATE 18.06.02	NO. OF VAR.		
UNIT: HIGH PRESSURE BOILER PLANT.		CHD	P. BOOMINATHAN		SIGN	DATE 18.06.02	—		
TIRUCHIRAPALLI 620014.		APPD	K.S.RAMAN		SIGN	DATE 18.06.02	—		
DEPT VL	SCALE	WEIGHT (KG).		REFERENCE INFORMATION			NO. OF ITEMS		
CODE 320	NTS.	—		CAD:C317424			—		
TITLE		CARD CODE	DRAWING NO.		REV				
BODY ASSEMBLY (BW)		U 01	3-V-0000-17424		07				

SCANNED

Size A3