

IMP. NOTE:-  
 1. GM , AGM , CONFERENCE ARE FULL HEIGHT CABIN OF 100 MM THK AAC BLOCKS & FIXED GLAZING TO BE PROVIDED TOWARDS CORRIDOR  
 2. DGM CABIN WILL BE IN 75MM THK. PARTITION OF 1200 HIGH.  
 3. EVERY WORKSTATION SHOULD HAVE ONE STORAGE UNIT OF 900X450X1200 HIGH  
 3. FURNITURE OF EXISTING PERI & MPL BHEL BUILDING WILL BE USED IN 11TH ,12TH ,13TH &15TH FLOOR

NAME	NO.	AREA(SQM)
GM	6	28
AGM	13	18
DGM	10	10
WS	128	
CONF.(10)	1	20
CONF.(16)	1	38

This drawing all its contents is the sole property of SPACE COMBINE copying of this drawing or part thereof or its use in any form whatsoever without the written permission of SPACE COMBINE is strictly prohibited

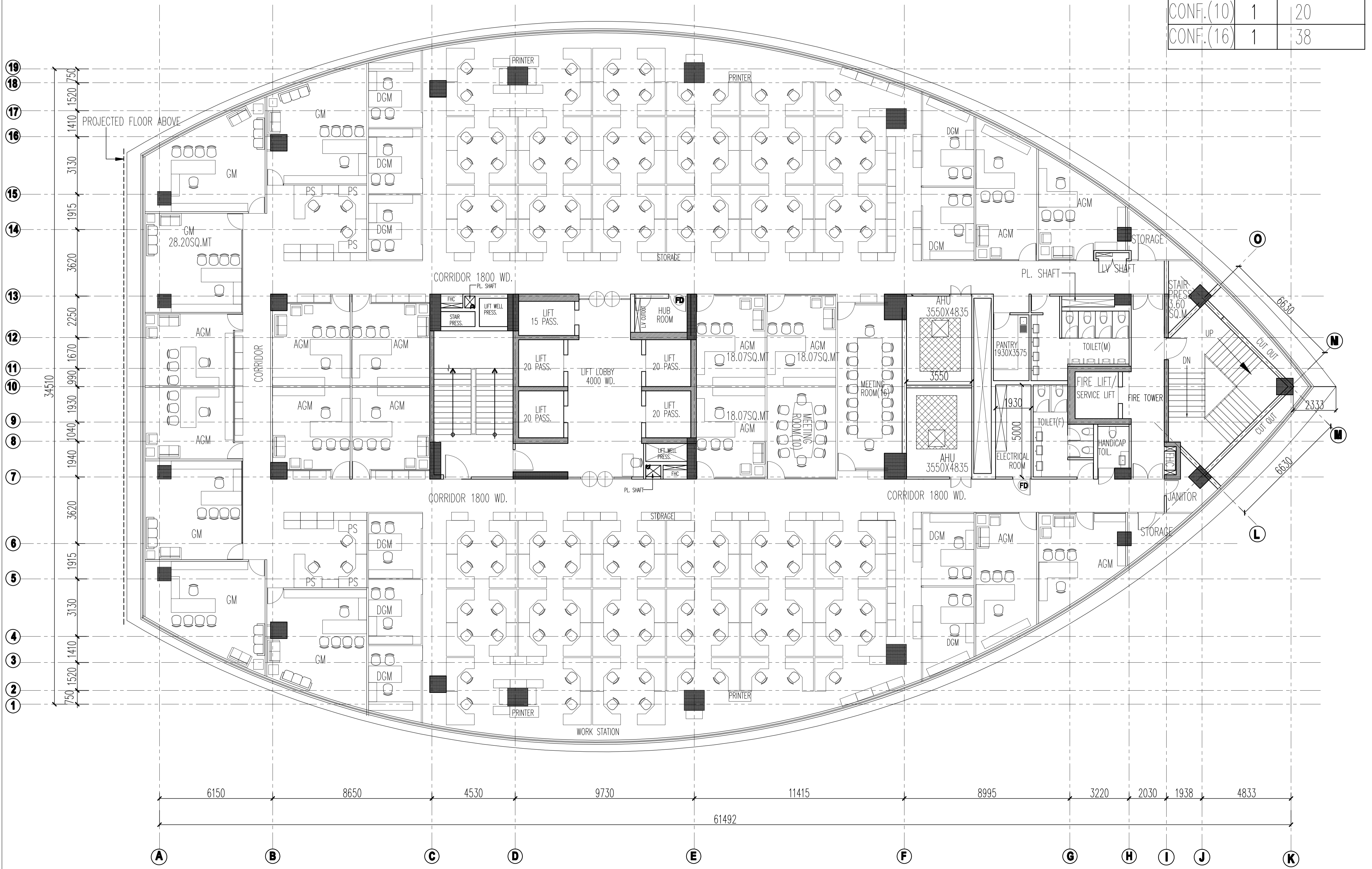
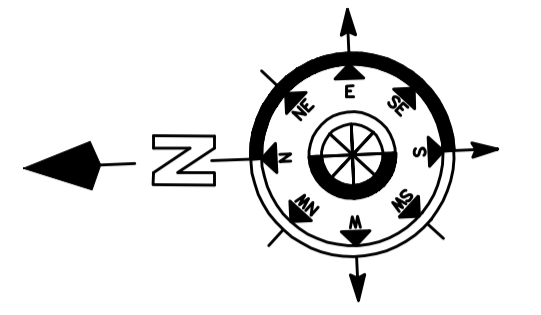

nos.	date	issued to

rev. no.	date	revision
R1	25/07/2017	BUILDING REVISED

client: **BHEL**  
 BHARAT HEAVY ELECTRICAL LIMITED  
 BHEL HOUSE, SIRI FORT NEW DELHI

project : **CORPORATE TOWER**  
 AT MDI COMPLEX FOR BHEL  
 AT PLOT-25,SECTOR 16-A, NOIDA (U.P.)

title : **4 TH FLOOR PLAN**

drawing released for :  
 FOR TENDER  
 AUTHORITY  
 CONSTRUCTION

drp. no. SC/BH/A/105 date 25/07/2017

scale 1:100 revision R1

drawn by RUPESH ctd by AMIT

architects **SPACE COMBINE**  
 Architects,Engineers,Planners  
 A1/112 SAFDARJUNG ENCLAVE,  
 Ph.No:- 4615000  
 NEW DELHI 110029