

69130-010-19-2 .ON .DRG

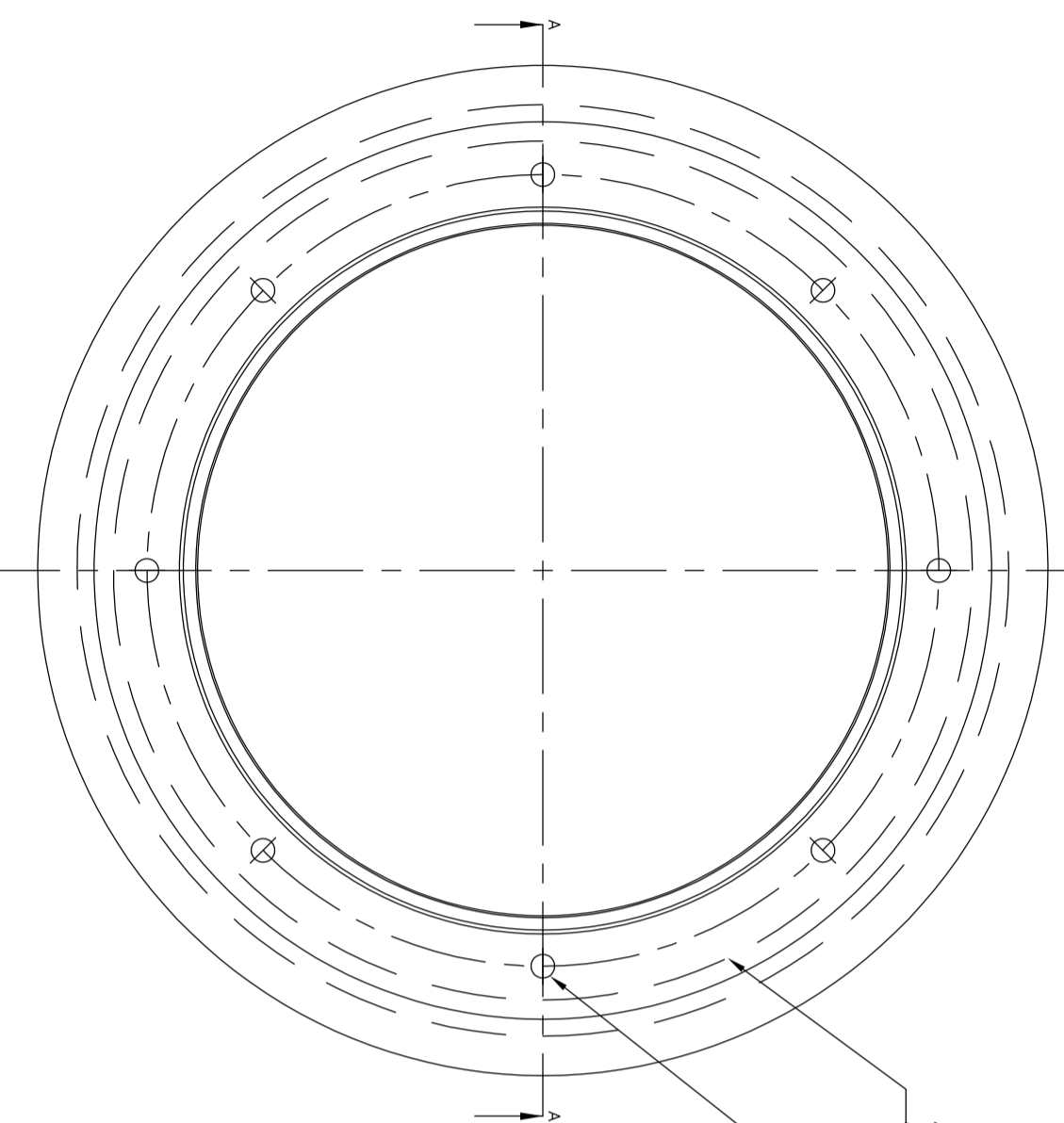
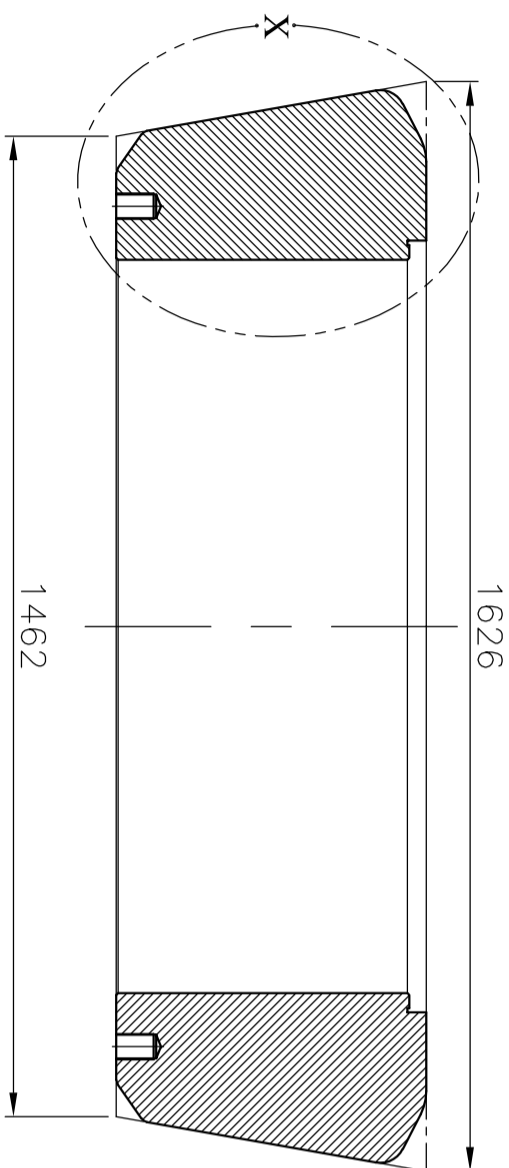

A/AE ROLLER IDENTIFICATION NUMBER TO BE PUNCHED AT FINAL STAGE ON TOP & BOTTOM FACES

8 TAPPED HOLES EQUISPACED
1.5"-6UNC X 63.5mm DEEP ON PCD 1174

$\varnothing 1.27$ (S) (P)139.7BA(M)
 $\perp 0.25$ (B)

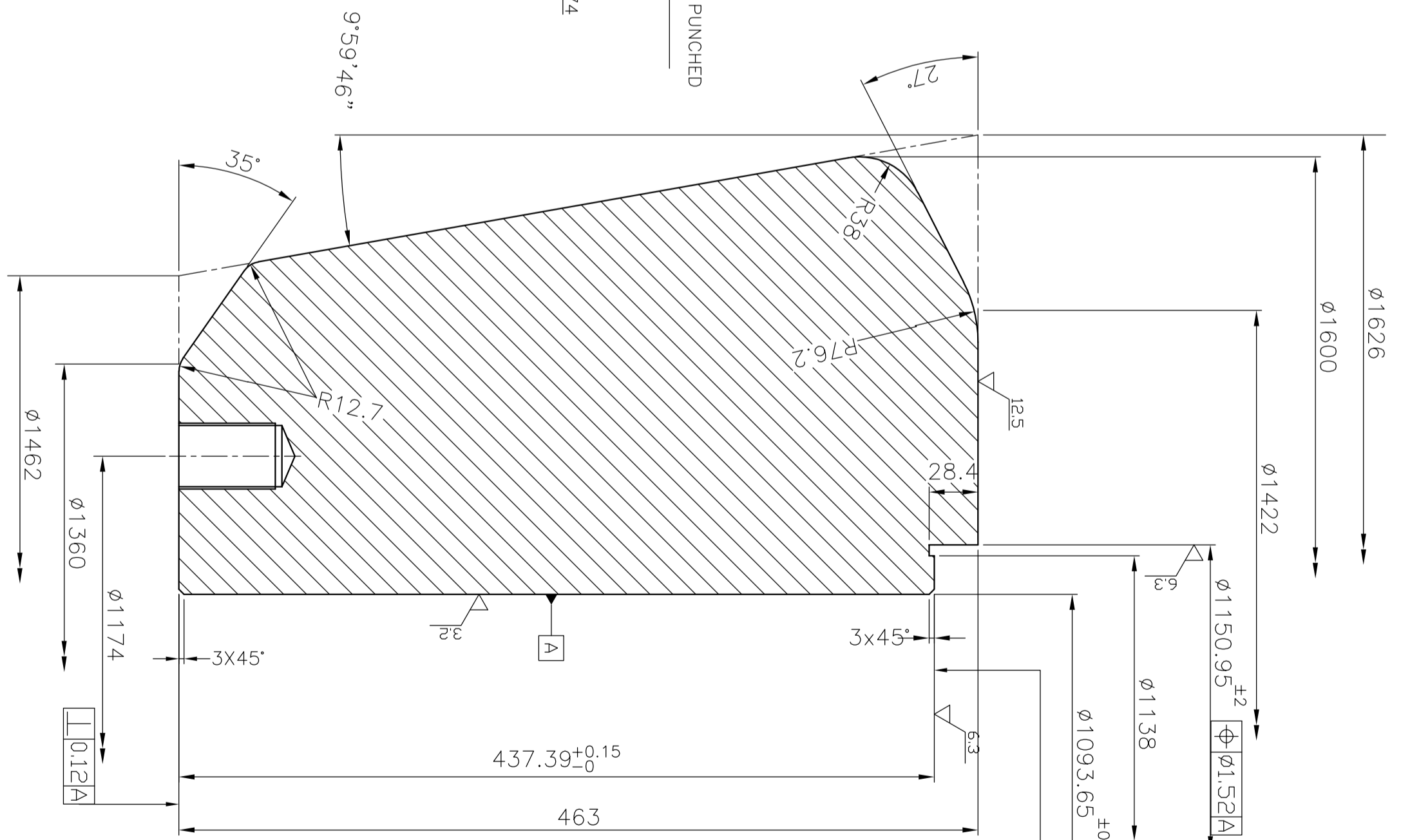

RAW MATERIAL WT/PC: 3374.0

THE FOLLOWING CONDITIONS APPLY EXCEPT OTHERWISE STATED.

1. REF. TO HY0230261 FOR UNSPECIFIED TOLERANCES.
2. CHAMFER M/CD: SHARP EDGES 1.2 TO 1.0 AT 45°.
3. INTERNAL M/CD: CORNER RADI 1 TO 0.7
4. THE SURFACE ROUGHNESS WHERE-EVER NOT SHOWN SHALL BE TAKEN FROM THE SURFACE ROUGHNESS SHOWN OUT SIDE THE BACK SLASH GIVEN OR THE TOP MOST RIGHT CORNER OF THE DRG.



TYPE OF PRODUCT: HP 1023-1103- COAL MILL
 NAME OF CUSTOMER/PROJECT: BHARAT HEAVY ELECTRICALS LIMITED HYDERABAD

DEPT. PULV ENGG	UNTOOL DMS. GR	SCALE	WEIGHT (KG)	NAME	DATE	NO. OF
446	q/m/y	1:5	3155.0	BGK	10.03.12	VAR.
				AMAN		
				S.G		

GRINDING ROLL 63"

DRAWING NO. 2-61-010-03169 00

INVENTORY NO	SIGN. AND DATE	REF. DRG. NO.	COMPUTER FILE NAME
--------------	----------------	---------------	--------------------

REV.	DATE	ALTERED	APPD.	REV.	DATE	ALTERED	APPD.	REV.	DATE	ALTERED	APPD.
ZONE		CHD.		ZONE		CHD.		ZONE		CHD.	

REV.	DATE	ALTERED	APPD.
ZONE		CHD.	

SHEET NO. 01	NO OF SHEETS 01
--------------	-----------------