



An ISO 9001
Company

Bharat Heavy Electricals Limited

(High Pressure Boiler Plant)

Tiruchirappalli – 620014, TAMIL NADU, INDIA

PURCHASE/PSS/MM/MFG

TITLE: SUPPLY OF STEEL CUPBOARDS FOR ARTISIAN	Phone: +91 431 2577054/2577049 Fax : +91 431 252 0719 Email : sankars@bheltry.co.in
--	--

	Reference Number: Enquiry 2001200543	Enquiry Date: 19.09.2012	Due date for submission of quotation: 18.10.2012
--	---	---	---

You are requested to quote the Enquiry number & date and due date in all your correspondences. This is only a request for quotation and not an order

Sealed Tenders are invited for **Supply of Steel Cupboards for Artisans required at various shop floors of BHEL/ HPBP complex** as per Spec and Drawings enclosed.

BHEL commercial terms & conditions with Price Bid formats and all annexure can be downloaded from BHEL web site <http://www.bhel.com> or from the Government tender website <http://tenders.gov.in> (public sector units) Bharat Heavy Electricals Limited) under enquiry reference "2001200543 "

Tenders should reach us before 14:00 hours on the due date Technical bid will be opened at 14:30 hours on the due date Tenders would be opened in presence of the tenderers who have submitted their offers and who may like to be present.	Yours faithfully, For Bharat Heavy Electricals Limited The Senior Manager/Purchase/PSS/MM/MFG Bldg 24, BHEL, Tiruchirappalli-620014 Ph: 0431- 2577054/7049, Fax: 0431- 2520719 Email: sankars@bheltry.co.in
---	--

**General Note: BHARAT HEAVY ELECTRICALS LIMITED**

Page:1/2

(A Government of India Undertaking)
 HIGH PRESSURE BOILER PLANT
 PURCHASE DEPARTMENT - FOSSIL BOILERS
 THIRUCHIRAPALLI - 620014
 TAMILNADU (INDIA)

PHONE : 910431/520730
 GRAMS : BHARATELEC
 FAX NO: 910431/520730
 E-mail : edoffice@bheltry.co.in
 WEB : http://mm.bheltry.co.in

429-002/A

OFFICE COPY	Collective No.	Enquiry Date	Due Date For Quotation
	2001200543	19.09.2012	18.10.2012
Please quote Enquiry No, Date and due date in all correspondences. This is only a request for quotation and not an order			

Item	Description	Unit	Quantity	Delivery Quantity	Schedule Date
10	STEEL CUPBOARDS FOR ARTISANS AS PER SPEC AND DRAWING ENCLOSED	NO	2050.000	2,050.00	30.03.13

General Note:

Annexure I-a, I-b, II (a), II(b) & III are applicable.

Note for Bidders:

Note for Bidders:

1. Bidders should primarily be engaged in manufacturing (Original Equipment Manufacturer-OEM) and supply of Steel Cupboards for industrial use. Offers from traders / agents will not be considered.
2. This is a two part bid and detailed Terms & Conditions are enclosed.(Annexures-I-a & I-b).
3. Bidders are requested to submit Technical Specifications (Qualification Bid) and Price Bid separately as per our Annexures - II(a), II (b) & III.
4. For verification of data submitted towards evaluation of bidder's capability, BHEL may decide to visit the bidder(s) works. Any fact found deviating from submitted data shall make the bidder liable to be disqualified.
5. One sample piece should be inspected by BHEL before full consignment delivery starts.
6. Delivery required in lots of minimum 200 Nos. once in every 15 days and should be completed on or before 30.03.2013.
7. Delivery has to be made in the respective workspot of HPBP.
8. Supplier's name board should be affixed on each cupboards.

Enclosures:

Annexures: I-a, I-b, II (a), II (b) & III.

Drawing NO.: PR: 81900796/03.07.12

Enclosures:**"LD clause has to be confirmed without fail."****"Payment to vendors will be made only thro E-Payment mode."****PR Links**

The offers should reach us 30 minutes before the time of opening of tenders.
 The offers will be opened at 14.30 hrs on the due date of tender in the presence of tenderers who have submitted their offer and who may like to be present for the tender opening.Late and delayed offers are liable to be rejected.

Yours faithfully,
 For **BHARAT HEAVY ELECTRICALS LIMITED**

S. SANKARARAJAN
 Sr. Manager / Purchase / P&S
 BHEL, THIRU - 620014.

S. Sankararajan
 MANAGER / PURCHASE
 (FOSSIL BOILERS)

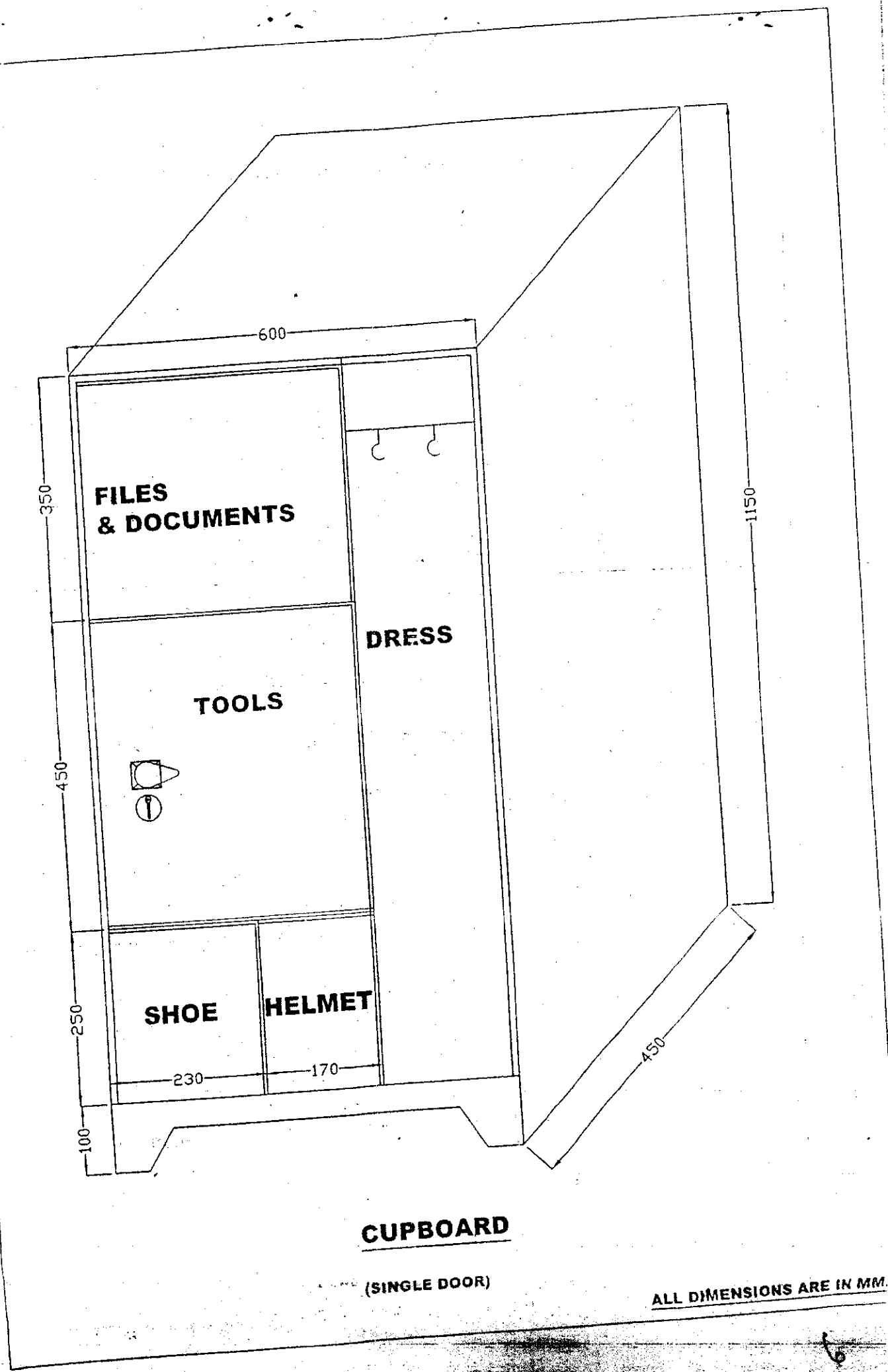

CUPBOARD

(SINGLE DOOR)

ALL DIMENSIONS ARE IN MM.

Specification for standard steel cup board for artisans

Cup board Unit : Required for the storage of variety of tools, gauges, files & documents, dress materials, shoes, helmet, etc.

Construction : The minimum thickness of CRCA steel conforming to IS:513 Gr.D is 1.20mm for all sides and internal partitions. Single steel door at front side has to be provided as shown in the sketch. Hanger arrangement has to be provided for dress materials as shown in the sketch.

Dimensions: 600mm (W) x 450mm (D) x 1150mm (H) – Approx.

Locking & Handle: Aesthetically appealing good quality lock with two keys is to be provided. Keys should have a unique quality such that interchangeability is not there with another cup board. Good quality chromium plated or powder coated handle is preferred.

Painting: Epoxy polyester powder coated to the thickness of minimum 40 microns. Before powder coating, metal surfaces are to be treated for antirust. Preferred colour of painting is olive green.

Note: 1) Offers received from indian OEM only will be considered

2) OEM should have their own press brake, powder coating plant with baking oven, pre cleaning devices, powder applications, etc.

3) Offers received from other than OEM without required facilities as mentioned in point No.2 will not be considered by BHEL.

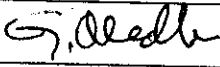
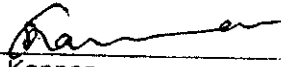
PREPARED BY		CHECKED BY	
Signature		Signature	
Name	G.Madhuramani	Name	K.Kannan
Designation	Sr.Manager	Designation	Sr.Dy.General Manager
Department	Management Services	Department	Management Services

Bharat Heavy Electricals Ltd. Tiruchirapalli-620 014
PSS/MM/MFG

TERMS AND CONDITIONS TO ENQUIRY NO: 2001200543 DT: 19.09.2012.

THE FOLLOWING TERMS & CONDITIONS ARE APPLICABLE TO THE ENQUIRY, IN ADDITION TO THE GENERAL TERMS AND CONDITIONS MENTIONED IN ANNEXURE I-b.

01. The quotation shall be submitted as two part bids. Techno-commercial bid as per Annexure II(a) & II(b) shall be put in a cover and super scribed **TECHNO-COMMERCIAL BID AGAINST ENQUIRY NO: 2001200543 DT: 19.09.2012**. Price bid as per Annexure III containing price details shall be put in a separate cover and super scribed as **PRICE BID AGAINST ENQUIRY NO: 2001200543 DT: 19.09.2012**. Both the covers shall be put inside a larger envelope and this envelope shall be super scribed as **TECHNO-COMMERCIAL BID AND PRICE BID AGAINST ENQUIRY NO: 2001200543 DT: 19.09.2012**.
02. The Tender should be addressed to 'The Senior Manager, Purchase/PSS/MM/MFG, Bharat Heavy Electricals Ltd. Bldg.24, Tiruchirapalli-620 014'.
03. On the due date of tender opening, only the technical bids will be opened and evaluated. Clarifications required, if any, will be called for from the bidders on technical and commercial points. BHEL reserves the right to go in for reverse auction instead of opening of price bid, which will be decided after techno-commercial evaluation.
04. Price should be quoted on **FOR / Destination basis only** (inclusive of freight and transit insurance). Ex-works offers will be rejected.
05. BHEL reserves the right to increase or decrease the tendered quantity and split the tender quantity among more than one tenderer and place order accordingly in any proportion, based on commitment, requirement and supplier's capability in terms of delivery and quality.
06. Inspection at vendor's works by BHEL/ BHEL appointed agency (Inspection cost at BHEL scope).
07. Payment will be made in 45-90 days on satisfactory receipt of items at BHEL Trichy. Offers quoting for Advance payment / LC /100% thro bank payment will be rejected.
08. Confirm BHEL standard LD clause as mentioned in Annexure I-b.
09. Risk Purchase clause applicable.
10. Supplier's name plate should be fixed on the products.
11. Guarantee to be given for 12 months from the date of supply of items.
12. Offers should have a validity of minimum 90 days from the date of tender opening.
13. Lowest price received against BHEL tenders need not be the technically acceptable one and in that case BHEL reserves the right not to consider the same.
14. BHEL reserves the right to negotiate or refloat the tender opened if L1 price is not the lowest acceptable price to them inter-alia other reasons.
15. BHEL reserves the right to negotiate the L1 rate.

**BHARAT HEAVY ELECTRICALS LTD. TIRUCHIRAPALLI-620 014
PURCHASE / PSS / MANUFACTURING**

GENERAL TERMS AND CONDITIONS

1.a) **QUOTATIONS:** Each tender should be sealed with tenderer's distinctive seal and super scribed with correct tender no., item of supply and due date of opening. Two or more quotation should not be sent in one cover but the quotation against each tender should be sent separately to avoid confusion. Tender should not be addressed to any individual's name but only by designation.

b) Tenders should be free from CORRECTION AND ERASURES. Corrections if any must be attested; all amounts shall be indicated both in words as well as in figures. Where there is difference between amount quoted in words and figures, amount quoted in words shall prevail.

c) Price should be **nett F.O.R. Destination station** inclusive of risk in transit and remain valid for 90 days from the due date.

d) If any sales tax is payable as extra to the quoted price it should be specifically stated in quotations along with CST & VAT Number failing which the purchaser will not be liable for payment of sales tax. Our TIN 33243560005 dt.01.01.2007 & CST no 239383 dt, 11.06.1991

e) No revision of prices will be entertained after tenders are opened. The quoted prices should remain firm till the execution of the orders.

f) Manufacturer's Name, Trademark or Patent Number if any should be specified. Illustrative leaflets giving technical particulars are required along with quotation wherever necessary.

g) Products with I.S.I certification marks will be preferred.

h) The purchaser shall be under no obligation to accept the lowest or any other tender and shall be entitled **to accept or reject any tender in part or full** without assigning any reason whatsoever.

2. PACKING AND MARKING: The supplier shall arrange for securely protecting and packing the stores to avoid loss or damages during transit.

3. TERMS OF PAYMENT: Payment will be made within **45-90 days** of satisfactory receipt of materials at site. Wherever required by the purchaser, the successful tenderer must send the Operation and Maintenance manuals, Test Certificates, drawings, etc., for the materials ordered. These should be sent immediately after dispatch of the materials and a statement to that effect should be made in the invoice. Failure to comply with this provision will result in delay in payment of the bills. Goods dispatched either by V.P.P or by the document presented through Bank will not be accepted unless agreed to by the purchaser.

The duplicate copy of the invoice meant for the transporters should accompany the material as stipulated under C.E. rules 52a and 173 c (or) 57gg. A Photostat copy of the above invoice for each Delivery Challan should be submitted along with the original bills routed through Bank or submitted directly to BHEL Finance Department.

4. LIQUIDATED DAMAGES PENALTY AND INTEREST ON ADVANCES FOR DELAY IN DELIVERY:

If the Supplier fails to deliver the raw material equipment components within the period specified in the contract the Purchaser shall deduct liquidated damages a sum equivalent to 0.5% of the price for each week of delay up to a maximum of 15% of the price of the delayed undelivered goods. In addition to the recovery of interest at normal cash credit rate plus 2% for the unadjusted portion of the advances, if the delay in delivery of a part contributes to delay in execution of total system, LD and interest on advances will be recovered on the total contract price / total advance paid.

5. RISK PURCHASE: Alternatively the purchaser at his option will be entitled to terminate the contract and to purchase elsewhere at the risk and cost of the seller either the whole of the goods or any part which the supplier has failed to deliver or dispatch within the time stipulated as aforesaid or if the same were not available, the best and the nearest available substitutes therefor. The supplier shall be liable for any loss, which the purchaser may sustain by reason of such risk purchases in addition to penalty at the rate mentioned in clause 6 above.

6. MODVAT CREDIT: If any Excise Duty is payable, the Chapter Head / Sub-head reference and the rate of the duty should be quoted. If the tenderer is availing MODVAT credit for this input material, the effect of Proforma credit should be passed on to the purchaser. BHEL will not be issuing any 'C' form for claiming ED exemption.

7. GENERAL: Order will be placed to the successful vendor on the basis of qualified / cumulative L-1 / acceptable rate.

Any other conditions which might have been quoted by the seller and are in contravention to the terms prescribed in the order and which have not been specifically accepted in by purchaser will not be applicable to the contract.

BHARAT HEAVY ELECTRICALS LTD
PURCHASE/PSS -- MM/MFG
Annexure II (a) - UNPRICE BID FORMAT

Unprice Bid Annexure to Enquiry No. 2001200543 Dated: 19.09.2012, due date: 18.10.2012

Material : Steel Cupboards for Artisans

S.No	Matl Code	Desc	Drawings/Standards	Units	Qty
10	-	Steel Cupboards for Artisans	DRG.NO.: PR:81900796/03.07.12	No	2,050
Excise Duty rate (mention in % if applicable, mention as NIL if not applicable)					
Cess on ED rate (mention in % if applicable)					
CST (%) / VAT (%)					
Delivery period					
Offer Validity (90 Days)					
Guaranty period (12 months from the date of supply)					

To be mentioned by supplier

To be mentioned by supplier

To be mentioned by supplier

To be mentioned by supplier

To be mentioned by supplier

To be mentioned by supplier

Authorised signatory with seal



An ISO 9001
Company

Dept: PSS/MM/MFG

ANNEXURE-II (b)

ACCEPTANCE OF TECHNO - COMMERCIAL TERMS AND CONDITIONS BY THE BIDDERS
(To be Filled and submitted for evaluation and to consider for Price-Bid opening)

Description of the Item:	STEEL CUPBOARDS FOR ARTISIAN'S	
Enquiry Ref:	2001200543 Dt.: 19.09.2012	
SI No.	Description	Vendor's confirmation
1	The tender will be operated on Two part bid basis and you are requested to submit both Techno-Commercial bid and Price Bid in a single sealed cover.	
2	Technical : Supply shall be as per BHEL's Respective Specification.	
3	Firm Price: The quoted/Finalised rates shall be Firm till execution of the supplies.	
4	Delivery and Price Basis: The rates are to be quoted on FOR Destination basis inclusive of Packing, Forwarding & Freight charges to supplier account. (Ex-works offers will be rejected)	
5	Payment terms: Payment will be made within 45-90 days on satisfactory receipt of materials at BHEL Trichy. (Offers quoting for advance payment / LC / 100% thro bank payment will be rejected)	
6	Liquidated damages: Our standard LD term is 0.5% per week subject to a maximum of 15% shall be applicable for late deliveries.	
8	Delivery Period: Bidder shall indicate the firm delivery period required for the delivery of the materials from the date of Purchase Order.	
9	Validity: Price Validity of your offer shall be Minimum 90 days from the date of Techno-Commercial Bid opening.	
10	Taxes & Duties: Please mention all the taxes and duties and other price elements applicable clearly in your offer.	
11	Guarantee: Guarantee should be given for 12 months from the date of actual put in use.	
12	Risk Purchase clause:	
13	BHEL reserves the right to negotiate or refloat the tender opened, if L1 price is not the lowest acceptable price to them inter-alia other reasons.	

Dt:

Signature with Seal

BHARAT HEAVY ELECTRICALS LTD
PURCHASE/PSS -- MM/MFG
ANNEXURE III - PRICE BID FORMAT

Price Bid Annexure to Enquiry No.2001200543 Dated: 19.09.2012, due date: 18.10.2012

Material : Steel Cupboards

S.No.	Matl Code	Desc	Drawings	Units	Qty	Price/Pc	
						In Fig.	In Words
10	-	Steel Cupboards for Artisian	DRG.NO.: PR:81900796/03.07.2012	No	2,050		

Authorised signatory with seal